



PRECINCT SUMMARY STATEMENT

(IEC-8)

State Form 13332 (R7/7-06)

Indiana Election Commission (IC 3-11-1.5-15) Name of County LAKE

INSTRUCTIONS: See Indiana Code 3-11-1.5-25 for periods during which precinct boundary changes may NOT take effect.
Indiana Code 3-11-1.5-15 requires that a county include the following items in a proposed precinct establishment order submitted to the Indiana Election Division:

1. A map of each precinct to be established by the proposed order. A county may submit these maps in electronic form.
2. A description of the boundaries of each precinct to be established by the proposed order that identifies any census blocks located entirely within the precinct.
3. An estimated number of voters in each precinct to be established by the proposed order, based on the registration records maintained by the county voter registration office.
4. A statement designating a polling place for the precinct that complies with the polling place accessibility requirements.
5. Any additional information required by rules adopted by the Indiana Election Commission under IC 4-22-2.

General Precinct Information

1. Name Of Proposed Precinct <u>MER 18</u>		2. Is this a new precinct? <input checked="" type="checkbox"/> Yes <input type="checkbox"/> No		3. Election Division & STFID Number <i>(To Be Completed By Election Division)</i>	
4. District Information Congressional <u>1</u> Indiana Senate <u>2</u> Indiana House <u>14</u>					
5. Number Of Active Voters (IC 3-5-2-1.7) <u>1084</u>		6. Number Of Inactive Voters <u>240</u>		7. Number Of Registered Voters (Must Equal Total Of Active And Inactive Voters) <u>1324</u>	
8. Total Number Of Precincts In The County If Submission Is Approved Voting Precincts _____ Non-Voting Precincts _____					
9. Date Of County Executive's Adopted Order			10. Date Of First Election After Precincts Are Approved MAY 8, 2018		
11. Precincts Affected By This Proposed Order (Complete a Precinct Summary Statement for each precinct. Please note that when changing boundaries of one precinct you will need to complete a separate IEC-8 for any other precinct affected by the change.) <u>MER 18 + MER 25</u>					

12. List Any Attached Documents (i.e. map 6 of 20 maps, etc.) CENSUS BLOCK LISTING AND MAPS

Does any portion of the newly established precinct split or divide any of the following?	Yes	No
13. School Corporation District Boundary		X
14. City or Town Boundary		X
15. City or Town Council District Boundary		X
16. Census Block Boundary		X
17. Other (Please Describe)		X

Method of Voting

18. Optical Scan Ballot Card Electronic Combination (Please Specify): _____

19. What is the designated location and address for the polling place for this precinct?
PRUZIN COMMUNITY CENTER
5750 TYLER ST
MERRILLVILLE, IN 46410
 (NOTE: This designation of a polling place remains in effect until later action by the county executive under state law.)

20. Does this polling place meet Indiana's polling place accessibility requirements? Yes No

Precinct Change Reason

21. Briefly state the reason for the precinct change. (Attach additional sheet if necessary.)
SENATE BILL 220 COMBINING MER 18 + MER 25

Additional Information

22. Name and Contact Information Of County Election Staff Person Who Prepared This Form:
GENNY GASPAROVIC 219-755-3812

23. Does the county have access to Geographic Information System (GIS)? Yes No
 Name and Contact Information Of County GIS Staff: **Annette Mellady 219-755-3795**

24. Does the county use Census Tiger files? Yes No

State Office Use Only

25. Type Of Geographic Files Used by County (If Known By Staff Of The Indiana Election Division Or Office Of Census Data)

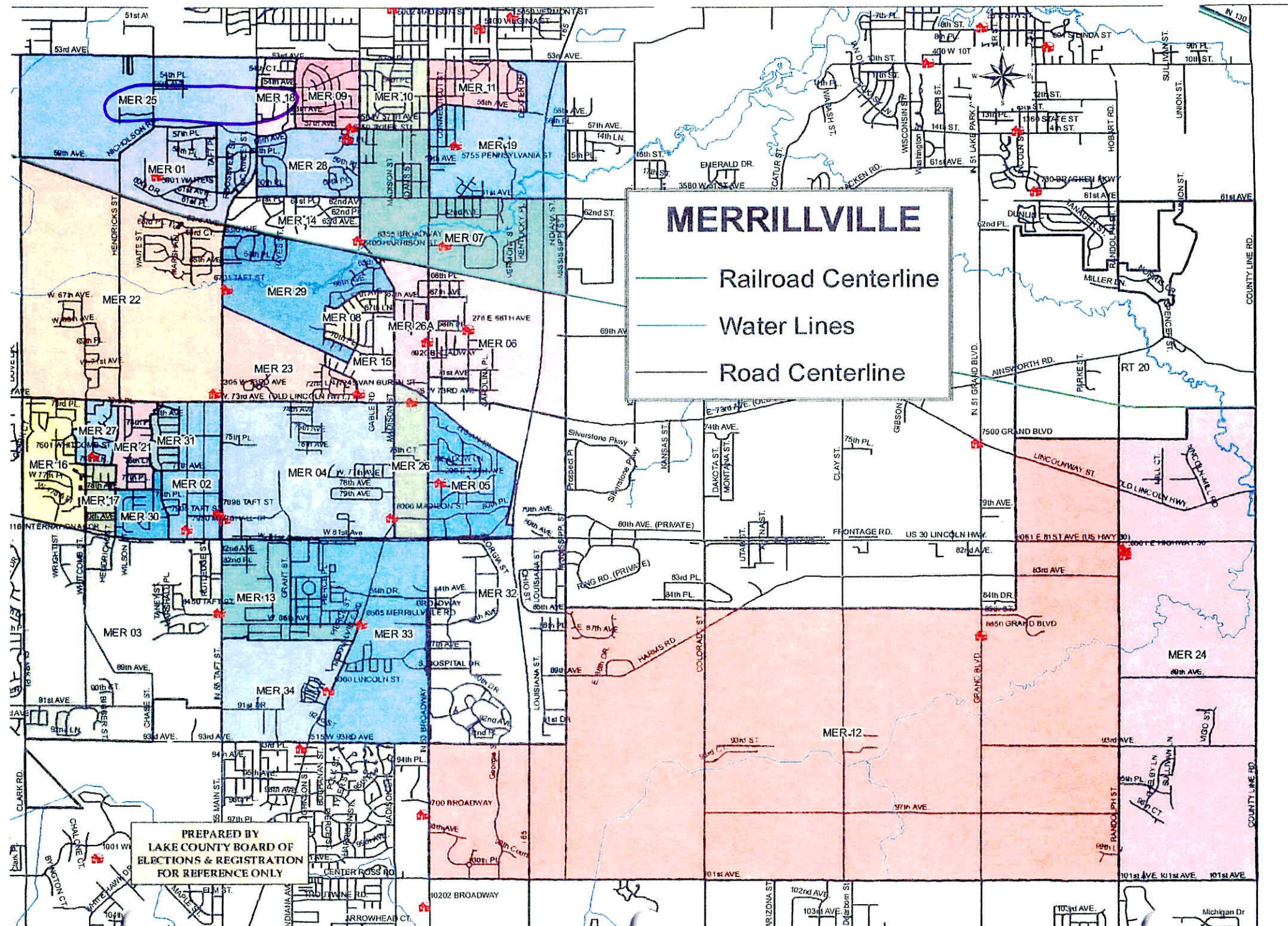

MERRILLVILLE

- Railroad Centerline
- Water Lines
- Road Centerline

PREPARED BY
LAKE COUNTY BOARD OF
ELECTIONS & REGISTRATION
FOR REFERENCE ONLY

MERRILLVILLE
PRECINCT 18

180890424012025

180890424012008

180890424012005

180890424012024

180890424012009

180890424012006

180890424012007

180890424012010

180890424012026

MERRILLVILLE
PRECINCT 25

180890424011006

180890424011005

180890424011002

180890424011000

180890424011015

180890424011001

180890424011010

180890424011020

180890424011021

180890424011019

180890424011009

180890424011004

180890424011024

180890424011003

180890424011022

180890424011018