



PRECINCT SUMMARY STATEMENT

(IEC-8)

State Form 13332 (R7/7-06)

Indiana Election Commission (IC 3-11-1.5-15) Name of County **LAKE**

INSTRUCTIONS: See Indiana Code 3-11-1.5-25 for periods during which precinct boundary changes may NOT take effect.
 Indiana Code 3-11-1.5-15 requires that a county include the following items in a proposed precinct establishment order submitted to the Indiana Election Division:

1. A map of each precinct to be established by the proposed order. A county may submit these maps in electronic form.
2. A description of the boundaries of each precinct to be established by the proposed order that identifies any census blocks located entirely within the precinct.
3. An estimated number of voters in each precinct to be established by the proposed order, based on the registration records maintained by the county voter registration office.
4. A statement designating a polling place for the precinct that complies with the polling place accessibility requirements.
5. Any additional information required by rules adopted by the Indiana Election Commission under IC 4-22-2.

General Precinct Information

1. Name Of Proposed Precinct LS 11		2. Is this a new precinct? <input checked="" type="checkbox"/> Yes <input type="checkbox"/> No	3. Election Division & STFID Number (To Be Completed By Election Division)
4. District Information Congressional <u>1</u> Indiana Senate <u>3</u> Indiana House <u>3</u>			
5. Number Of Active Voters (IC 3-5-2-1.7) 1172	6. Number Of Inactive Voters 136	7. Number Of Registered Voters (Must Equal Total Of Active And Inactive Voters) 1308	
8. Total Number Of Precincts In The County If Submission Is Approved Voting Precincts _____ Non-Voting Precincts _____			
9. Date Of County Executive's Adopted Order		10. Date Of First Election After Precincts Are Approved MAY 8, 2018	
11. Precincts Affected By This Proposed Order (Complete a Precinct Summary Statement for each precinct. Please note that when changing boundaries of one precinct you will need to complete a separate IEC-8 for any other precinct affected by the change.) LS 11 + LS 12			

12. List Any Attached Documents (i.e. map 6 of 20 maps, etc.)
CENSUS BLOCK LISTING AND MAPS

Does any portion of the newly established precinct split or divide any of the following?	Yes	No
13. School Corporation District Boundary		X
14. City or Town Boundary		X
15. City or Town Council District Boundary		X
16. Census Block Boundary		X
17. Other (Please Describe)		X

Method of Voting

18. Optical Scan Ballot Card Electronic Combination (Please Specify): _____

19. What is the designated location and address for the polling place for this precinct?
**HOBART TOWNSHIP COMMUNITY CENTER
 3107 E. 35TH AVE.
 LAKE STATION, IN.**

(NOTE: This designation of a polling place remains in effect until later action by the county executive under state law.)

20. Does this polling place meet Indiana's polling place accessibility requirements? Yes No

Precinct Change Reason

21. Briefly state the reason for the precinct change. (Attach additional sheet if necessary.)
SENATE BILL 220 COMBINING LS 11 + LS 12

Additional Information

22. Name and Contact Information Of County Election Staff Person Who Prepared This Form:
GENNY GASPAROVIC 219-755-3812

23. Does the county have access to Geographic Information System (GIS)? Yes No
 Name and Contact Information Of County GIS Staff: **Annette Mellady 219-755-3795**

24. Does the county use Census Tiger files? Yes No

State Office Use Only

25. Type Of Geographic Files Used by County (If Known By Staff Of The Indiana Election Division Or Office Of Census Data)

LAKE STATION

— Railroad Centerline

— Water Lines

— Road Centerline

PREPARED BY
LAKE COUNTY BOARD OF
ELECTIONS & REGISTRATION
FOR REFERENCE ONLY

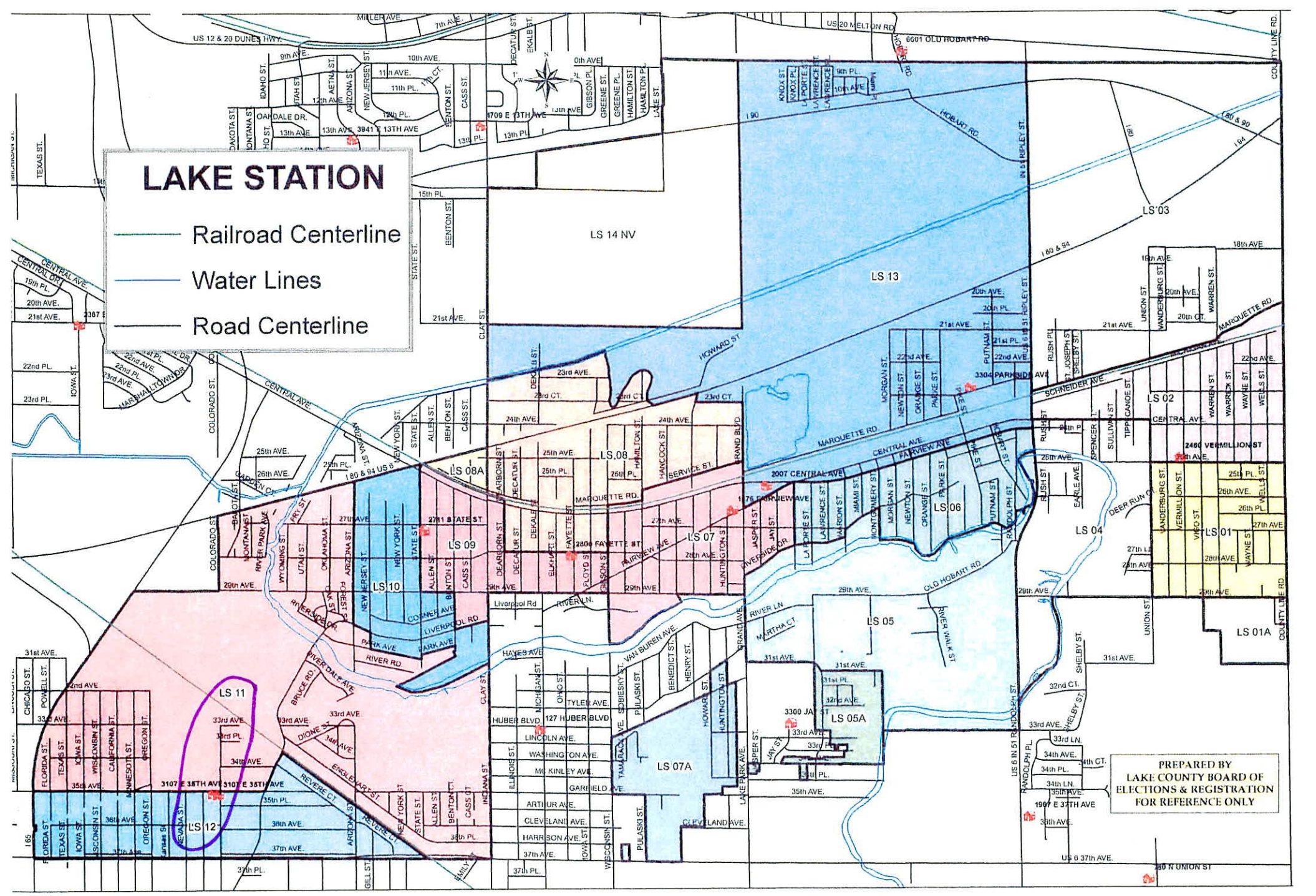

LAKE STATION
PRECINCT 11

①

180890416004005
180890416003013
180890416004021
180890416004003
180890417005033
180890416003019
180890417005021
180890417005017
180890417005006
180890417005008
180890417005018
180890417005020
180890416004004
180890417005019
180890417005030
180890417004018
180890417005013
180890417005022
180890417005032
180890417005023
180890416003020
180890416004022
180890416003014
180890416003015
180890416002027
180890416004009
180890416004015
180890416004016
180890416004010
180890416004001
180890417005009
180890416004017
180890416004018

LAKE STATION
PRECINCT 11

- 180890416004019
- 180890416004020
- 180890416004042
- 180890416003017
- 180890417005034
- 180890417005031
- 180890123001012
- 180890417005007
- 180890417005004
- 180890416004052
- 180890416004023
- 180890416004006
- 180890417004020
- 180890417004019
- 180890417005016
- 180890416004008
- 180890416004000
- 180890417005005
- 180890417005014
- 180890416003016
- 180890123001011
- 180890416003018
- 180890416004011
- 180890416004002
- 180890417005015
- 180890416004007

LAKE STATION
PRECINCT 12

180890416003022

180890416004045

180890416004014

180890416004029

180890416004032

180890416004024

180890416004034

180890416004035

180890416004037

180890416004051

180890416004049

180890416004041

180890416004040

180890416004039

180890416004050

180890416004046

180890416004044

180890416004043

180890416004048

180890416004047

180890416004036

180890416004026

180890416004028

180890416004012

180890416004030

180890416004013

180890416004033

180890416004031

180890416004025

180890416004027

180890416004038