



PRECINCT SUMMARY STATEMENT

(IEC-8)

State Form 13332 (R7/7-06)

Indiana Election Commission (IC 3-11-1.5-15) Name of County LAKE

INSTRUCTIONS: See Indiana Code 3-11-1.5-25 for periods during which precinct boundary changes may NOT take effect.
 Indiana Code 3-11-1.5-15 requires that a county include the following items in a proposed precinct establishment order submitted to the Indiana Election Division:

1. A map of each precinct to be established by the proposed order. A county may submit these maps in electronic form.
2. A description of the boundaries of each precinct to be established by the proposed order that identifies any census blocks located entirely within the precinct.
3. An estimated number of voters in each precinct to be established by the proposed order, based on the registration records maintained by the county voter registration office.
4. A statement designating a polling place for the precinct that complies with the polling place accessibility requirements.
5. Any additional information required by rules adopted by the Indiana Election Commission under IC 4-22-2.

General Precinct Information

1. Name Of Proposed Precinct LS 9 2. Is this a new precinct? Yes No 3. Election Division & STFID Number (To Be Completed By Election Division)

4. District Information
 Congressional 1 Indiana Senate 3 Indiana House 3

5. Number Of Active Voters (IC 3-5-2-1.7) 812 6. Number Of Inactive Voters 100 7. Number Of Registered Voters (Must Equal Total Of Active And Inactive Voters) 912

8. Total Number Of Precincts In The County If Submission Is Approved
 Voting Precincts _____ Non-Voting Precincts _____

9. Date Of County Executive's Adopted Order _____ 10. Date Of First Election After Precincts Are Approved
 MAY 8, 2018

11. Precincts Affected By This Proposed Order (Complete a Precinct Summary Statement for each precinct. Please note that when changing boundaries of one precinct you will need to complete a separate IEC-8 for any other precinct affected by the change.)
LS 9 + LS 8

12. List Any Attached Documents (i.e. map 6 of 20 maps, etc.)
CENSUS BLOCK LISTING AND MAPS

Does any portion of the newly established precinct split or divide any of the following?	Yes	No
13. School Corporation District Boundary		X
14. City or Town Boundary		X
15. City or Town Council District Boundary		X
16. Census Block Boundary		X
17. Other (Please Describe)		X

Method of Voting

18. Optical Scan Ballot Card Electronic Combination (Please Specify): _____

19. What is the designated location and address for the polling place for this precinct?
COMMUNITY PRESBYTERIAN CHURCH
2800 FAYETTE ST.
LAKE STATION, IN 46405
 (NOTE: This designation of a polling place remains in effect until later action by the county executive under state law.)

20. Does this polling place meet Indiana's polling place accessibility requirements? Yes No

Precinct Change Reason

21. Briefly state the reason for the precinct change. (Attach additional sheet if necessary.)
SENATE BILL 220 COMBINING LS 9 + LS 8

Additional Information

22. Name and Contact Information Of County Election Staff Person Who Prepared This Form:
GENNY GASPAROVIC 219-755-3812

23. Does the county have access to Geographic Information System (GIS)? Yes No
 Name and Contact Information Of County GIS Staff: **Annette Mellady 219-755-3795**

24. Does the county use Census Tiger files? Yes No

State Office Use Only

25. Type Of Geographic Files Used by County (If Known By Staff Of The Indiana Election Division Or Office Of Census Data)

LAKE STATION

— Railroad Centerline

— Water Lines

— Road Centerline

PREPARED BY
LAKE COUNTY BOARD OF
ELECTIONS & REGISTRATION
FOR REFERENCE ONLY

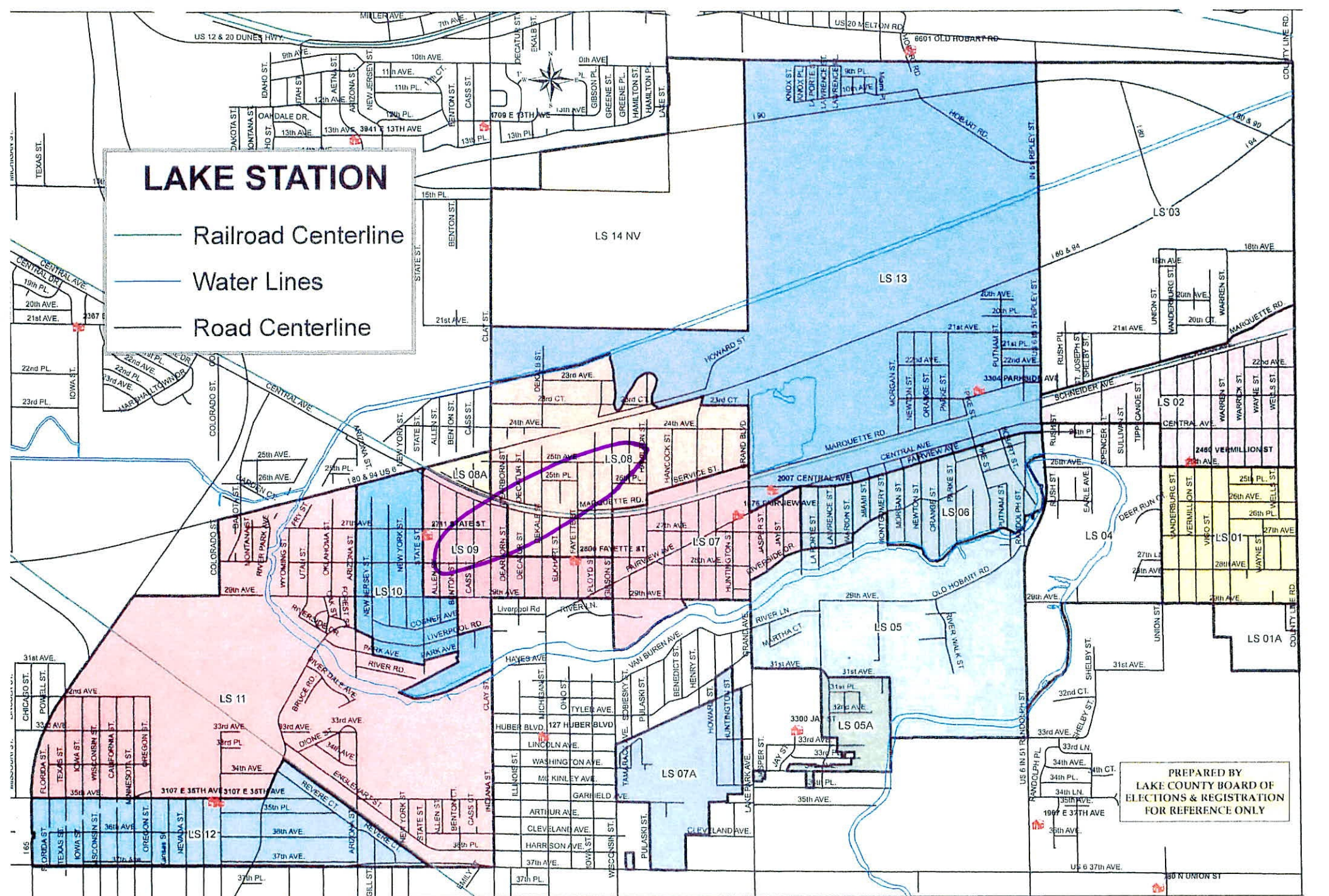

LAKE STATION
PRECINCT 09

180890417003007

180890417003020

180890417004015

180890417004012

180890417004013

180890417004042

180890417004026

180890417004021

180890417004022

180890417004028

180890417003036

180890417003046

180890417004033

180890417003042

180890417003024

180890417003023

180890417004014

180890417004023

180890417004027

180890417004031

180890417003029

180890417003049

180890417004030

180890417003043

180890417003044

180890417003019

180890417003018

180890417003045

180890417004008

180890417004025

180890417003037

180890417003050

180890417004024

180890417003048

180890417003035

180890417004032

180890417004029

180890417003047

LAKE STATION
PRECINCT 08

180890417001032
180890417001039
180890417003033
180890417004005
180890417004003
180890417003005
180890417003031
180890417003040
180890417003038
180890417003008
180890417003010
180890417003012
180890417003006
180890417001044
180890417001043
180890417001041
180890417001020
180890417001046
180890417001035
180890417001064
180890417001033
180890417004004
180890417004002
180890417003004
180890417003021
180890417003041
180890417003034
180890417003022
180890417003013
180890417001040
180890417001045
180890417003032
180890417003039
180890417003030
180890417004000
180890417001036
180890417001065
180890417004001
180890417001042
180890417001038
180890417003011
180890417003009
180890417003052
180890417001037
180890417001019