



PRECINCT SUMMARY STATEMENT

(IEC-8)

State Form 13332 (R7/7-06)

Indiana Election Commission (IC 3-11-1.5-15) Name of County LAKE

INSTRUCTIONS: See Indiana Code 3-11-1.5-25 for periods during which precinct boundary changes may NOT take effect.
 Indiana Code 3-11-1.5-15 requires that a county include the following items in a proposed precinct establishment order submitted to the Indiana Election Division:

1. A map of each precinct to be established by the proposed order. A county may submit these maps in electronic form.
2. A description of the boundaries of each precinct to be established by the proposed order that identifies any census blocks located entirely within the precinct.
3. An estimated number of voters in each precinct to be established by the proposed order, based on the registration records maintained by the county voter registration office.
4. A statement designating a polling place for the precinct that complies with the polling place accessibility requirements.
5. Any additional information required by rules adopted by the Indiana Election Commission under IC 4-22-2.

General Precinct Information

1. Name Of Proposed Precinct HL 06 2. Is this a new precinct? Yes No 3. Election Division & STFID Number (To Be Completed By Election Division)

4. District Information
 Congressional 1 Indiana Senate 1 Indiana House 12

5. Number Of Active Voters (IC 3-5-2-1.7) 15001 6. Number Of Inactive Voters 86 7. Number Of Registered Voters (Must Equal Total Of Active And Inactive Voters) 15087

8. Total Number Of Precincts In The County If Submission Is Approved
 _____ Voting Precincts _____ Non-Voting Precincts

9. Date Of County Executive's Adopted Order 10. Date Of First Election After Precincts Are Approved
 _____ MAY 8, 2018

11. Precincts Affected By This Proposed Order (Complete a Precinct Summary Statement for each precinct. Please note that when changing boundaries of one precinct you will need to complete a separate IEC-8 for any other precinct affected by the change.)
HL 06 & HL 07

12. List Any Attached Documents (i.e. map 6 of 20 maps, etc.)
CENSUS BLOCK LISTING AND MAPS

Does any portion of the newly established precinct split or divide any of the following?	Yes	No
13. School Corporation District Boundary		X
14. City or Town Boundary		X
15. City or Town Council District Boundary		X
16. Census Block Boundary		X
17. Other (Please Describe)		X

Method of Voting

18. Optical Scan Ballot Card Electronic Combination (Please Specify): _____

19. What is the designated location and address for the polling place for this precinct?
JOHNSTON ELEMENTARY SCHOOL
8220 5th ST
HIGHLAND IN
 (NOTE: This designation of a polling place remains in effect until later action by the county executive under state law.)

20. Does this polling place meet Indiana's polling place accessibility requirements? Yes No

Precinct Change Reason

21. Briefly state the reason for the precinct change. (Attach additional sheet if necessary.)
SENATE BILL 220 - Combine HL 06 & HL 07

Additional Information

22. Name and Contact Information Of County Election Staff Person Who Prepared This Form:
GENNY GASPAROVIC 219-755-3812

23. Does the county have access to Geographic Information System (GIS)? Yes No
 Name and Contact Information Of County GIS Staff: Annette Mellady 219-755-3795

24. Does the county use Census Tiger files? Yes No

State Office Use Only

25. Type Of Geographic Files Used by County (If Known By Staff Of The Indiana Election Division Or Office Of Census Data)

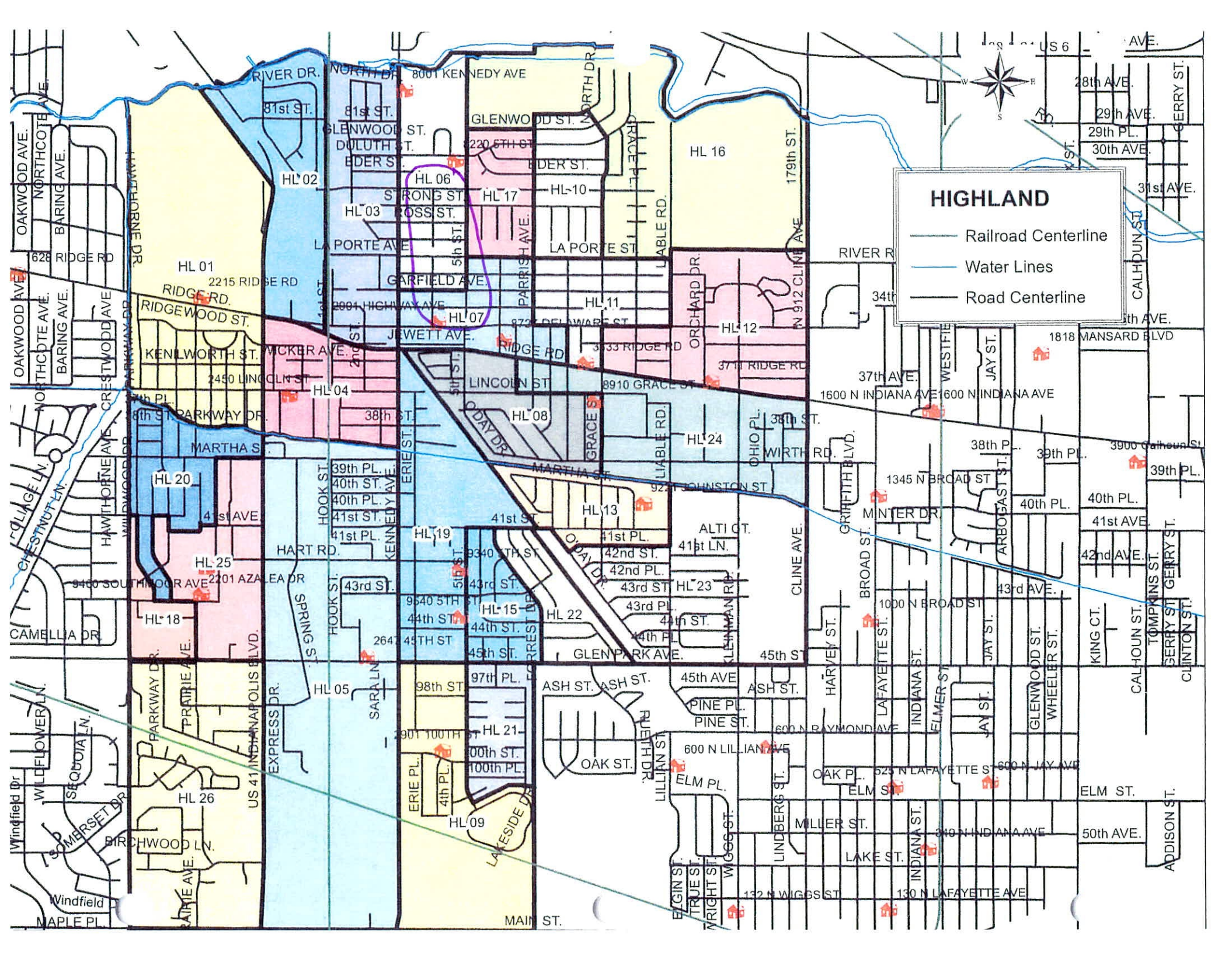

HIGHLAND

- Railroad Centerline
- Water Lines
- Road Centerline

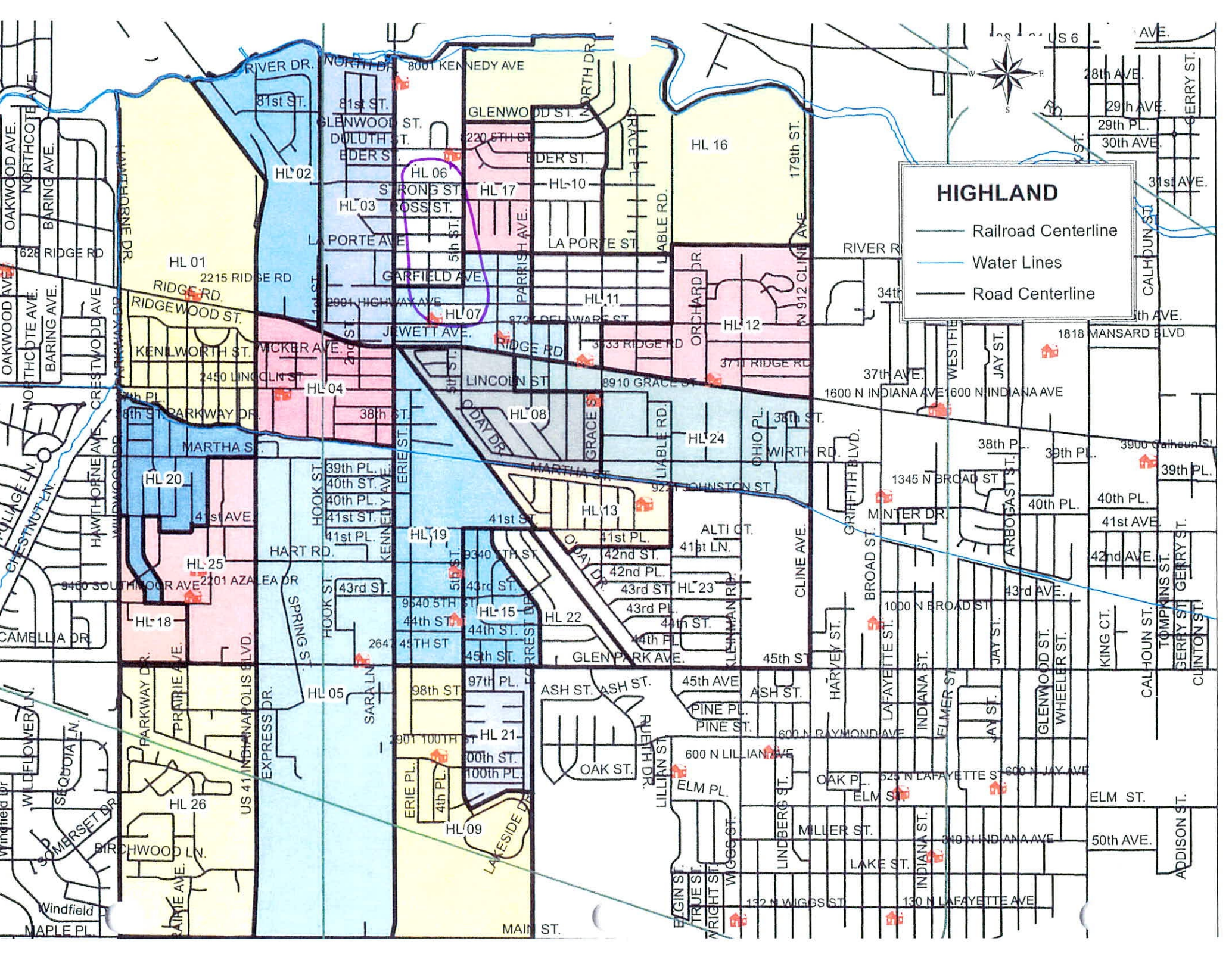

HIGHLAND
PRECINCT 06

180890407004008

180890407004002

180890407004005

180890407004007

180890407004006

180890407004009

180890407004010

180890407004011

180890407004012

180890407004013

180890407004014

180890407004015

180890407004001

180890407004004

180890407004003

HIGHLAND
PRECINCT 07

180890407003011
180890407004017
180890407004018
180890408013013
180890407003009
180890407003012
180890407003010
180890407004019
180890408013012
180890407003016
180890408013008
180890408013007
180890407003015
180890408013005
180890408013006
180890408013010
180890408013009
180890408013011
180890407003014
180890407004016
180890408013004
180890407003013