



PRECINCT SUMMARY STATEMENT

(IEC-8)

State Form 13332 (R/7-06)

Indiana Election Commission (IC 3-11-1.5-15) Name of County LAKE

- INSTRUCTIONS:** See Indiana Code 3-11-1.5-25 for periods during which precinct boundary changes may NOT take effect.
- Indiana Code 3-11-1.5-15 requires that a county include the following items in a proposed precinct establishment order submitted to the Indiana Election Division:
1. A map of each precinct to be established by the proposed order. A county may submit these maps in electronic form.
 2. A description of the boundaries of each precinct to be established by the proposed order that identifies any census blocks located entirely within the precinct.
 3. An estimated number of voters in each precinct to be established by the proposed order, based on the registration records maintained by the county voter registration office.
 4. A statement designating a polling place for the precinct that complies with the polling place accessibility requirements.
 5. Any additional information required by rules adopted by the Indiana Election Commission under IC 4-22-2.

General Precinct Information

1. Name Of Proposed Precinct <u>G3-21</u>		2. Is this a new precinct? <input checked="" type="checkbox"/> Yes <input type="checkbox"/> No		3. Election Division & STFID Number <i>(To Be Completed By Election Division)</i>	
4. District Information Congressional <u>1</u> Indiana Senate <u>2</u> Indiana House <u>2</u>					
5. Number Of Active Voters (IC 3-5-2-1.7) <u>938</u>		6. Number Of Inactive Voters <u>156</u>		7. Number Of Registered Voters (Must Equal Total Of Active And Inactive Voters) <u>5094</u>	
8. Total Number Of Precincts In The County If Submission Is Approved Voting Precincts _____ Non-Voting Precincts _____					
9. Date Of County Executive's Adopted Order			10. Date Of First Election After Precincts Are Approved <u>MAY 8, 2018</u>		
11. Precincts Affected By This Proposed Order (Complete a Precinct Summary Statement for each precinct. Please note that when changing boundaries of one precinct you will need to complete a separate IEC-8 for any other precinct affected by the change.) <u>G3-21 & G3-13</u>					
12. List Any Attached Documents (i.e. map 6 of 20 maps, etc.)					

CENSUS BLOCK LISTING AND MAPS

Does any portion of the newly established precinct split or divide any of the following?	Yes	No
13. School Corporation District Boundary		X
14. City or Town Boundary		X
15. City or Town Council District Boundary		X
16. Census Block Boundary		X
17. Other (Please Describe)		X

Method of Voting

18. Optical Scan Ballot Card Electronic Combination (Please Specify): _____

19. What is the designated location and address for the polling place for this precinct?
WEST Side High School
9th & GERRY ST
GARY IN
(NOTE: This designation of a polling place remains in effect until later action by the county executive under state law.)

20. Does this polling place meet Indiana's polling place accessibility requirements? Yes No

Precinct Change Reason

21. Briefly state the reason for the precinct change. (Attach additional sheet if necessary.)
SENATE BILL 220 - Combine G3-21 & G3-13

Additional Information

22. Name and Contact Information Of County Election Staff Person Who Prepared This Form:
GENNY GASPAROVIC 219-755-3812

23. Does the county have access to Geographic Information System (GIS)? Yes No
Name and Contact Information Of County GIS Staff: Annette Mellady 219-755-3795

24. Does the county use Census Tiger files? Yes No

State Office Use Only

25. Type Of Geographic Files Used by County (If Known By Staff Of The Indiana Election Division Or Office Of Census Data)

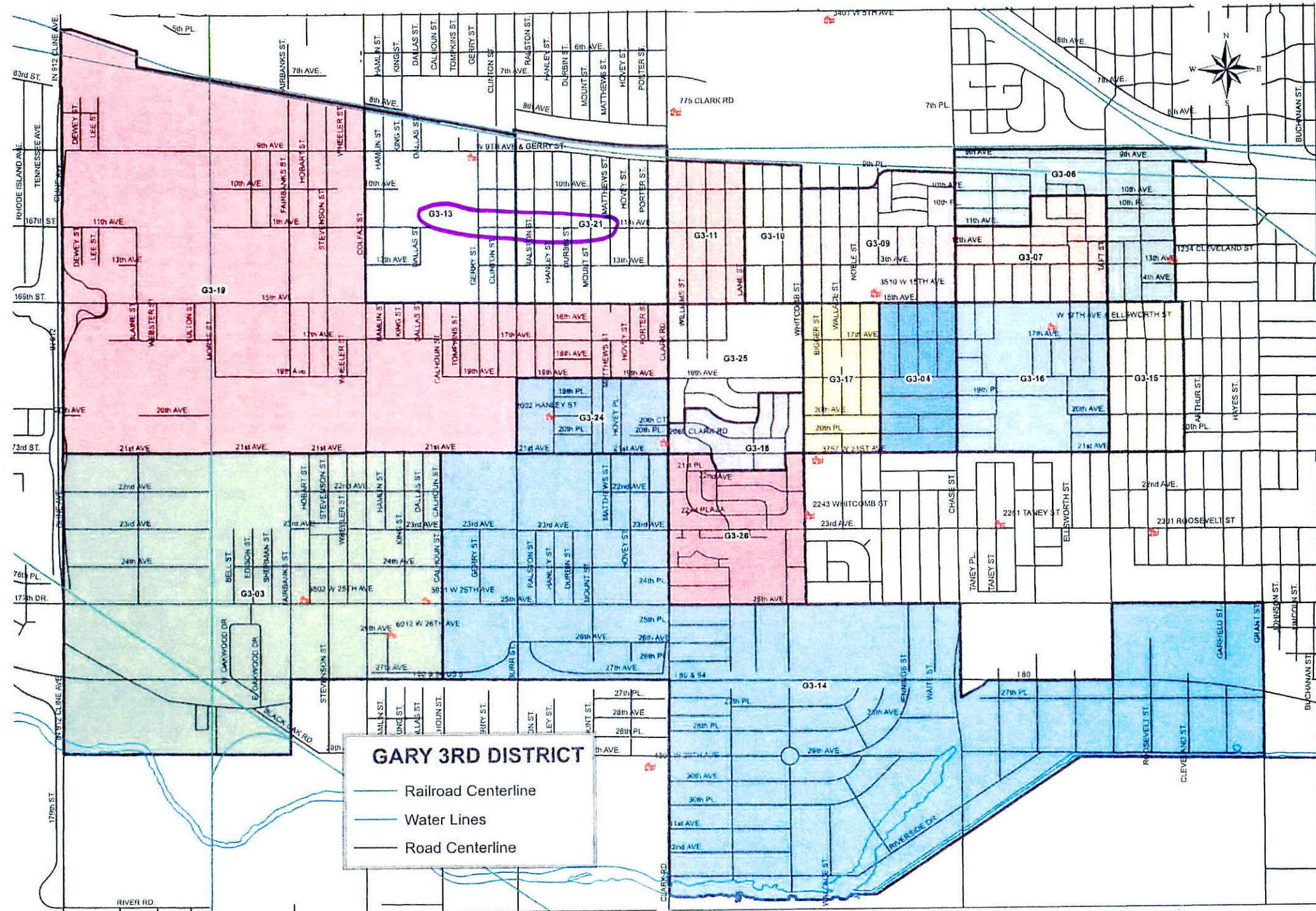

GARY PRECINCT
3-13

180890103023117
180890103023000
180890103023007
180890103023013
180890103023016
180890103023025
180890103023008
180890103023009
180890103023018
180890103023019
180890103023024
180890103023028
180890103023113
180890103023030
180890103023115
180890103023023
180890103023015
180890103023026
180890103023120
180890103023116
180890103023017
180890103023112
180890103023021
180890103023020
180890103023029
180890103023022
180890103023011
180890103023010
180890103023027
180890103023114
180890103023014
180890103023012

GARY PRECINCT

3-21

180890103021054
180890103021000
180890103021001
180890103021020
180890103021053
180890103021016
180890103021015
180890103021022
180890103021014
180890103021040

①

2

GARY PRECINCT
3-21

- 180890103021005
- 180890103021025
- 180890103021012
- 180890103021010
- 180890103021051
- 180890103021039
- 180890103021047
- 180890103021038
- 180890103021011
- 180890103021046
- 180890103021043
- 180890103021036
- 180890103021029
- 180890103021031
- 180890103021035
- 180890103021033
- 180890103021032
- 180890103021034
- 180890103021023
- 180890103021050
- 180890103021052
- 180890103021049
- 180890103021024
- 180890103021002
- 180890103021027
- 180890103021030
- 180890103021037
- 180890103021013
- 180890103021009
- 180890103021017
- 180890103021055
- 180890103021026
- 180890103021003
- 180890103021045
- 180890103021048
- 180890103021021
- 180890103021018
- 180890103021019
- 180890103021042
- 180890103021056

GARY PRECINCT

3-21

- 180890103021008
- 180890103021044
- 180890103021057
- 180890103021007
- 180890103021028
- 180890103021006
- 180890103021004
- 180890103021041