



PRECINCT SUMMARY STATEMENT

(IEC-8)

State Form 13332 (R7/7-06)

Indiana Election Commission (IC 3-11-1.5-15) Name of County LAKE

INSTRUCTIONS: See Indiana Code 3-11-1.5-25 for periods during which precinct boundary changes may NOT take effect.
 Indiana Code 3-11-1.5-15 requires that a county include the following items in a proposed precinct establishment order submitted to the Indiana Election Division:

1. A map of each precinct to be established by the proposed order. A county may submit these maps in electronic form.
2. A description of the boundaries of each precinct to be established by the proposed order that identifies any census blocks located entirely within the precinct.
3. An estimated number of voters in each precinct to be established by the proposed order, based on the registration records maintained by the county voter registration office.
4. A statement designating a polling place for the precinct that complies with the polling place accessibility requirements.
5. Any additional information required by rules adopted by the Indiana Election Commission under IC 4-22-2.

General Precinct Information

1. Name Of Proposed Precinct <u>G 3-17</u>	2. Is this a new precinct? <input checked="" type="checkbox"/> Yes <input type="checkbox"/> No	3. Election Division & STFID Number (To Be Completed By Election Division)
---	---	---

4. District Information
 Congressional 1 Indiana Senate 3 Indiana House 2

5. Number Of Active Voters (IC 3-5-2-1.7) <u>1,106</u>	6. Number Of Inactive Voters <u>142</u>	7. Number Of Registered Voters (Must Equal Total Of Active And Inactive Voters) <u>1,248</u>
---	--	---

8. Total Number Of Precincts In The County If Submission Is Approved
 Voting Precincts _____ Non-Voting Precincts _____

9. Date Of County Executive's Adopted Order	10. Date Of First Election After Precincts Are Approved <u>MAY 8, 2018</u>
---	---

11. Precincts Affected By This Proposed Order (Complete a Precinct Summary Statement for each precinct. Please note that when changing boundaries of one precinct you will need to complete a separate IEC-8 for any other precinct affected by the change.)
G 3-17, G 3-18 & G 3-25

12. List Any Attached Documents (i.e. map 6 of 20 maps, etc.)
CENSUS BLOCK LISTING AND MAPS

Does any portion of the newly established precinct split or divide any of the following?	Yes	No
13. School Corporation District Boundary		X
14. City or Town Boundary		X
15. City or Town Council District Boundary		X
16. Census Block Boundary		X
17. Other (Please Describe)		X

Method of Voting

18. Optical Scan Ballot Card Electronic Combination (Please Specify): _____

19. What is the designated location and address for the polling place for this precinct?
FRANKIE Mc Cullough / FORMER: Locke
3757 W 121ST
GARY, TN

(NOTE: This designation of a polling place remains in effect until later action by the county executive under state law.)

20. Does this polling place meet Indiana's polling place accessibility requirements? Yes No

Precinct Change Reason

21. Briefly state the reason for the precinct change. (Attach additional sheet if necessary.)
SENATE BILL 220 - Combine G 3-17, G 3-17, & G 3-25

Additional Information

22. Name and Contact Information Of County Election Staff Person Who Prepared This Form:
GENNY GASPAROVIC 219-755-3812

23. Does the county have access to Geographic Information System (GIS)? Yes No
 Name and Contact Information Of County GIS Staff: **Annette Mellady 219-755-3795**



24. Does the county use Census Tiger files? Yes No

State Office Use Only

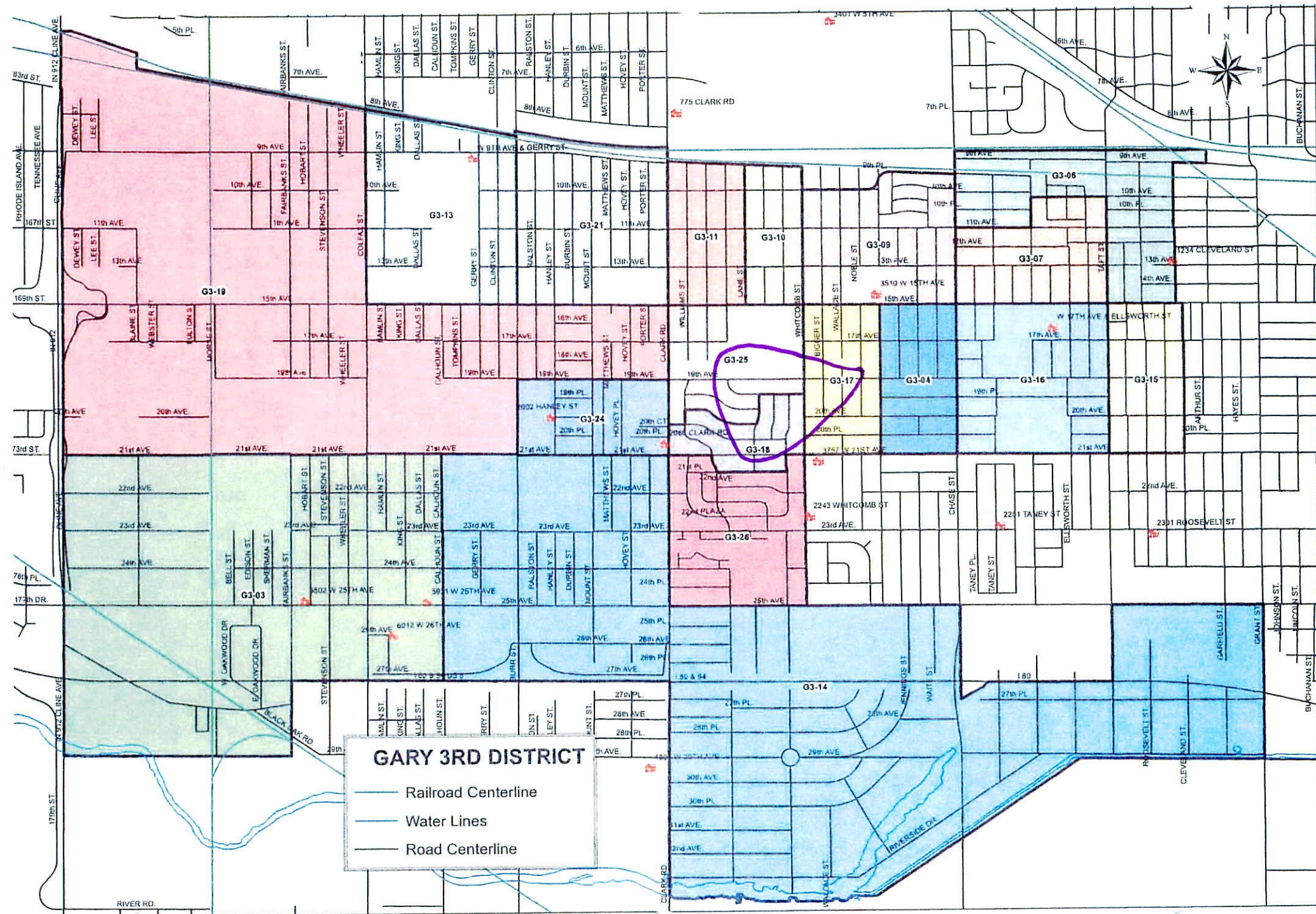
25. Type Of Geographic Files Used by County (If Known By Staff Of The Indiana Election Division Or Office Of Census Data)



GARY 3RD DISTRICT

-  Railroad Centerline
-  Water Lines
-  Road Centerline

GARY PRECINCT
3-17

180890111002029
180890111002040
180890111002043
180890111002030
180890111002012
180890111002015
180890111002026
180890111002049
180890111002048
180890111002038
180890111002025
180890111002047
180890111002016
180890111002039
180890111002052
180890111002024
180890111002044
180890111002046
180890111002011
180890111002010
180890111002032
180890111002041
180890111002028
180890111002013
180890111002009
180890111002014
180890111002031
180890111002008
180890111002027
180890111002042

GARY PRECINCT

3-18

180890111001014

180890111001013

180890111001012

180890111004002

180890111001007

180890111001015

180890111001016

180890111001017

180890111004001

GARY PRECINCT

3-25

180890111001004

180890111001000

180890111001006

180890111001011

180890111001010

180890111001002

180890111001005

180890111001003

180890111001001

180890111001008

180890111001009
