



PRECINCT SUMMARY STATEMENT

(IEC-8)

State Form 13332 (R7/7-06)

Indiana Election Commission (IC 3-11-1.5-15) Name of County LAKE

INSTRUCTIONS: See Indiana Code 3-11-1.5-25 for periods during which precinct boundary changes may NOT take effect.
 Indiana Code 3-11-1.5-15 requires that a county include the following items in a proposed precinct establishment order submitted to the Indiana Election Division:

1. A map of each precinct to be established by the proposed order. A county may submit these maps in electronic form.
2. A description of the boundaries of each precinct to be established by the proposed order that identifies any census blocks located entirely within the precinct.
3. An estimated number of voters in each precinct to be established by the proposed order, based on the registration records maintained by the county voter registration office.
4. A statement designating a polling place for the precinct that complies with the polling place accessibility requirements.
5. Any additional information required by rules adopted by the Indiana Election Commission under IC 4-22-2.

General Precinct Information

1. Name Of Proposed Precinct <u>G3-15</u>	2. Is this a new precinct? <input checked="" type="checkbox"/> Yes <input type="checkbox"/> No	3. Election Division & STFID Number (To Be Completed By Election Division)
----------------------------------------------	---------------------------------------------------------------------------------------------------	-------------------------------------------------------------------------------

4. District Information
 Congressional 1 Indiana Senate 3 Indiana House 2

5. Number Of Active Voters (IC 3-5-2-1.7) <u>813</u>	6. Number Of Inactive Voters <u>207</u>	7. Number Of Registered Voters (Must Equal Total Of Active And Inactive Voters) <u>1020</u>
---------------------------------------------------------	--------------------------------------------	------------------------------------------------------------------------------------------------

8. Total Number Of Precincts In The County If Submission Is Approved
 _____ Voting Precincts _____ Non-Voting Precincts

9. Date Of County Executive's Adopted Order	10. Date Of First Election After Precincts Are Approved <u>MAY 8, 2018</u>
---------------------------------------------	-------------------------------------------------------------------------------

11. Precincts Affected By This Proposed Order (Complete a Precinct Summary Statement for each precinct. Please note that when changing boundaries of one precinct you will need to complete a separate IEC-8 for any other precinct affected by the change.)
G3-15 & G3-6

12. List Any Attached Documents (i.e. map 6 of 20 maps, etc.)
CENSUS BLOCK LISTING & MAPS

Does any portion of the newly established precinct split or divide any of the following?	Yes	No
13. School Corporation District Boundary		X
14. City or Town Boundary		X
15. City or Town Council District Boundary		X
16. Census Block Boundary		X
17. Other (Please Describe)		X

Method of Voting

18. Optical Scan Ballot Card Electronic Combination (Please Specify): _____

19. What is the designated location and address for the polling place for this precinct?
BEVERIDGE SCHOOL
1234 CLEVELAND
GARY, IN
 (NOTE: This designation of a polling place remains in effect until later action by the county executive under state law.)

20. Does this polling place meet Indiana's polling place accessibility requirements? Yes No

Precinct Change Reason

21. Briefly state the reason for the precinct change. (Attach additional sheet if necessary.)
SENATE BILL 220 - COMBINING G3-15 & G3-6

Additional Information

22. Name and Contact Information Of County Election Staff Person Who Prepared This Form:
GENNY GASPAROVIC 219-755-3812

23. Does the county have access to Geographic Information System (GIS)? Yes No
 Name and Contact Information Of County GIS Staff: Annette Mellady 219-755-3795

24. Does the county use Census Tiger files? Yes No

State Office Use Only

25. Type Of Geographic Files Used by County (If Known By Staff Of The Indiana Election Division Or Office Of Census Data)

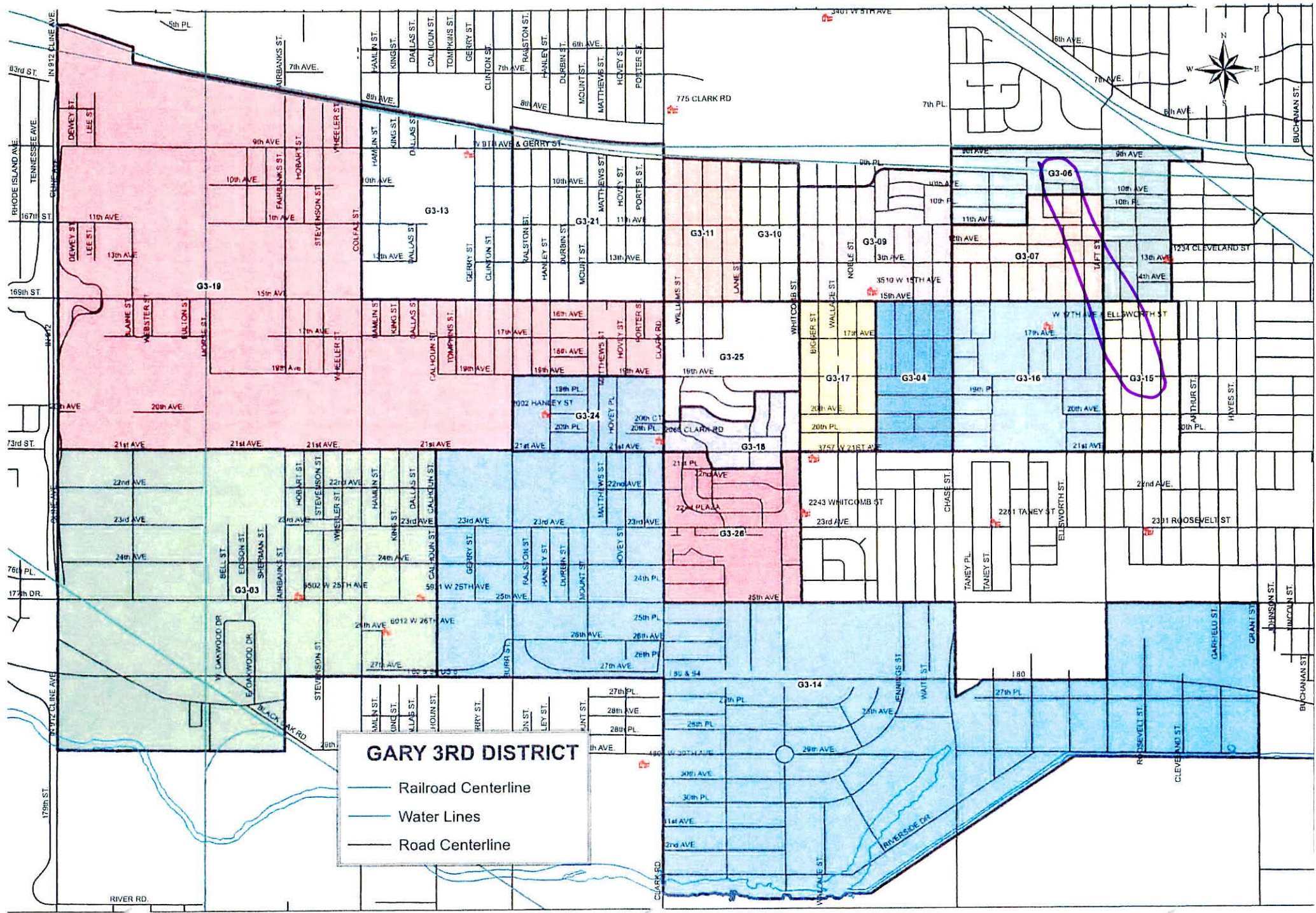

GARY 3RD DISTRICT

- Railroad Centerline
- Water Lines
- Road Centerline

GARY PRECINCT

3-06

1

180890109001002
180890109002006
180890109002002
180890109002003
180890109002010
180890109002004
180890109002012
180890109002037
180890109002035
180890109002023
180890109001007
180890109001006
180890109002005
180890109001024
180890109001016
180890109001001
180890109001005
180890109001008
180890109001014
180890109001017
180890109001039
180890112001009
180890109001041
180890112001005
180890112001012
180890112001006
180890112001018
180890112001007
180890112001010
180890109002013
180890109002039
180890112001011
180890109002009
180890109002011
180890109002036
180890109002038
180890109001040
180890112001008
180890112005001
180890109001022
180890109002025
180890109002016

GARY PRECINCT
3-06

2

180890109002024
180890112005000
180890109002007
180890109001037
180890109002001
180890109002008
180890109002014

180890112005033
180890109002020
180890109001038
180890109002000
180890109002015
180890109001015
180890109001025
180890109001023

GARY PRECINCT

3-15

180890112005037
180890112005040
180890112001033
180890112001043
180890112001041
180890112001059
180890112005053
180890112005058
180890112002032
180890112002016
180890112002012
180890112002014
180890112002018
180890112002030

180890112005052
180890112002011
180890112005059
180890112002013
180890112002031
180890112002019
180890112002015
180890112002029
180890112002009
180890112005038
180890112002017
180890112005032
180890112001036
180890112001038
180890112001044
180890112001042
180890112001034
180890112001031
180890112001032
180890112001062
180890112001035
180890112001040
180890112001045
180890112005054
180890112005039
180890112001037
180890112002010
180890112001039
180890112002007
180890112002008