



PRECINCT SUMMARY STATEMENT

(IEC-8)

State Form 13332 (R7/7-06)

Indiana Election Commission (IC 3-11-1.5-15)

Name of County LAKE

INSTRUCTIONS: See Indiana Code 3-11-1.5-25 for periods during which precinct boundary changes may NOT take effect.
 Indiana Code 3-11-1.5-15 requires that a county include the following items in a proposed precinct establishment order submitted to the Indiana Election Division:

1. A map of each precinct to be established by the proposed order. A county may submit these maps in electronic form.
2. A description of the boundaries of each precinct to be established by the proposed order that identifies any census blocks located entirely within the precinct.
3. An estimated number of voters in each precinct to be established by the proposed order, based on the registration records maintained by the county voter registration office.
4. A statement designating a polling place for the precinct that complies with the polling place accessibility requirements.
5. Any additional information required by rules adopted by the Indiana Election Commission under IC 4-22-2.

General Precinct Information

1. Name Of Proposed Precinct <u>G 3-3</u>	2. Is this a new precinct? <input checked="" type="checkbox"/> Yes <input type="checkbox"/> No	3. Election Division & STFID Number (To Be Completed By Election Division)
--	---	---

4. District Information
 Congressional 1 Indiana Senate 2 Indiana House 2

5. Number Of Active Voters (IC 3-5-2-1.7) <u>950</u>	6. Number Of Inactive Voters <u>184</u>	7. Number Of Registered Voters (Must Equal Total Of Active And Inactive Voters) <u>1,134</u>
---	--	---

8. Total Number Of Precincts In The County If Submission Is Approved
 Voting Precincts _____ Non-Voting Precincts _____

9. Date Of County Executive's Adopted Order	10. Date Of First Election After Precincts Are Approved <u>MAY 8, 2018</u>
---	---

11. Precincts Affected By This Proposed Order (Complete a Precinct Summary Statement for each precinct. Please note that when changing boundaries of one precinct you will need to complete a separate IEC-8 for any other precinct affected by the change.)
G 3-3 & G 3-14

12. List Any Attached Documents (i.e. map 6 of 20 maps, etc.)
CENSUS BLOCK LISTING AND MAPS

Does any portion of the newly established precinct split or divide any of the following?	Yes	No
13. School Corporation District Boundary		X
14. City or Town Boundary		X
15. City or Town Council District Boundary		X
16. Census Block Boundary		X
17. Other (Please Describe)		X

Method of Voting

18. Optical Scan Ballot Card Electronic Combination (Please Specify): _____

19. What is the designated location and address for the polling place for this precinct?
BLACK OAK BAPTIST Church
6502 W 25th Ave
GARY IN

(NOTE: This designation of a polling place remains in effect until later action by the county executive under state law.)

20. Does this polling place meet Indiana's polling place accessibility requirements? Yes No

Precinct Change Reason

21. Briefly state the reason for the precinct change. (Attach additional sheet if necessary.)
SENATE BILL 220 - Combine G 3-3 & G 3-14

Additional Information

22. Name and Contact Information Of County Election Staff Person Who Prepared This Form:
GENNY GASPAROVIC 219-755-3812

23. Does the county have access to Geographic Information System (GIS)? Yes No
 Name and Contact Information Of County GIS Staff: Annette Mellady 219-755-3795

24. Does the county use Census Tiger files? Yes No

State Office Use Only

25. Type Of Geographic Files Used by County (If Known By Staff Of The Indiana Election Division Or Office Of Census Data)

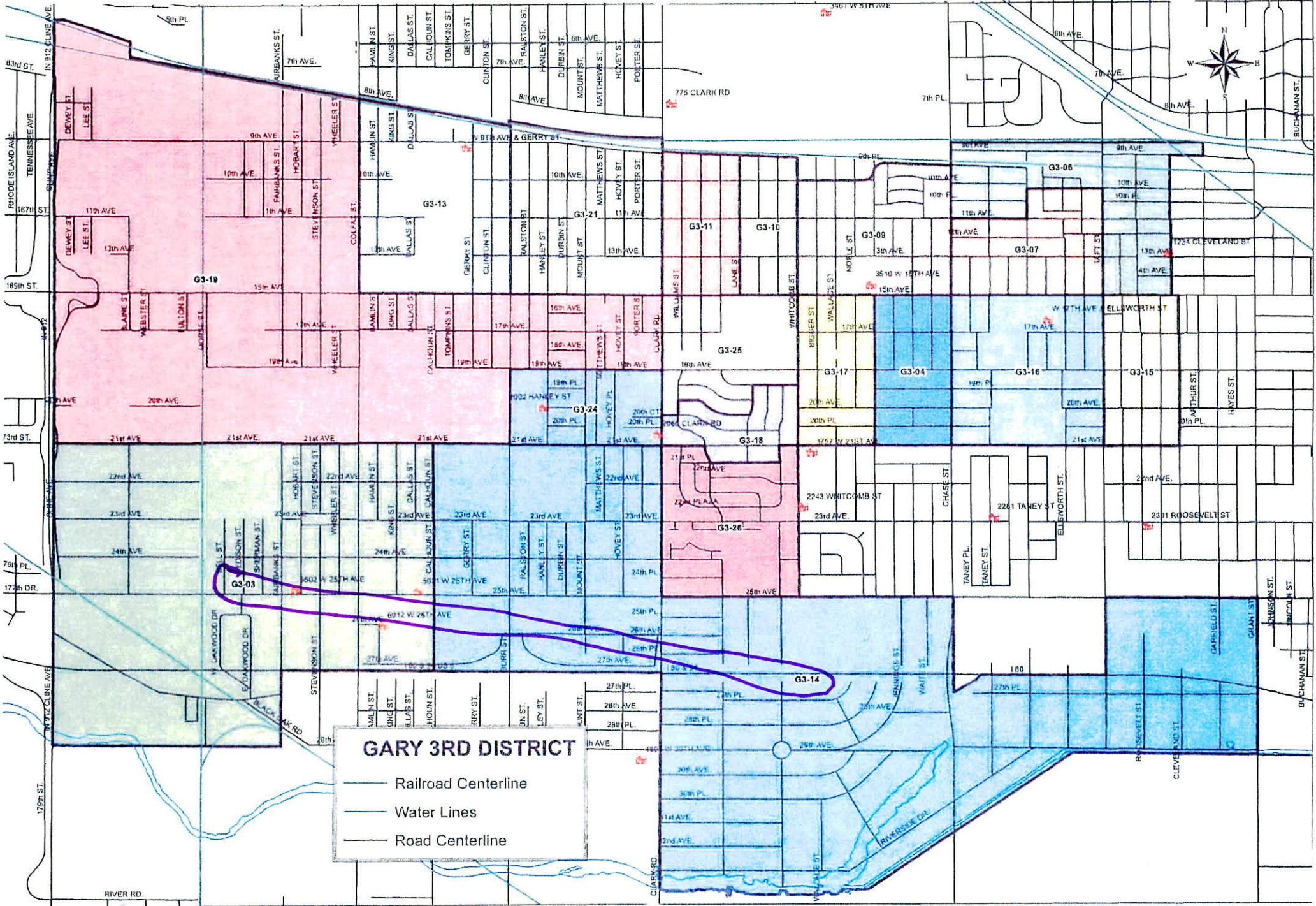

GARY 3RD DISTRICT

- Railroad Centerline
- Water Lines
- Road Centerline



180890411002010
180890411001012
180890411003004
180890411001002
180890411001008
180890411001007
180890411003019
180890411003009
180890411003017
180890411001009
180890411003020
180890411001014
180890411003003
180890411002028
180890411003008
180890411001001
180890411001000
180890411001010
180890411001004
180890411002005
180890411001017
180890411001016
180890411001015
180890411002021
180890411002022
180890411002006
180890411002019
180890411002020
180890411002023
180890411002004
180890411002018
180890411002007
180890411002017
180890411002009
180890411002016
180890411002015
180890411002024
180890411002025
180890411002002
180890411001005
180890411003006
180890411001013
180890411003010
180890411001011
180890411003018
180890411001003

GARY PRECINCT
3-03

- 180890411003005
 - 180890411001006
 - 180890411002003
 - 180890411002008
 - 180890411003007
-

GARY PRECINCT
3-14

GEOID10
180890412003006
180890412003023
180890412003038
180890412003040
180890412003043
180890412003044
180890412003022
180890412003047
180890412003048
180890112003036
180890411002027
180890412003033
180890412003019
180890412003004
180890412003017
180890111004019
180890412003050
180890411002000
180890411002014
180890412003009
180890411002012
180890411002011
180890411002013
180890411002026
180890412003011
180890412003007
180890412003010
180890412003008
180890412003014
180890412003015
180890111004020
180890412003002
180890412003028
180890412003035
180890412003055
180890412003036
180890412003052
180890412003051
180890412003025
180890412003039
180890412003021

GARY PRECINCT

3-14

- 180890412003045
- 180890112003037
- 180890412003000
- 180890112003038
- 180890412003016
- 180890111002065
- 180890111003021
- 180890112003039
- 180890112003034
- 180890411002001
- 180890412003041
- 180890412003046
- 180890412003054
- 180890412003053
- 180890412003042
- 180890412003027
- 180890412003034
- 180890412003018
- 180890412003005
- 180890412003013
- 180890412003037
- 180890111004021
- 180890412003012
- 180890412003024
- 180890112003035