



PRECINCT SUMMARY STATEMENT

(IEC-8)

State Form 13332 (R7/7-06)

Indiana Election Commission (IC 3-11-1.5-15) Name of County LAKE

INSTRUCTIONS: See Indiana Code 3-11-1.5-25 for periods during which precinct boundary changes may NOT take effect.
 Indiana Code 3-11-1.5-15 requires that a county include the following items in a proposed precinct establishment order submitted to the Indiana Election Division:
 1. A map of each precinct to be established by the proposed order. A county may submit these maps in electronic form.
 2. A description of the boundaries of each precinct to be established by the proposed order that identifies any census blocks located entirely within the precinct.
 3. An estimated number of voters in each precinct to be established by the proposed order, based on the registration records maintained by the county voter registration office.
 4. A statement designating a polling place for the precinct that complies with the polling place accessibility requirements.
 5. Any additional information required by rules adopted by the Indiana Election Commission under IC 4-22-2.

General Precinct Information

1. Name Of Proposed Precinct <u>G 2-3</u>	2. Is this a new precinct? <input checked="" type="checkbox"/> Yes <input type="checkbox"/> No	3. Election Division & STFID Number (To Be Completed By Election Division)
--	---	---

4. District Information
 Congressional 1 Indiana Senate 3 Indiana House 3

5. Number Of Active Voters (IC 3-5-2-1.7) <u>731</u>	6. Number Of Inactive Voters <u>159</u>	7. Number Of Registered Voters (Must Equal Total Of Active And Inactive Voters) <u>890</u>
---	--	---

8. Total Number Of Precincts In The County If Submission Is Approved
 Voting Precincts _____ Non-Voting Precincts _____

9. Date Of County Executive's Adopted Order	10. Date Of First Election After Precincts Are Approved <u>MAY 8, 2018</u>
---	---

11. Precincts Affected By This Proposed Order (Complete a Precinct Summary Statement for each precinct. Please note that when changing boundaries of one precinct you will need to complete a separate IEC-8 for any other precinct affected by the change.)
G 2-3 & G 2-5

12. List Any Attached Documents (i.e. map 6 of 20 maps, etc.)
CENSUS BLOCK LISTING AND MAPS

Does any portion of the newly established precinct split or divide any of the following?	Yes	No
13. School Corporation District Boundary		X
14. City or Town Boundary		X
15. City or Town Council District Boundary		X
16. Census Block Boundary		X
17. Other (Please Describe)		X

Method of Voting

18. Optical Scan Ballot Card Electronic Combination (Please Specify): _____

19. What is the designated location and address for the polling place for this precinct?
GENESIS TOWNSHIP SENIOR High Rise
578 BROADWAY
GADSDEN
 (NOTE: This designation of a polling place remains in effect until later action by the county executive under state law.)

20. Does this polling place meet Indiana's polling place accessibility requirements? Yes No

Precinct Change Reason

21. Briefly state the reason for the precinct change. (Attach additional sheet if necessary.)
SENATE BILL 220 - COMBINE G 2-3 & G 2-5

Additional Information

22. Name and Contact Information Of County Election Staff Person Who Prepared This Form:
GENNY GASPAROVIC 219-755-3812

23. Does the county have access to Geographic Information System (GIS)? Yes No
 Name and Contact Information Of County GIS Staff: Annette Mellady 219-755-3795

24. Does the county use Census Tiger files? Yes No

State Office Use Only

25. Type Of Geographic Files Used by County (If Known By Staff Of The Indiana Election Division Or Office Of Census Data)

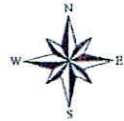

GARY 2ND DISTRICT

- Railroad Centerline
- Water Lines
- Road Centerline

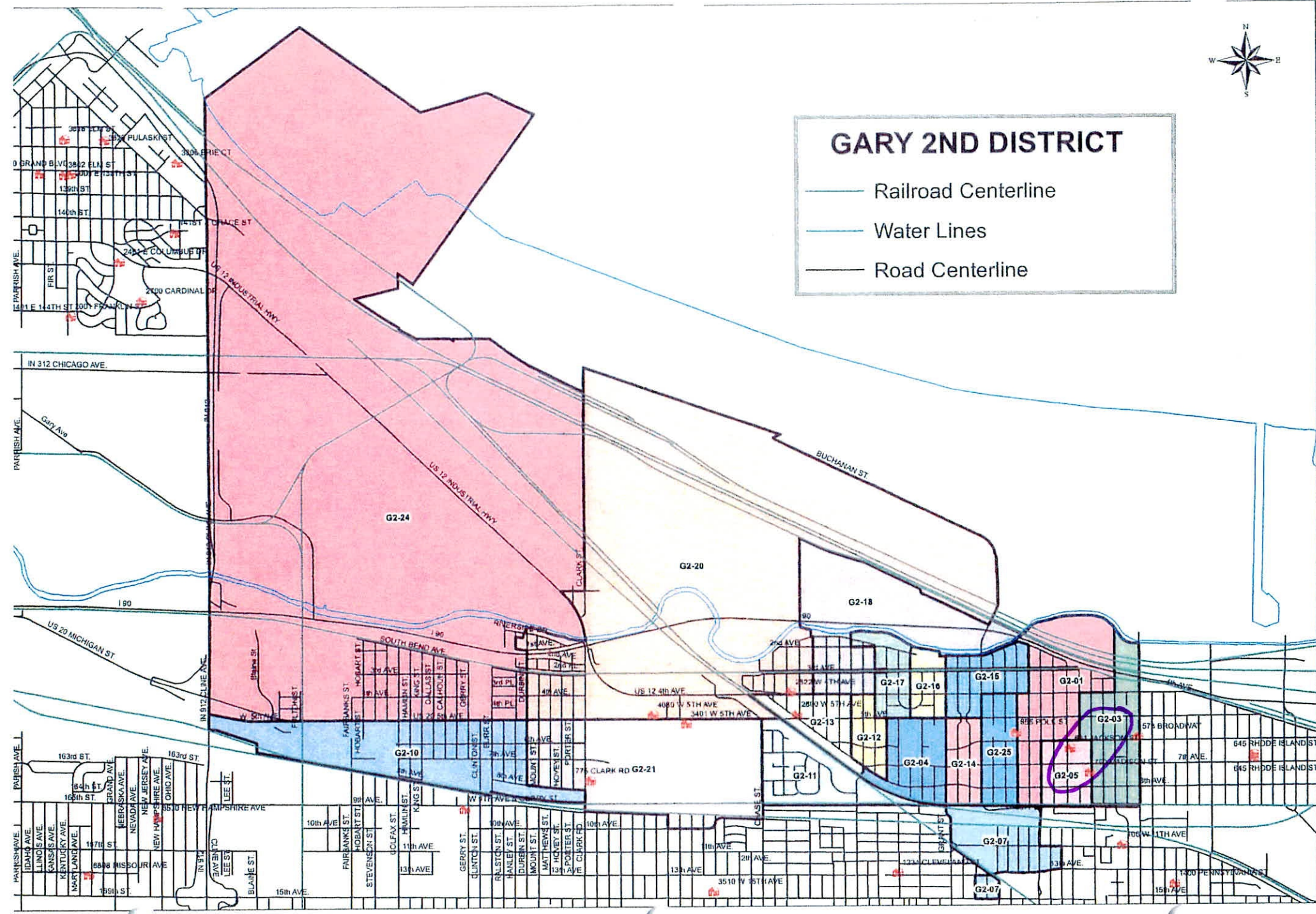

GARY PRECINCT

2-05

180890128003044
180890128003049
180890128003057
180890128003042
180890128003040
180890128003039
180890128003053
180890128003062
180890128003060
180890128003041
180890128003050
180890128003052
180890128003063
180890128003056
180890128003061
180890128003064
180890128003051
180890128003054
180890128003043
180890128003055

GARY PRECINCT

2-03

180890102052121
180890102052185
180890102052184
180890128003018
180890102051005
180890102051003
180890102051012
180890102051018
180890102051014
180890102051016
180890102051001
180890102051019
180890102051038
180890102052212
180890102052213
180890102051024
180890102051027
180890102051029
180890102051039
180890102051041
180890102051030
180890102051028
180890102051035
180890102051037
180890102051015
180890102051017
180890102051025
180890102051023
180890102051020
180890128003038
180890102051008
180890102051009
180890102051032
180890128003000
180890102051013
180890102051043
180890102051042
180890102051006

GARY PRAECINCT

2-03

- 180890128003019
- 180890102051011
- 180890102051007
- 180890128003037
- 180890102051040
- 180890128003001
- 180890128003017
- 180890102052186
- 180890102051034
- 180890102051000
- 180890102051033
- 180890102051031
- 180890102051004
- 180890102052183
- 180890102051036
- 180890102051022
- 180890102051021
- 180890102051010
- 180890102051002
- 180890128003020
- 180890102051026