



# PRECINCT SUMMARY STATEMENT

(IEC-8)

State Form 13332 (R7/7-06)

Indiana Election Commission (IC 3-11-1.5-15) Name of County LAKE

**INSTRUCTIONS:** See Indiana Code 3-11-1.5-25 for periods during which precinct boundary changes may NOT take effect.  
**Indiana Code 3-11-1.5-15 requires that a county include the following items in a proposed precinct establishment order submitted to the Indiana Election Division:**

1. A map of each precinct to be established by the proposed order. A county may submit these maps in electronic form.
2. A description of the boundaries of each precinct to be established by the proposed order that identifies any census blocks located entirely within the precinct.
3. An estimated number of voters in each precinct to be established by the proposed order, based on the registration records maintained by the county voter registration office.
4. A statement designating a polling place for the precinct that complies with the polling place accessibility requirements.
5. Any additional information required by rules adopted by the Indiana Election Commission under IC 4-22-2.

### General Precinct Information

1. Name Of Proposed Precinct <u>CT-6</u>		2. Is this a new precinct? <input checked="" type="checkbox"/> Yes <input type="checkbox"/> No		3. Election Division & STFID Number (To Be Completed By Election Division)	
4. District Information Congressional <u>1</u> Indiana Senate <u>6</u> Indiana House <u>19</u>					
5. Number Of Active Voters (IC 3-5-2-1.7) <u>1185</u>		6. Number Of Inactive Voters <u>66</u>		7. Number Of Registered Voters (Must Equal Total Of Active And Inactive Voters) <u>1251</u>	
8. Total Number Of Precincts In The County If Submission Is Approved Voting Precincts _____ Non-Voting Precincts _____					
9. Date Of County Executive's Adopted Order			10. Date Of First Election After Precincts Are Approved MAY 8, 2018		
11. Precincts Affected By This Proposed Order (Complete a Precinct Summary Statement for each precinct. Please note that when changing boundaries of one precinct you will need to complete a separate IEC-8 for any other precinct affected by the change.) <u>CT-2 + CT-6</u>					

12. List Any Attached Documents (i.e. map 6 of 20 maps, etc.)  
CENSUS BLOCK LISTING + MAPS

Does any portion of the newly established precinct split or divide any of the following?	Yes	No
13. School Corporation District Boundary		X
14. City or Town Boundary		X
15. City or Town Council District Boundary		X
16. Census Block Boundary		X
17. Other (Please Describe)		X

### Method of Voting

18.  Optical Scan Ballot Card  Electronic  Combination (Please Specify): \_\_\_\_\_

19. What is the designated location and address for the polling place for this precinct?  
LAKE CO. FAIR GROUNDS  
889 SOUTH COURT ST.  
CROWN POINT, IN  
 (NOTE: This designation of a polling place remains in effect until later action by the county executive under state law.)

20. Does this polling place meet Indiana's polling place accessibility requirements?  Yes  No

### Precinct Change Reason

21. Briefly state the reason for the precinct change. (Attach additional sheet if necessary.)  
SENATE BILL 220 - COMBINE CT-6 + CT-2

### Additional Information

22. Name and Contact Information Of County Election Staff Person Who Prepared This Form:  
GENNY GASPAROVIC 219-755-3812

23. Does the county have access to Geographic Information System (GIS)?  Yes  No  
 Name and Contact Information Of County GIS Staff: Annette Mellady 219-755-3795

24. Does the county use Census Tiger files?  Yes  No

### State Office Use Only

25. Type Of Geographic Files Used by County (If Known By Staff Of The Indiana Election Division Or Office Of Census Data)

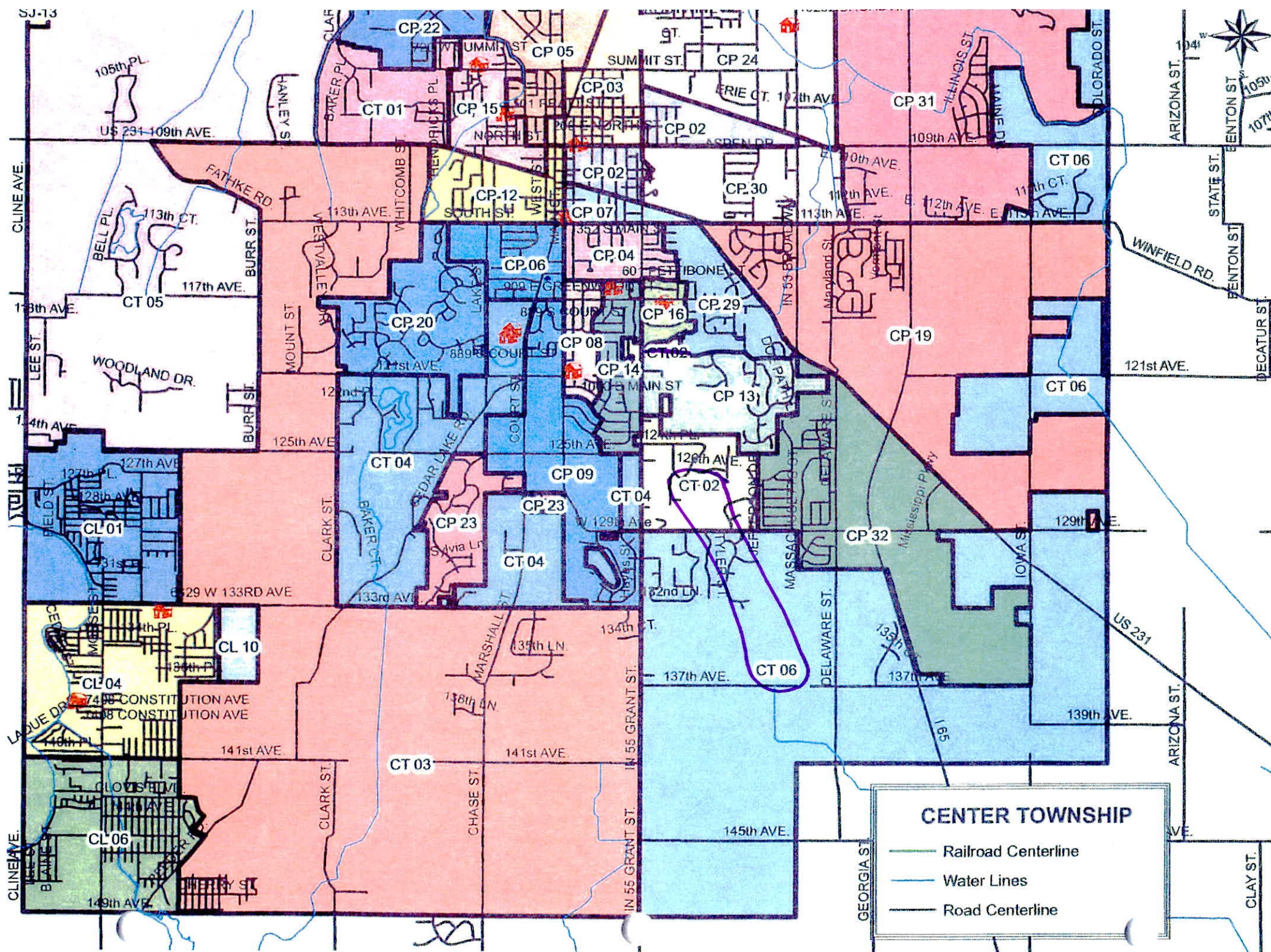

SJ-13



Map labels include street names such as Cline Ave, US 231-109th Ave, 105th Pl, 113th Ct, 117th Ave, 119th Ave, 121st Ave, 125th Ave, 127th Ave, 128th Ave, 131st Ave, 133rd Ave, 134th Ct, 135th Ln, 137th Ave, 139th Ave, 141st Ave, 145th Ave, 149th Ave, 104th St, 105th St, 107th St, State St, Benton St, Decatur St, Winfield Rd, Fathke Rd, Burr St, Mount St, Vestal St, Whitcomb St, West St, Main St, Court St, Marshall St, Chase St, Clark St, In 55 Grant St, Delaware St, Iowa St, Georgia St, and Clay St.

Map labels also include parcel identifiers such as CP 01, CP 02, CP 03, CP 04, CP 05, CP 06, CP 07, CP 08, CP 09, CP 10, CP 12, CP 13, CP 14, CP 15, CP 16, CP 19, CP 20, CP 22, CP 23, CP 24, CP 29, CP 30, CP 31, CP 32, CT 01, CT 02, CT 03, CT 04, CT 05, CT 06, CL 01, CL 04, CL 06, and CL 10.

Map labels also include landmarks such as Woodland Dr, Cedar Lake Rd, and Mississippi Park.

---

CENTER TOWNSHIP  
PRECINCT 02

180890431022008

180890431022038

180890432021093

180890432022044

180890432022045

180890432022046

---

CENTER TOWNSHIP  
PRECINCT 06

180890432021038  
180890432021039  
180890432021025  
180890432022007  
180890432022094  
180890432022092  
180890432022062  
180890432021024  
180890432022079  
180890432022004  
180890432022002  
180890432022086  
180890432021022  
180890432022003  
180890432022091  
180890432022071  
180890432022096  
180890432022070  
180890432022069  
180890432022098  
180890432022077  
180890432022061  
180890432022095  
180890432022088  
180890432022090  
180890432022080  
180890432022011  
180890432022097  
180890432022085  
180890432022060  
180890432022008  
180890432022089  
180890432021023  
180890432022093  
180890432021000  
180890432022006  
180890432022005  
180890432022005  
180890432022006  
180890432022006  
180890432022006