



PRECINCT SUMMARY STATEMENT

(IEC-8)

State Form 13332 (R7/7-06)

Indiana Election Commission (IC 3-11-1.5-15) Name of County LAKE

INSTRUCTIONS: See Indiana Code 3-11-1.5-25 for periods during which precinct boundary changes may NOT take effect.
 Indiana Code 3-11-1.5-15 requires that a county include the following items in a proposed precinct establishment order submitted to the Indiana Election Division:

1. A map of each precinct to be established by the proposed order. A county may submit these maps in electronic form.
2. A description of the boundaries of each precinct to be established by the proposed order that identifies any census blocks located entirely within the precinct.
3. An estimated number of voters in each precinct to be established by the proposed order, based on the registration records maintained by the county voter registration office.
4. A statement designating a polling place for the precinct that complies with the polling place accessibility requirements.
5. Any additional information required by rules adopted by the Indiana Election Commission under IC 4-22-2.

General Precinct Information

1. Name Of Proposed Precinct <u>CP-29</u>		2. Is this a new precinct? <input checked="" type="checkbox"/> Yes <input type="checkbox"/> No		3. Election Division & STFID Number (To Be Completed By Election Division)	
4. District Information Congressional <u>1</u> Indiana Senate <u>6</u> Indiana House <u>19</u>					
5. Number Of Active Voters (IC 3-5-2-1.7) <u>1065</u>		6. Number Of Inactive Voters <u>166</u>		7. Number Of Registered Voters (Must Equal Total Of Active And Inactive Voters) <u>1231</u>	
8. Total Number Of Precincts In The County If Submission Is Approved Voting Precincts _____ Non-Voting Precincts _____					
9. Date Of County Executive's Adopted Order			10. Date Of First Election After Precincts Are Approved MAY 8, 2018		

11. Precincts Affected By This Proposed Order (Complete a Precinct Summary Statement for each precinct. Please note that when changing boundaries of one precinct you will need to complete a separate IEC-8 for any other precinct affected by the change.)

CROWN POINT-29 & CROWN POINT-16

12. List Any Attached Documents (i.e. map 6 of 20 maps, etc.)
CENSUS BLOCK LISTING AND MAPS

Does any portion of the newly established precinct split or divide any of the following?	Yes	No
13. School Corporation District Boundary		X
14. City or Town Boundary		X
15. City or Town Council District Boundary		X
16. Census Block Boundary		X
17. Other (Please Describe)		X

Method of Voting

18. Optical Scan Ballot Card Electronic Combination (Please Specify): _____

19. What is the designated location and address for the polling place for this precinct?
FIRST CHRISTIAN REFORMED CHURCH
909 E. GREENWOOD ST.
CROWN POINT, IN
 (NOTE: This designation of a polling place remains in effect until later action by the county executive under state law.)

20. Does this polling place meet Indiana's polling place accessibility requirements? Yes No

Precinct Change Reason

21. Briefly state the reason for the precinct change. (Attach additional sheet if necessary.)
SENATE BILL 220 - COMBINING CP-29 & CP-16

Additional Information

22. Name and Contact Information Of County Election Staff Person Who Prepared This Form:
GENNY GASPAROVIC 219-755-3812

23. Does the county have access to Geographic Information System (GIS)? Yes No
 Name and Contact Information Of County GIS Staff: Annette Mellady 219-755-3795

24. Does the county use Census Tiger files? Yes No

State Office Use Only

25. Type Of Geographic Files Used by County (If Known By Staff Of The Indiana Election Division Or Office Of Census Data)

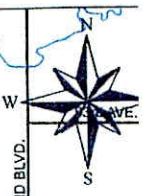

CROWN POINT

-  Railroad Centerline
-  Water Lines
-  Road Centerline

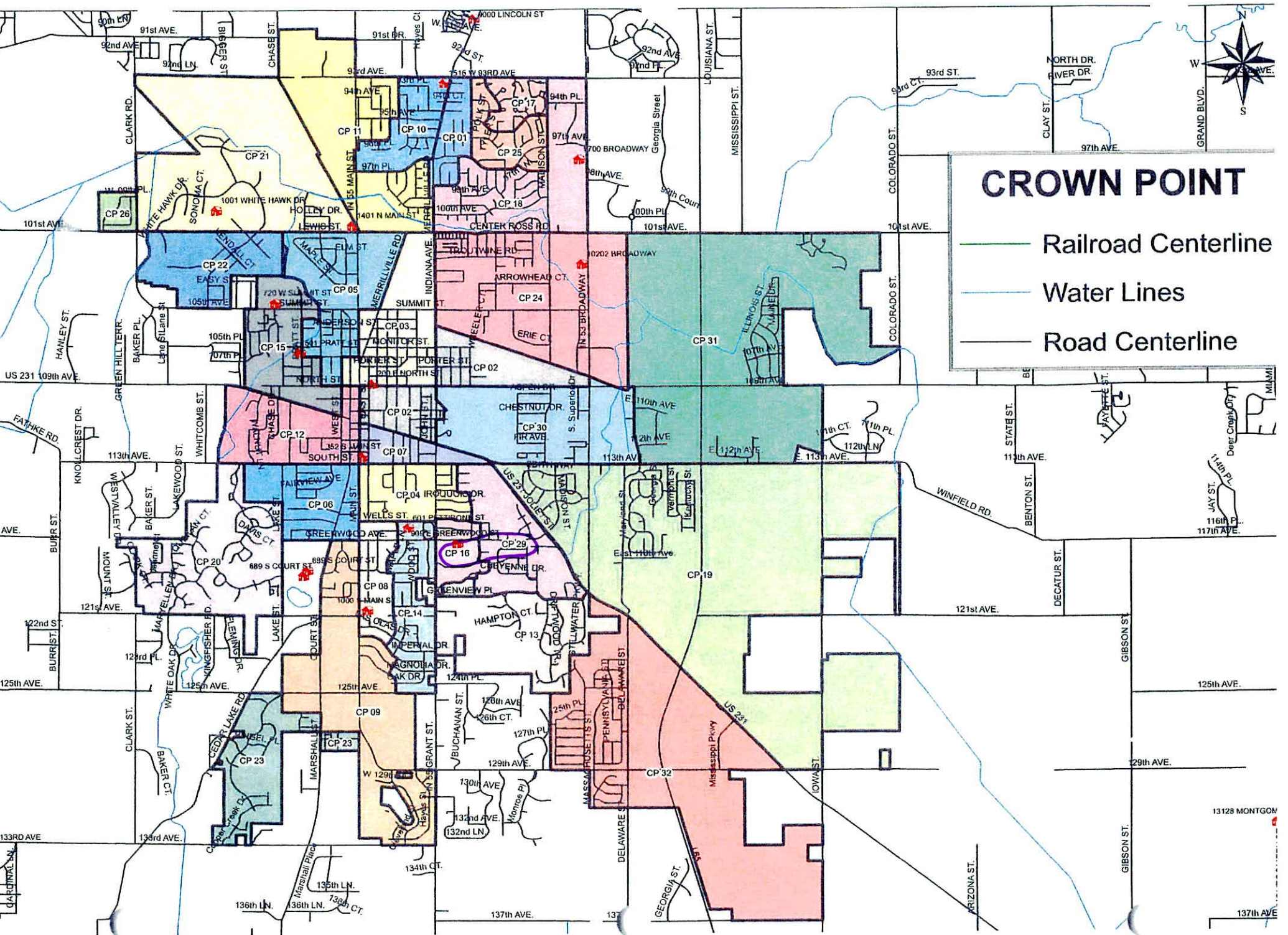

CROWN POINT
PRECINCT 16

180890432021094
180890432021079
180890432021083
180890432021085
180890432021078
180890432021084
180890432021056
180890432021077
180890432021075
180890432021076

CROWN POINT
PRECINCT 29

180890432021080
180890432021082
180890432021090
180890432021081
180890432021055
180890432021053
180890432021086
180890432021057
180890432021091
180890432021054
180890432021095
180890432021092
180890432021088
180890432021089
180890432021098
