



PRECINCT SUMMARY STATEMENT

(IEC-8)

State Form 13332 (R7/7-06)

Indiana Election Commission (IC 3-11-1.5-15) Name of County LAKE

INSTRUCTIONS: See Indiana Code 3-11-1.5-25 for periods during which precinct boundary changes may NOT take effect. Indiana Code 3-11-1.5-15 requires that a county include the following items in a proposed precinct establishment order submitted to the Indiana Election Division:

1. A map of each precinct to be established by the proposed order. A county may submit these maps in electronic form.
2. A description of the boundaries of each precinct to be established by the proposed order that identifies any census blocks located entirely within the precinct.
3. An estimated number of voters in each precinct to be established by the proposed order, based on the registration records maintained by the county voter registration office.
4. A statement designating a polling place for the precinct that complies with the polling place accessibility requirements.
5. Any additional information required by rules adopted by the Indiana Election Commission under IC 4-22-2.

General Precinct Information

1. Name Of Proposed Precinct <u>CP-4</u>	2. Is this a new precinct? <input checked="" type="checkbox"/> Yes <input type="checkbox"/> No	3. Election Division & STFID Number (To Be Completed By Election Division)
---	---	---

4. District Information
 Congressional 1 Indiana Senate 6 Indiana House 19

5. Number Of Active Voters (IC 3-5-2-1.7) <u>1035</u>	6. Number Of Inactive Voters <u>170</u>	7. Number Of Registered Voters (Must Equal Total Of Active And Inactive Voters) <u>1205</u>
--	--	--

8. Total Number Of Precincts In The County If Submission Is Approved
 _____ Voting Precincts _____ Non-Voting Precincts

9. Date Of County Executive's Adopted Order	10. Date Of First Election After Precincts Are Approved <u>MAY 8, 2018</u>
---	---

11. Precincts Affected By This Proposed Order (Complete a Precinct Summary Statement for each precinct. Please note that when changing boundaries of one precinct you will need to complete a separate IEC-8 for any other precinct affected by the change.)

CROWN POINT - 4 & CROWN POINT - 7

12. List Any Attached Documents (i.e. map 6 of 20 maps, etc.)

CENSUS BLOCK LISTING AND MAPS

Does any portion of the newly established precinct split or divide any of the following?	Yes	No
13. School Corporation District Boundary		X
14. City or Town Boundary		X
15. City or Town Council District Boundary		X
16. Census Block Boundary		X
17. Other (Please Describe)		X

Method of Voting

18. Optical Scan Ballot Card Electronic Combination (Please Specify): _____

19. What is the designated location and address for the polling place for this precinct?
SOLON ROBINSON SCHOOL
601 PETTIBONE ST.
CROWN POINT, IN
 (NOTE: This designation of a polling place remains in effect until later action by the county executive under state law.)

20. Does this polling place meet Indiana's polling place accessibility requirements? Yes No

Precinct Change Reason

21. Briefly state the reason for the precinct change. (Attach additional sheet if necessary.)
SENATE BILL 220 - COMBINING CP-4 & CP-7

Additional Information

22. Name and Contact Information Of County Election Staff Person Who Prepared This Form:
GENNY GASPAROVIC 219-755-3812

23. Does the county have access to Geographic Information System (GIS)? Yes No
 Name and Contact Information Of County GIS Staff: Annette Mellady 219-755-3795



24. Does the county use Census Tiger files? Yes No

State Office Use Only

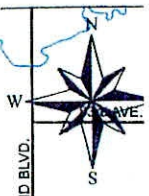
25. Type Of Geographic Files Used by County (If Known By Staff Of The Indiana Election Division Or Office Of Census Data)



CROWN POINT

-  Railroad Centerline
-  Water Lines
-  Road Centerline

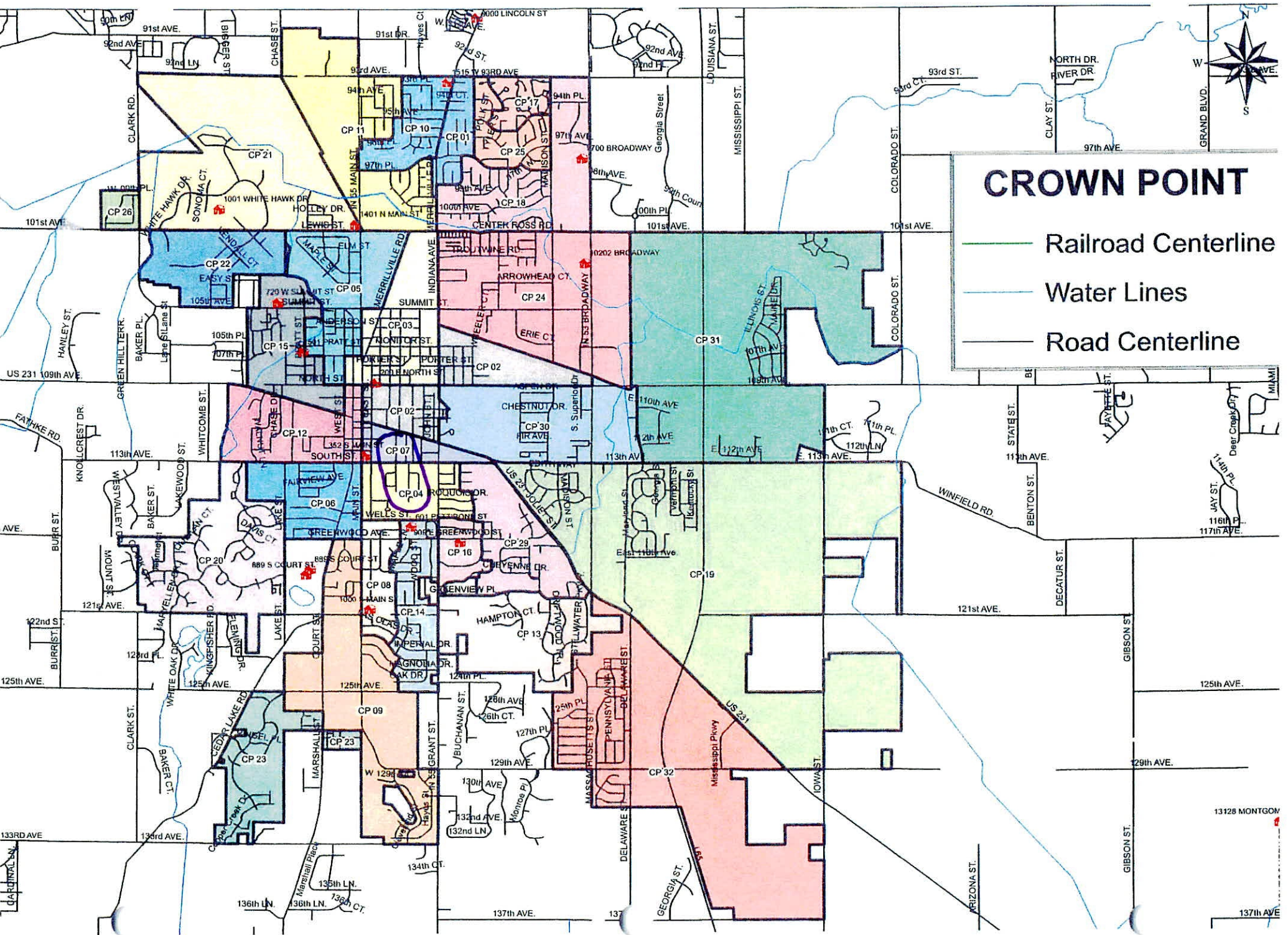

13128 MONTGOM

137th AVE

CROWN POINT
PRECINCT 04

180890432021058
180890432021061
180890432021060
180890431022000
180890431022001
180890432021063
180890431022002
180890432021069
180890432021067
180890432021074
180890432021065
180890432021064
180890432021062
180890432021068
180890432021073
180890431022003
180890432021059

CROWN POINT
PRECINCT 07

180890430023032

180890430023034

180890430023060

180890430023059

180890430023063

180890430023024

180890430023023

180890430023022

180890430023021

180890430023029

180890430023031

180890430023030

180890430023058

180890430023033
