



PRECINCT SUMMARY STATEMENT

(IEC-8)

State Form 13332 (R7/7-06)

Indiana Election Commission (IC 3-11-1.5-15) Name of County LAKE

INSTRUCTIONS: See Indiana Code 3-11-1.5-25 for periods during which precinct boundary changes may NOT take effect.
 Indiana Code 3-11-1.5-15 requires that a county include the following items in a proposed precinct establishment order submitted to the Indiana Election Division:

1. A map of each precinct to be established by the proposed order. A county may submit these maps in electronic form.
2. A description of the boundaries of each precinct to be established by the proposed order that identifies any census blocks located entirely within the precinct.
3. An estimated number of voters in each precinct to be established by the proposed order, based on the registration records maintained by the county voter registration office.
4. A statement designating a polling place for the precinct that complies with the polling place accessibility requirements.
5. Any additional information required by rules adopted by the Indiana Election Commission under IC 4-22-2.

General Precinct Information

1. Name Of Proposed Precinct <u>MER 12</u>		2. Is this a new precinct? <input checked="" type="checkbox"/> Yes <input type="checkbox"/> No	3. Election Division & STFID Number <i>(To Be Completed By Election Division)</i>
4. District Information Congressional <u>1</u> Indiana Senate <u>3</u> Indiana House <u>19</u>			
5. Number Of Active Voters (IC 3-5-2-1.7) <u>1234</u>	6. Number Of Inactive Voters <u>131</u>	7. Number Of Registered Voters (Must Equal Total Of Active And Inactive Voters) <u>1365</u>	
8. Total Number Of Precincts In The County If Submission Is Approved Voting Precincts _____ Non-Voting Precincts _____			
9. Date Of County Executive's Adopted Order		10. Date Of First Election After Precincts Are Approved MAY 8, 2018	
11. Precincts Affected By This Proposed Order (Complete a Precinct Summary Statement for each precinct. Please note that when changing boundaries of one precinct you will need to complete a separate IEC-8 for any other precinct affected by the change.) <u>MER 12 & MER 24</u>			

12. List Any Attached Documents (i.e. map 6 of 20 maps, etc.) CENSUS BLOCK LISTING AND MAPS

Does any portion of the newly established precinct split or divide any of the following?	Yes	No
13. School Corporation District Boundary		X
14. City or Town Boundary		X
15. City or Town Council District Boundary		X
16. Census Block Boundary		X
17. Other (Please Describe)		X

Method of Voting

18. Optical Scan Ballot Card Electronic Combination (Please Specify): _____

19. What is the designated location and address for the polling place for this precinct?
TRINITY FREE METHODIST CHURCH
8650 GRAND BLVD
MERRILLVILLE IN 46410
 (NOTE: This designation of a polling place remains in effect until later action by the county executive under state law.)

20. Does this polling place meet Indiana's polling place accessibility requirements? Yes No

Precinct Change Reason

21. Briefly state the reason for the precinct change. (Attach additional sheet if necessary.)
SENATE BILL 220 COMBINING MER 12 & MER 24

Additional Information

22. Name and Contact Information Of County Election Staff Person Who Prepared This Form:
GENNY GASPAROVIC 219-755-3812

23. Does the county have access to Geographic Information System (GIS)? Yes No
 Name and Contact Information Of County GIS Staff: Annette Mellady 219-755-3795

24. Does the county use Census Tiger files? Yes No

State Office Use Only

25. Type Of Geographic Files Used by County (If Known By Staff Of The Indiana Election Division Or Office Of Census Data)

MERRILLVILLE

-  Railroad Centerline
-  Water Lines
-  Road Centerline

PREPARED BY
LAKE COUNTY BOARD OF
ELECTIONS & REGISTRATION
FOR REFERENCE ONLY

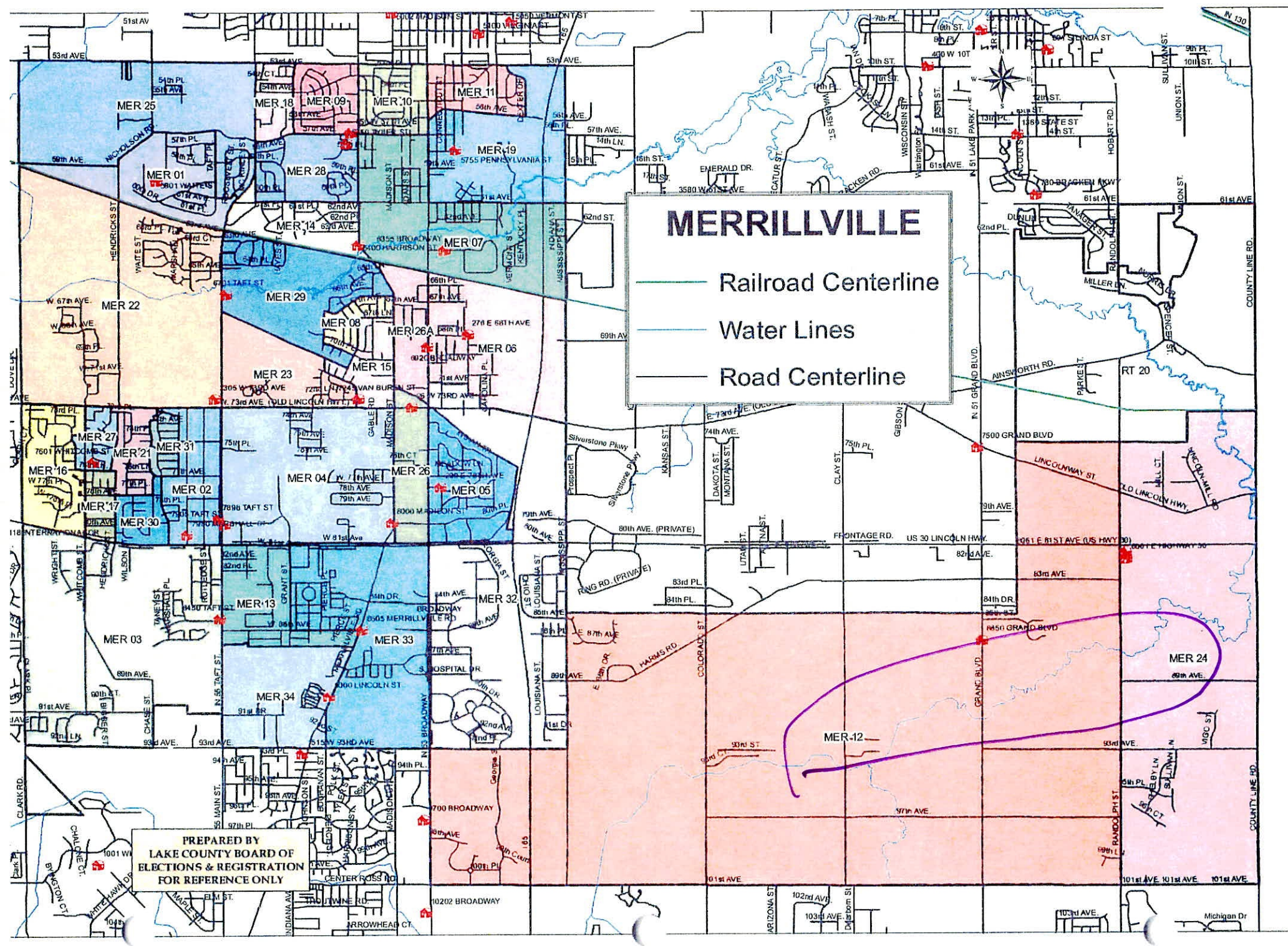

MERRILLVILLE
PRECINCT 12

180890423002059
180890423001015
180890423001046
180890423001044
180890423001077
180890423003062
180890423001038
180890423001047
180890423001048
180890423001078

(1)

MERRILLVILLE
PRECINCT 12

- 180890423001079
- 180890423002060
- 180890423001037
- 180890423001041
- 180890423001053
- 180890423001050
- 180890423001052
- 180890423001069
- 180890423001071
- 180890423001054
- 180890423001022
- 180890423001055
- 180890423001056
- 180890423001072
- 180890423001073
- 180890423001059
- 180890423001057
- 180890423001082
- 180890423001036
- 180890423001042
- 180890423001039
- 180890423003090
- 180890423001033
- 180890423001051
- 180890423001045
- 180890423001034
- 180890423001032
- 180890425043001
- 180890423003086
- 180890423001080
- 180890425043000
- 180890423003077
- 180890423003085
- 180890423001058
- 180890423001023
- 180890423001031
- 180890423001068
- 180890423001060
- 180890423001070
- 180890423001030
- 180890423001049

- 180890423003089
- 180890423001043
- 180890423001040
- 180890423001003

MERRILLVILLE
PRECINCT 24

180890423001018
180890423001063
180890423001074
180890423001066
180890423002066
180890423002070
180890423001017
180890423002065
180890423001001
180890423001062
180890423001019
180890423001061
180890423001000
180890423001064
180890423001016
180890423002071
180890423001021
180890423001067
180890423001020
180890423001075
180890423001002
180890423001065
180890423002072
180890423001076