



PRECINCT SUMMARY STATEMENT

(IEC-8)

State Form 13332 (R7/7-06)

Indiana Election Commission (IC 3-11-1.5-15)

Name of County LAKE

INSTRUCTIONS: See Indiana Code 3-11-1.5-25 for periods during which precinct boundary changes may NOT take effect.
 Indiana Code 3-11-1.5-15 requires that a county include the following items in a proposed precinct establishment order submitted to the Indiana Election Division:

1. A map of each precinct to be established by the proposed order. A county may submit these maps in electronic form.
2. A description of the boundaries of each precinct to be established by the proposed order that identifies any census blocks located entirely within the precinct.
3. An estimated number of voters in each precinct to be established by the proposed order, based on the registration records maintained by the county voter registration office.
4. A statement designating a polling place for the precinct that complies with the polling place accessibility requirements.
5. Any additional information required by rules adopted by the Indiana Election Commission under IC 4-22-2.

General Precinct Information

1. Name Of Proposed Precinct <u>MER 5</u>	2. Is this a new precinct? <input checked="" type="checkbox"/> Yes <input type="checkbox"/> No	3. Election Division & STFID Number (To Be Completed By Election Division)
--	---	---

4. District Information
 Congressional 1 Indiana Senate 2 Indiana House 14

5. Number Of Active Voters (IC 3-5-2-1.7) <u>1220</u>	6. Number Of Inactive Voters <u>237</u>	7. Number Of Registered Voters (Must Equal Total Of Active And Inactive Voters) <u>1454</u>
--	--	--

8. Total Number Of Precincts In The County If Submission Is Approved

Voting Precincts	Non-Voting Precincts
------------------	----------------------

9. Date Of County Executive's Adopted Order	10. Date Of First Election After Precincts Are Approved <u>MAY 8, 2018</u>
---	---

11. Precincts Affected By This Proposed Order (Complete a Precinct Summary Statement for each precinct. Please note that when changing boundaries of one precinct you will need to complete a separate IEC-8 for any other precinct affected by the change.)
MER 5 + MER 6 + MER 26

12. List Any Attached Documents (i.e. map 6 of 20 maps, etc.)
CENSUS BLOCK LISTING AND MAPS

Does any portion of the newly established precinct split or divide any of the following?	Yes	No
13. School Corporation District Boundary		X
14. City or Town Boundary		X
15. City or Town Council District Boundary		X
16. Census Block Boundary		X
17. Other (Please Describe)		X

Method of Voting

18. Optical Scan Ballot Card Electronic Combination (Please Specify): _____

19. What is the designated location and address for the polling place for this precinct?
ST. JOAN OF ARC HALL
200 E. 78th AVE
MERRILLVILLE, IN 46410
 (NOTE: This designation of a polling place remains in effect until later action by the county executive under state law.)

20. Does this polling place meet Indiana's polling place accessibility requirements? Yes No

Precinct Change Reason

21. Briefly state the reason for the precinct change. (Attach additional sheet if necessary.)
SENATE BILL 220 COMBINING MER 5 + MER 6 + MER 26

Additional Information

22. Name and Contact Information Of County Election Staff Person Who Prepared This Form:
GENNY GASPAROVIC 219-755-3812

23. Does the county have access to Geographic Information System (GIS)? Yes No
 Name and Contact Information Of County GIS Staff: Annette Mellady 219-755-3795

24. Does the county use Census Tiger files? Yes No

State Office Use Only

25. Type Of Geographic Files Used by County (If Known By Staff Of The Indiana Election Division Or Office Of Census Data)

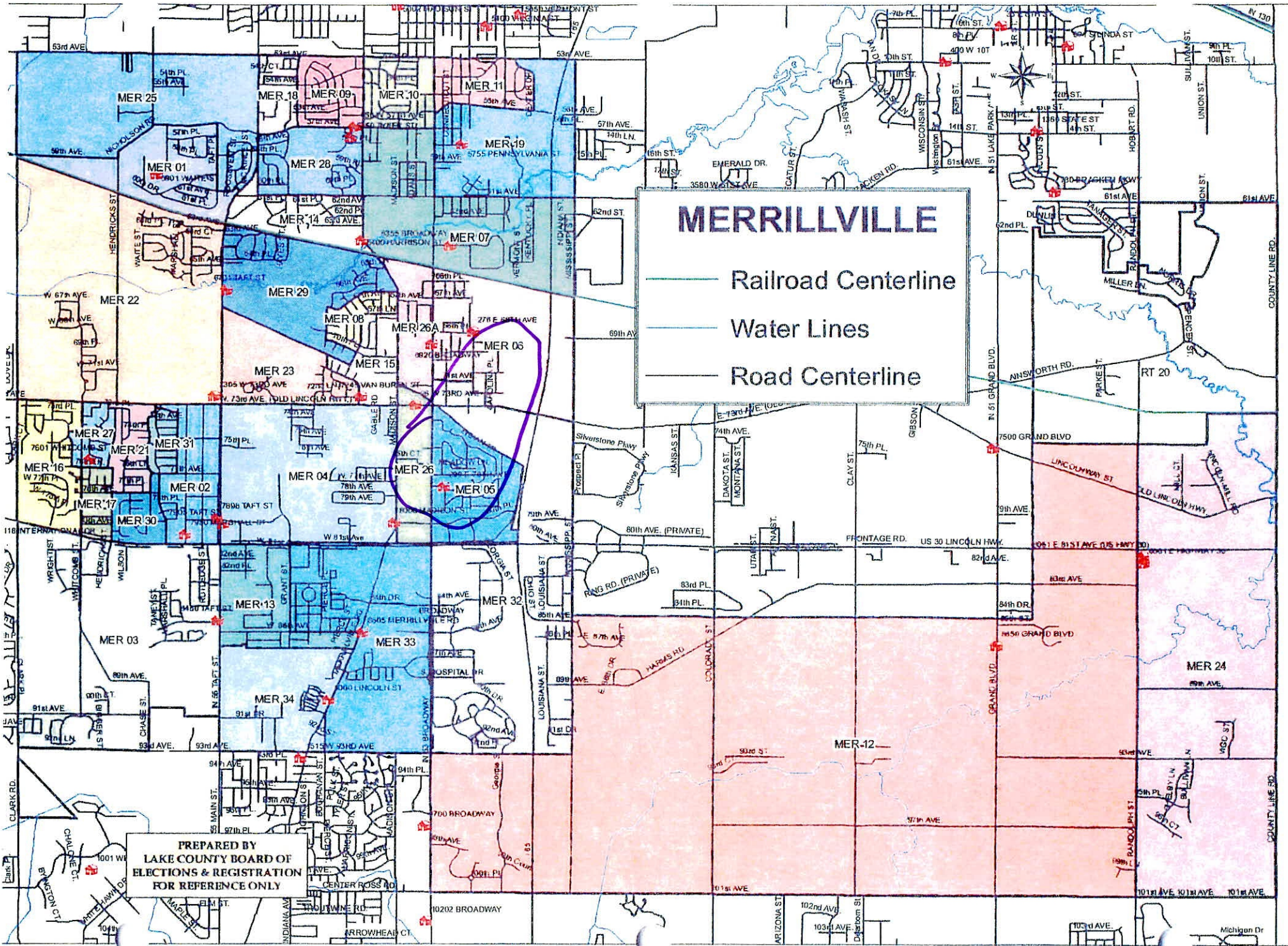

MERRILLVILLE

- Railroad Centerline
- Water Lines
- Road Centerline

PREPARED BY
LAKE COUNTY BOARD OF
ELECTIONS & REGISTRATION
FOR REFERENCE ONLY

MERRILLVILLE
PRECINCT 05

180890425031012

180890425031050

180890425031051

180890425031052

180890425031004

180890425031003

180890425031011

180890425031010

180890425031009

180890425031048

180890425031061

180890425031039

180890425031055

180890425031044

180890425031042

180890425031049

180890425031045

180890423003045

180890425031037

180890425031038

180890425031036

180890425031056

180890425031001

180890425031002

180890425031046

180890425031040

180890425031047

180890425031043

180890425031054

180890425031053

MERRILLVILLE
PRECINCT 06

- 180890424024016
- 180890424024017
- 180890424024021
- 180890424024012
- 180890424024004
- 180890424024005
- 180890424024001
- 180890424024007
- 180890424024008
- 180890423003022
- 180890424024011
- 180890424024020
- 180890424024018
- 180890424024002
- 180890424024014
- 180890424024009
- 180890424024015
- 180890424024006
- 180890424024013
- 180890424024010
- 180890424024000
- 180890423003013
- 180890424024003
- 180890424024019
- 180890424024022
- 180890423003014

MERRILLVILLE
PRECINCT 26

180890425031014

180890425031029

180890425031005

180890424023025

180890425031006

180890425031015

180890424023026

180890424023010

180890425031013