



PRECINCT SUMMARY STATEMENT

(IEC-8)

State Form 13332 (R7/7-06)

Indiana Election Commission (IC 3-11-1.5-15) Name of County LAKE

INSTRUCTIONS: See Indiana Code 3-11-1.5-25 for periods during which precinct boundary changes may NOT take effect.
Indiana Code 3-11-1.5-15 requires that a county include the following items in a proposed precinct establishment order submitted to the Indiana Election Division:

1. A map of each precinct to be established by the proposed order. A county may submit these maps in electronic form.
2. A description of the boundaries of each precinct to be established by the proposed order that identifies any census blocks located entirely within the precinct.
3. An estimated number of voters in each precinct to be established by the proposed order, based on the registration records maintained by the county voter registration office.
4. A statement designating a polling place for the precinct that complies with the polling place accessibility requirements.
5. Any additional information required by rules adopted by the Indiana Election Commission under IC 4-22-2.

General Precinct Information

1. Name Of Proposed Precinct <u>LS 13</u>		2. Is this a new precinct? <input checked="" type="checkbox"/> Yes <input type="checkbox"/> No	3. Election Division & STFID Number (To Be Completed By Election Division)
4. District Information Congressional <u>1</u> Indiana Senate <u>3</u> Indiana House <u>3</u>			
5. Number Of Active Voters (IC 3-5-2-1.7) <u>874</u>	6. Number Of Inactive Voters <u>117</u>	7. Number Of Registered Voters (Must Equal Total Of Active And Inactive Voters) <u>991</u>	
8. Total Number Of Precincts In The County If Submission Is Approved Voting Precincts _____ Non-Voting Precincts _____			
9. Date Of County Executive's Adopted Order		10. Date Of First Election After Precincts Are Approved <u>MAY 8, 2018</u>	
11. Precincts Affected By This Proposed Order (Complete a Precinct Summary Statement for each precinct. Please note that when changing boundaries of one precinct you will need to complete a separate IEC-8 for any other precinct affected by the change.) <u>LS 13 & LS 3</u>			

12. List Any Attached Documents (i.e. map 6 of 20 maps, etc.) CENSUS BLOCK LISTING AND MAPS

Does any portion of the newly established precinct split or divide any of the following?	Yes	No
13. School Corporation District Boundary		X
14. City or Town Boundary		X
15. City or Town Council District Boundary		X
16. Census Block Boundary		X
17. Other (Please Describe)		X

Method of Voting

18. Optical Scan Ballot Card Electronic Combination (Please Specify): _____

19. What is the designated location and address for the polling place for this precinct?
EDISON HIGH SCHOOL
3304 PARKSIDE AVE.
LAKE STATION, IN 46405
 (NOTE: This designation of a polling place remains in effect until later action by the county executive under state law.)

20. Does this polling place meet Indiana's polling place accessibility requirements? Yes No

Precinct Change Reason

21. Briefly state the reason for the precinct change. (Attach additional sheet if necessary.)
SENATE BILL 220 COMBINING LS 13 & LS 3

Additional Information

22. Name and Contact Information Of County Election Staff Person Who Prepared This Form:
GENNY GASPAROVIC 219-755-3812

23. Does the county have access to Geographic Information System (GIS)? Yes No
 Name and Contact Information Of County GIS Staff: Annette Mellady 219-755-3795

24. Does the county use Census Tiger files? Yes No

State Office Use Only

25. Type Of Geographic Files Used by County (If Known By Staff Of The Indiana Election Division Or Office Of Census Data)

LAKE STATION

— Railroad Centerline

— Water Lines

— Road Centerline

PREPARED BY
LAKE COUNTY BOARD OF
ELECTIONS & REGISTRATION
FOR REFERENCE ONLY

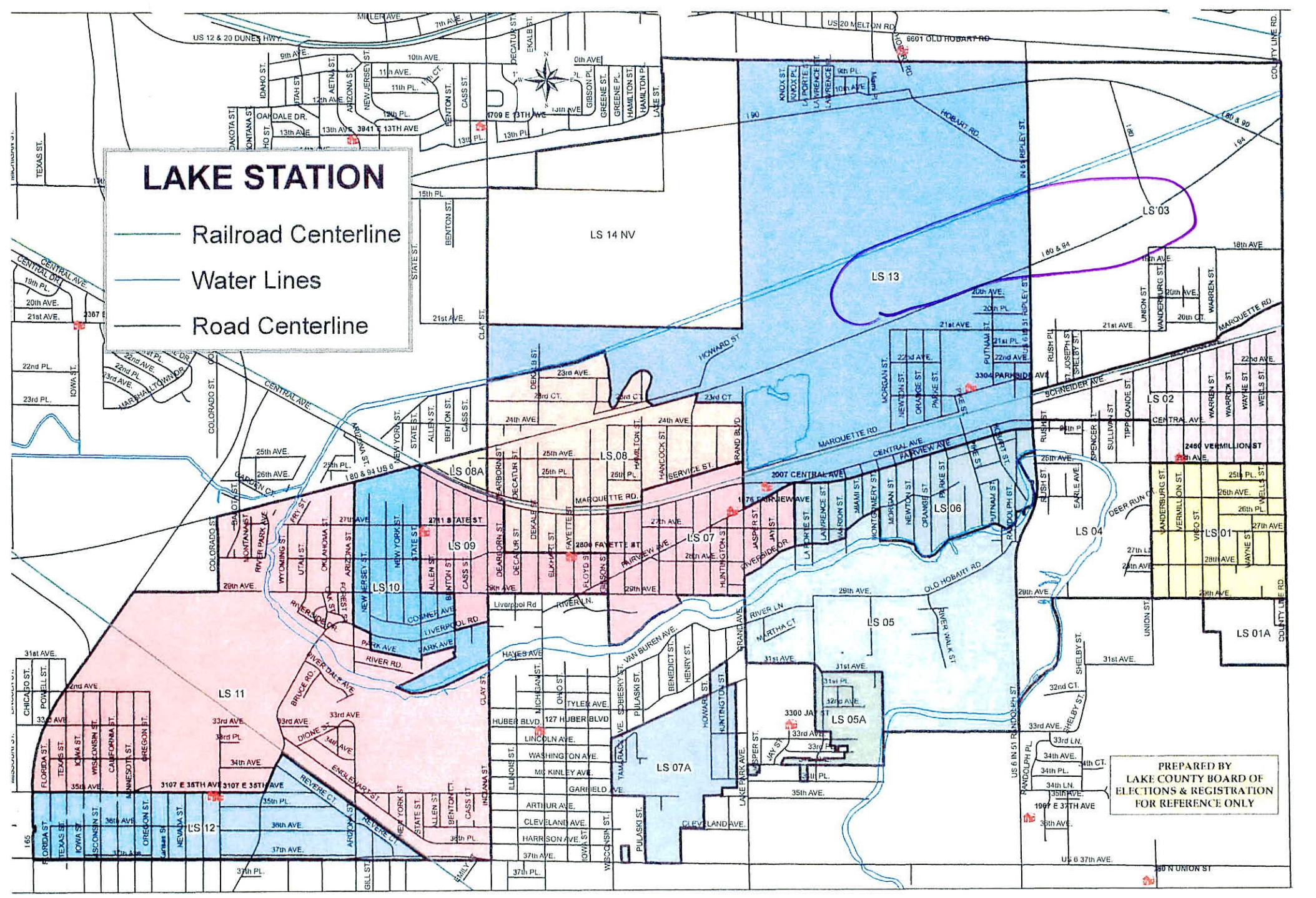

LAKE STATION
PRECINCT 03

①

180890418001024
180890418001065
180890418001032
180890418001036
180890418001037
180890418001015
180890418001054
180890418001053
180890418001056
180890418001013
180890418001057
180890418001020
180890418001042
180890418001025
180890418001021
180890418001000
180890418001009
180890418001030
180890418001035
180890418001023
180890418001062
180890418001051
180890418001019
180890418001018
180890418001067
180890418001017
180890418001002
180890418001048
180890418001016
180890418001046

LAKE STATION
PRECINCT 03

180890418001047
180890418001039
180890418001033
180890418001011
180890418001012
180890418001010
180890418001034
180890418001038
180890418001001
180890418001027
180890418001028
180890418001003
180890418001004
180890418001049
180890418001006
180890418001050
180890418001029
180890418001055
180890418001008
180890418001026
180890418001063
180890418001064
180890418001031
180890418001014
180890418001005
180890418001058
180890418001066
180890418001007
180890418001040
180890418001052
180890418001022

©

LAKE STATION
PRECINCT 13

180890417001018
180890418006032
180890418006008
180890418006004
180890418006006
180890418006005
180890417001021
180890417001022
180890417001047
180890417001025
180890417001055
180890417001053
180890417001054
180890417001030
180890417001015
180890417001012
180890417001005
180890417001023
180890417001006
180890417001003
180890417001007

①

LAKE STATION
PRECINCT 13

- 180890417001008
- 180890417001000
- 180890417001058
- 180890417001057
- 180890417001050
- 180890417001060
- 180890417001068
- 180890417002001
- 180890418006003
- 180890418006000
- 180890418006001
- 180890418006010
- 180890417001009
- 180890417001027
- 180890417001056
- 180890417001031
- 180890417001001
- 180890417001028
- 180890417001052
- 180890417001051
- 180890417001013
- 180890417001062
- 180890417001061
- 180890417001049
- 180890417001004
- 180890417001026
- 180890417001059
- 180890418006009
- 180890418006007
- 180890417001024
- 180890417001034
- 180890417002002
- 180890417001063
- 180890417001048
- 180890418006002
- 180890417001002
- 180890417001014
- 180890417002000
- 180890417001029