



# PRECINCT SUMMARY STATEMENT

(IEC-8)

State Form 13332 (R7/7-06)

Indiana Election Commission (IC 3-11-1.5-15) Name of County LAKE

**INSTRUCTIONS:** See Indiana Code 3-11-1.5-25 for periods during which precinct boundary changes may NOT take effect.  
 Indiana Code 3-11-1.5-15 requires that a county include the following items in a proposed precinct establishment order submitted to the Indiana Election Division:

1. A map of each precinct to be established by the proposed order. A county may submit these maps in electronic form.
2. A description of the boundaries of each precinct to be established by the proposed order that identifies any census blocks located entirely within the precinct.
3. An estimated number of voters in each precinct to be established by the proposed order, based on the registration records maintained by the county voter registration office.
4. A statement designating a polling place for the precinct that complies with the polling place accessibility requirements.
5. Any additional information required by rules adopted by the Indiana Election Commission under IC 4-22-2.

### General Precinct Information

1. Name Of Proposed Precinct LS 11      2. Is this a new precinct?  Yes  No      3. Election Division & STFID Number (To Be Completed By Election Division)

4. District Information  
 Congressional 1      Indiana Senate 3      Indiana House 3

5. Number Of Active Voters (IC 3-5-2-1.7) 1172      6. Number Of Inactive Voters 136      7. Number Of Registered Voters (Must Equal Total Of Active And Inactive Voters) 1308

8. Total Number Of Precincts In The County If Submission Is Approved  
 Voting Precincts \_\_\_\_\_ Non-Voting Precincts \_\_\_\_\_

9. Date Of County Executive's Adopted Order \_\_\_\_\_      10. Date Of First Election After Precincts Are Approved MAY 8, 2018

11. Precincts Affected By This Proposed Order (Complete a Precinct Summary Statement for each precinct. Please note that when changing boundaries of one precinct you will need to complete a separate IEC-8 for any other precinct affected by the change.)  
LS 11 + LS 12

12. List Any Attached Documents (i.e. map 6 of 20 maps, etc.)  
**CENSUS BLOCK LISTING AND MAPS**

Does any portion of the newly established precinct split or divide any of the following?	Yes	No
13. School Corporation District Boundary		X
14. City or Town Boundary		X
15. City or Town Council District Boundary		X
16. Census Block Boundary		X
17. Other (Please Describe)		X

### Method of Voting

18.  Optical Scan Ballot Card     Electronic     Combination (Please Specify): \_\_\_\_\_

19. What is the designated location and address for the polling place for this precinct?  
HOBART TOWNSHIP COMMUNITY CENTER  
3107 E. 35TH AVE.  
LAKE STATION, IN.  
 (NOTE: This designation of a polling place remains in effect until later action by the county executive under state law.)

20. Does this polling place meet Indiana's polling place accessibility requirements?  Yes  No

### Precinct Change Reason

21. Briefly state the reason for the precinct change. (Attach additional sheet if necessary.)  
SENATE BILL 220 COMBINING LS 11 + LS 12

### Additional Information

22. Name and Contact Information Of County Election Staff Person Who Prepared This Form:  
GENNY GASPAROVIC 219-755-3812

23. Does the county have access to Geographic Information System (GIS)?  Yes  No  
 Name and Contact Information Of County GIS Staff: Annette Mellady 219-755-3795

24. Does the county use Census Tiger files?  Yes  No

### State Office Use Only

25. Type Of Geographic Files Used by County (If Known By Staff Of The Indiana Election Division Or Office Of Census Data)

# LAKE STATION

— Railroad Centerline

— Water Lines

— Road Centerline

PREPARED BY  
LAKE COUNTY BOARD OF  
ELECTIONS & REGISTRATION  
FOR REFERENCE ONLY

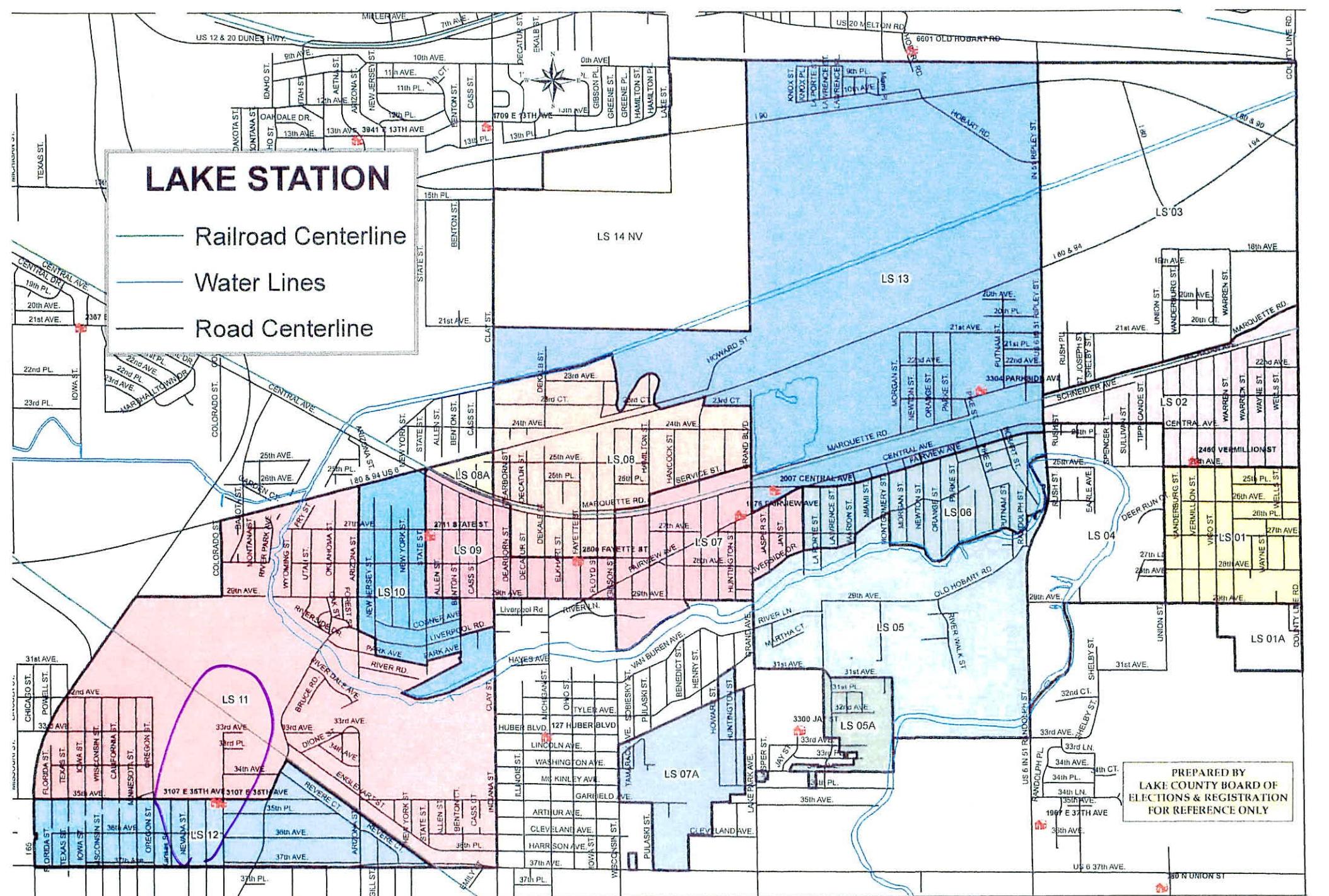

LAKE STATION  
PRECINCT 11

①

180890416004005  
180890416003013  
180890416004021  
180890416004003  
180890417005033  
180890416003019  
180890417005021  
180890417005017  
180890417005006  
180890417005008  
180890417005018  
180890417005020  
180890416004004  
180890417005019  
180890417005030  
180890417004018  
180890417005013  
180890417005022  
180890417005032  
180890417005023  
180890416003020  
180890416004022  
180890416003014  
180890416003015  
180890416002027  
180890416004009  
180890416004015  
180890416004016  
180890416004010  
180890416004001  
180890417005009  
180890416004017  
180890416004018

LAKE STATION  
PRECINCT 11

- 180890416004019
- 180890416004020
- 180890416004042
- 180890416003017
- 180890417005034
- 180890417005031
- 180890123001012
- 180890417005007
- 180890417005004
- 180890416004052
- 180890416004023
- 180890416004006
- 180890417004020
- 180890417004019
- 180890417005016
- 180890416004008
- 180890416004000
- 180890417005005
- 180890417005014
- 180890416003016
- 180890123001011
- 180890416003018
- 180890416004011
- 180890416004002
- 180890417005015
- 180890416004007

LAKE STATION  
PRECINCT 12

180890416003022  
180890416004045  
180890416004014  
180890416004029  
180890416004032  
180890416004024  
180890416004034  
180890416004035  
180890416004037  
180890416004051  
180890416004049  
180890416004041  
180890416004040  
180890416004039  
180890416004050  
180890416004046  
180890416004044  
180890416004043  
180890416004048  
180890416004047  
180890416004036  
180890416004026  
180890416004028  
180890416004012  
180890416004030  
180890416004013  
180890416004033  
180890416004031  
180890416004025  
180890416004027  
180890416004038