



PRECINCT SUMMARY STATEMENT

(IEC-8)

State Form 13332 (R/7-06)

Indiana Election Commission (IC 3-11-1.5-15) Name of County LAKE

INSTRUCTIONS: See Indiana Code 3-11-1.5-25 for periods during which precinct boundary changes may NOT take effect.
 Indiana Code 3-11-1.5-15 requires that a county include the following items in a proposed precinct establishment order submitted to the Indiana Election Division:

1. A map of each precinct to be established by the proposed order. A county may submit these maps in electronic form.
2. A description of the boundaries of each precinct to be established by the proposed order that identifies any census blocks located entirely within the precinct.
3. An estimated number of voters in each precinct to be established by the proposed order, based on the registration records maintained by the county voter registration office.
4. A statement designating a polling place for the precinct that complies with the polling place accessibility requirements.
5. Any additional information required by rules adopted by the Indiana Election Commission under IC 4-22-2.

General Precinct Information

1. Name Of Proposed Precinct LS 6 2. Is this a new precinct? Yes No 3. Election Division & STFID Number (To Be Completed By Election Division)

4. District Information
 Congressional 1 Indiana Senate 3 Indiana House 3

5. Number Of Active Voters (IC 3-5-2-1.7) 594 6. Number Of Inactive Voters 33 7. Number Of Registered Voters (Must Equal Total Of Active And Inactive Voters) 627

8. Total Number Of Precincts In The County If Submission Is Approved
 Voting Precincts _____ Non-Voting Precincts _____

9. Date Of County Executive's Adopted Order _____ 10. Date Of First Election After Precincts Are Approved MAY 8, 2018

11. Precincts Affected By This Proposed Order (Complete a Precinct Summary Statement for each precinct. Please note that when changing boundaries of one precinct you will need to complete a separate IEC-8 for any other precinct affected by the change.)
LS 6 + LS 4

12. List Any Attached Documents (i.e. map 6 of 20 maps, etc.) CENSUS BLOCK LISTING AND MAPS

Does any portion of the newly established precinct split or divide any of the following?	Yes	No
13. School Corporation District Boundary		X
14. City or Town Boundary		X
15. City or Town Council District Boundary		X
16. Census Block Boundary		X
17. Other (Please Describe)		X

Method of Voting

18. Optical Scan Ballot Card Electronic Combination (Please Specify): _____

19. What is the designated location and address for the polling place for this precinct?
LAKE COUNTY PUBLIC LIBRARY
2007 CENTRAL AVE
LAKE STATION IN 46405
 (NOTE: This designation of a polling place remains in effect until later action by the county executive under state law.)

20. Does this polling place meet Indiana's polling place accessibility requirements? Yes No

Precinct Change Reason

21. Briefly state the reason for the precinct change. (Attach additional sheet if necessary.)
SENATE BILL 220 COMBINING LS 6 + LS 4

Additional Information

22. Name and Contact Information Of County Election Staff Person Who Prepared This Form:
GENNY GASPAROVIC 219-755-3812

23. Does the county have access to Geographic Information System (GIS)? Yes No
 Name and Contact Information Of County GIS Staff: **Annette Mellady 219-755-3795**

24. Does the county use Census Tiger files? Yes No

State Office Use Only

25. Type Of Geographic Files Used by County (If Known By Staff Of The Indiana Election Division Or Office Of Census Data)

LAKE STATION

— Railroad Centerline

— Water Lines

— Road Centerline

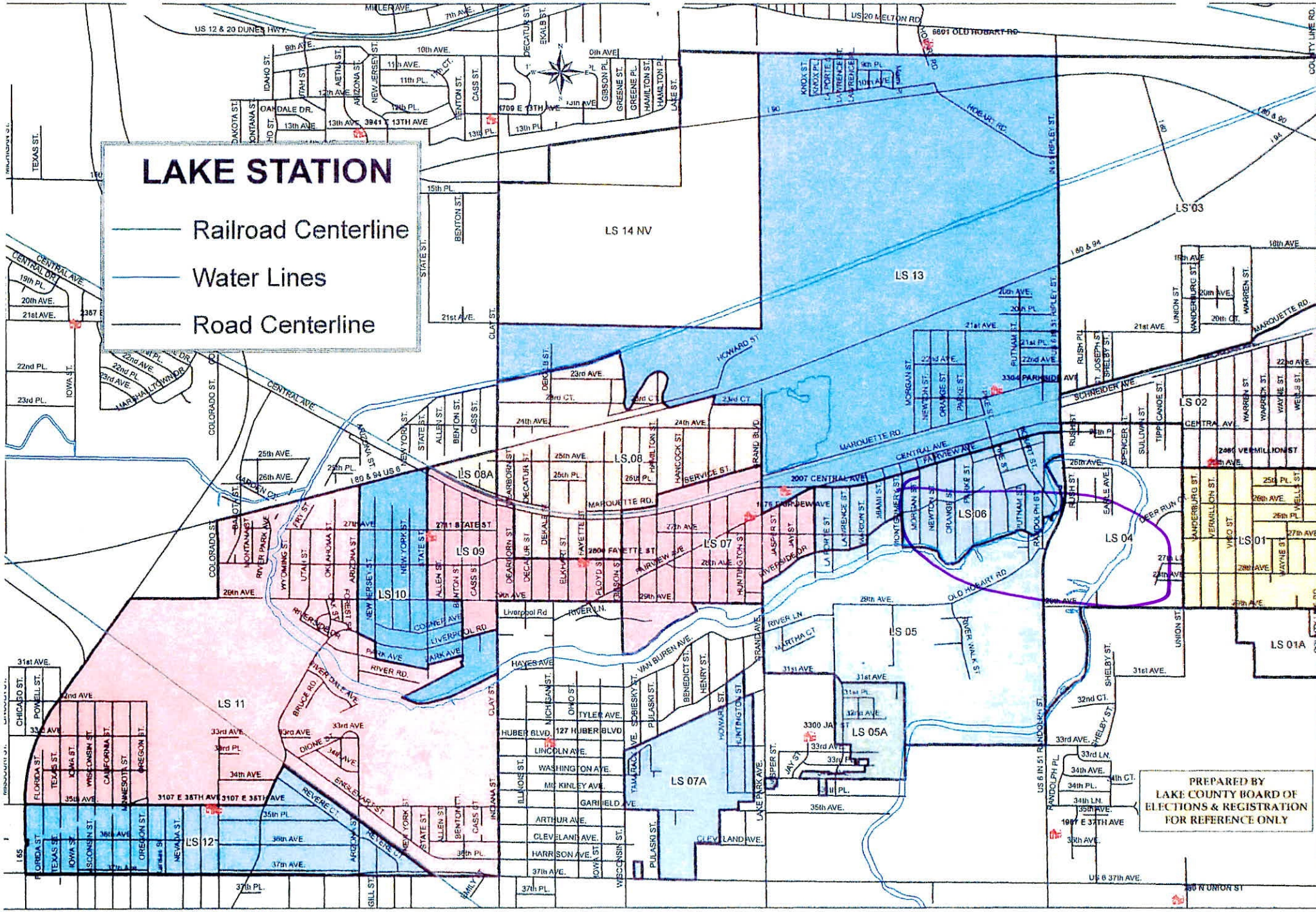

PREPARED BY
LAKE COUNTY BOARD OF
ELECTIONS & REGISTRATION
FOR REFERENCE ONLY

LAKE STATION
PRECINCT 04

180890418005009

180890418005004

180890418005010

180890418005012

180890418005005

180890418005002

180890418005011

180890418005003

180890418005000

180890418005001

180890418005006

180890418005007

180890418005008

LAKE STATION
PRECINCT 06

180890418006057
180890418006038
180890418006056
180890418006055
180890418006042
180890418006048
180890418006054
180890418006050
180890418006052
180890418006021
180890418006072
180890418006014
180890418006012
180890418006017
180890418006020
180890418006070
180890418006013
180890418006069
180890418006071
180890418006036
180890418006018
180890418006016
180890418006024
180890418006029
180890418006039
180890418006051
180890418006049
180890418006043
180890418006037
180890418006030
180890418006047
180890418006025
180890418006022
180890418006041
180890418006028
180890418006035
180890418006045
180890418006027
180890418006046
180890418006044
180890418006011
180890418006019
180890418006073
180890418006023
180890418006026
180890418006040
180890418006053