



# PRECINCT SUMMARY STATEMENT

(IEC-8)

State Form 13332 (R7/7-06)

Indiana Election Commission (IC 3-11-1.5-15)

Name of County LAKE

**INSTRUCTIONS:** See Indiana Code 3-11-1.5-25 for periods during which precinct boundary changes may NOT take effect. Indiana Code 3-11-1.5-15 requires that a county include the following items in a proposed precinct establishment order submitted to the Indiana Election Division:

1. A map of each precinct to be established by the proposed order. A county may submit these maps in electronic form.
2. A description of the boundaries of each precinct to be established by the proposed order that identifies any census blocks located entirely within the precinct.
3. An estimated number of voters in each precinct to be established by the proposed order, based on the registration records maintained by the county voter registration office.
4. A statement designating a polling place for the precinct that complies with the polling place accessibility requirements.
5. Any additional information required by rules adopted by the Indiana Election Commission under IC 4-22-2.

### General Precinct Information

1. Name Of Proposed Precinct <u>HO 29</u>		2. Is this a new precinct? <input checked="" type="checkbox"/> Yes <input type="checkbox"/> No		3. Election Division & STFID Number <i>(To Be Completed By Election Division)</i>	
4. District Information Congressional <u>1</u> Indiana Senate <u>3</u> Indiana House <u>19</u>					
5. Number Of Active Voters (IC 3-5-2-1.7) <u>1,238</u>		6. Number Of Inactive Voters <u>327</u>		7. Number Of Registered Voters (Must Equal Total Of Active And Inactive Voters) <u>1,565</u>	
8. Total Number Of Precincts In The County If Submission Is Approved Voting Precincts _____ Non-Voting Precincts _____					
9. Date Of County Executive's Adopted Order			10. Date Of First Election After Precincts Are Approved <u>MAY 8, 2018</u>		
11. Precincts Affected By This Proposed Order (Complete a Precinct Summary Statement for each precinct. Please note that when changing boundaries of one precinct you will need to complete a separate IEC-8 for any other precinct affected by the change.) <u>HO 29 &amp; HO 26</u>					

### 12. List Any Attached Documents (i.e. map 6 of 20 maps, etc.) CENSUS BLOCK LISTING AND MAPS

Does any portion of the newly established precinct split or divide any of the following?	Yes	No
13. School Corporation District Boundary		X
14. City or Town Boundary		X
15. City or Town Council District Boundary		X
16. Census Block Boundary		X
17. Other (Please Describe)		X

### Method of Voting

18.  Optical Scan Ballot Card  Electronic  Combination (Please Specify): \_\_\_\_\_

19. What is the designated location and address for the polling place for this precinct?  
Deep River Church of Christ  
7500 Grand Blvd  
HOBART TN

(NOTE: This designation of a polling place remains in effect until later action by the county executive under state law.)

20. Does this polling place meet Indiana's polling place accessibility requirements?  Yes  No

### Precinct Change Reason

21. Briefly state the reason for the precinct change. (Attach additional sheet if necessary.)  
SENATE BILL 220 - combine HO 29 & HO 26

### Additional Information

22. Name and Contact Information Of County Election Staff Person Who Prepared This Form:  
GENNY GASPAROVIC 219-755-3812

23. Does the county have access to Geographic Information System (GIS)?  Yes  No  
Name and Contact Information Of County GIS Staff: Annette Mellady 219-755-3795

24. Does the county use Census Tiger files?  Yes  No



### State Office Use Only

25. Type Of Geographic Files Used by County (If Known By Staff Of The Indiana Election Division Or Office Of Census Data)





# HOBART

-  Railroad Centerline
-  Water Lines
-  Road Centerline

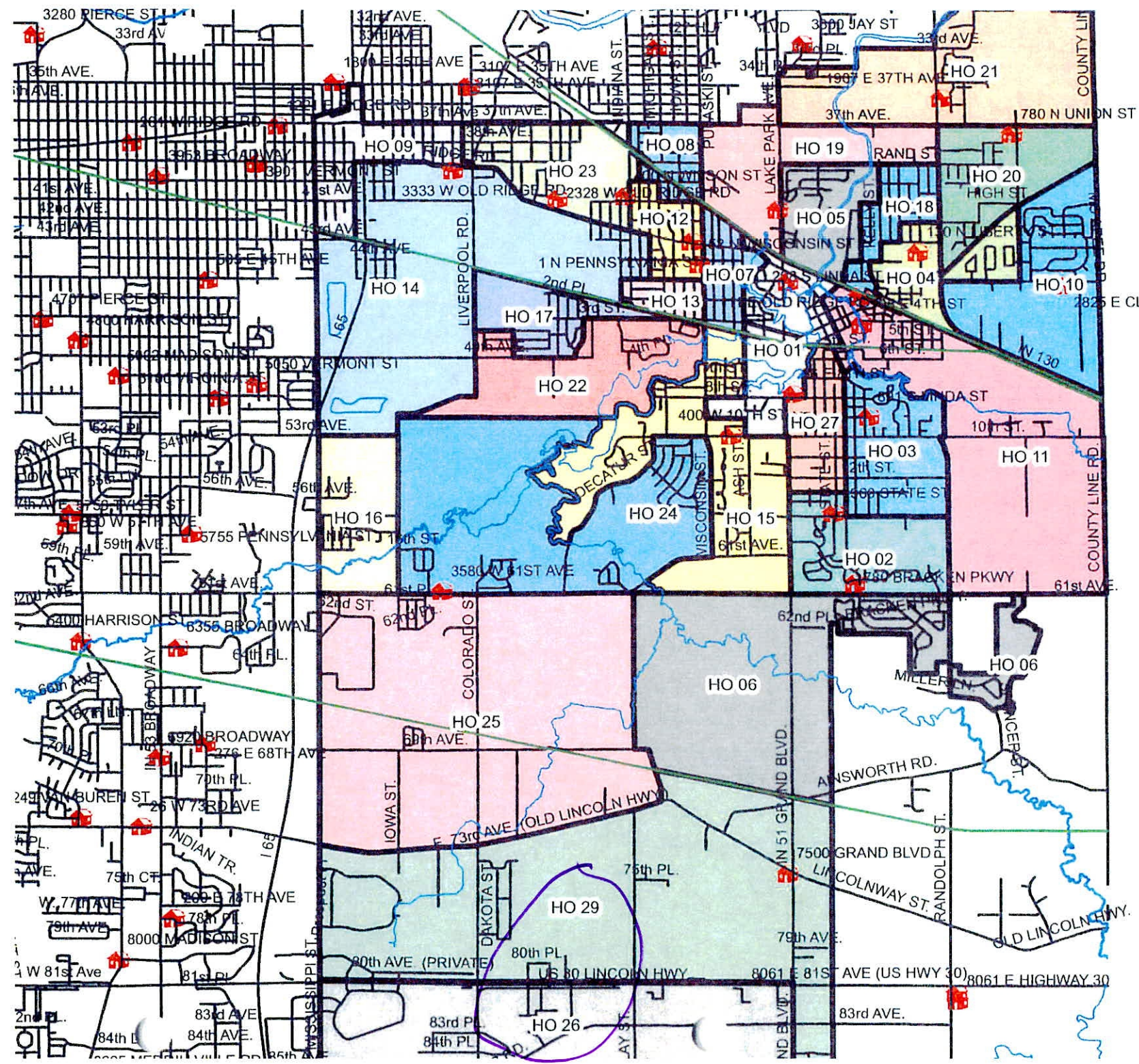



HOBART PRECINCT

26

180890423001013  
180890423001008  
180890423003047  
180890423003076  
180890423001028  
180890423003046  
180890423001026  
180890423003088  
180890423001029  
180890423001081  
180890423001025  
180890423003071  
180890423003074  
180890423003091  
180890423003070

180890423003072  
180890423003073  
180890423003065  
180890423003064  
180890423003066  
180890423003075  
180890423003040  
180890423001007  
180890423001006  
180890423003031  
180890423003068  
180890423001010  
180890423003067  
180890423001005  
180890423001012  
180890423003041  
180890423001009  
180890423003042  
180890423001027  
180890423003048  
180890423003063  
180890423003069  
180890423001011  
180890423003092

HOBART PRECINCT

29

180890423002034  
180890423002036  
180890423002023  
180890423002032  
180890423002030  
180890423001014  
180890423001024  
180890423001035  
180890423003035  
180890423003034  
180890423003019  
180890423002042  
180890423002039  
180890423002024  
180890423002038  
180890423003032  
180890423003087  
180890423003036  
180890423001004  
180890423002031  
180890423003037  
180890423003038  
180890423003039  
180890423002037  
180890423002040  
180890423002041  
180890423003033  
180890423002035  
180890423002033  
180890423003043  
180890423002058