



# PRECINCT SUMMARY STATEMENT

(IEC-8)

State Form 13332 (R7/7-06)

Indiana Election Commission (IC 3-11-1.5-15) Name of County LAKE

**INSTRUCTIONS:** See Indiana Code 3-11-1.5-25 for periods during which precinct boundary changes may NOT take effect.  
 Indiana Code 3-11-1.5-15 requires that a county include the following items in a proposed precinct establishment order submitted to the Indiana Election Division:  
 1. A map of each precinct to be established by the proposed order. A county may submit these maps in electronic form.  
 2. A description of the boundaries of each precinct to be established by the proposed order that identifies any census blocks located entirely within the precinct.  
 3. An estimated number of voters in each precinct to be established by the proposed order, based on the registration records maintained by the county voter registration office.  
 4. A statement designating a polling place for the precinct that complies with the polling place accessibility requirements.  
 5. Any additional information required by rules adopted by the Indiana Election Commission under IC 4-22-2.

### General Precinct Information

1. Name Of Proposed Precinct <u>HL 10</u>		2. Is this a new precinct? <input checked="" type="checkbox"/> Yes <input type="checkbox"/> No	3. Election Division & STFID Number <i>(To Be Completed By Election Division)</i>
4. District Information Congressional <u>1</u> Indiana Senate <u>1</u> Indiana House <u>12</u>			
5. Number Of Active Voters (IC 3-5-2-1.7) <u>5167</u>	6. Number Of Inactive Voters <u>82</u>	7. Number Of Registered Voters (Must Equal Total Of Active And Inactive Voters) <u>5249</u>	
8. Total Number Of Precincts In The County If Submission Is Approved Voting Precincts _____ Non-Voting Precincts _____			
9. Date Of County Executive's Adopted Order		10. Date Of First Election After Precincts Are Approved MAY 8, 2018	
11. Precincts Affected By This Proposed Order (Complete a Precinct Summary Statement for each precinct. Please note that when changing boundaries of one precinct you will need to complete a separate IEC-8 for any other precinct affected by the change.) <u>HL 10 &amp; HL 17</u>			
12. List Any Attached Documents (i.e. map 6 of 20 maps, etc.)			

### CENSUS BLOCK LISTING AND MAPS

Does any portion of the newly established precinct split or divide any of the following?	Yes	No
13. School Corporation District Boundary		X
14. City or Town Boundary		X
15. City or Town Council District Boundary		X
16. Census Block Boundary		X
17. Other (Please Describe)		X

### Method of Voting

18.  Optical Scan Ballot Card  Electronic  Combination (Please Specify): \_\_\_\_\_

19. What is the designated location and address for the polling place for this precinct?  
Highland Fire Station  
2901 Highway Ave  
Highland IN  
 (NOTE: This designation of a polling place remains in effect until later action by the county executive under state law.)

20. Does this polling place meet Indiana's polling place accessibility requirements?  Yes  No

### Precinct Change Reason

21. Briefly state the reason for the precinct change. (Attach additional sheet if necessary.)  
**SENATE BILL 220** Combine HL 10 & HL 17

### Additional Information

22. Name and Contact Information Of County Election Staff Person Who Prepared This Form:  
**GENNY GASPAROVIC 219-755-3812**

23. Does the county have access to Geographic Information System (GIS)?  Yes  No  
 Name and Contact Information Of County GIS Staff: **Annette Mellady 219-755-3795**

24. Does the county use Census Tiger files?  Yes  No

### State Office Use Only

25. Type Of Geographic Files Used by County (If Known By Staff Of The Indiana Election Division Or Office Of Census Data)

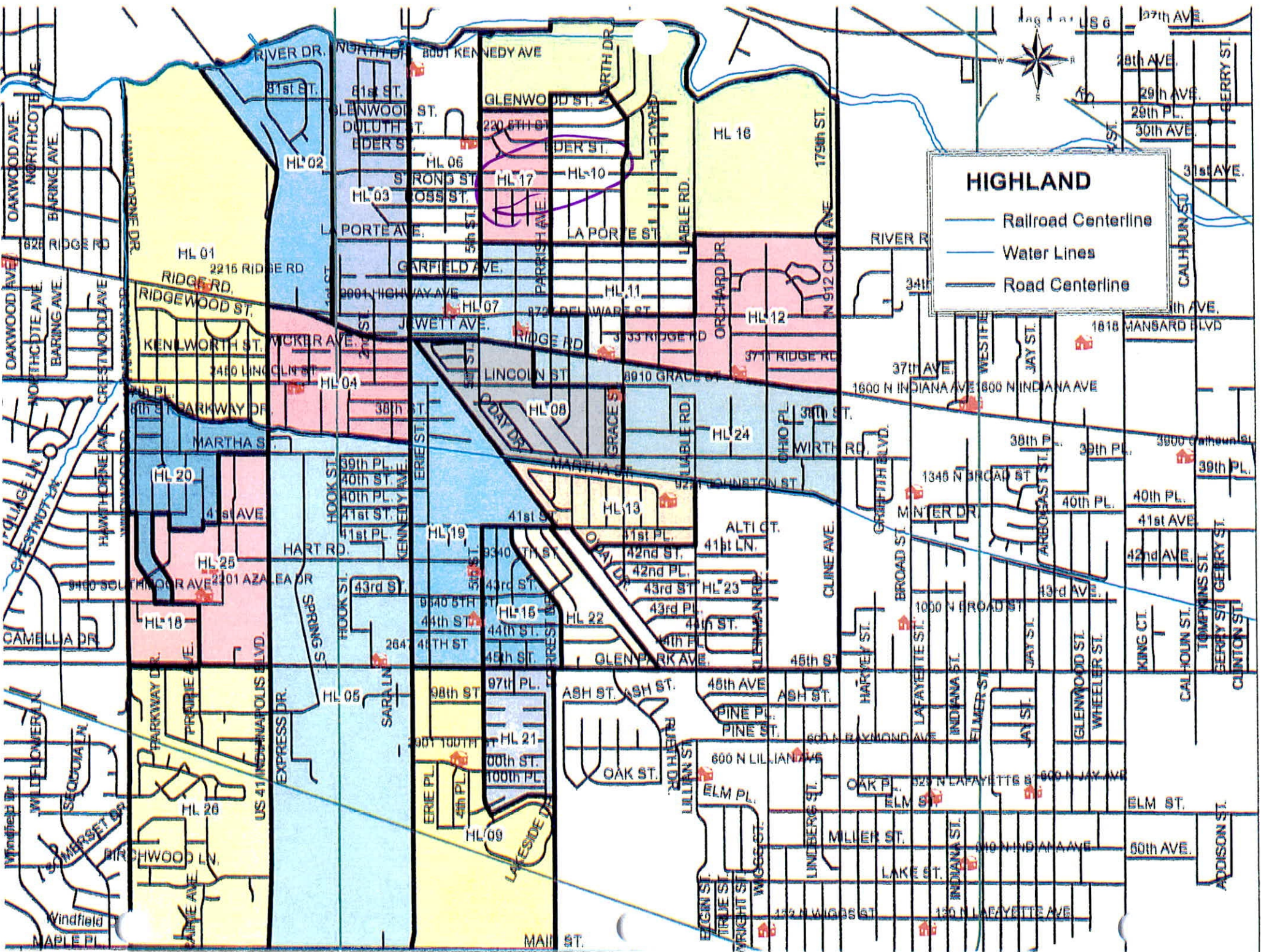

### HIGHLAND

- Railroad Centerline
- Water Lines
- Road Centerline

Map of Highland, Indiana, showing street names and lot numbers. Major streets include 8001 Kennedy Ave, 2215 Ridge Rd, 1600 N Indiana Ave, 37th Ave, 40th Pl, 41st Ave, 42nd Ave, 43rd Ave, 44th St, 45th St, 46th St, 47th St, 48th St, 49th St, 50th St, 51st St, 52nd St, 53rd St, 54th St, 55th St, 56th St, 57th St, 58th St, 59th St, 60th St, 61st St, 62nd St, 63rd St, 64th St, 65th St, 66th St, 67th St, 68th St, 69th St, 70th St, 71st St, 72nd St, 73rd St, 74th St, 75th St, 76th St, 77th St, 78th St, 79th St, 80th St, 81st St, 82nd St, 83rd St, 84th St, 85th St, 86th St, 87th St, 88th St, 89th St, 90th St, 91st St, 92nd St, 93rd St, 94th St, 95th St, 96th St, 97th St, 98th St, 99th St, 100th St. Lot numbers include HL 01, HL 02, HL 03, HL 04, HL 05, HL 06, HL 07, HL 08, HL 09, HL 10, HL 11, HL 12, HL 13, HL 14, HL 15, HL 16, HL 17, HL 18, HL 19, HL 20, HL 21, HL 22, HL 23, HL 24, HL 25, HL 26, HL 27, HL 28, HL 29, HL 30, HL 31, HL 32, HL 33, HL 34, HL 35, HL 36, HL 37, HL 38, HL 39, HL 40, HL 41, HL 42, HL 43, HL 44, HL 45, HL 46, HL 47, HL 48, HL 49, HL 50, HL 51, HL 52, HL 53, HL 54, HL 55, HL 56, HL 57, HL 58, HL 59, HL 60, HL 61, HL 62, HL 63, HL 64, HL 65, HL 66, HL 67, HL 68, HL 69, HL 70, HL 71, HL 72, HL 73, HL 74, HL 75, HL 76, HL 77, HL 78, HL 79, HL 80, HL 81, HL 82, HL 83, HL 84, HL 85, HL 86, HL 87, HL 88, HL 89, HL 90, HL 91, HL 92, HL 93, HL 94, HL 95, HL 96, HL 97, HL 98, HL 99, HL 100.

HIGHLAND  
PRECINCT 10

180890407002006

180890407002007

180890407002002

180890407002001

180890407002005

180890407002004

180890407002003

180890407002009

180890407002000

180890407002008

---

HIGHLAND  
PRECINCT 17

180890407003006

180890407003007

180890407003008

180890407003000

180890407003003

180890407003004

---

180890407003002

180890407003005

180890407003001