



PRECINCT SUMMARY STATEMENT

(IEC-8)

State Form 13332 (R7/7-06)

Indiana Election Commission (IC 3-11-1.5-15) Name of County LAKE

INSTRUCTIONS: See Indiana Code 3-11-1.5-25 for periods during which precinct boundary changes may NOT take effect.
 Indiana Code 3-11-1.5-15 requires that a county include the following items in a proposed precinct establishment order submitted to the Indiana Election Division:

1. A map of each precinct to be established by the proposed order. A county may submit these maps in electronic form.
2. A description of the boundaries of each precinct to be established by the proposed order that identifies any census blocks located entirely within the precinct.
3. An estimated number of voters in each precinct to be established by the proposed order, based on the registration records maintained by the county voter registration office.
4. A statement designating a polling place for the precinct that complies with the polling place accessibility requirements.
5. Any additional information required by rules adopted by the Indiana Election Commission under IC 4-22-2.

General Precinct Information

1. Name Of Proposed Precinct <u>HL 04</u>	2. Is this a new precinct? <input checked="" type="checkbox"/> Yes <input type="checkbox"/> No	3. Election Division & STFID Number (To Be Completed By Election Division)
--	---	---

4. District Information
 Congressional 1 Indiana Senate 1 Indiana House 12

5. Number Of Active Voters (IC 3-5-2-1.7) <u>5,265</u>	6. Number Of Inactive Voters <u>188</u>	7. Number Of Registered Voters (Must Equal Total Of Active And Inactive Voters) <u>5,453</u>
---	--	---

8. Total Number Of Precincts In The County If Submission Is Approved
 _____ Voting Precincts _____ Non-Voting Precincts

9. Date Of County Executive's Adopted Order	10. Date Of First Election After Precincts Are Approved <u>MAY 8, 2018</u>
---	---

11. Precincts Affected By This Proposed Order (Complete a Precinct Summary Statement for each precinct. Please note that when changing boundaries of one precinct you will need to complete a separate IEC-8 for any other precinct affected by the change.)
HL 04 & HL 01

12. List Any Attached Documents (i.e. map 6 of 20 maps, etc.)
CENSUS BLOCK LISTING AND MAPS

Does any portion of the newly established precinct split or divide any of the following?	Yes	No
13. School Corporation District Boundary		X
14. City or Town Boundary		X
15. City or Town Council District Boundary		X
16. Census Block Boundary		X
17. Other (Please Describe)		X

Method of Voting

18. Optical Scan Ballot Card Electronic Combination (Please Specify): _____

19. What is the designated location and address for the polling place for this precinct?
LINCOLN SOCIAL CENTER
2450 LINCOLN ST
HIGHLAND IN
 (NOTE: This designation of a polling place remains in effect until later action by the county executive under state law.)

20. Does this polling place meet Indiana's polling place accessibility requirements? Yes No

Precinct Change Reason

21. Briefly state the reason for the precinct change. (Attach additional sheet if necessary.)
SENATE BILL 220 - combine HL 04 & HL 01

Additional Information

22. Name and Contact Information Of County Election Staff Person Who Prepared This Form:
GENNY GASPAROVIC 219-755-3812

23. Does the county have access to Geographic Information System (GIS)? Yes No
 Name and Contact Information Of County GIS Staff: Annette Mellady 219-755-3795

24. Does the county use Census Tiger files? Yes No

State Office Use Only

25. Type Of Geographic Files Used by County (If Known By Staff Of The Indiana Election Division Or Office Of Census Data)

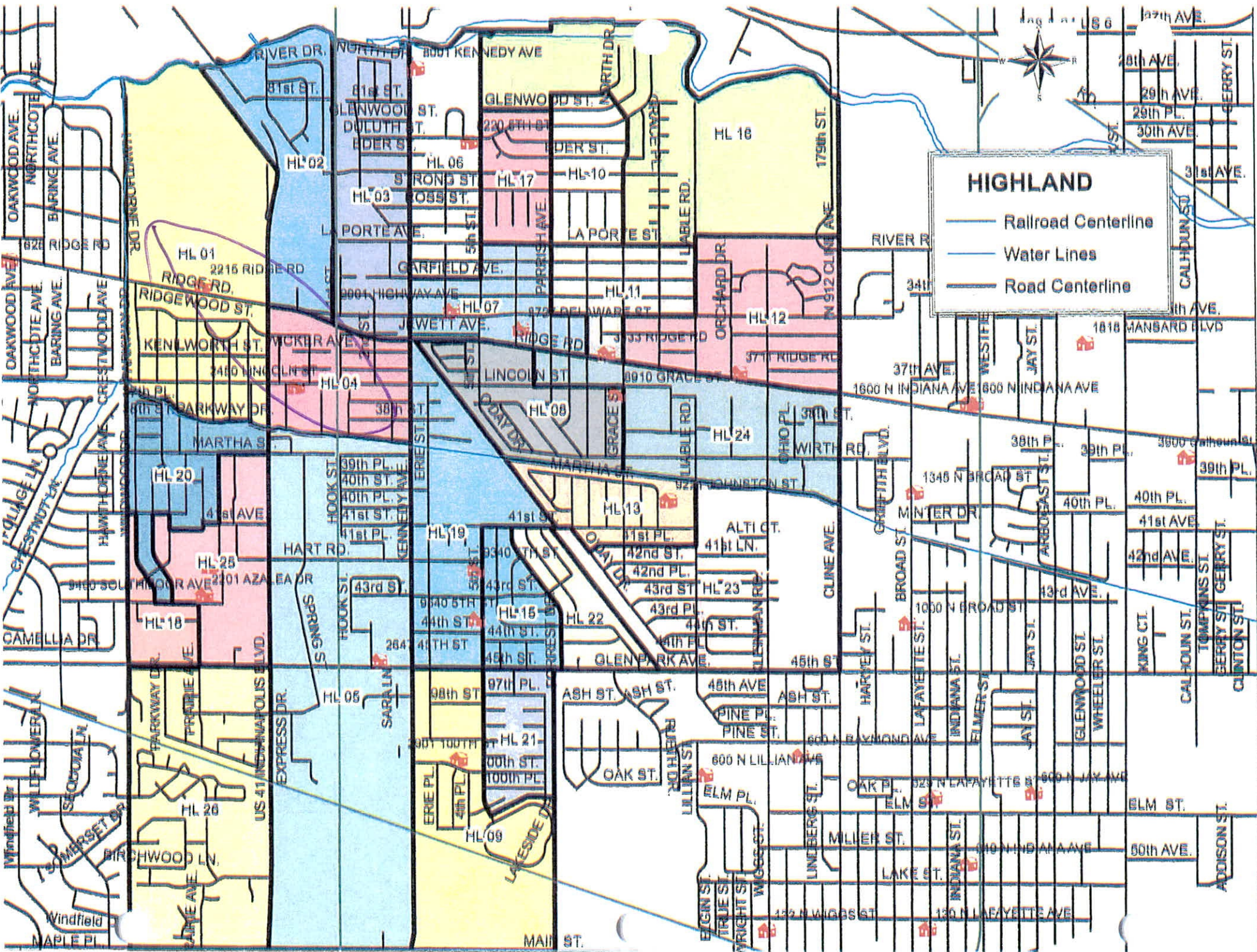

HIGHLAND

- Railroad Centerline
- Water Lines
- Road Centerline

Map showing street grid and lot numbers in Highland, Indiana. Major streets include Oakwood Ave, Northcote Ave, Ridge Rd, and US 41 Indianapolis Blvd. Lot numbers range from HL 01 to HL 26. A legend in the upper right corner defines symbols for Railroad Centerline, Water Lines, and Road Centerline. A compass rose is also present in the top right corner.

HIGHLAND
PRECINCT 01

180890406004020
180890406004007
180890406004008
180890406004009
180890406004010
180890406004000
180890406001009
180890406001008
180890406004005
180890406001010
180890406004006
180890406004004
180890406004003
180890406004002
180890406004001
180890406004019
180890406004012
180890406004017
180890406004016
180890406004015
180890406004014
180890406004026
180890406004013
180890406001011
180890406004011
180890406004018

HIGHLAND
PRECINCT 04

180890406003010

180890406003001

180890406003016

180890406003023

180890406003017

180890406003005

180890406003002

180890406003011

180890406003018

180890406003014

180890406003019

180890406003021

180890406003012

180890406003009

180890406003013

180890406003027

180890406003022

180890406003015

180890406003020