



# PRECINCT SUMMARY STATEMENT

(IEC-8)

State Form 13332 (R7/7-06)

Indiana Election Commission (IC 3-11-1.5-15) Name of County LAKE

**INSTRUCTIONS:** See Indiana Code 3-11-1.5-25 for periods during which precinct boundary changes may NOT take effect.

Indiana Code 3-11-1.5-15 requires that a county include the following items in a proposed precinct establishment order submitted to the Indiana Election Division:

1. A map of each precinct to be established by the proposed order. A county may submit these maps in electronic form.
2. A description of the boundaries of each precinct to be established by the proposed order that identifies any census blocks located entirely within the precinct.
3. An estimated number of voters in each precinct to be established by the proposed order, based on the registration records maintained by the county voter registration office.
4. A statement designating a polling place for the precinct that complies with the polling place accessibility requirements.
5. Any additional information required by rules adopted by the Indiana Election Commission under IC 4-22-2.

### General Precinct Information

1. Name Of Proposed Precinct <u>G3-9</u>	2. Is this a new precinct? <input checked="" type="checkbox"/> Yes <input type="checkbox"/> No	3. Election Division & STFID Number (To Be Completed By Election Division)
---	---	---

4. District Information

Congressional 1 Indiana Senate 3 Indiana House 2

5. Number Of Active Voters (IC 3-5-2-1.7) <u>762</u>	6. Number Of Inactive Voters <u>125</u>	7. Number Of Registered Voters (Must Equal Total Of Active And Inactive Voters) <u>887</u>
---	--	---

8. Total Number Of Precincts In The County If Submission Is Approved

Voting Precincts \_\_\_\_\_ Non-Voting Precincts \_\_\_\_\_

9. Date Of County Executive's Adopted Order	10. Date Of First Election After Precincts Are Approved <u>MAY 8, 2018</u>
---	---

11. Precincts Affected By This Proposed Order (Complete a Precinct Summary Statement for each precinct. Please note that when changing boundaries of one precinct you will need to complete a separate IEC-8 for any other precinct affected by the change.)

G3-9 & G3-10

12. List Any Attached Documents (i.e. map 6 of 20 maps, etc.)

**CENSUS BLOCK LISTING AND MAPS**

Does any portion of the newly established precinct split or divide any of the following?	Yes	No
13. School Corporation District Boundary		X
14. City or Town Boundary		X
15. City or Town Council District Boundary		X
16. Census Block Boundary		X
17. Other (Please Describe)		X

### Method of Voting

18.  Optical Scan Ballot Card  Electronic  Combination (Please Specify): \_\_\_\_\_

19. What is the designated location and address for the polling place for this precinct?

Peace Baptist Church  
3510 W 15th Ave (ARMORY)

(NOTE: This designation of a polling place remains in effect until later action by the county executive under state law.)

20. Does this polling place meet Indiana's polling place accessibility requirements?  Yes  No

### Precinct Change Reason

21. Briefly state the reason for the precinct change. (Attach additional sheet if necessary.)

SENATE BILL 220 - COMBINE G3-9 & G3-10

### Additional Information

22. Name and Contact Information Of County Election Staff Person Who Prepared This Form:

GENNY GASPAROVIC 219-755-3812

23. Does the county have access to Geographic Information System (GIS)?  Yes  No

Name and Contact Information Of County GIS Staff: Annette Mellady 219-755-3795

24. Does the county use Census Tiger files?  Yes  No

### State Office Use Only

25. Type Of Geographic Files Used by County (If Known By Staff Of The Indiana Election Division Or Office Of Census Data)

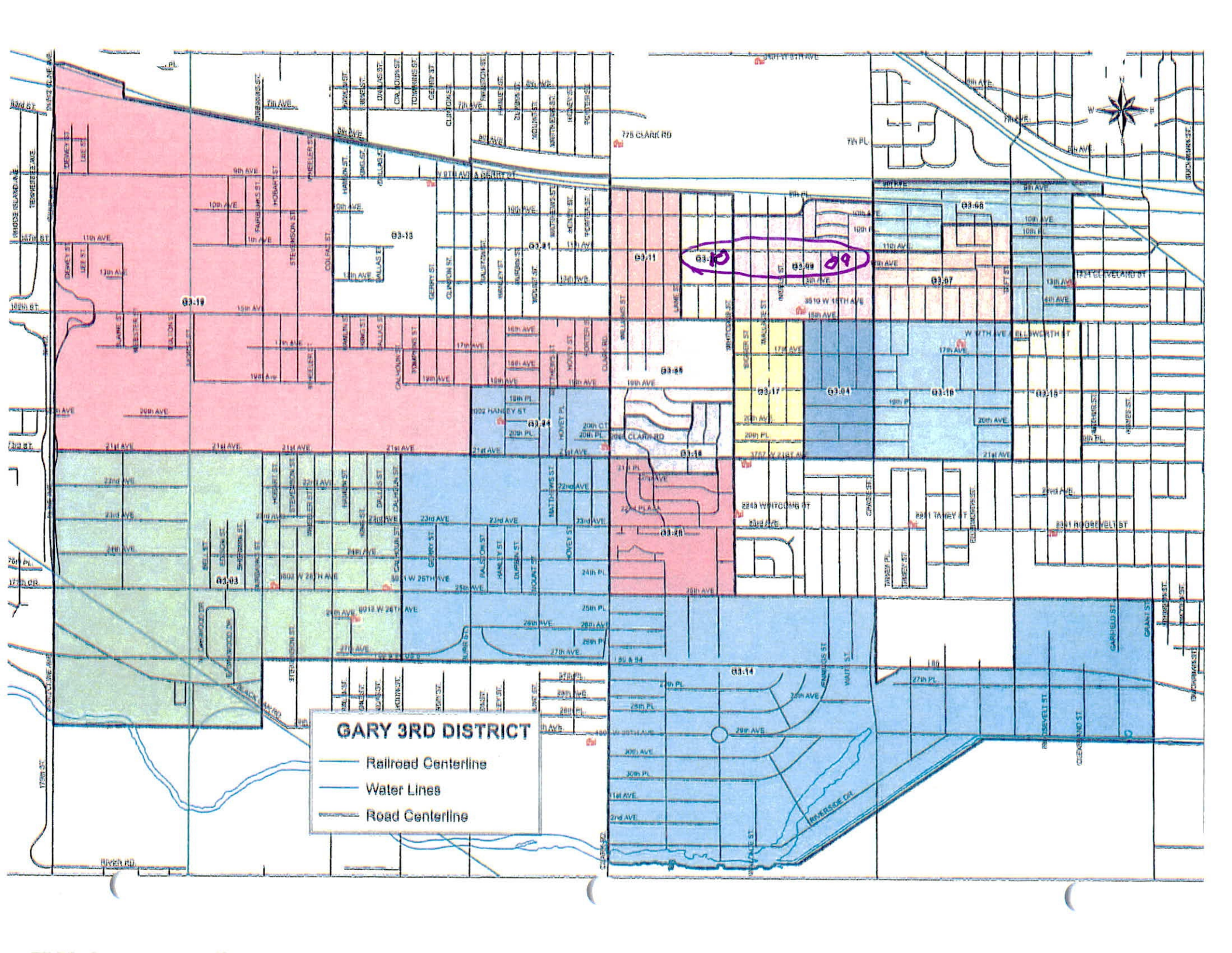

### GARY 3RD DISTRICT

- Railroad Centerline
- Water Lines
- Road Centerline

03-10 03-11 03-08 03-09



GARY PRECINCT

3-09

180890110002034  
180890110003029  
180890110002013  
180890110002039  
180890110001001  
180890110001002  
180890110001003  
180890110003027  
180890110001000  
180890110001006  
180890110002015  
180890110002006  
180890110002048  
180890110001004  
180890110002021  
180890110001007  
180890110001005  
180890110002023  
180890110002031  
180890110002027  
180890110002029  
180890110002002  
180890110002000  
180890110002001  
180890110002007  
180890110002050  
180890110002003  
180890110002037  
180890110002016  
180890110002026  
180890110002030  
180890110002049  
180890110002032  
180890110002024  
180890110002022  
180890110003028  
180890110003023  
180890110002008  
180890110003056  
180890110002012  
180890110003030  
180890110002014  
180890110002036  
180890110002019

GARY PRECINCT  
3-09

- 180890110002017
- 180890110002005
- 180890110002018
- 180890110003025
- 180890110003026
- 180890110002035
- 180890110002020
- 180890110002038
- 180890110003024
- 180890110002004
- 180890110002025
- 180890110002028
- 180890110002033

GARY PRECINCT

3-10

180890110003038  
180890110003033  
180890110003021  
180890110003064  
180890110002041  
180890110003110  
180890110002046  
180890110003011  
180890110002045  
180890110003101  
180890110003099  
180890110003100  
180890110003096  
180890110003014  
180890110003097  
180890110003013  
180890110002044  
180890110002043  
180890110003065  
180890110003034  
180890110003055  
180890110003022  
180890110002011  
180890110003031  
180890110003035  
180890110003039  

---

180890110003053  
180890110003052  
180890110003054  
180890110002042  
180890110002010  
180890110003012  
180890110002040  
180890110002047  
180890110003009  
180890110003098  
180890110003103  
180890110003095  
180890110003015  
180890110003102  
180890110002009  
180890110003037  
180890110003032

---