



# PRECINCT SUMMARY STATEMENT

(IEC-8)

State Form 13332 (R7/7-06)

Indiana Election Commission (IC 3-11-1.5-15) Name of County LAKE

**INSTRUCTIONS:** See Indiana Code 3-11-1.5-25 for periods during which precinct boundary changes may NOT take effect.  
 Indiana Code 3-11-1.5-15 requires that a county include the following items in a proposed precinct establishment order submitted to the Indiana Election Division:

1. A map of each precinct to be established by the proposed order. A county may submit these maps in electronic form.
2. A description of the boundaries of each precinct to be established by the proposed order that identifies any census blocks located entirely within the precinct.
3. An estimated number of voters in each precinct to be established by the proposed order, based on the registration records maintained by the county voter registration office.
4. A statement designating a polling place for the precinct that complies with the polling place accessibility requirements.
5. Any additional information required by rules adopted by the Indiana Election Commission under IC 4-22-2.

### General Precinct Information

1. Name Of Proposed Precinct <u>G 2-3</u>		2. Is this a new precinct? <input checked="" type="checkbox"/> Yes <input type="checkbox"/> No	3. Election Division & STFID Number (To Be Completed By Election Division)
4. District Information Congressional <u>1</u> Indiana Senate <u>3</u> Indiana House <u>3</u>			
5. Number Of Active Voters (IC 3-5-2-1.7) <u>731</u>	6. Number Of Inactive Voters <u>159</u>	7. Number Of Registered Voters (Must Equal Total Of Active And Inactive Voters) <u>890</u>	
8. Total Number Of Precincts In The County If Submission Is Approved Voting Precincts _____ Non-Voting Precincts _____			
9. Date Of County Executive's Adopted Order		10. Date Of First Election After Precincts Are Approved MAY 8, 2018	
11. Precincts Affected By This Proposed Order (Complete a Precinct Summary Statement for each precinct. Please note that when changing boundaries of one precinct you will need to complete a separate IEC-8 for any other precinct affected by the change.) <u>G 2-3 &amp; G 2-5</u>			

12. List Any Attached Documents (i.e. map 6 of 20 maps, etc.)  
**CENSUS BLOCK LISTING AND MAPS**

Does any portion of the newly established precinct split or divide any of the following?	Yes	No
13. School Corporation District Boundary		X
14. City or Town Boundary		X
15. City or Town Council District Boundary		X
16. Census Block Boundary		X
17. Other (Please Describe)		X

### Method of Voting

18.  Optical Scan Ballot Card  Electronic  Combination (Please Specify): \_\_\_\_\_

19. What is the designated location and address for the polling place for this precinct?  
GENESIS TOWNSHIP SENIOR HIGH RISE  
578 BROADWAY  
GARY TN  
 (NOTE: This designation of a polling place remains in effect until later action by the county executive under state law.)

20. Does this polling place meet Indiana's polling place accessibility requirements?  Yes  No

### Precinct Change Reason

21. Briefly state the reason for the precinct change. (Attach additional sheet if necessary.)  
**SENATE BILL 220 - COMBINE G 2-3 & G 2-5**

### Additional Information

22. Name and Contact Information Of County Election Staff Person Who Prepared This Form:  
**GENNY GASPAROVIC 219-755-3812**

23. Does the county have access to Geographic Information System (GIS)?  Yes  No  
 Name and Contact Information Of County GIS Staff: **Annette Mellady 219-755-3795**

24. Does the county use Census Tiger files?  Yes  No

### State Office Use Only

25. Type Of Geographic Files Used by County (If Known By Staff Of The Indiana Election Division Or Office Of Census Data)





# GARY 2ND DISTRICT

- Railroad Centerline
- Water Lines
- Road Centerline

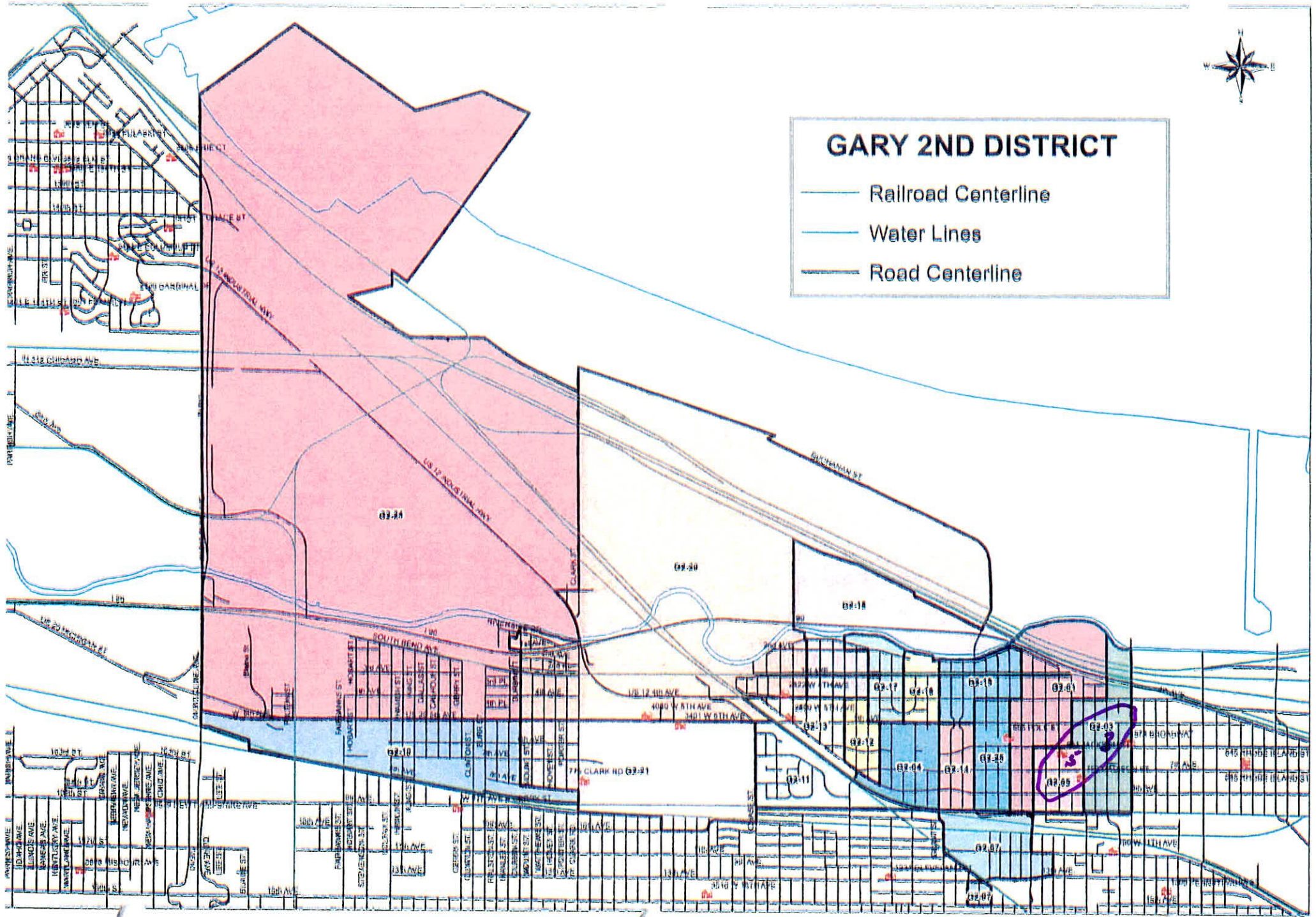

GARY PRECINCT

2-45

180890128003044

180890128003049

180890128003057

180890128003042

180890128003040

180890128003039

180890128003053

180890128003062

180890128003060

180890128003041

180890128003050

180890128003052

180890128003063

180890128003056

180890128003061

180890128003064

180890128003051

180890128003054

180890128003043

180890128003055



GARY PRECINCT

2-03

180890102052121  
180890102052185  
180890102052184  
180890128003018  
180890102051005  
180890102051003  
180890102051012  
180890102051018  
180890102051014  
180890102051016  
180890102051001  
180890102051019  
180890102051038  
180890102052212  
180890102052213  
180890102051024  
180890102051027  
180890102051029  
180890102051039  
180890102051041  
180890102051030  
180890102051028  
180890102051035  
180890102051037  
180890102051015  
180890102051017  
180890102051025  
180890102051023  
180890102051020  
180890128003038  
180890102051008  
180890102051009  
180890102051032  
180890128003000  
180890102051013  
180890102051043  
180890102051042  
180890102051006

GARY PRECINCT

2-03

- 180890128003019
- 180890102051011
- 180890102051007
- 180890128003037
- 180890102051040
- 180890128003001
- 180890128003017
- 180890102052186
- 180890102051034
- 180890102051000
- 180890102051033
- 180890102051031
- 180890102051004
- 180890102052183
- 180890102051036
- 180890102051022
- 180890102051021
- 180890102051010
- 180890102051002
- 180890128003020
- 180890102051026