



# PRECINCT SUMMARY STATEMENT

(IEC-8)

State Form 13332 (R7/7-06)

Indiana Election Commission (IC 3-11-1.5-15) Name of County LAKE

**INSTRUCTIONS:** See Indiana Code 3-11-1.5-25 for periods during which precinct boundary changes may NOT take effect.  
 Indiana Code 3-11-1.5-15 requires that a county include the following items in a proposed precinct establishment order submitted to the Indiana Election Division:

1. A map of each precinct to be established by the proposed order. A county may submit these maps in electronic form.
2. A description of the boundaries of each precinct to be established by the proposed order that identifies any census blocks located entirely within the precinct.
3. An estimated number of voters in each precinct to be established by the proposed order, based on the registration records maintained by the county voter registration office.
4. A statement designating a polling place for the precinct that complies with the polling place accessibility requirements.
5. Any additional information required by rules adopted by the Indiana Election Commission under IC 4-22-2.

### General Precinct Information

1. Name Of Proposed Precinct CP-29      2. Is this a new precinct?  Yes  No      3. Election Division & STFID Number (To Be Completed By Election Division)

4. District Information  
 Congressional 1      Indiana Senate 6      Indiana House 19

5. Number Of Active Voters (IC 3-5-2-1.7) 1065      6. Number Of Inactive Voters 166      7. Number Of Registered Voters (Must Equal Total Of Active And Inactive Voters) 1231

8. Total Number Of Precincts In The County If Submission Is Approved  
 \_\_\_\_\_ Voting Precincts      \_\_\_\_\_ Non-Voting Precincts

9. Date Of County Executive's Adopted Order      10. Date Of First Election After Precincts Are Approved  
 \_\_\_\_\_      MAY 8, 2018

11. Precincts Affected By This Proposed Order (Complete a Precinct Summary Statement for each precinct. Please note that when changing boundaries of one precinct you will need to complete a separate IEC-8 for any other precinct affected by the change.)

CROWN POINT-29 & CROWN POINT-16

12. List Any Attached Documents (i.e. map 6 of 20 maps, etc.)

### CENSUS BLOCK LISTING AND MAPS

Does any portion of the newly established precinct split or divide any of the following?	Yes	No
--	-----	----

13. School Corporation District Boundary		X
14. City or Town Boundary		X
15. City or Town Council District Boundary		X
16. Census Block Boundary		X
17. Other (Please Describe)		X

### Method of Voting

18.  Optical Scan Ballot Card     Electronic     Combination (Please Specify): \_\_\_\_\_

19. What is the designated location and address for the polling place for this precinct?  
FIRST CHRISTIAN REFORMED CHURCH  
909 E. GREENWOOD ST.  
CROWN POINT, IN  
 (NOTE: This designation of a polling place remains in effect until later action by the county executive under state law.)

20. Does this polling place meet Indiana's polling place accessibility requirements?  Yes     No

### Precinct Change Reason

21. Briefly state the reason for the precinct change. (Attach additional sheet if necessary.)  
SENATE BILL 220 - COMBINING CP-29 & CP-16

### Additional Information

22. Name and Contact Information Of County Election Staff Person Who Prepared This Form:  
GENNY GASPAROVIC 219-755-3812

23. Does the county have access to Geographic Information System (GIS)?  Yes     No  
 Name and Contact Information Of County GIS Staff: Annette Mellady 219-755-3795



24. Does the county use Census Tiger files?  Yes     No

### State Office Use Only

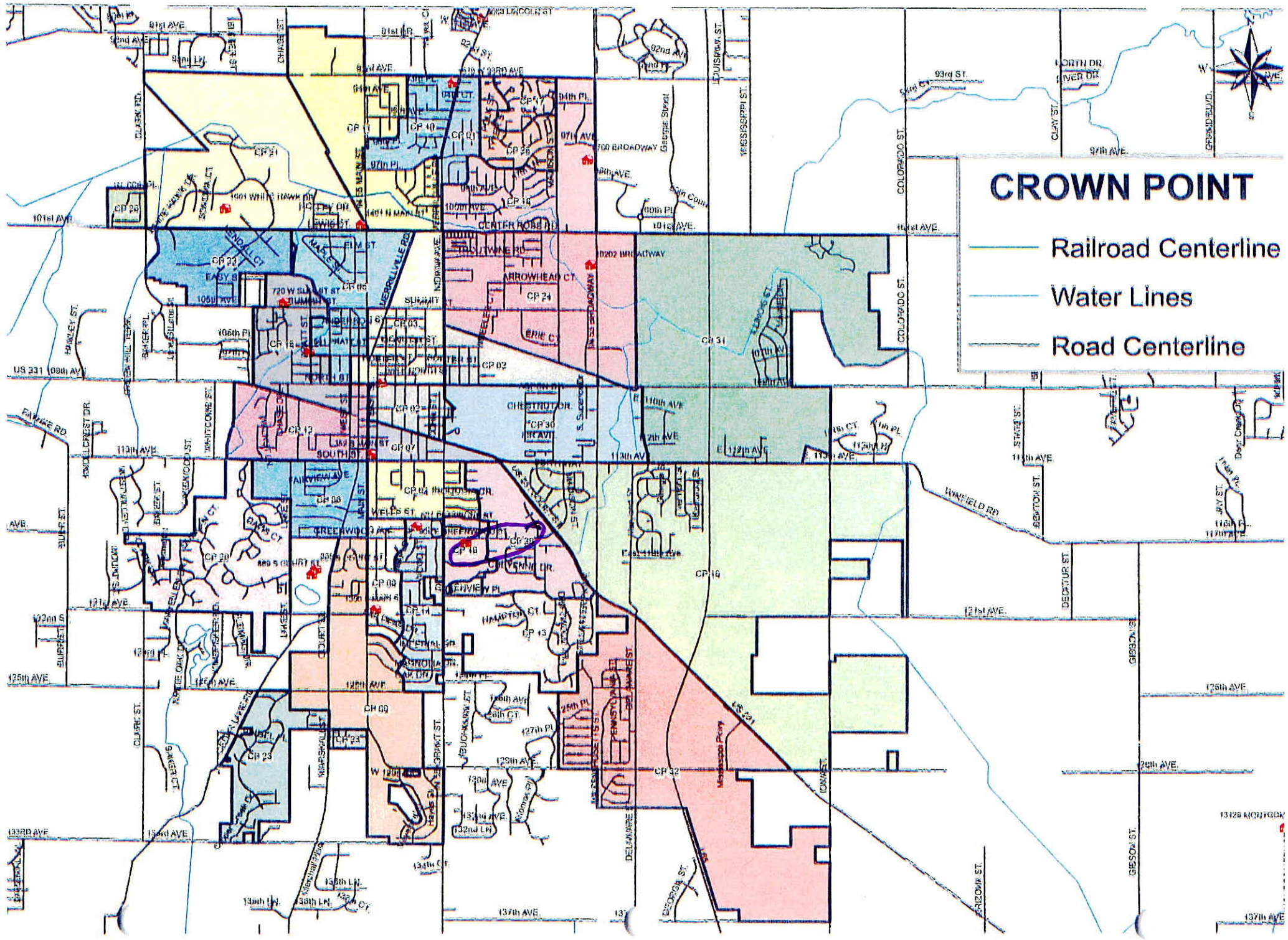
25. Type Of Geographic Files Used by County (If Known By Staff Of The Indiana Election Division Or Office Of Census Data)



# CROWN POINT

-  Railroad Centerline
-  Water Lines
-  Road Centerline

13726 & 10717 GOK

137th AVE

---

CROWN POINT  
PRECINCT 16

180890432021094

180890432021079

180890432021083

180890432021085

180890432021078

180890432021084

180890432021056

180890432021077

180890432021075

180890432021076

---

---

CROWN POINT  
PRECINCT 29

180890432021080  
180890432021082  
180890432021090  
180890432021081  
180890432021055  
180890432021053  
180890432021086  
180890432021057  
180890432021091  
180890432021054  
180890432021095  
180890432021092  
180890432021088  
180890432021089  
180890432021098

---