



# PRECINCT SUMMARY STATEMENT

(IEC-8)

State Form 13332 (R7/7-06)

Indiana Election Commission (IC 3-11-1.5-15) Name of County LAKE

**INSTRUCTIONS:** See Indiana Code 3-11-1.5-25 for periods during which precinct boundary changes may NOT take effect.  
 Indiana Code 3-11-1.5-15 requires that a county include the following items in a proposed precinct establishment order submitted to the Indiana Election Division:

1. A map of each precinct to be established by the proposed order. A county may submit these maps in electronic form.
2. A description of the boundaries of each precinct to be established by the proposed order that identifies any census blocks located entirely within the precinct.
3. An estimated number of voters in each precinct to be established by the proposed order, based on the registration records maintained by the county voter registration office.
4. A statement designating a polling place for the precinct that complies with the polling place accessibility requirements.
5. Any additional information required by rules adopted by the Indiana Election Commission under IC 4-22-2.

### General Precinct Information

1. Name Of Proposed Precinct <u>CP-5</u>		2. Is this a new precinct? <input checked="" type="checkbox"/> Yes <input type="checkbox"/> No		3. Election Division & STFID Number (To Be Completed By Election Division)	
4. District Information Congressional <u>1</u> Indiana Senate <u>6</u> Indiana House <u>19</u>					
5. Number Of Active Voters (IC 3-5-2-1.7) <u>1388</u>		6. Number Of Inactive Voters <u>139</u>		7. Number Of Registered Voters (Must Equal Total Of Active And Inactive Voters) <u>1527</u>	
8. Total Number Of Precincts In The County If Submission Is Approved Voting Precincts _____ Non-Voting Precincts _____					
9. Date Of County Executive's Adopted Order			10. Date Of First Election After Precincts Are Approved MAY 8, 2018		
11. Precincts Affected By This Proposed Order (Complete a Precinct Summary Statement for each precinct. Please note that when changing boundaries of one precinct you will need to complete a separate IEC-8 for any other precinct affected by the change.) <u>CROWN POINT-5 &amp; CROWN POINT-3</u>					

12. List Any Attached Documents (i.e. map 6 of 20 maps, etc.)  
**CENSUS BLOCK LISTING AND MAPS**

Does any portion of the newly established precinct split or divide any of the following?	Yes	No
13. School Corporation District Boundary		X
14. City or Town Boundary		X
15. City or Town Council District Boundary		X
16. Census Block Boundary		X
17. Other (Please Describe)		X

### Method of Voting

18.  Optical Scan Ballot Card  Electronic  Combination (Please Specify): \_\_\_\_\_

19. What is the designated location and address for the polling place for this precinct?  
AMERICAN LEGION POST #20  
1401 N. MAIN ST.  
CROWN POINT, IN  
 (NOTE: This designation of a polling place remains in effect until later action by the county executive under state law.)

20. Does this polling place meet Indiana's polling place accessibility requirements?  Yes  No

### Precinct Change Reason

21. Briefly state the reason for the precinct change. (Attach additional sheet if necessary.)  
SENATE BILL 220 - COMBINING CP-5 & CP-3

### Additional Information

22. Name and Contact Information Of County Election Staff Person Who Prepared This Form:  
GENNY GASPAROVIC 219-755-3812

23. Does the county have access to Geographic Information System (GIS)?  Yes  No  
 Name and Contact Information Of County GIS Staff: Annette Mellady 219-755-3795

24. Does the county use Census Tiger files?  Yes  No

### State Office Use Only

25. Type Of Geographic Files Used by County (If Known By Staff Of The Indiana Election Division Or Office Of Census Data)

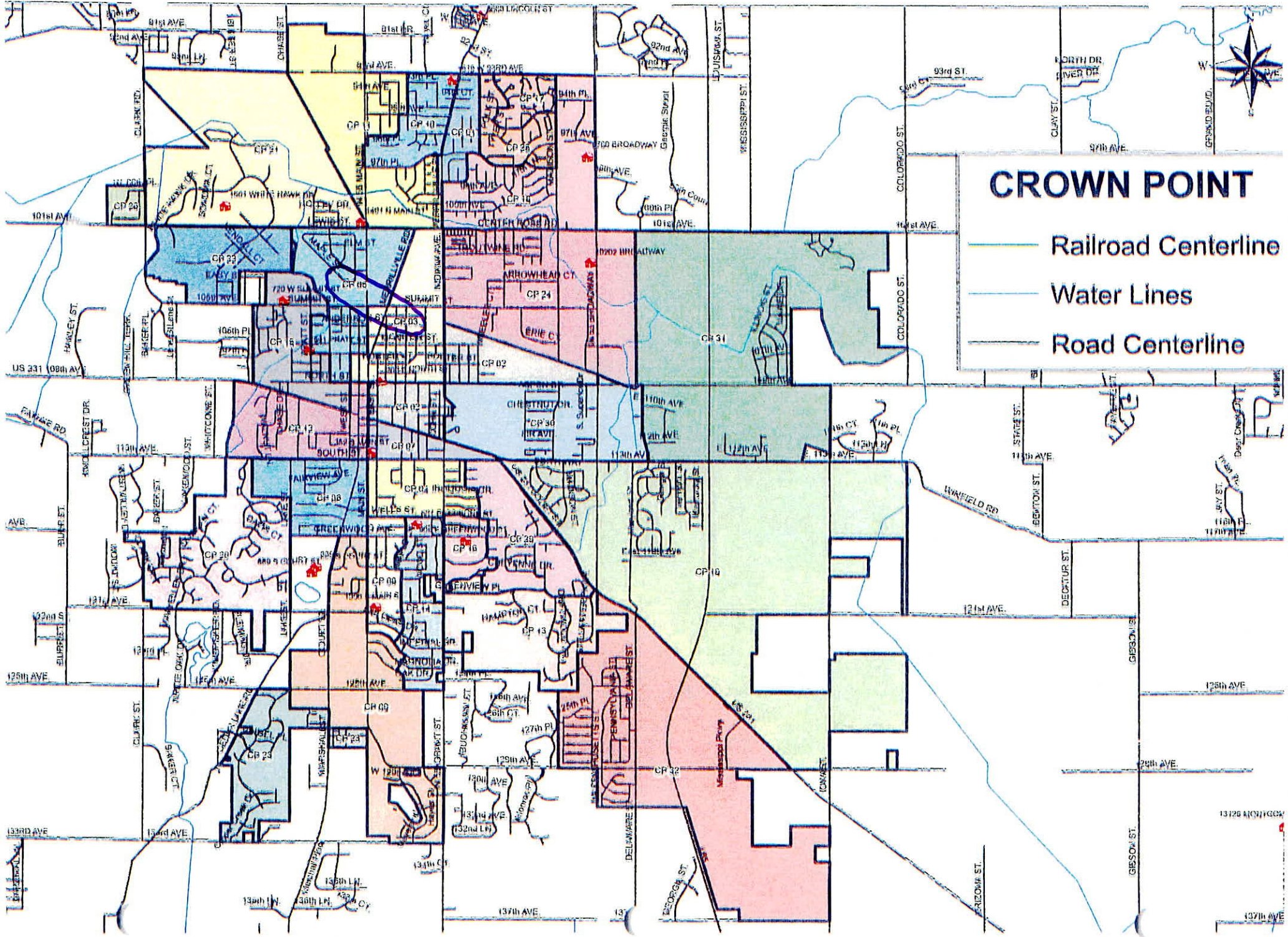

# CROWN POINT

-  Railroad Centerline
-  Water Lines
-  Road Centerline

13126 A/C/17000  
137th Ave

CROWN POINT  
PRECINCT 03

180890430022042

180890430021036

180890430022025

180890430012054

180890430022045

180890430012025

180890430021007

180890430021041

180890430021031

180890430021023

180890430021005

180890430021033

180890430021021

180890430021022

CROWN POINT  
PRECINCT-03

- 180890430021032
- 180890430021047
- 180890430021046
- 180890430021042
- 180890430021044
- 180890430021045
- 180890430021048
- 180890430021034
- 180890430021035
- 180890430021052
- 180890430022033
- 180890430021053
- 180890430022032
- 180890430022044
- 180890430022043
- 180890430021050
- 180890430021054
- 180890430022046
- 180890430021020
- 180890430021018
- 180890430021058
- 180890430021017
- 180890430021056
- 180890430021015
- 180890430021055
- 180890430021008
- 180890430012065
- 180890430021038
- 180890430021037
- 180890430022035
- 180890430022024
- 180890430021043
- 180890430021030
- 180890430022028
- 180890430021006
- 180890430022036
- 180890430021049
- 180890430022031
- 180890430021016
- 180890430021024
- 180890430022034

---

CROWN POINT

PRECINCT 03

180890430021051

180890430021019

180890430021025

---

3

---

CROWN POINT  
PRECINCT 05

180890430011000  
180890430012045  
180890430012046  
180890430012047  
180890430012027  
180890430011002  
180890430012032  
180890430012026  
180890430012033  
180890430012035  
180890430012051  
180890430012029  
180890430012068  
180890430012034  
180890430012048  
180890430021026  
180890430021027

---

180890430021028  
180890430021040  
180890430021029  
180890430021039  
180890430012028  
180890430012050  
180890430012049  
180890430011020  
180890430011029  
180890430012031  
180890430012030

---