



# PRECINCT SUMMARY STATEMENT

(IEC-8)

State Form 13332 (R7/7-06)

Indiana Election Commission (IC 3-11-1.5-15) Name of County LAKE

INSTRUCTIONS: See Indiana Code 3-11-1.5-25 for periods during which precinct boundary changes may NOT take effect.  
 Indiana Code 3-11-1.5-15 requires that a county include the following items in a proposed precinct establishment order submitted to the Indiana Election Division:  
 1. A map of each precinct to be established by the proposed order. A county may submit these maps in electronic form.  
 2. A description of the boundaries of each precinct to be established by the proposed order that identifies any census blocks located entirely within the precinct.  
 3. An estimated number of voters in each precinct to be established by the proposed order, based on the registration records maintained by the county voter registration office.  
 4. A statement designating a polling place for the precinct that complies with the polling place accessibility requirements.  
 5. Any additional information required by rules adopted by the Indiana Election Commission under IC 4-22-2.

### General Precinct Information

1. Name Of Proposed Precinct <u>CAL-10</u>		2. Is this a new precinct? <input checked="" type="checkbox"/> Yes <input type="checkbox"/> No		3. Election Division & STFID Number (To Be Completed By Election Division)	
4. District Information Congressional <u>1</u> Indiana Senate <u>2</u> Indiana House <u>14</u>					
5. Number Of Active Voters (IC 3-5-2-1.7) <u>1196</u>		6. Number Of Inactive Voters <u>155</u>		7. Number Of Registered Voters (Must Equal Total Of Active And Inactive Voters) <u>1351</u>	
8. Total Number Of Precincts In The County If Submission Is Approved Voting Precincts _____ Non-Voting Precincts _____					
9. Date Of County Executive's Adopted Order			10. Date Of First Election After Precincts Are Approved MAY 8, 2018		
11. Precincts Affected By This Proposed Order (Complete a Precinct Summary Statement for each precinct. Please note that when changing boundaries of one precinct you will need to complete a separate IEC-8 for any other precinct affected by the change.) <u>CAL-10 &amp; CAL-4</u>					

12. List Any Attached Documents (i.e. map 6 of 20 maps, etc.)  
**CENSUS BLOCK LISTING AND MAPS**

Does any portion of the newly established precinct split or divide any of the following?	Yes	No
13. School Corporation District Boundary		X
14. City or Town Boundary		X
15. City or Town Council District Boundary		X
16. Census Block Boundary		X
17. Other (Please Describe)		X

### Method of Voting

18.  Optical Scan Ballot Card  Electronic  Combination (Please Specify): \_\_\_\_\_

19. What is the designated location and address for the polling place for this precinct?  
CALUMET TOWNSHIP TRUSTEE OFFICE  
1900 W. 41ST AVE.  
GARY, IN

(NOTE: This designation of a polling place remains in effect until later action by the county executive under state law.)

20. Does this polling place meet Indiana's polling place accessibility requirements?  Yes  No

### Precinct Change Reason

21. Briefly state the reason for the precinct change. (Attach additional sheet if necessary.)  
SENATE BILL 220 - CAL 10 & CAL 4 COMBINING

### Additional Information

22. Name and Contact Information Of County Election Staff Person Who Prepared This Form:  
GENNY GASPAROVIC 219-755-3812

23. Does the county have access to Geographic Information System (GIS)?  Yes  No  
 Name and Contact Information Of County GIS Staff: Annette Mellady 219-755-3795

24. Does the county use Census Tiger files?  Yes  No

### State Office Use Only

25. Type Of Geographic Files Used by County (If Known By Staff Of The Indiana Election Division Or Office Of Census Data)



# CALUMET TOWNSHIP

- Railroad Centerline
- Water Lines
- Road Centerline

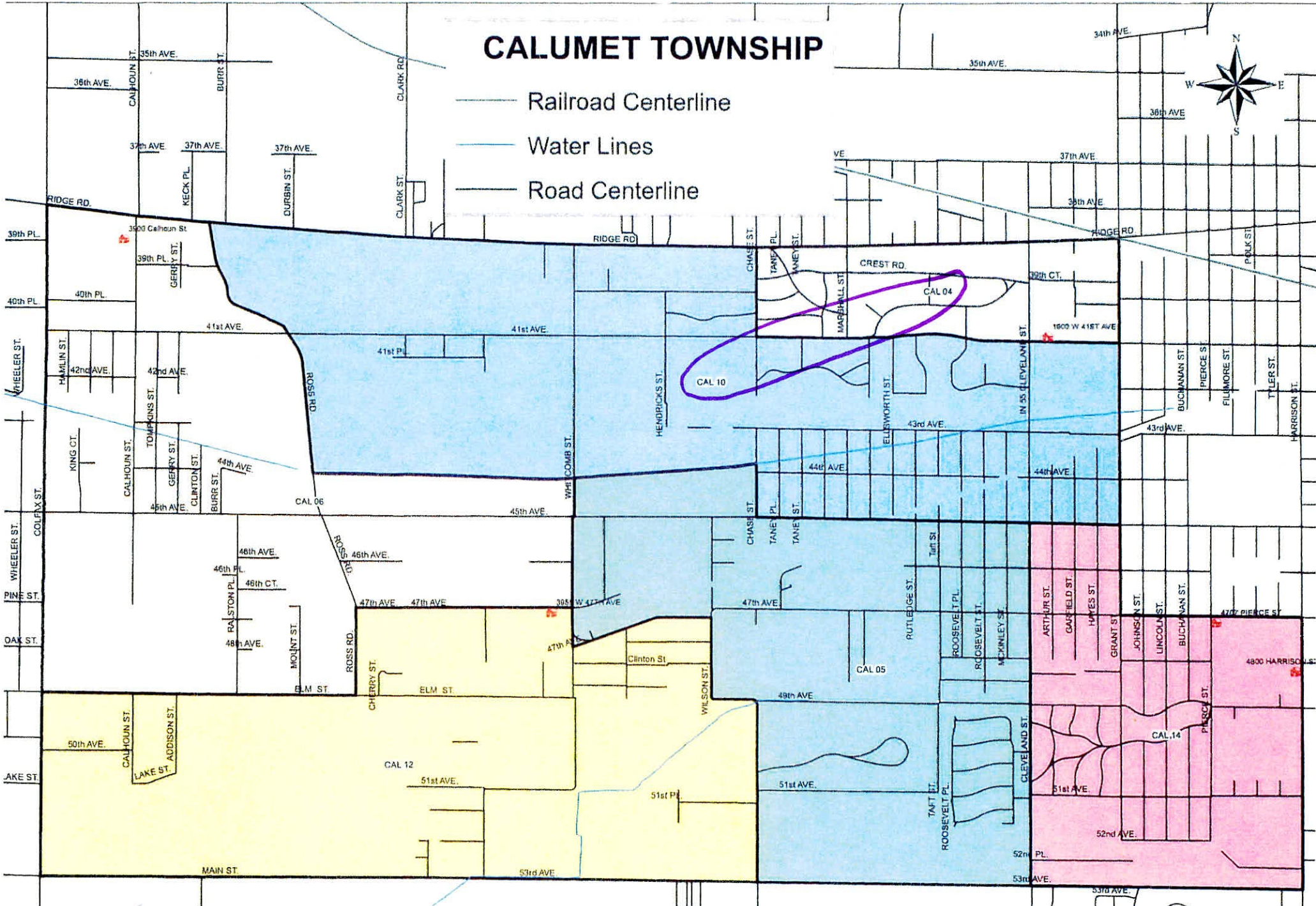

# Lake County Precincts 2016

---

P16

GEOID10

---

CALUMET  
TOWNSHIP  
PRECINCT 04

180890413022003  
180890413022002  
180890413022025  
180890413022006  
180890413022007  
180890413022008  
180890413022024  
180890413022001  
180890413022000  
180890413022009  
180890413022011  
180890413022012  
180890413022014  
180890413022010  
180890413022013  
180890413022033  
180890413022023

---

TOWNSHIP  
PRECINCT 10

180890415001003  
180890413022016  
180890413022028  
180890413022026  
180890415001005  
180890415001004  
180890413021004  
180890413022004  
180890413021000  
180890413022021

---

180890413022005  
180890413022017  
180890413022019  
180890413022020  
180890413022018  
180890413022032  
180890415001000  
180890415001006  
180890413021005  
180890415001002  
180890415001012  
180890413022027  
180890413022022  
180890415001001  
180890415001007  
180890413022015  
180890413022029  
180890413021003  
180890413022031

---