

WABASH

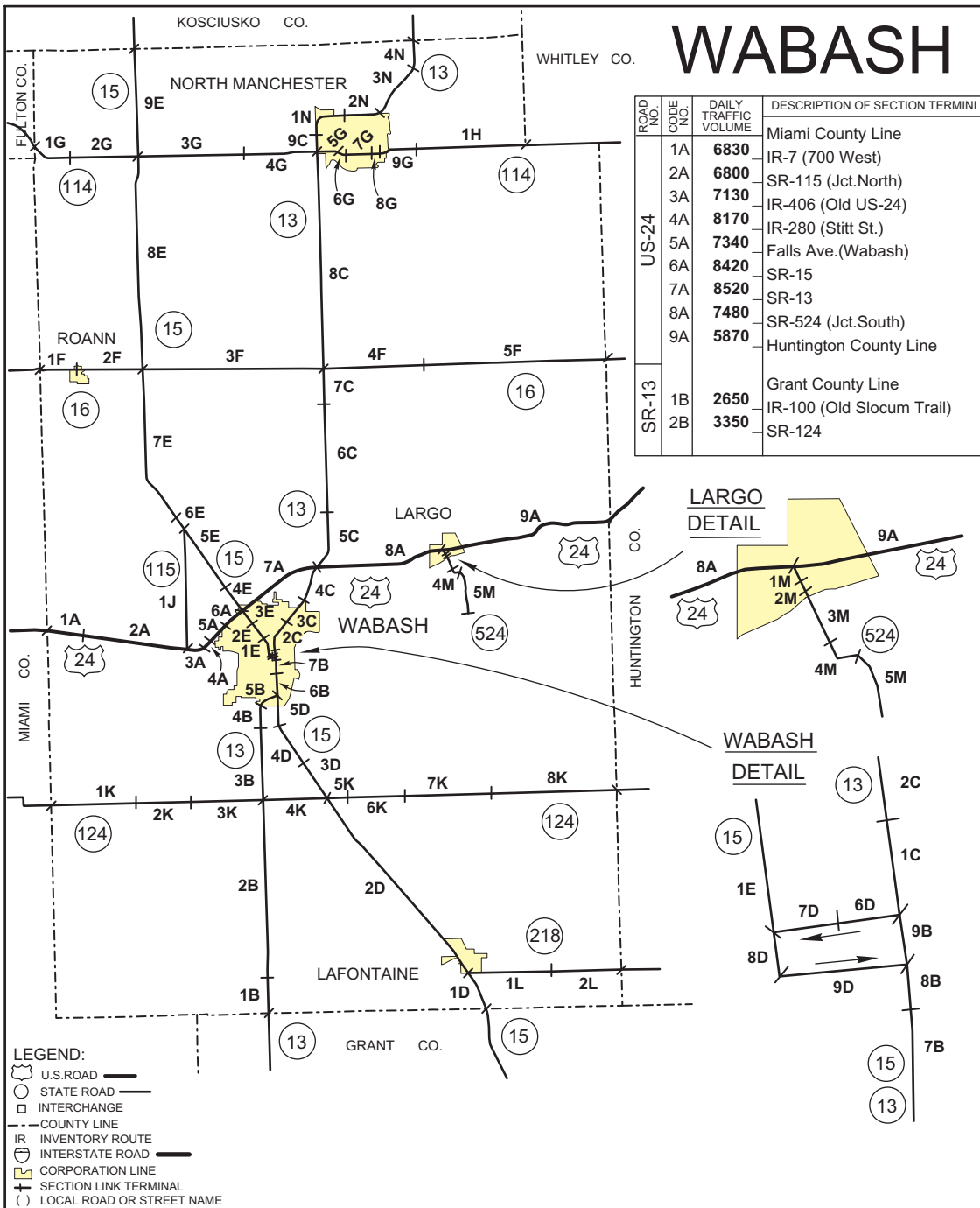

ROAD NO.	CODE NO.	DAILY TRAFFIC VOLUME	DESCRIPTION OF SECTION TERMINI
US-24	1A	6830	Miami County Line
	2A	6800	IR-7 (700 West)
	3A	7130	SR-115 (Jct. North)
	4A	8170	IR-406 (Old US-24)
	5A	7340	IR-280 (Stitt St.)
	6A	8420	Falls Ave. (Wabash)
	7A	8520	SR-15
	8A	7480	SR-13
	9A	5870	SR-524 (Jct. South)
SR-13	1B	2650	Grant County Line
	2B	3350	IR-100 (Old Slocum Trail)
			SR-124

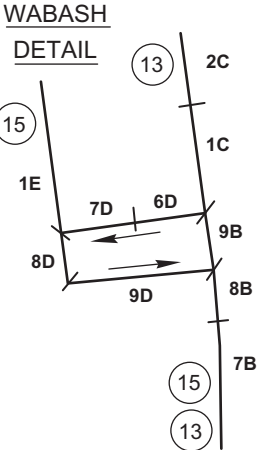
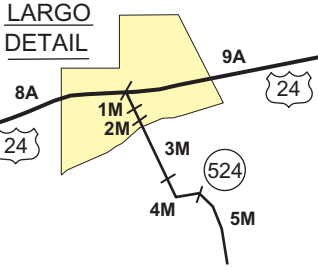

ROAD NO.	CODE NO.	DAILY TRAFFIC VOLUME	DESCRIPTION OF SECTION LINK TERMINI
SR-13	3B	3440	SR-124
	4B	4050	IR-34 (France Rd.) (400 South)
	5B	6390	Vernon St. (Wabash)
	6B	14740	SR-15 (Jct. South)
	7B	13840	LaFontaine Ave. (Wabash)
	8B	12670	Water St. (Wabash)
	9B	11460	SR-15 Southbound (Canal St.)
	1C	10600	SR-15 Northbound (Market St.)
	2C	11820	Hill St. (Wabash)
	3C	9720	Harrison St. (Wabash)
	4C	7830	Gillen Ave. (Wabash)
	5C	5730	US-24
	6C	4900	IR-58 (200 North)
	7C	4330	IR-64 (500 North)
	8C	4620	SR-16
	9C	6590	SR-114
SR-15	1N	4720	Ninth St. (North Manchester)
	2N	5210	Beckley St. (North Manchester)
	3N	3370	East St. (North Manchester)
	4N	2890	IR-90 (Main St.) (Liberty Mills)
	1D	5840	Kosciusko County Line
	2D	6490	Grant County Line
	3D	7880	SR-218
	4D	8720	SR-124
	5D	9670	IR-30 (500 South)
	6D	2860	IR-129 (150W) (Walnut Tree Pike)
	7D	5510	SR-13 (Jct. South)
	8D	9560	(SR-15 follows SR-13)
	9D	4230	(Begin SR-15 One-way Pair)
	1E	12430	(SR-15 Westbound on Market St.)
	2E	13900	SR-13 Ahead & SR-15 Behind
	3E	14450	Miami St. (Wabash)
4E	7390	SR-15 Southbound Lt. (Cass St.)	
5E	5350	(SR-15 South over Cass St. then East over Canal St.)	
6E	5380	SR-15 Northbound (Market St.)	
7E	4110	Canal St. (Wabash)	
SR-16	8E	4000	SR-13 / SR-15 (Wabash St.)
	9E	4450	(End SR-15 One-way Pair)
	1F	1520	SR-15 Northbound (Market St.)
	2F	1670	Stitt St. (Wabash)
	3F	760	Harrison St. (Wabash)
	4F	700	Gillen Ave. (Wabash)
	5F	570	US-24
	1G	2320	SR-15
	2G	2890	IR-51 (50 East)
	3G	3640	IR-61 (Old SR-15)
	4G	5670	IR-63 (America Rd.)
	5G	9390	Huntington County Line
	6G	9530	SR-15
	7G	9450	IR-77 (600 East)
	8G	8370	Huntington County Line
	9G	4310	SR-15
1H	3600	IR-77 (600 East)	
SR-114	1J	1200	Huntington County Line
	2J	940	SR-15
	3J	1210	SR-15
	4J	1180	SR-15
	5J	2630	SR-15
	6J	1840	SR-15
	7J	1620	SR-15
	8J	1310	SR-15
	1K	850	SR-15
	2K	940	SR-15
	3K	1210	SR-15
	4K	1180	SR-15
	5K	2630	SR-15
	6K	1840	SR-15
	7K	1620	SR-15
	8K	1310	SR-15
SR-115	1L	1310	SR-15
	2L	1010	SR-15
	1M	1500	SR-15
	2M	1500	SR-15
	3M	1390	SR-15
	4M	1000	SR-15
	5M	610	SR-15