

White River Bridge

I-69 Section 6.5 Design Build



MEET THE PRESENTERS



A portrait of Doug VanSlambrook, a man with short brown hair and a beard, wearing a dark blue blazer over a light blue checkered shirt. The background is a plain, light gray wall. The Walsh Construction logo is overlaid in the bottom right corner of the image.

Doug VanSlambrook
WALSH CONSTRUCTION



A portrait of Corey Gilreath, a man with short brown hair and a beard, wearing a light gray blazer over a blue button-down shirt. He is standing in front of a wall of several monitors displaying various construction-related images. The American Structurepoint logo is overlaid in the bottom right corner of the image.

Corey Gilreath, PE
AMERICAN STRUCTUREPOINT, INC.



PROJECT LOCATION

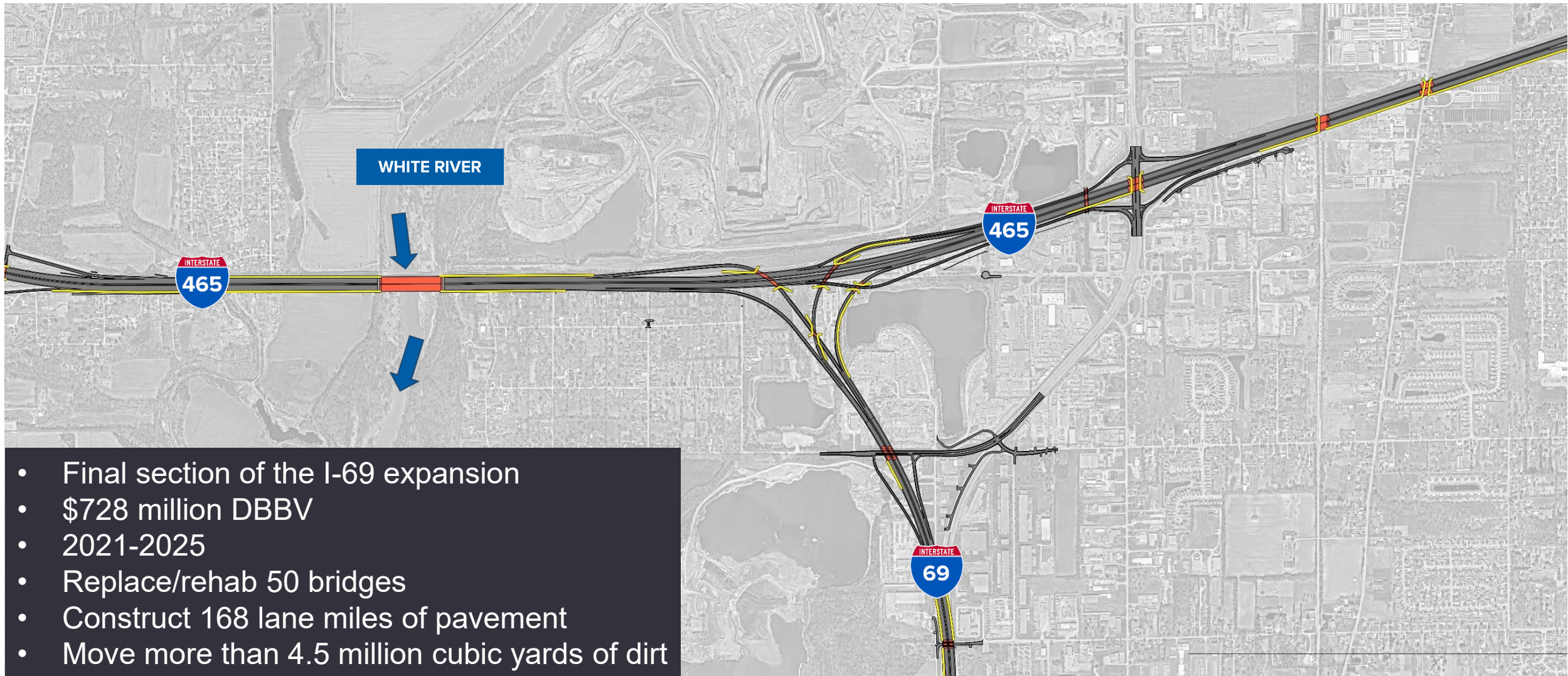

- Final section of the I-69 expansion
- \$728 million DBBV
- 2021-2025
- Replace/rehab 50 bridges
- Construct 168 lane miles of pavement
- Move more than 4.5 million cubic yards of dirt

PRE-BID HYDRAULICS OPTIMIZATIONS

Existing Bridge – 9 Span 930'

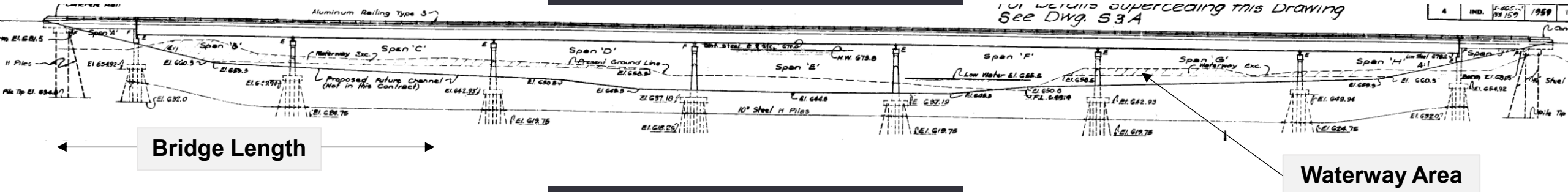

RID Design – 5 Span 897'

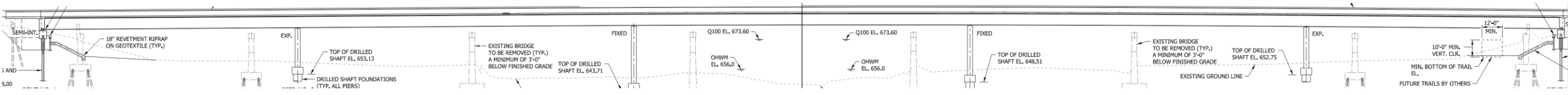

Optimized Design – 5 Span 833'

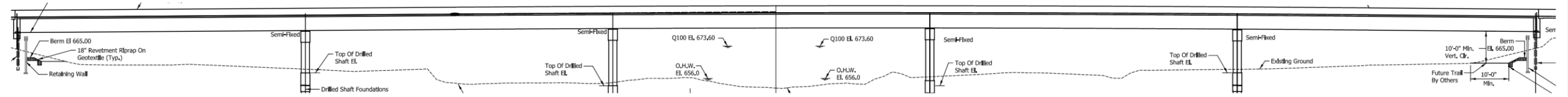

PRE-BID SUPERSTRUCTURE ALTERNATIVES

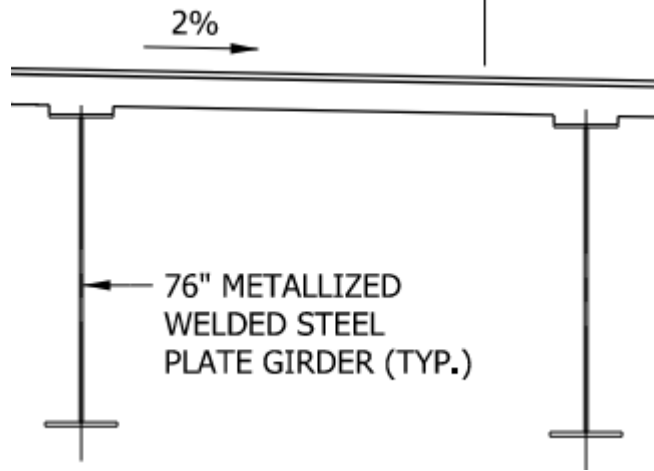

5 Span Steel Plate Girder
76" web
70 ksi flanges
150', 3 @ 198', 150'
6.1 Million lbs

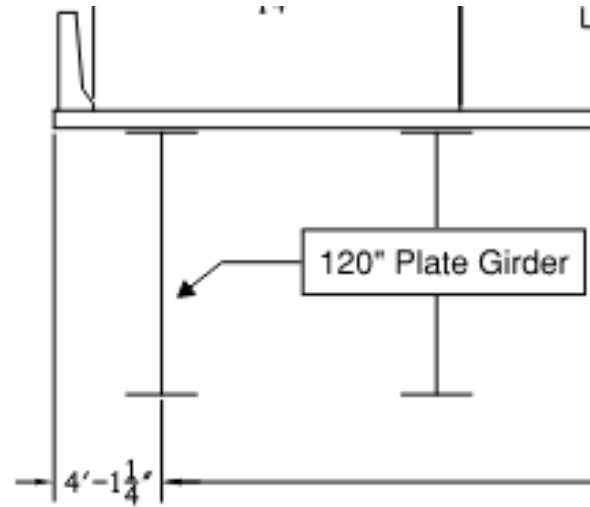

3 Span Steel Plate Girder
120" web
70ksi flanges
232', 330', 292'
10.8 Million lbs

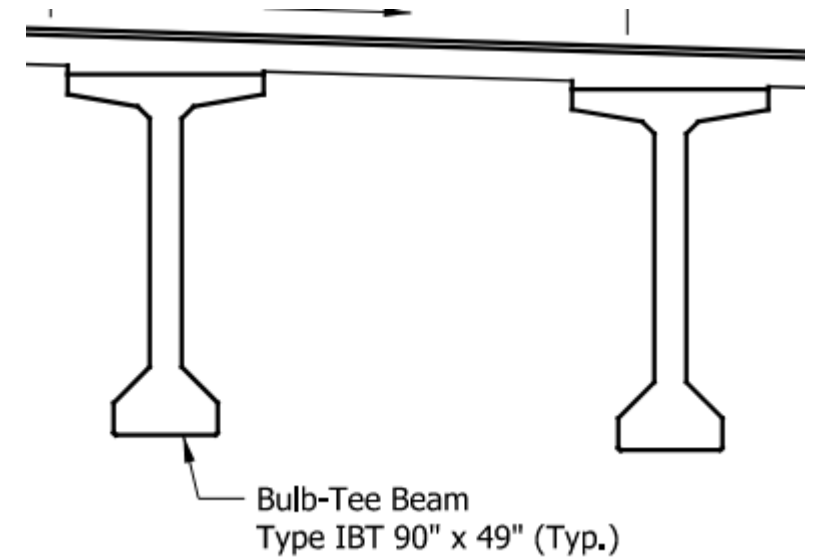

5 Span Precast Concrete
IBT 90x49
157', 168', 174', 168', 163'

POST-BID SUPERSTRUCTURE RE-DESIGN

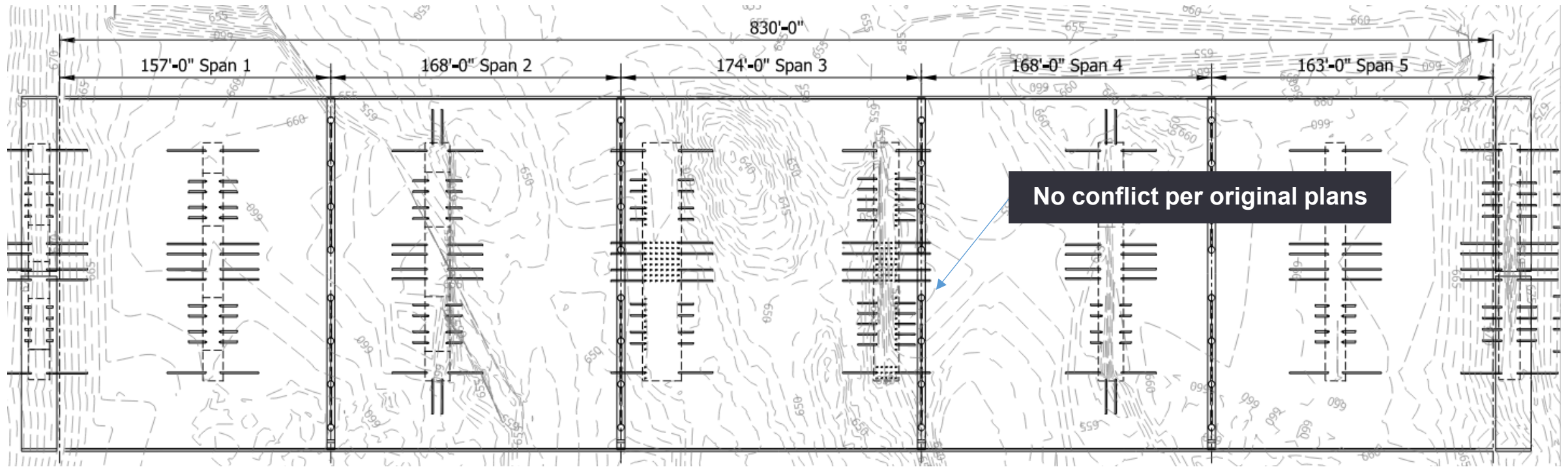

Bid Design:

IBT 90x49

5 Span Precast Concrete

157', 168', 174', 168', 163'

POST-BID SUPERSTRUCTURE RE-DESIGN

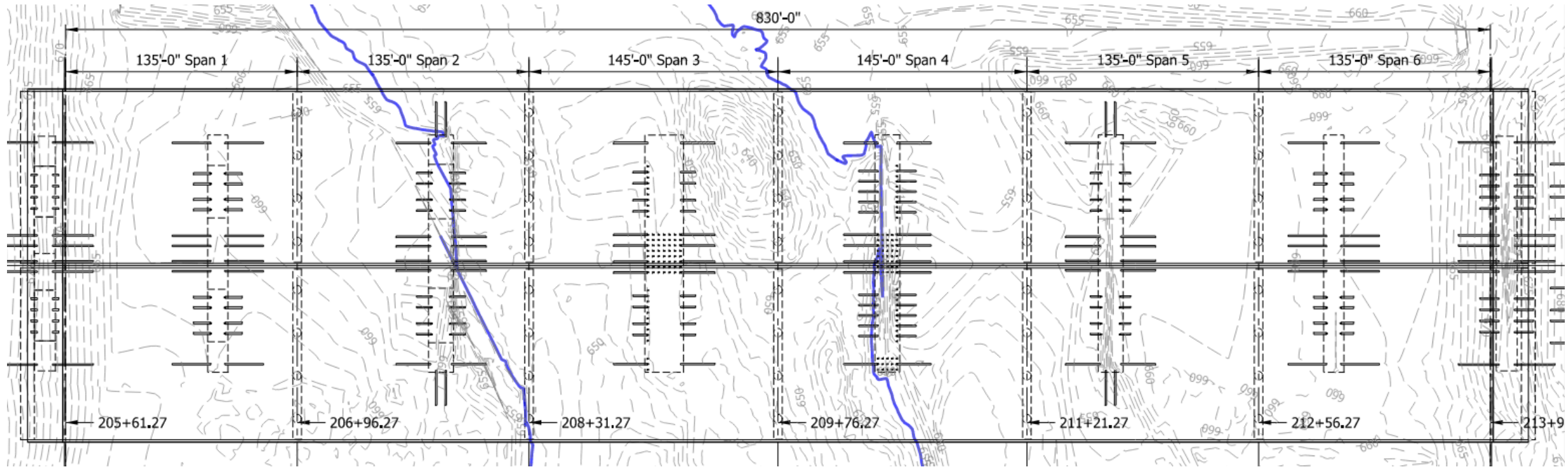

Redesign:

IBT 72x49

6 Span Precast Concrete

2 @ 135', 2 @ 145', 2 @ 135'



SUPERSTRUCTURE SELECTION CONSIDERATIONS



VS

SCHEDULE CONTROL



REDUCE LIQUIDATED DAMAGES RISK



COST SAVINGS



METALLIZATION REQUIREMENT - S.o.S.



SUBSTRUCTURE SELECTION CONSIDERATIONS



Piles vs Drilled Shafts

- Existing Substructure Conflicts
- Cofferdam