

**GENERAL NOTES:**

1. The locations of the transverse joints in the moment slab and the railing shall be the same.
- ② See Standard Drawing E 706-BRRW-09 for plan view and additional reinforcing bars in the railing at the railing joints.
- ③ The coping by be precast or cast in place. See Standard Drawing E 731-BRRW-01 for coping details.
- ④ The thickness of the coarse aggregate No. 8 shall be equal to the combined thicknesses of the first two lifts of HMA, but not less than 6 in.
5. The moment-slab thickness shall match that of adjoining PCCP, but shall not be less than 12 in., regardless of pavement type.
- ⑥ For moment slab thickness  $\leq 15$  in., this shall be 2'-0".  
For moment slab thickness  $> 15$  in., this shall be moment-slab thickness plus 12 in.
7. The moment slab shall be used only within the limits of the MSE wall.
8. Reinforcing bars in the moment slab shall be epoxy coated.

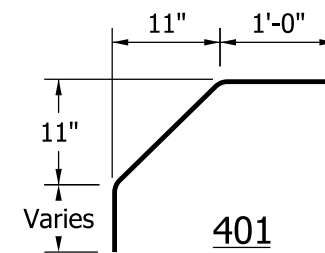
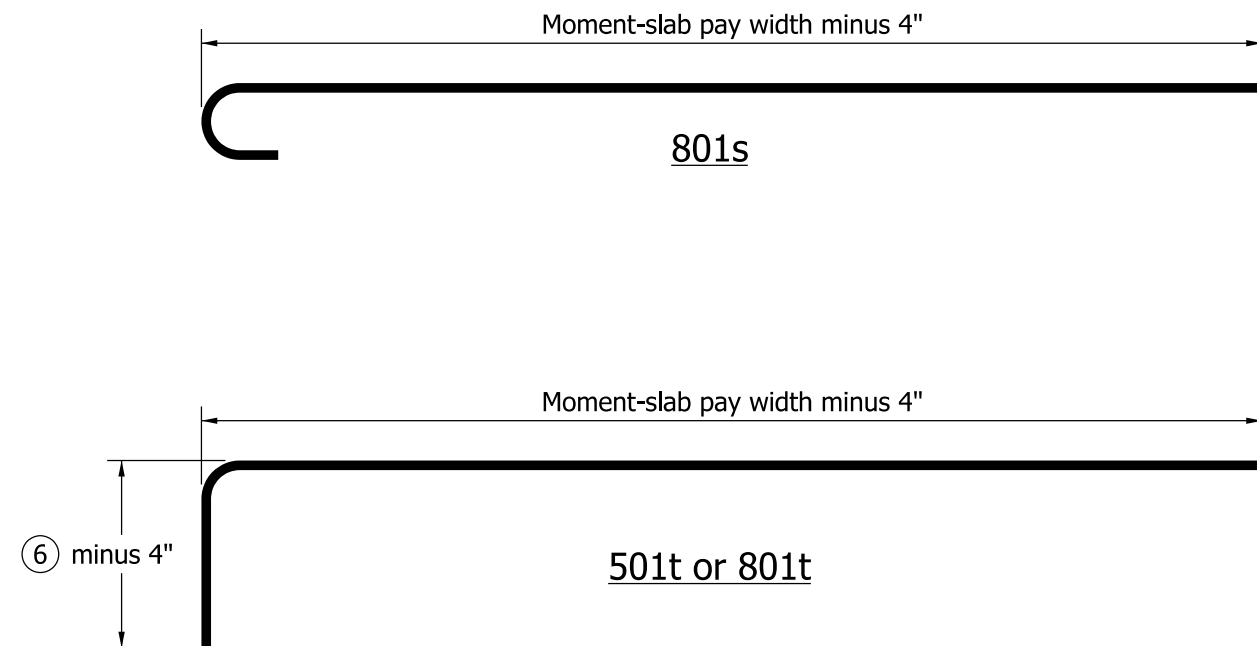

INDIANA DEPARTMENT OF TRANSPORTATION									
RAILING AND MOMENT SLAB AT MSE WALL									
SEPTEMBER 2009									
STANDARD DRAWING NO. E 706-BRRW-10									
	<table style="width: 100%; border-collapse: collapse;"> <tr> <td style="text-align: center; border-bottom: 1px solid black;"><i>/s/ Richard L. VanCleave</i></td> <td style="text-align: center; border-bottom: 1px solid black;">09/01/09</td> </tr> <tr> <td style="text-align: center; font-size: small;">DESIGN STANDARDS ENGINEER</td> <td style="text-align: center; font-size: small;">DATE</td> </tr> <tr> <td style="text-align: center; border-bottom: 1px solid black;"><i>/s/ Mark A. Miller</i></td> <td style="text-align: center; border-bottom: 1px solid black;">09/01/09</td> </tr> <tr> <td style="text-align: center; font-size: small;">CHIEF HIGHWAY ENGINEER</td> <td style="text-align: center; font-size: small;">DATE</td> </tr> </table>	<i>/s/ Richard L. VanCleave</i>	09/01/09	DESIGN STANDARDS ENGINEER	DATE	<i>/s/ Mark A. Miller</i>	09/01/09	CHIEF HIGHWAY ENGINEER	DATE
<i>/s/ Richard L. VanCleave</i>	09/01/09								
DESIGN STANDARDS ENGINEER	DATE								
<i>/s/ Mark A. Miller</i>	09/01/09								
CHIEF HIGHWAY ENGINEER	DATE								
DESIGN STANDARDS ENGINEER									