

8 - 3/4" ϕ x 1'-2 long round head bolts in 7/8" ϕ holes. (4 ea. rail) Holes are to be slotted as required for expansion

8 - 3/16" ϕ x 1'-0 long round head bolts in 1/4" ϕ holes. (4 ea. rail) Holes are to be slotted as required for expansion.

* Field measure distance to holes on concrete transition.

ELEVATION

NOTES :

1. All chamfered edges shall be 1".
2. Intermediate railing splices shall be placed every 20' with center of connection at span quarter points.
3. See Standard Drawing E 706-BRPP-05 for railing tube details and Inner sleeve details.
4. See Standard Drawing E 706-BRPP-06 for base plate detail, bearing plate detail and reinforcing bar bends.
5. See Standard Drawing E 706-TTBP-07, -08 for Concrete Bridge Railing Transition, TPS-2.
6. See Standard Drawing E 703-BRST-01 for standard 180° bar bending details.
7. All reinforcing bars designated "E" shall be epoxy coated.
8. Reinforcing bars in sidewalk shall match that shown on the bridge plans.

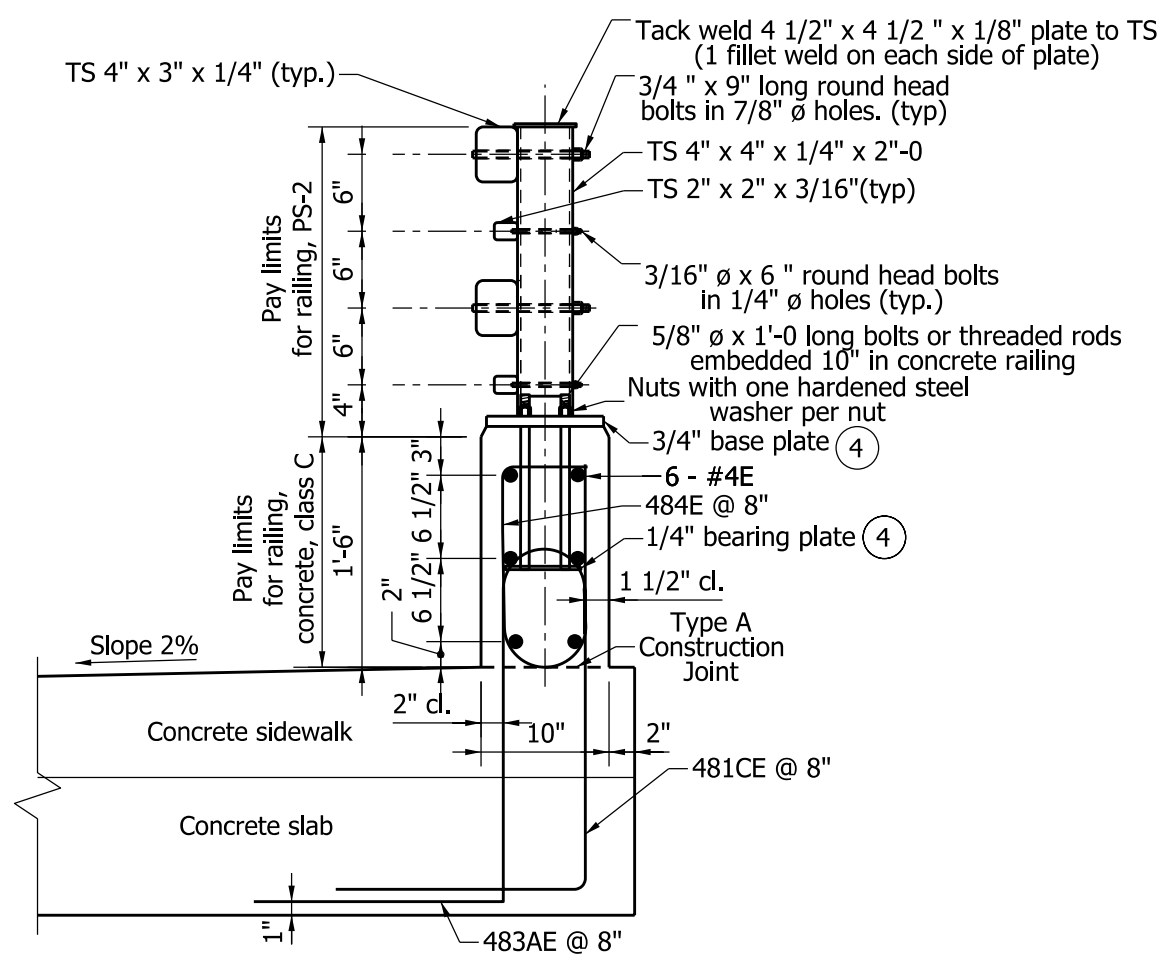
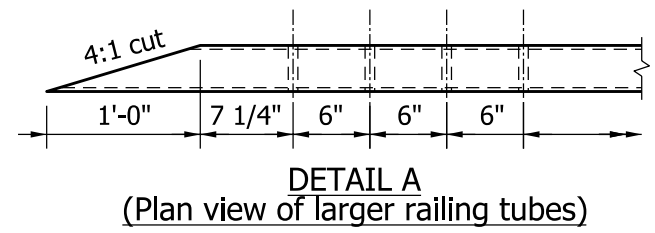
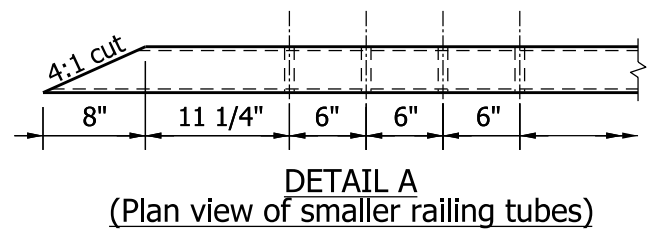

TYPICAL SECTION

INDIANA DEPARTMENT OF TRANSPORTATION	
RAILING, PS-2	
SEPTEMBER 2011	
STANDARD DRAWING NO.	E 706-BRPP-04
	/s/ <i>Richard L. VanCleave</i> 09/01/11 DESIGN STANDARDS ENGINEER DATE
DESIGN STANDARDS ENGINEER	/s/ <i>Richard K. Smuizer</i> 09/01/11 CHIEF HIGHWAY ENGINEER DATE