

**NOTES**

1. See Standard Drawings E801-TCCO-02 and E 801-TCLG-01 for additional general notes and legend.
2. See Standard Drawing E 801-TCCO-02 for Entrance Detail.
3. See Standard Drawing E 801-TCCO-03 for Exit Detail.
4. See Standard Drawing E 801-TCDV-03 for the required length of taper section for channelizing devices for construction zone speed limits less than 55 MPH.

6. Area of Type A crossovers are shown on Standard Drawing E 801-TCLG-01 and area of Type B crossover is shown on Standard Drawing E 801-TCCO-05.

- 5] Appropriate channelizing devices:
- a. For freeways - temporary concrete barrier-  
(see Standard Drawings E 801-TCCB-01 thru-04)
  - b. For non-freeways - cones or tubular markers  
(see Standard Drawing E 801-TCDV-01)

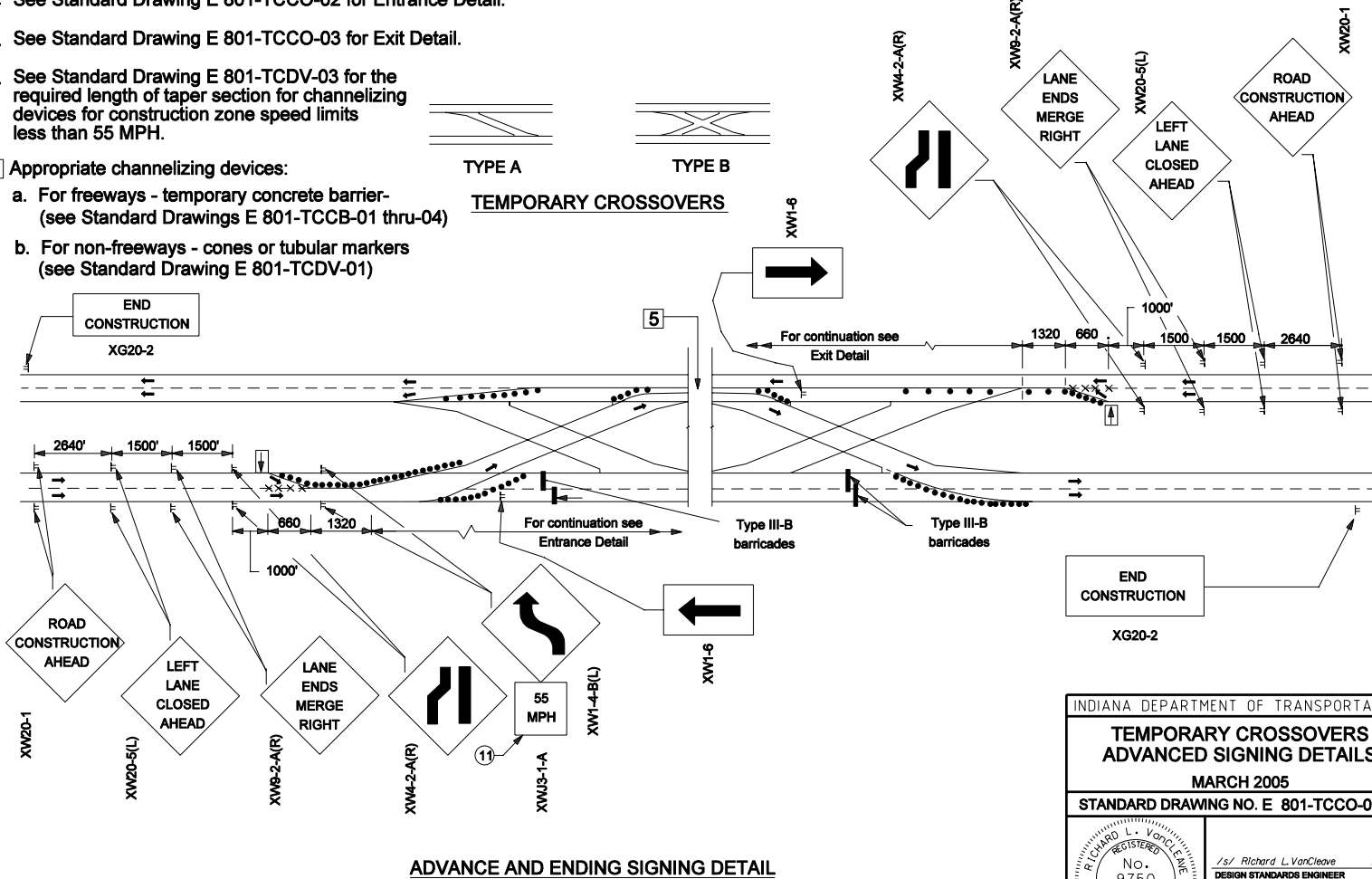
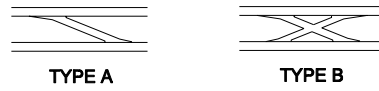

INDIANA DEPARTMENT OF TRANSPORTATION	
<b>TEMPORARY CROSSOVERS ADVANCED SIGNING DETAILS</b>	
MARCH 2005	
STANDARD DRAWING NO. E 801-TCCO-01	
	/s/ Richard L. VanCleave    3-01-05 DESIGN STANDARDS ENGINEER    DATE
	/s/ Richard K. Smutzer    3-01-05 CHIEF HIGHWAY ENGINEER    DATE
DESIGN STANDARDS ENGINEER	