

PLAN

LEGEND :
 F.F. = Front Face
 R.F. = Rear Face

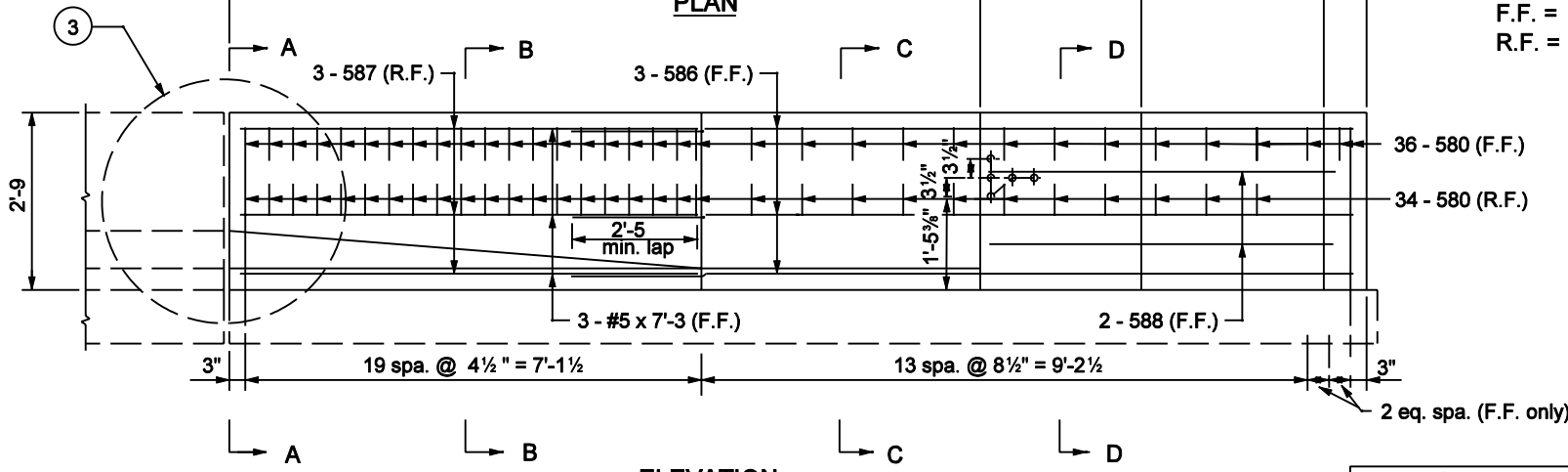

ELEVATION

**33" COMMON HEIGHT W-BEAM/
 CONCRETE BRIDGE RAILING TRANSITION**

NOTES :

- ① See Standard Drawing E 706-CBRT-03 for details of guardrail transition type WGB attachment.
2. See Standard Drawing E 706-TWBC-02 for Section A-A, B-B, C-C and D-D and Drawing E 706-TWBC-03 for reinforcement and bill of materials.
3. See Standard Drawing E 706-TASE-05 for General Notes.

INDIANA DEPARTMENT OF TRANSPORTATION

**CONCRETE BRIDGE RAILING
 TRANSITION TYPE WBC**

MARCH 2003

STANDARD DRAWING NO. E 706-TWBC-01

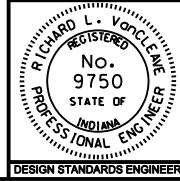

/s/ Richard L. VanCleave 3-03-03
 DESIGN STANDARDS ENGINEER DATE

/s/ Richard K. Smutzer 3-03-03
 CHIEF HIGHWAY ENGINEER DATE

DESIGN STANDARDS ENGINEER