

#4 stirrup bars  
at 2'-0 c. to c.

Cross-hatched portion is  
integral concrete curb.

**INTEGRAL CONCRETE CURB  
(BARRIER)**

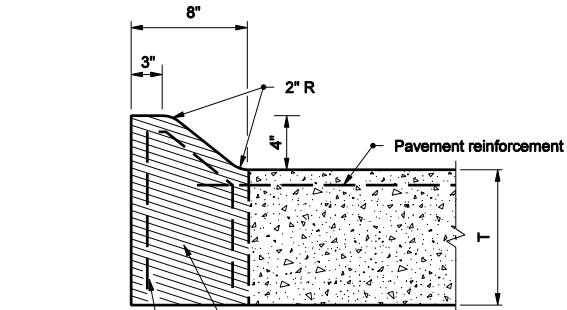

#4 stirrup bars  
at 2'-0 c. to c.

Cross-hatched portion is  
integral concrete curb type B

**INTEGRAL CONCRETE CURB  
TYPE B  
(MOUNTABLE)**

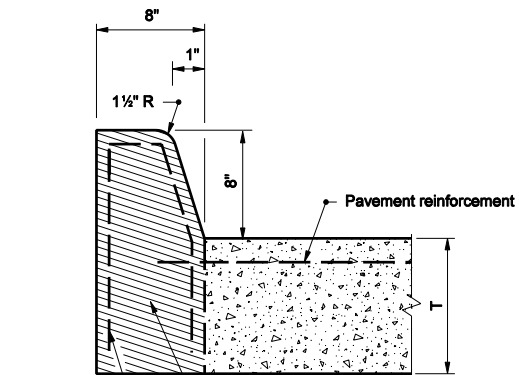

#4 stirrup bars  
at 2'-0 c. to c.

Cross-hatched portion is  
integral concrete curb  
type C.

**INTEGRAL CONCRETE CURB  
TYPE C  
(BARRIER)**

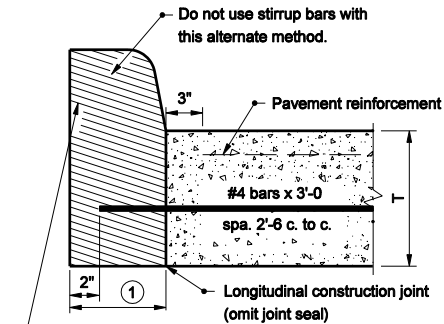

Do not use stirrup bars with  
this alternate method.

Cross-hatched portion is  
Integral concrete curb,  
Integral concrete curb, type B, or  
Integral concrete curb, type C.

**ALTERNATE METHOD  
OF CONSTRUCTION FOR ALL TYPES  
OF INTEGRAL CONCRETE CURB**

**NOTES**

- ① 8" for integral concrete curb type B or C and 7" for integral concrete curb.
- ② Concrete below this line may be poured with the pavement.

**LEGEND**

T = Nominal pavement thickness

INDIANA DEPARTMENT OF TRANSPORTATION	
<b>INTEGRAL CONCRETE CURB</b>	
SEPTEMBER 2004	
STANDARD DRAWING NO. E 605-CCIN-01	
	/s/ Richard L. VanCleave 9-01-04 DESIGN STANDARDS ENGINEER DATE
	/s/ Richard K. Smutzer 9-01-04 CHIEF HIGHWAY ENGINEER DATE
DESIGN STANDARDS ENGINEER	