

General Notes:

1. Signs and supports shall meet NCHRP 350 crash evaluation criteria, if not trailer mounted.

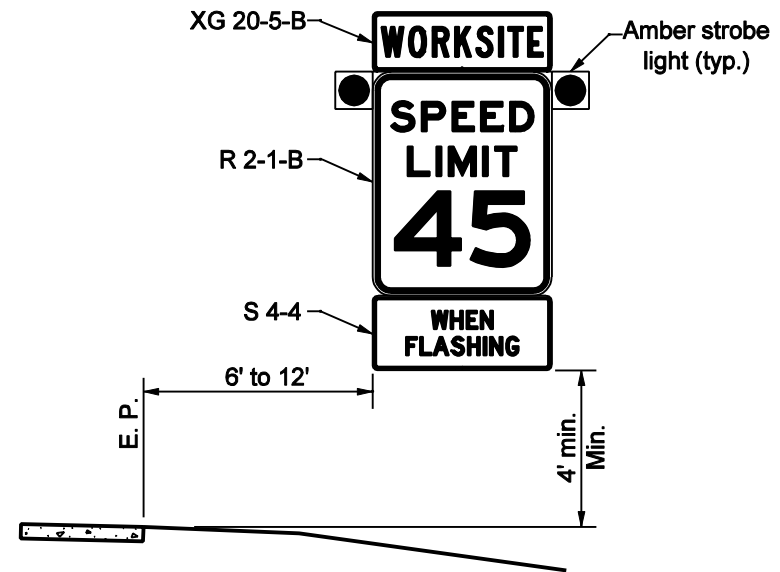
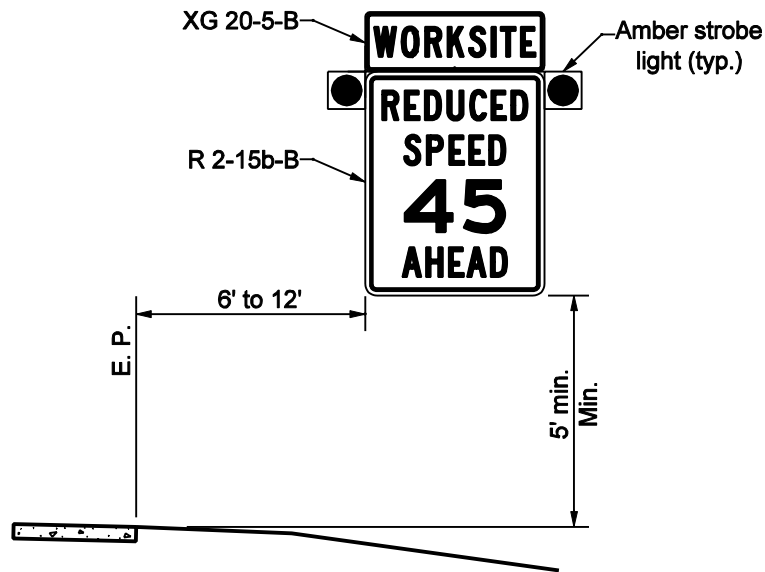

INDIANA DEPARTMENT OF TRANSPORTATION	
WORKSITE SPEED LIMIT SIGN ASSEMBLY	
SEPTEMBER 2002	
STANDARD DRAWING NO. E 801-TCDV-10	
	/s/ Richard L. VanCleave 9-03-02 DESIGN STANDARDS ENGINEER DATE
	/s/ Richard K. Smutzer 9-03-02 CHIEF HIGHWAY ENGINEER DATE
DESIGN STANDARDS ENGINEER	