

8 - 19 ϕ x 320 long round head bolts in 22 ϕ holes. (4 ea. rail) Holes are to be slotted as required for expansion

8 - 4.8 ϕ x 300 long round head bolts in 6 ϕ holes. (4 ea. rail) Holes are to be slotted as required for expansion.

* Field measure distance to holes on concrete transition.

ELEVATION

NOTES :

1. All chamfered edges shall be 25.
2. Intermediate railing splices shall be placed every 6 m with center of connection at span quarter points.
3. See Standard Drawing 706-BRPP-05 for railing tube details and Inner sleeve details.
4. See Standard Drawing 706-BRPP-06 for base plate detail and reinforcing steel bar bends.
5. See Standard Drawing 706-TTBP-07, -08 for Concrete Bridge Railing Transition, TPS-2.
6. See Standard Drawing 703-BRST-01 for standard 180° bar bending details.
7. All reinforcing bars designated "E" shall be epoxy coated.
8. Reinforcing steel in sidewalk shall match that shown on the bridge plans.

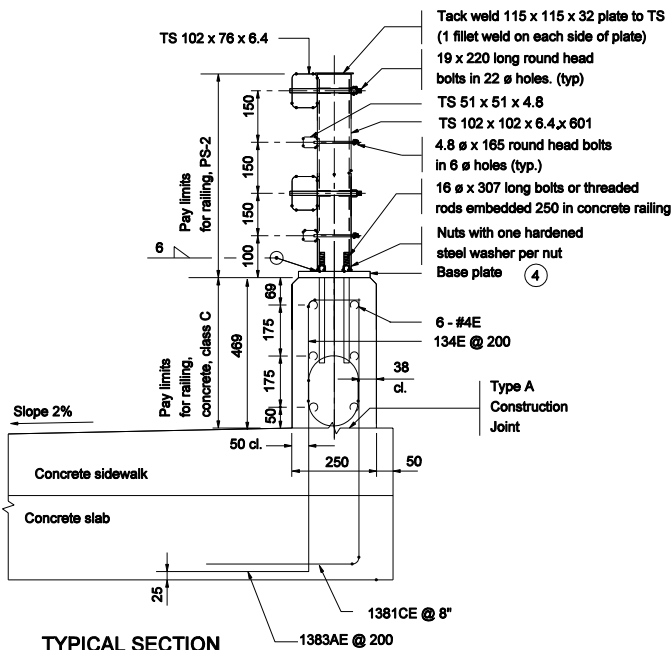

TYPICAL SECTION

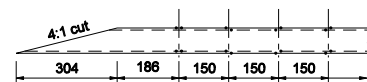

DETAIL A
(Plan view of larger railing tubes)

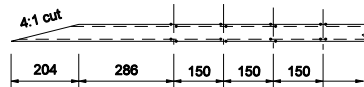

DETAIL A
(Plan view of smaller railing tubes)

All Dimension are in mm unless otherwise specified

INDIANA DEPARTMENT OF TRANSPORTATION

RAILING, PS-2

SEPTEMBER 2005

STANDARD DRAWING NO. 706-BRPP-04

	<i>/s/ Richard L. VanCleave</i> 9-01-05 DESIGN STANDARDS ENGINEER DATE
	<i>/s/ Richard K. Smutzer</i> 9-01-05 CHIEF HIGHWAY ENGINEER DATE

DESIGN STANDARDS ENGINEER