

**GENERAL NOTES**

1. See Standard Drawing E 801-TCLG-01 for General Notes and Legend.

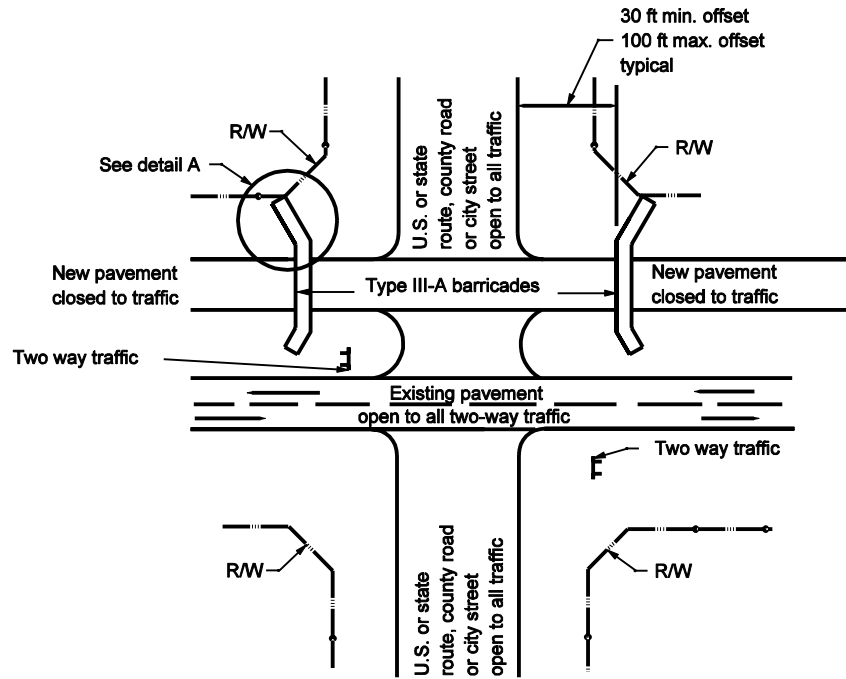

**TEMPORARY CLOSURE OF ONE NEW  
LANE OF PAVEMENT OF A DUAL  
LANE FACILITY**

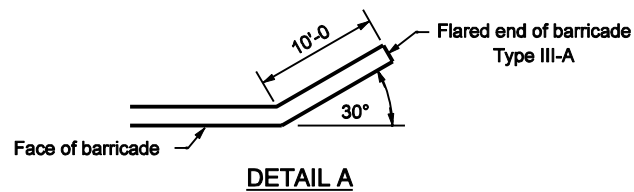

INDIANA DEPARTMENT OF TRANSPORTATION	
TEMPORARY CLOSURES	
SEPTEMBER 2002	
STANDARD DRAWING NO. E 801-TCTC-02	
	/s/ Richard L. VanCleave      9-03-02 DESIGN STANDARDS ENGINEER      DATE
	/s/ Richard K. Smutzer      9-03-02 CHIEF HIGHWAY ENGINEER      DATE
DESIGN STANDARDS ENGINEER	