

**CASTING TYPE II**

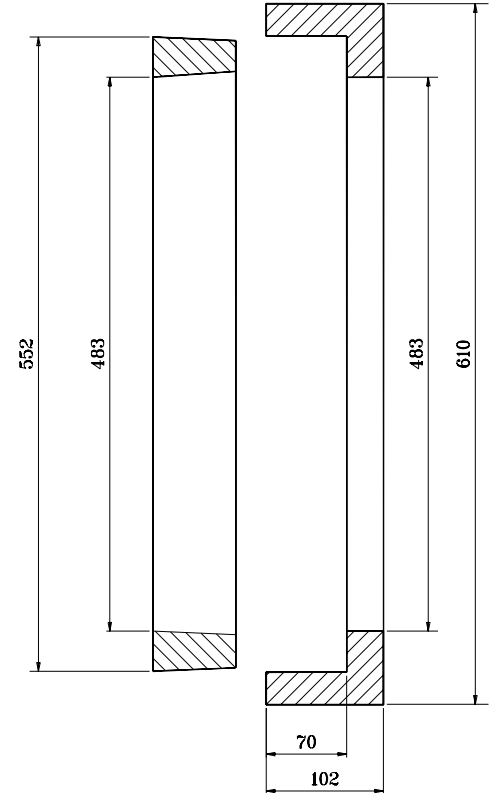

**GENERAL NOTES**

1. Casting total mass 200 kg.
2. Casting finish: no paint.

All dimensions are in mm unless otherwise specified.

INDIANA DEPARTMENT OF TRANSPORTATION

**CASTING TYPE II  
FRAME AND GRATE**

JANUARY 1999

STANDARD DRAWING NO. **720-SDCP-03**

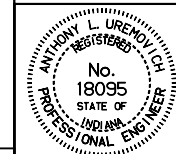

/s/ Anthony L. Uremovich 1-04-99  
DESIGN STANDARDS ENGINEER DATE

/s/ Donald W. Lucas 1-04-99  
CHIEF HIGHWAY ENGINEER DATE

Source Sheet: None