

LONGITUDINAL SAFETY BAR DETAIL

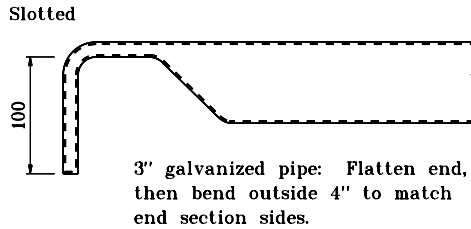

3" galvanized pipe: Flatten end, then bend outside 4" to match end section sides.

OR

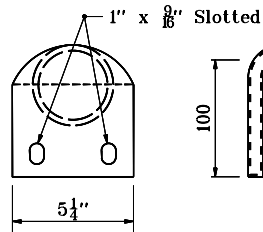
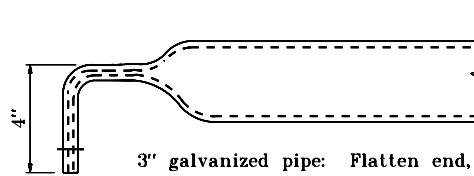
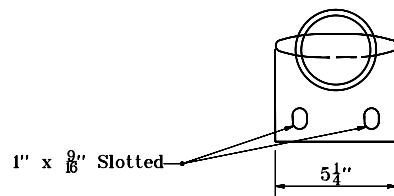

3" galvanized pipe: Flatten end, then bend outside 4" to match end section sides.

TRANSVERSE SAFETY BAR DETAILS

INDIANA DEPARTMENT OF TRANSPORTATION
**SAFETY METAL CULVERT END
 SECTIONS FOR CORRUGATED PIPE**
 JANUARY 1998

STANDARD DRAWING NO. **E 715-SMES-02**

	DETAILS PLACED IN THIS FORMAT 7-27-99
	/s/ Anthony L. Uremovich 7-27-99 DESIGN STANDARDS ENGINEER DATE
	/s/ Firooz Zandi 7-27-99 CHIEF HIGHWAY ENGINEER DATE
DESIGN STANDARDS ENGINEER	ORIGINALLY APPROVED 1-02-98