

\* Field measure distance to holes on concrete transition.

**NOTES :**

1. All chamfered edges shall be 1".
2. Intermediate railing splices shall be placed every 20' with center of connection at span quarter points.
3. See Standard Drawing E 706-BRPP-05 for railing tube details and inner sleeve details.
4. See Standard Drawing E 706-BRPP-06 for base plate detail and reinforcing steel bar bends.
5. See Standard Drawing E 706-TTBP-05 and -06 for concrete bridge railing transition, TPS-1.
6. See Standard Drawing E 703-BRST-01 for standard 180° bar bending details.
7. All reinforcing bars designated "E" shall be epoxy coated.
8. Reinforcing steel in sidewalk match that shown on the bridge plans.

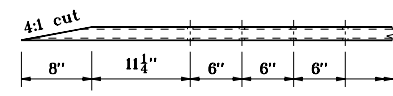
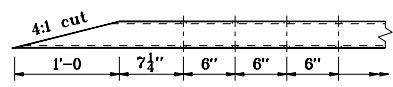
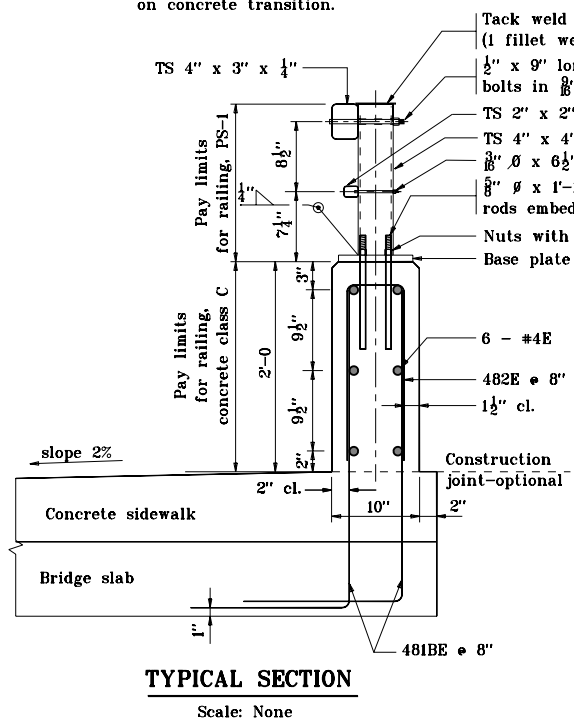

INDIANA DEPARTMENT OF TRANSPORTATION	
<b>RAILING, PS-1</b>	
MARCH 2002	
<b>STANDARD DRAWING NO. E 706-BRPP-03</b>	
	/s/ Richard L. VanCleave 3-01-02 DESIGN STANDARDS ENGINEER DATE
	/s/ Richard K. Smutzer 3-01-02 CHIEF HIGHWAY ENGINEER DATE
DESIGN STANDARDS ENGINEER	