

NOTE: 4" WHITE EDGE LINE SHALL BE PLACED ON EDGE PAVEMENT IN ALL AREAS RECEIVING NEW SHOULDERS.
 ONE 24" STOP SIGN REQ'D STA. 17+60 RT. EXISTING STOP SIGNS TO BE RELOCATED BY CONTRACTOR AS DIRECTED BY ENGINEER.
 ALL RIGHT-OF-WAY ON THIS SHEET TO BE AS SHOWN. ALL R/W DESCRIBED FROM LINE 'BRC'.

UTILITIES
 PUBLIC SERVICE INDIANA
 1000 E. MAIN STREET
 PLAINFIELD, INDIANA
 INDIANA BELL TELEPHONE
 N. RURAL STREET
 INDIANAPOLIS, INDIANA

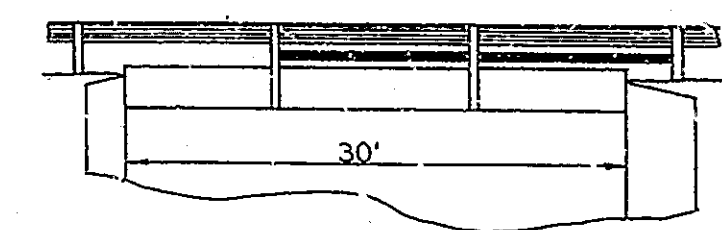

EXISTING STRUCTURE
 RC GIRDER WIDENED WITH PRECAST CONCRETE BEAMS

INDICATES NEW BITUMINOUS PAVEMENT
 INDICATES NEW 660#/SYD BITUMINOUS BASE SIZE 5D FOR SHOULDERS
 INDICATES 55 TON 18" REVETMENT RIPRAP AND 64# SYS PLASTIC FILTER CLOTH.

HYDRAULIC DATA
 DRAINAGE AREA = 1.8 SQ. MI.
 Q10 = 525 CFS
 Q50 = 700 CFS

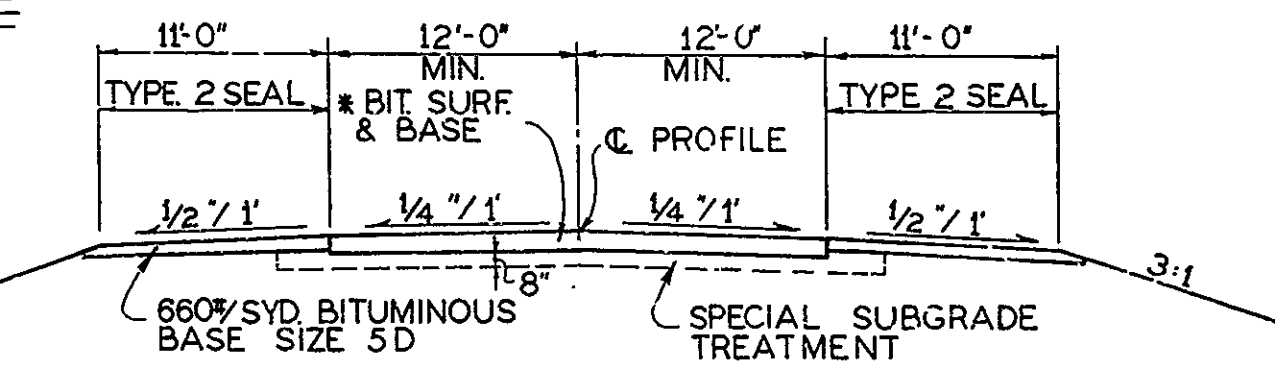

* 110#/SYD. HOT ASPHALTIC CONC. SURFACE TYPE 11B ON 1210#/SYD. BITUMINOUS BASE 5D.

NOTE: UNLESS OTHERWISE SPECIFIED THE CONTRACTOR SHALL HAVE THE OPTION OF USING EITHER HOT ASPHALTIC CONCRETE (H.A.C.) OR HOT ASPHALTIC EMULSION (H.A.E.) ON ALL BITUMINOUS ITEMS EXCEPT SURFACE.

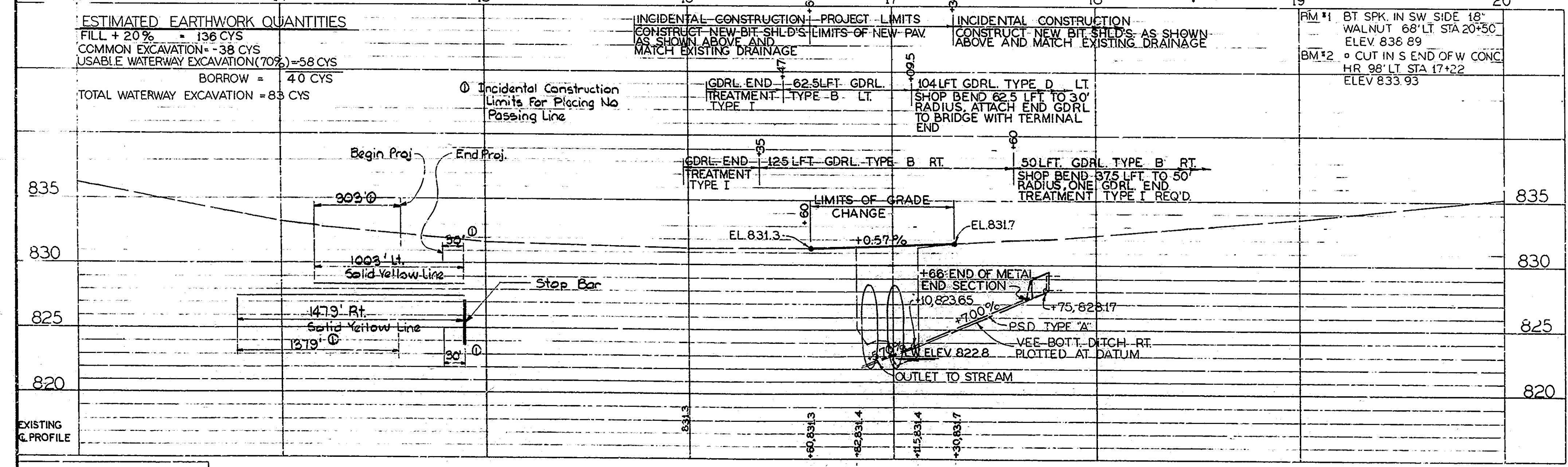
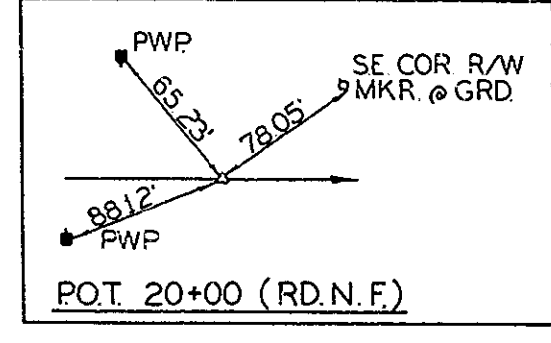
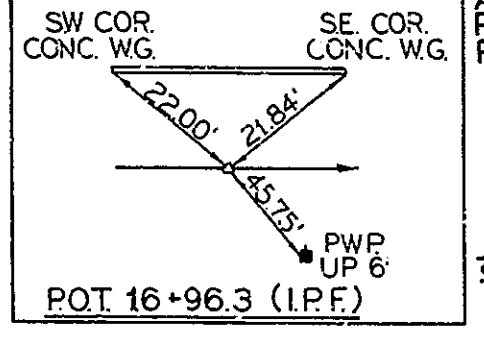
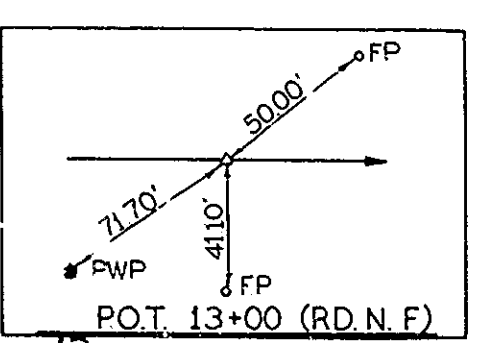

ESTIMATED EARTHWORK QUANTITIES
 FILL + 20% = 136 CYS
 COMMON EXCAVATION = 38 CYS
 USABLE WATERWAY EXCAVATION (70%) = 58 CYS
 BORROW = 40 CYS
 TOTAL WATERWAY EXCAVATION = 83 CYS

INCIDENTAL CONSTRUCTION - PROJECT LIMITS
 CONSTRUCT NEW BIT. SHLDS. LIMITS OF NEW PAV. AS SHOWN ABOVE AND MATCH EXISTING DRAINAGE

RM #1 BT SPK. IN SW SIDE 18" WALNUT 68' LT STA 20+50 ELEV 836.89
 BM #2 CUT IN S END OF W CONC. HR 98' LT STA 17+22 ELEV 833.93

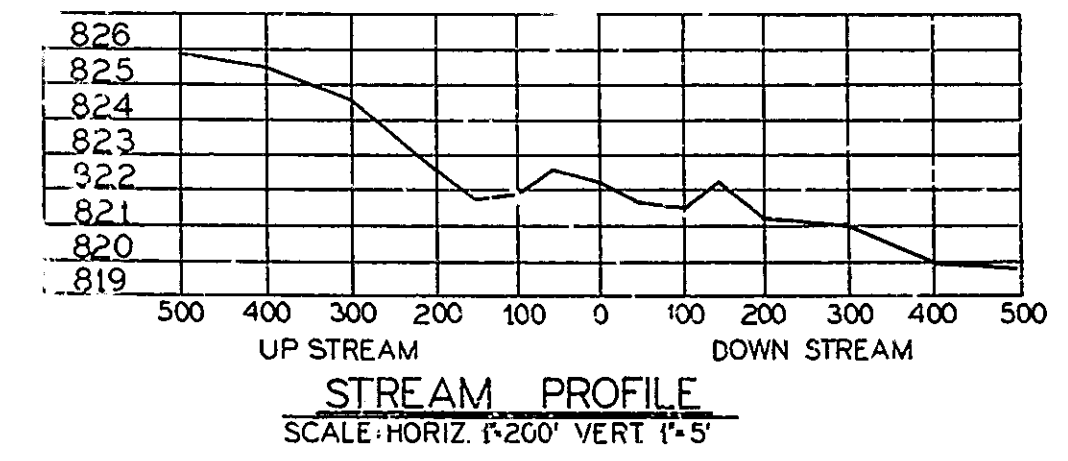

LAYOUT
 WEST FORK SLY RUN CREEK
INDIANA DEPT. OF HIGHWAYS

SCALE: DATE: 11-29-83
 Stephen F. Weintraub
 SENIOR DESIGNER

DRAWING OF SHEET 2 OF 25
 PROJECT: RS-5229 (2)
 CONTRACT NO. B-15047

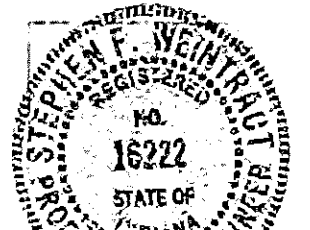

PROFILE ON PROPOSED C ROADWAY

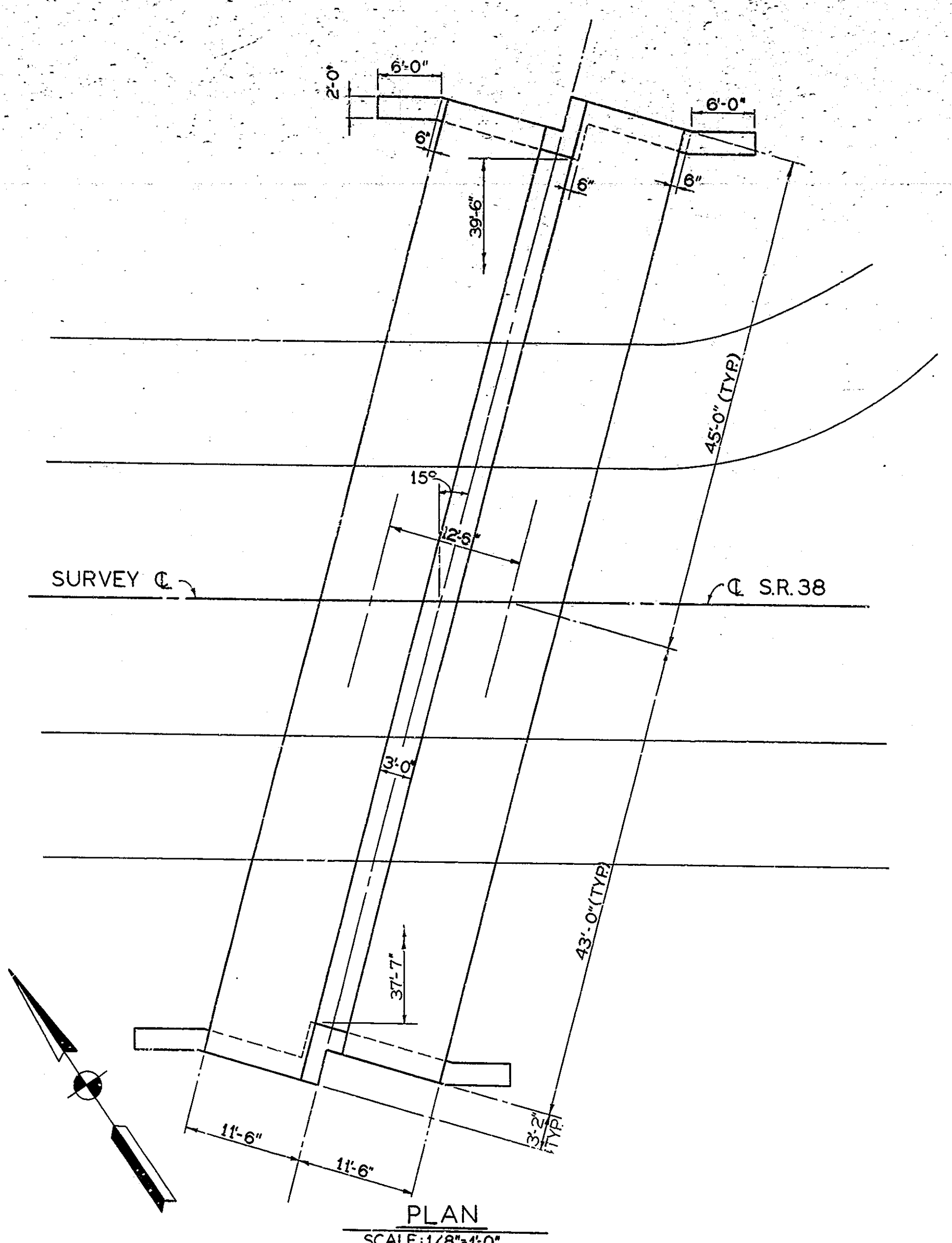

PLAN
SCALE: 1/8" = 1'-0"

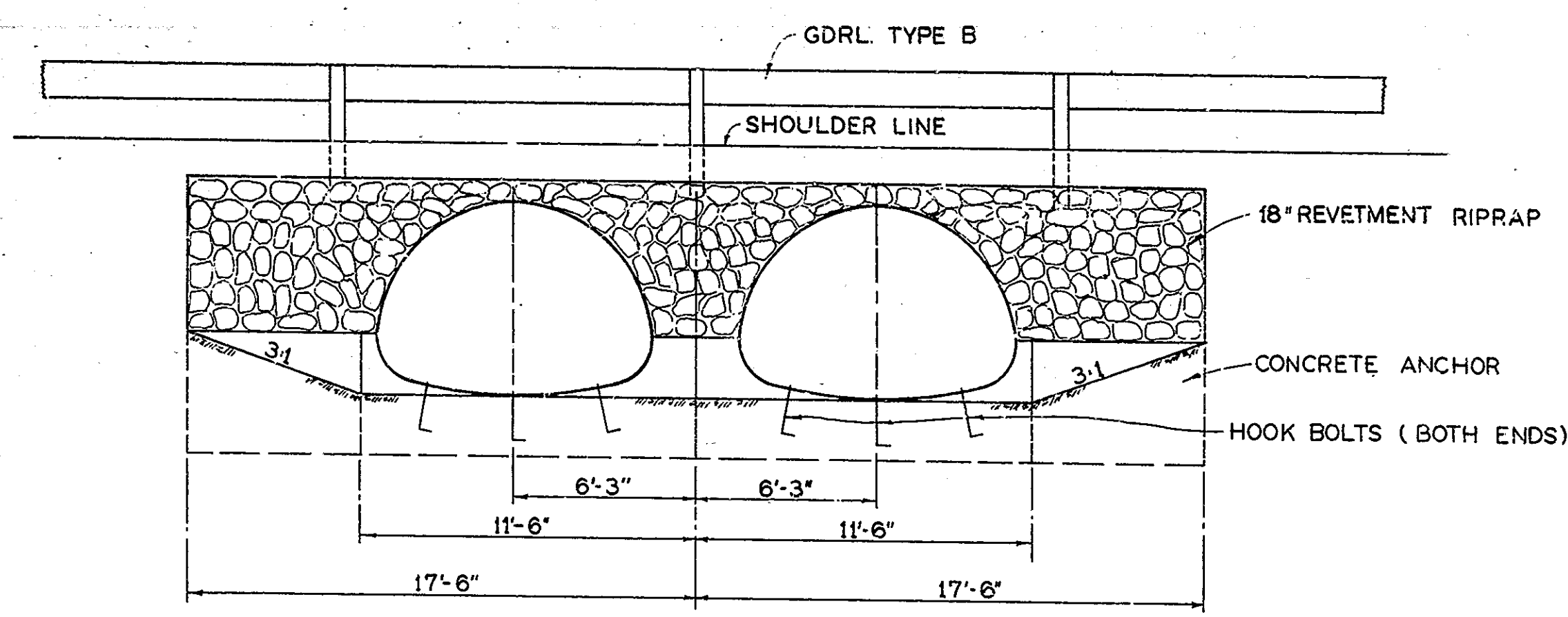

SOUTH ELEVATION
SCALE: 1/4" = 1'-0"

STANDARD DRAWINGS	
RD. STD.	DESCRIPTION
MA	R/W MARKERS
MB	PAVED SIDE DITCH
ME1	HOOK BOLTS & STRAP ANCHOR
MN	STRUCTURE BACKFILL
GR ₂	GUARDRAIL
GR ₃	GUARDRAIL
GR ₈	GUARDRAIL
GR ₉	GUARDRAIL
GR ₁₀	GUARDRAIL END TREATMENT
CB ₂	TEMPORARY CONCRETE BARRIERS
1	STANDARD DETOUR SIGNS
2A	STANDARD DETOUR SIGNS
3	STANDARD DETOUR SIGNS
4	STANDARD DETOUR SIGNS
5	SIGN DESIGN DETAILS
MT3	TRAFFIC SIGN DETAILS

- DESIGN DATA
DESIGNED FOR HS-20-44 LIVE LOAD USING DISTRIBUTION THROUGH EARTH FILL.
- GENERAL NOTES
- PIPE SHALL BE CONSTRUCTED IN ACCORDANCE WITH 1978 STANDARD SPECIFICATIONS, SECTION 717.
 - CONCRETE CLASS "A" FOR PIPE END ANCHORS TO INCLUDE COST OF ANCHOR BOLTS, REINFORCING RODS AND STRAP ANCHOR (#6 BAR).
 - B-BORROW FOR STRUCTURE BACKFILL TO BE INCLUDED IN COST PER LINEAR FOOT OF CORRUGATED STEEL PIPE.
 - ALL EXPOSED EDGES OF CONCRETE TO BE CHAMFERED 1".

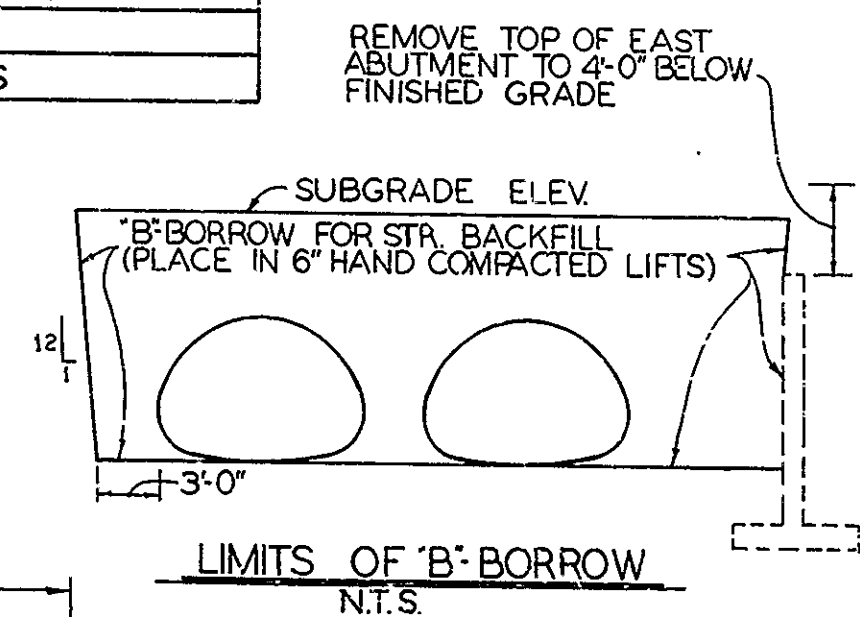

LIMITS OF B-BORROW
N.T.S.
NOTE: ALL B-BORROW FOR STR. BACKFILL TO BE INCLUDED IN COST OF PIPES.

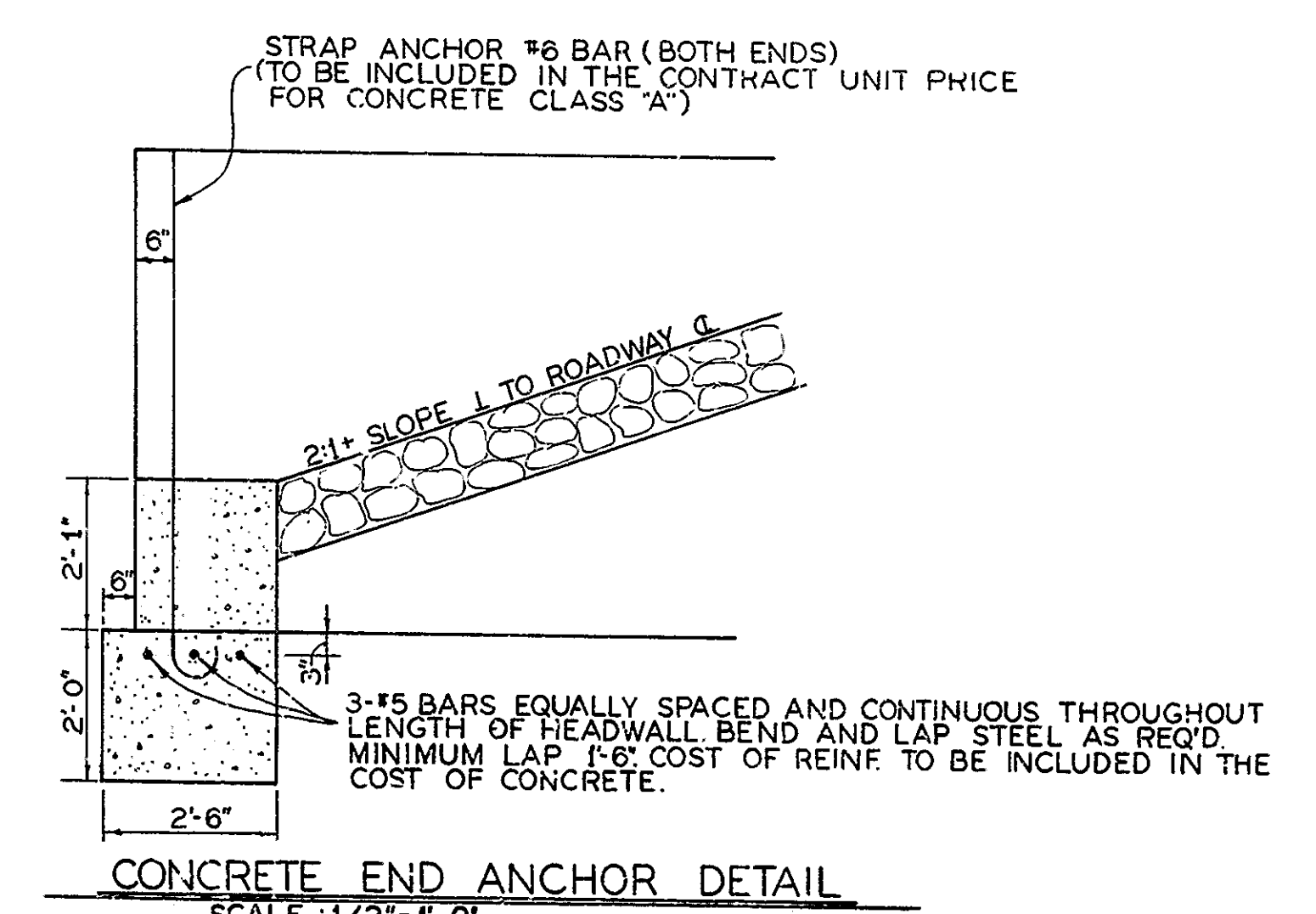

CONCRETE END ANCHOR DETAIL
SCALE: 1/2" = 1'-0"
10.52 CYS. CONCRETE CLASS "A" REQ'D PER END ANCHOR

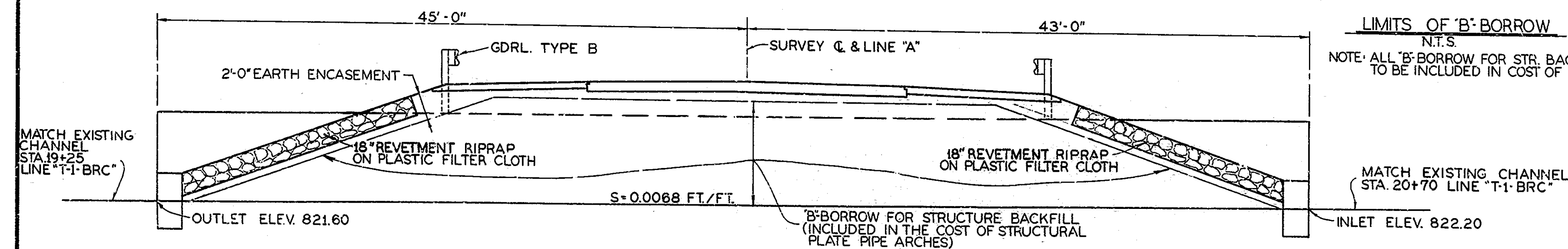

SECTION II TO C PIPE
SCALE: 3/16" = 1'-0"

CORRUGATED STEEL STRUCTURAL PLATE PIPE ARCH DETAILS

TWIN 2"x6" CORRUGATED STEEL STRUCTURAL PLATE PIPE ARCH (GA.0.109" TOP & SIDES, 0.138" BOTTL.), SIZE 3'-6" x 6'-5", SKEW 15° RT.

INDIANA DEPT. OF HIGHWAYS

SCALE: AS SHOWN

DATE: 11-29-83

Stephen F. Winkler
SENIOR DESIGNER

DRAWING: OF SHEET: 3 OF 25

PROJECT: RS-5229 (2)
CONTRACT NO. B-15047

BRIDGE FILE: 38-29-6905

DESIGNED	CKD
DRAWN	TLP
TRACED	CKD

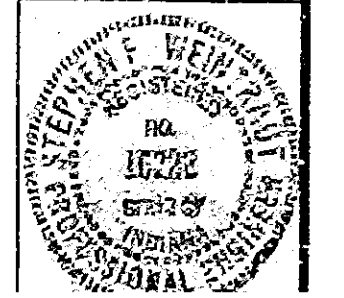

ITEM	CONCRETE				STRUCTURE				QUANTITIES																		
	CLASS C	CLASS A	CLASS B	IN FTG.	CONCRETE RAILING CLASS C	REINF STEEL TOTAL	STRUCT STEEL ***	ANCHOR RODS MK-AR	ANCHOR PLATES MS-AP	UNTREATED TIMBER	TREATED TIMBER	STEEL ENCASED CURB	STEEL BEARING	CAST IRON DRAIN PIPE	CAST IRON GRATES, BASINS & FITTINGS	RAILING TYPE OR	EXP. JOINT TYPE	EXP. JOINT CLASS	CONC. STR. BOX BEAMS TYPE	MEMBERS I-BEAM TYPE	APPLIED SHEET MEMBRANE	BITUM. MIXTURE FOR APPROACHES	MOD. PC CONCRETE SURFACE	DECK DRAIN	SURFACE SEAL		
	CU. YDS.	CU. YDS.	CU. YDS.	CU. YDS.	CU. YDS. LIN. FT.	LBS.	LBS.	EACH.	EACH.	NO. LIN. FT.	NO. LIN. FT.	NO. LIN. FT.	NO. LIN. FT.	LBS.	LBS.	LIN. FT.	LIN. FT.	LIN. FT.	SQ. FT.	LIN. FT.	SQ. FT.	TONS	CU. YDS.	EACH.	SQ. FT.		
TOTALS																											

Remf. Steel for Approach Structures
 Remf. Steel for R.C. Bridge Approaches
 Remf. Steel for Lip Gutter, Pvmf., Tapers, etc.

STRUCT NO.	LOCATION	SIZE	APPROACH DESCRIPTION		LENGTH LIN. FT.	CONCR. CL. A IN STPS CU. YDS.	STRUCTURES		REMARKS
			KIND	REINFORCING STEEL LBS.			PIPE END SEC. EACH.		
1	STA. 16+91 C. LINE "BRC"	96x65" TWIN 2x6" CORRUGATED STEEL STRUCTURAL PLATE PIPE ARCH	176	210					TWO SPECIAL END ANCHORS REQ'D (SEE SHEET N°3)
2	STA. 17+72 RT.	18" C.S.P. (0.064")	8				1		REMOVE EXIST. END SECTION
TOTALS									

Total of Reinforcing Steel Carried to "Structure Quantities"

LT OR RT	STATION TO STATION	TYPE	PAVED SIDE DITCH (LIN. FT.)					SODDING (SQ. YD.)					
			PAY LENGTH	NO OF LUGS	PAY LENGTH	CUT OFF WALLS	PAY LENGTH	TOTAL PAY LENGTH	FOR PSD	FOR DITCHES	SHOULDERS	OTHER	TOTAL SOD
RT.	16+64 TO 17+66	A	82	1	8	2	16	106	25				25

LOCATION LT/RT STATION	DESCRIPTION	WIDTH FT.	RADI. FT.	GRADE LENGTH FT.	DIST. BEYOND R/W FT.	EXCAVATION (CY)		BITUM. SURFACE		BITUM. BINDER		BASE #/SQ. YD.	BASE TONS	COMP. AGG. BASE	
						CUT	FILL	#/SQ. YD.	TONS	#/SQ. YD.	TONS			Depth (in)	TONS
TOTALS															

NOTES
 Weight of Spirals includes weight of 1/2 extra turns top and bottom
 Sockets and 1/2 turns at base included in cost of Spirals

REVISIONS	
DATE	ITEM

BRIDGE SUMMARY
INDIANA DEPT. OF HIGHWAYS
 DATE: 11-29-83

Edward F. Winshaw
 ASSISTANT ENGINEER OF BRIDGE DESIGN

STRUCTURE PAY ITEMS				
CODE NO.	DESCRIPTION	UNIT	STRUCTURE	TOTAL QUANTITY
51002	CONCRETE CLASS C IN SUPERSTRUCTURE	CYS.		
51002	CONCRETE CLASS A IN SUPERSTRUCTURE	CYS.		
51005	CONCRETE CLASS A IN SUBSTRUCTURE	CYS.		
51010	CONCRETE CLASS B ABOVE FOOTINGS	CYS.		
51015	CONCRETE CLASS B IN FTGS	CYS.		
51875	SPECIAL CLASS A CONCRETE	SET.		
51045	CONCRETE STRUCTURAL MEMBERS	LSUM		
51030	REINFORCING STEEL	LBS.		
51632	EPOXY COATED REINF. STEEL	LBS.		
51035	STRUCTURAL STEEL	LBS.		
51038	STRUCTURAL STEEL	LSUM		
51090	BRONZE PLATES	LBS.		
51070	ANCHOR PLATES (MK-AP 1)	EACH		
51075	ANCHOR PLATES (MK-AP 2)	EACH		
51080	ANCHOR PLATES (MK-AP 3)	EACH		
51085	ANCHOR PLATES (MK-AP 4)	EACH		
51112	ANCHOR BOLTS	EACH		
51068	TIE DOWN ASSEMBLY MK-UA	EACH		
51095	CAST IRON DRAIN PIPE 4 IN.	LBS.		
51100	CAST IRON DRAIN PIPE 6 IN.	LBS.		
51105	CAST IRON DRAIN PIPE 8 IN.	LBS.		
51110	CAST IRON GRATES BASIN AND FITTINGS	LBS.		
51134	REMOVAL OF PRESENT RAILING	LFT.		
51132	RAILING RESET	LFT.		
51115	RAILING (TYPE 5 OR C)	LFT.		
51120	RAILING (TYPE 5A OR C1)	LFT.		
51125	RAILING (TYPE 6 OR D)	LFT.		
51130	RAILING (TYPE 7 OR E)	LFT.		
51020	CLASS C CONCRETE RAILING	CYS.		
51025	CLASS C CONCRETE RAILING	LFT.		
51131	BARRIER RAILING TYPE X	LFT.		
51215	CLASS X EXCAVATION	CYS.		
51220	HET EXCAVATION	CYS.		
51223	WATERWAY EXCAVATION	CYS.		83
51224	WATERWAY EXCAVATION	LSUM		
51225	DRY EXCAVATION	CYS.		
51230	FOUNDATION EXCAVATION (UNCLASSIFIED)	CYS.		
51813	PNEUMATICALLY PLACED MORTAR	SFT.		
51870	REPOINTING MASONRY IN STRS	SFT.		
51814	WELDED STEEL WIRE FABRIC	SFT.		
51859	PAINTING OLD STEEL BRIDGE	LSUM		
51881	EXPANSION JOINT TYPE BS2	LFT.		
51885	EXPANSION JOINT TYPE BS6	LFT.		
51887	EXPANSION JOINT TYPE BS8	LFT.		
51888	EXPANSION JOINT TYPE BS9	LFT.		
51890	EXPANSION JOINT TYPE BS11	LFT.		
51925	EXPANSION JOINT CLASS S-S	LFT.		
51926	EXPANSION JOINT CLASS T-S	LFT.		
51872	OVERLAY DAM	SFT.		

STRUCTURE PAY ITEMS				
CODE NO.	DESCRIPTION	UNIT	STRUCTURE	TOTAL QUANTITY
51135	TIMBER PILES FURNISHED UNREATED	LFT.		
51140	TIMBER PILES DRIVEN UNREATED	LFT.		
51145	TIMBER PILES TURN TREATED	LFT.		
51150	TIMBER PILES DRIV. TREATED	LFT.		
51155	PILE SHELLS FURNISHED AND DRIVEN (12 INCH)	LFT.		
51160	PILE SHELLS FURNISHED AND DRIVEN (14 INCH)	LFT.		
51185	STEEL H PILES FURNISHED AND DRIVEN (8 BP 36)	LFT.		
51190	STEEL H PILES FURNISHED AND DRIVEN (10 BP 42)	LFT.		
51195	STEEL H PILES FURNISHED AND DRIVEN (12 BP 53)	LFT.		
51210	PILE ENCASEMENT (CONCRETE)	LFT.		
51328	REMOVAL OF PRESENT STR. (PORTIONS)	LSUM		
51330	REMOVAL OF PRESENT STR.	LSUM		
51335	TEMPORARY BRIDGE AND APPR.	LSUM		
51366	CONCRETE SLOPEWALL 5 INCH	SYS.		
51365	SLOPEWALL	SYS.		
51370	RIPRAP	SYS.		
51375	REVETMENT RIPRAP	TON		55
51371	HANDLAID RIPRAP 1 1/2 INCH	SYS.		
51372	DUMPED RIPRAP	TON		
51374	PLASTIC TIE CLOTH	SYS.		64
51395	STEEL DRAIN PIPE (6 INCH)	LSUM		
51400	STEEL DRAIN PIPE (8 INCH)	LSUM		
51422	STEEL PIPE CONDUIT (2 INCH)	LFT.		
51866	RIVETS REMOVED	EACH		
51864	FIELD DRILLED HOLES	EACH		
51867	STRUCTURAL STEEL CUTTING	SIN		
51863	FIELD DRILLED HOLES IN CONCRETE	EACH		
51842	BRIDGE DECK OVERLAY	SYS.		
51845	BRIDGE DECK SURFACE	SYS.		
51843	BRIDGE DECK PATCHING	SFT.		
51833	CONCRETE SCARPING	SYS.		
51840	ADDITIONAL CONC SCARPINGS	SYS.		
51837	BLASTING AND CLEANING	SYS.		
51838	FINISHING AND CURING	SYS.		

APPROACH PAY ITEMS				
CODE NO.	DESCRIPTION	UNIT	STRUCTURE	TOTAL QUANTITY
02045	EXCAVATION FOR SUBGRADE TREATMENT	CYS.		
02020	UNCLASSIFIED EXCAVATION	CYS.		
52240	COMMON EXCAVATION	CYS.		36
52245	BORROW	CYS.		40
52250	B BORROW	CYS.		
52255	B BORROW FOR STRUCTURE BACKFILL	CYS.		
52303	REMOVAL OF PAVEMENT	SYS.		
02235	BREAKING PAVEMENT	SYS.		
52490	TERMINAL JOINT	LFT.		
52495	CONTRACTION JOINT, TYPE D-1	LFT.		
52280	CONC PAVEMENT REINFORCED (7 INCH)	SYS.		
52285	CONC PAVEMENT REINFORCED (8 INCH)	SYS.		
52290	CONC PAVEMENT REINFORCED (9 INCH)	SYS.		
52300	CONC PAVEMENT REINFORCED (10 INCH)	SYS.		
06070	CONCRETE SIDEWALK	SYS.		
52305	TYPE P COMPACTED AGGREGATE FOR BASE (SIZE NO. 53)	TON		
52605	AGGREGATE FOR SHOULDER DRAINS	TON		
52610	AGGREGATE FOR UNDER DRAINS	CYS.		
52705	TYPE O COMPACTED AGGREGATE FOR BASE (SIZE NO. 53)	TON		
52310	SUBBASE	CYS.		
52315	BITUM. STABILIZED SUBBASE TYPE I, II, OR III	TON		
52320	BITUM. STABILIZED SUBBASE	TON		
52445	BITUMINOUS BASE	TON		
04260	BITUMINOUS BASE (TYPE 5D)	TON		294
52450	BITUMINOUS BINDER	TON		
52455	BITUMINOUS SURFACE	TON		11
52458	BITUMINOUS MATERIAL FOR RACK COAT	SYS.		200
52461	BITUMINOUS MATERIAL FOR PRIME COAT	SYS.		
04351	SEAL COAT TYPE 5	SYS.		
04348	SEAL COAT TYPE 2	SYS.		520
52470	BITUMINOUS MIXTURE FOR APPROACHES	TON		
52475	BITUMINOUS MIXTURE FOR SHOULDER	TON		
52500	GUARD RAIL, TYPE A	LFT.		
52505	GUARD RAIL, TYPE B	LFT.		238
52510	GUARD RAIL, TYPE C	LFT.		
52515	GUARD RAIL, TYPE D	LFT.		104
52520	GUARD RAIL, TYPE E	LFT.		
52525	GUARD RAIL, TYPE F	LFT.		
52530	GUARD RAIL, TYPE G	LFT.		
52531	GUARD RAIL, TYPE H	LFT.		
52532	GUARD RAIL END TREATMENT TYPE 1	EACH		3
06035	RESET GUARD RAIL	LFT.		
52535	REMOVAL OF GUARD RAIL	LFT.		305
52380	SODDING	SYS.		25
52381	SODDING (NURSERY)	SYS.		
52385	MULCHED SEEDING "R"	SYS.		
06560	MULCHED SEEDING "U"	SYS.		
52392	MULCHED SEEDING (LEGUMES)	SYS.		1000
52388	SEED MIXTURE "R"	LBS.		
52389	SEED MIXTURE "U"	LBS.		
52398	SEED MIXTURE (CV)	LBS.		1
52399	SEED MIXTURE (GRASS)	LBS.		
52408	MULCHING MATERIAL	TON		
52401	MULCHING MATERIAL (WOOD CHIPS)	TON		
52405	MULCHING MATERIAL (WOOD CHIPS)	TON		
52406	FERTILIZER	TON		
52410	WATER	M.G.		1
52415	AGRICULTURAL LIMESTONE	TON		

APPROACH PAY ITEMS				
CODE NO.	DESCRIPTION	UNIT	STRUCTURE	TOTAL QUANTITY
07025	PIPE:GR.A(0.064"FBCCS) 12"	LFT.		
07075	PIPE:GR.A(0.064"FBCCS) 15"	LFT.		
07125	PIPE:GR.A(0.064"FBCCS) 18"	LFT.		
07175	PIPE:GR.A(0.064"FBCCS) 24"	LFT.		
07225	PIPE:GR.A(0.064"FBCCS) 30"	LFT.		
07275	PIPE:GR.A(0.064"FBCCS) 36"	LFT.		
07325	PIPE:GR.A(0.064"FBCCS) 42"	LFT.		
10000	PIPE:GR.D(0.064"CS) 12"	LFT.		
10025	PIPE:GR.D(0.064"CS) 15"	LFT.		
10050	PIPE:GR.D(0.064"CS) 18"	LFT.		
10075	PIPE:GR.D(0.064"CS) 24"	LFT.		
10100	PIPE:GR.D(0.064"CS) 30"	LFT.		
10125	PIPE:GR.D(0.064"CS) 36"	LFT.		
10150	PIPE:GR.D(0.064"CS) 42"	LFT.		
34000	PIPE:O.052"REC PERP.CS 6"	LFT.		8
23000	PIPE:O.064"FBCCS 12"	LFT.		
52375	CONC CLASS A IN STRUCTURE	CYS.		21
52376	CONC CLASS C IN STRUCTURE	CYS.		
46000	PIPE END SECTION 12"	EACH		
46005	PIPE END SECTION 15"	EACH		
46010	PIPE END SECTION 18"	EACH		
46015	PIPE END SECTION 24"	EACH		
46020	PIPE END SECTION 30"	EACH		
46025	PIPE END SECTION 36"	EACH		
46030	PIPE END SECTION 42"	EACH		
46035	PIPE END SECTION 36"	EACH		
46040	PIPE END SECTION 36"	EACH		
45000	INLET, TYPE A-1	EACH		
45025	INLET, TYPE D-6	EACH		
45030	INLET, TYPE E-7	EACH		
45070	INLET, TYPE P-12A	EACH		
06335	PAVED SIDE DITCH, TYPE A	LFT.		106
06340	PAVED SIDE DITCH, TYPE B	LFT.		
06345	PAVED SIDE DITCH, TYPE C	LFT.		
06350	PAVED SIDE DITCH, TYPE D	LFT.		
06355	PAVED SIDE DITCH, TYPE E	LFT.		
06360	PAVED SIDE DITCH, TYPE F	LFT.		
06365	PAVED SIDE DITCH, TYPE G	LFT.		
52831	DRILLED HOLES FOR W/D JACKING	EACH		
52830	MATERIAL FOR MUD JACKING	CYS.		
99660	DO NOT SPRAY SIGNS	EACH		4
2'x6	CORRUGATED STEEL STRUCTURAL PLATE PIPE ARCH (GA 0109 TOP & SIDES, 0138 BOT)	LFT.		176
9'x6'x6"		LFT.		

APPROACH PAY ITEMS				
CODE NO.	DESCRIPTION	UNIT	STRUCTURE	TOTAL QUANTITY
06040	47" FENCE, F, FIELD	LFT.		
06045	48" FENCE, CHAIN LINK	LFT.		
52340	CONSTRUCTION SIGNS (TYPE A)	EACH		12
52345	CONSTRUCTION SIGNS (TYPE B)	EACH		4
52350	STD. BARRICADES (TYPE III-A)	EACH		2
52640	MAINTAINING TRAFFIC	LSUM		
06650	STOP SIGN TYPE R-1A	EACH		
06652	DO NOT PASS SIGN, TYPE R-11-A	EACH		
06655	YIELD SIGN, TYPE R-301	EACH		
06657	PADS WITH CARE SIGN, TYPE R-12A	EACH		
06660	CURVE SIGN, TYPE R-2AR	EACH		
06665	CURVE SIGN, TYPE R-2AL	EACH		
06670	REVERSE CURVE SIGN, TYPE R-4AR	EACH		
06675	REVERSE CURVE SIGN, TYPE W-4AL	EACH		
06680	LARGE ARROW SIGN, TYPE W-11A	EACH		
06685	STOP AHEAD SIGN, TYPE W-12A	EACH		
06725	DELINEATOR WITH POST, TYPE D-1, 3 INCH	EACH		
06740	DELINEATOR WITH POST, TYPE D-2, 3 INCH	EACH		
52825	FLEXIBLE DELINEATORS	EACH		
06770	DELINEATOR POST	EACH		
06775	FLEXIBLE DELINEATOR POST	EACH		
52366	TEMPORARY PAVEMENT MARKING TAPE	LFT.		
52367	TEMPORARY PAVEMENT MARKING TAPE	LFT.		
52368	TEMPORARY PAVEMENT MARKING TAPE	LFT.		
52369	TEMPORARY PAVEMENT MARKING TAPE	LFT.		
52370	TEMPORARY PAVEMENT MARKING TAPE	LFT.		
52371	TEMPORARY PAVEMENT MARKING TAPE	LFT.		
52372	TEMPORARY PAVEMENT MARKING TAPE	LFT.		
52373	TEMPORARY PAVEMENT MARKING TAPE	LFT.		
52374	TEMPORARY PAVEMENT MARKING TAPE	LFT.		
52375	TEMPORARY PAVEMENT MARKING TAPE	LFT.		
52376	TEMPORARY PAVEMENT MARKING TAPE	LFT.		
52377	TEMPORARY PAVEMENT MARKING TAPE	LFT.		
52378	TEMPORARY PAVEMENT MARKING TAPE	LFT.		
52379	TEMPORARY PAVEMENT MARKING TAPE	LFT.		
52380	TEMPORARY PAVEMENT MARKING TAPE	LFT.		
52381	TEMPORARY PAVEMENT MARKING TAPE	LFT.		
52382	TEMPORARY PAVEMENT MARKING TAPE	LFT.		
52383	TEMPORARY PAVEMENT MARKING TAPE	LFT.		
52384	TEMPORARY PAVEMENT MARKING TAPE	LFT.		
52385	TEMPORARY PAVEMENT MARKING TAPE	LFT.		
52386	TEMPORARY PAVEMENT MARKING TAPE	LFT.		
52387	TEMPORARY PAVEMENT MARKING TAPE	LFT.		
52388	TEMPORARY PAVEMENT MARKING TAPE	LFT.		
52389	TEMPORARY PAVEMENT MARKING TAPE	LFT.		
52390	TEMPORARY PAVEMENT MARKING TAPE	LFT.		
52391	TEMPORARY PAVEMENT MARKING TAPE	LFT.		
52392	TEMPORARY PAVEMENT MARKING TAPE	LFT.		
52393	TEMPORARY PAVEMENT MARKING TAPE	LFT.		
52394	TEMPORARY PAVEMENT MARKING TAPE	LFT.		
52395	TEMPORARY PAVEMENT MARKING TAPE	LFT.		
52396	TEMPORARY PAVEMENT MARKING TAPE	LFT.		
52397	TEMPORARY PAVEMENT MARKING TAPE	LFT.		
52398	TEMPORARY PAVEMENT MARKING TAPE	LFT.		
52399	TEMPORARY PAVEMENT MARKING TAPE	LFT.		
52400	TEMPORARY PAVEMENT MARKING TAPE	LFT.		
52401	TEMPORARY PAVEMENT MARKING TAPE	LFT.		
52402	TEMPORARY PAVEMENT MARKING TAPE	LFT.		
52403	TEMPORARY PAVEMENT MARKING TAPE	LFT.		
52404	TEMPORARY PAVEMENT MARKING TAPE	LFT.		
52405	TEMPORARY PAVEMENT MARKING TAPE	LFT.		
52406	TEMPORARY PAVEMENT MARKING TAPE	LFT.		
52407	TEMPORARY PAVEMENT MARKING TAPE	LFT.		
52408	TEMPORARY PAVEMENT MARKING TAPE	LFT.		
52409	TEMPORARY PAVEMENT MARKING TAPE	LFT.		
52410	TEMPORARY PAVEMENT MARKING TAPE	LFT.		
52411	TEMPORARY PAVEMENT MARKING TAPE	LFT.		
52412	TEMPORARY PAVEMENT MARKING TAPE	LFT.		
52413	TEMPORARY PAVEMENT MARKING TAPE	LFT.		
52414	TEMPORARY PAVEMENT MARKING TAPE	LFT.		
52415	TEMPORARY PAVEMENT MARKING TAPE	LFT.		
52416	TEMPORARY PAVEMENT MARKING TAPE	LFT.		
52417	TEMPORARY PAVEMENT MARKING TAPE	LFT.		
52418	TEMPORARY PAVEMENT MARKING TAPE	LFT.		
52419	TEMPORARY PAVEMENT MARKING TAPE	LFT.		
52420	TEMPORARY PAVEMENT MARKING TAPE	LFT.		
52421	TEMPORARY PAVEMENT MARKING TAPE	LFT.		
52422	TEMPORARY PAVEMENT MARKING TAPE	LFT.		
52423	TEMPORARY PAVEMENT MARKING TAPE	LFT.		
52424	TEMPORARY PAVEMENT MARKING TAPE	LFT.		
52425	TEMPORARY PAVEMENT MARKING TAPE	LFT.		
52426	TEMPORARY PAVEMENT MARKING TAPE	LFT.		
52427	TEMPORARY PAVEMENT MARKING TAPE	LFT.		
52428	TEMPORARY PAVEMENT MARKING TAPE	LFT.		
52429	TEMPORARY PAVEMENT MARKING TAPE	LFT.		
52430	TEMPORARY PAVEMENT MARKING TAPE	LFT.		
52431	TEMPORARY PAVEMENT MARKING TAPE	LFT.		
52432	TEMPORARY PAVEMENT MARKING TAPE	L		