

Produced by the U.S. Geological Survey  
Revised by the U.S. Forest Service

Areas outside the National Forest System lands may not have been revised.  
Control by USGS, NOS/NOAA, and Indian Flood Control and Water Resources Commission

Topography by photogrammetric methods from aerial photographs taken 1947 and planimeter surveys 1956. Revised from aerial photographs taken 1986. Partial field check by U.S. Forest Service 1993.

North American Datum of 1927 (NAD 27). Projection and 10 000-foot ticks: Indiana coordinate system, west zone (Transverse Mercator). Blue 1000-meter Universal Transverse Mercator ticks, zone 16.

North American Datum of 1983 (NAD 83) is shown by dashed corner ticks. The values of the shift between NAD 27 and NAD 83 for 7.5-minute intersections are obtainable from National Geographic Survey NADCON software.

Non-National Forest System lands within the National Forest System may exist in other National or State reservations.

This map is not a legal land line or ownership document. Public lands are subject to change and leasing, and may have access restrictions; check with local offices. Obtain permission before entering private lands.

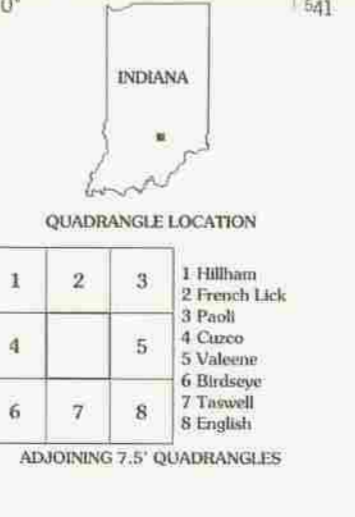
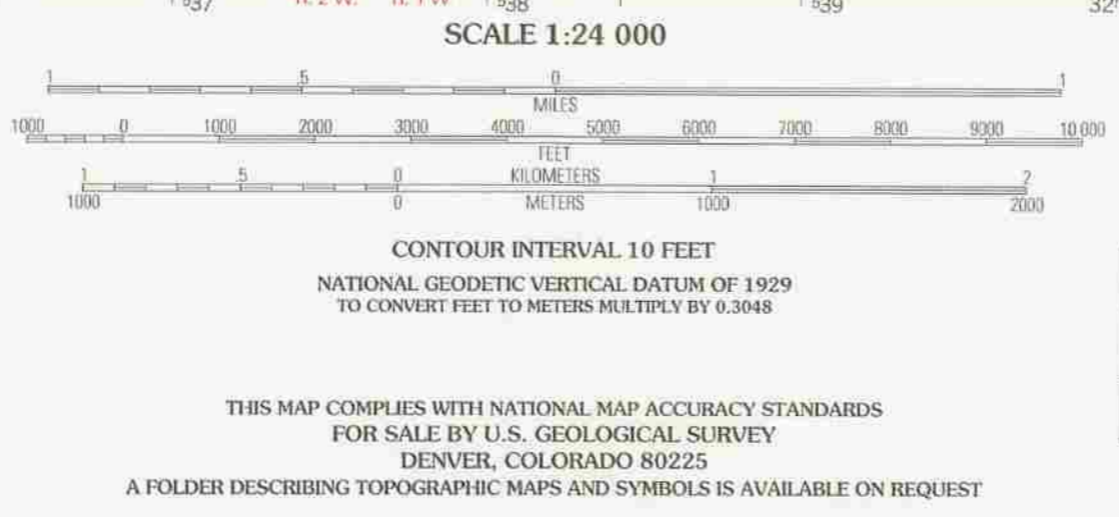
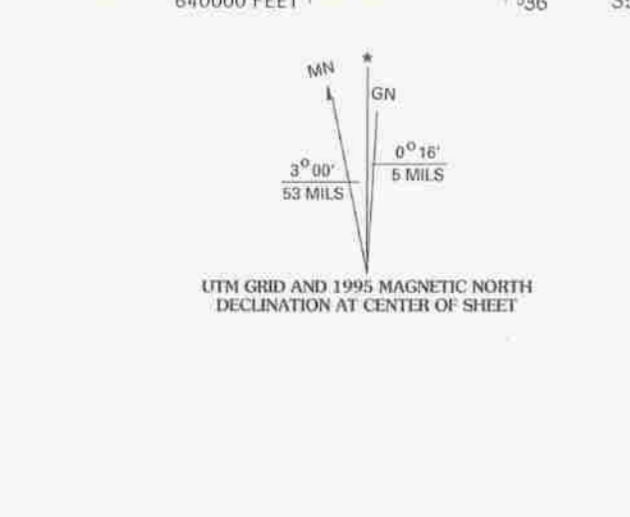

HIGHWAYS AND ROADS

Interstate		Primary highway	
U. S.		Secondary highway	
State		Light-duty road	
County		Paved	
National Forest, suitable for passenger cars		Gravel	
National Forest, suitable for high clearance vehicles		Dirt	
National Forest Trail		Composition unspecified	
		Unimproved; 4 wheel drive	
		Trail	
		Gate	

**GREENBRIER, IND.**  
38086-05-TF-024  
1993  
DMA 3660 1 NE - SERIES V851