

# KANKAKEE FISH & WILDLIFE AREA

- Waterfowl Draws are held at 4:30 AM Daily
- All Persons in a boat must have a life jacket
- Shooting time is ½ hr. before sunrise to Noon local time
- There is a 25 shell limit per hunter
- Hunters must be out of 10 Mile and Corn areas by 2:00 PM

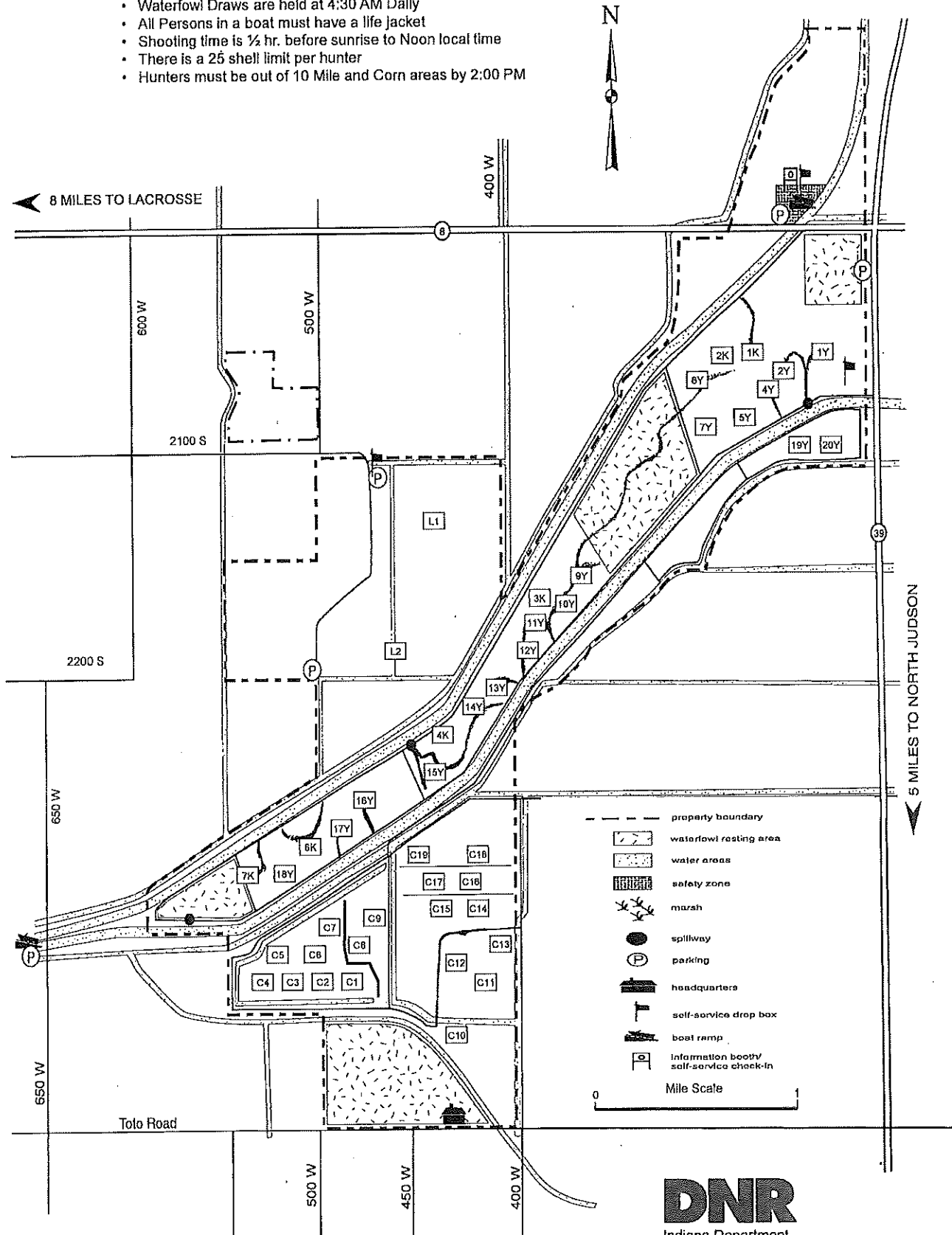

# KANKAKEE FISH & WILDLIFE AREA

## Property Rules

- \*Traps must be checked daily
- \*In managed waterfowl hunting units (Units 2, 3, & 4), traps must be checked after noon local time
- \*Waterfowl Resting Areas can only be accessed after December 8th, unless otherwise noted by manager
- \*Dry land trapping for fox and coyote will be allowed in the resting area in Unit 4
- \*Failure to return assigned key and/or trapping log will result in suspension of trapping privileges the following year
- \*Key must be returned within 30 days at end of trapping period

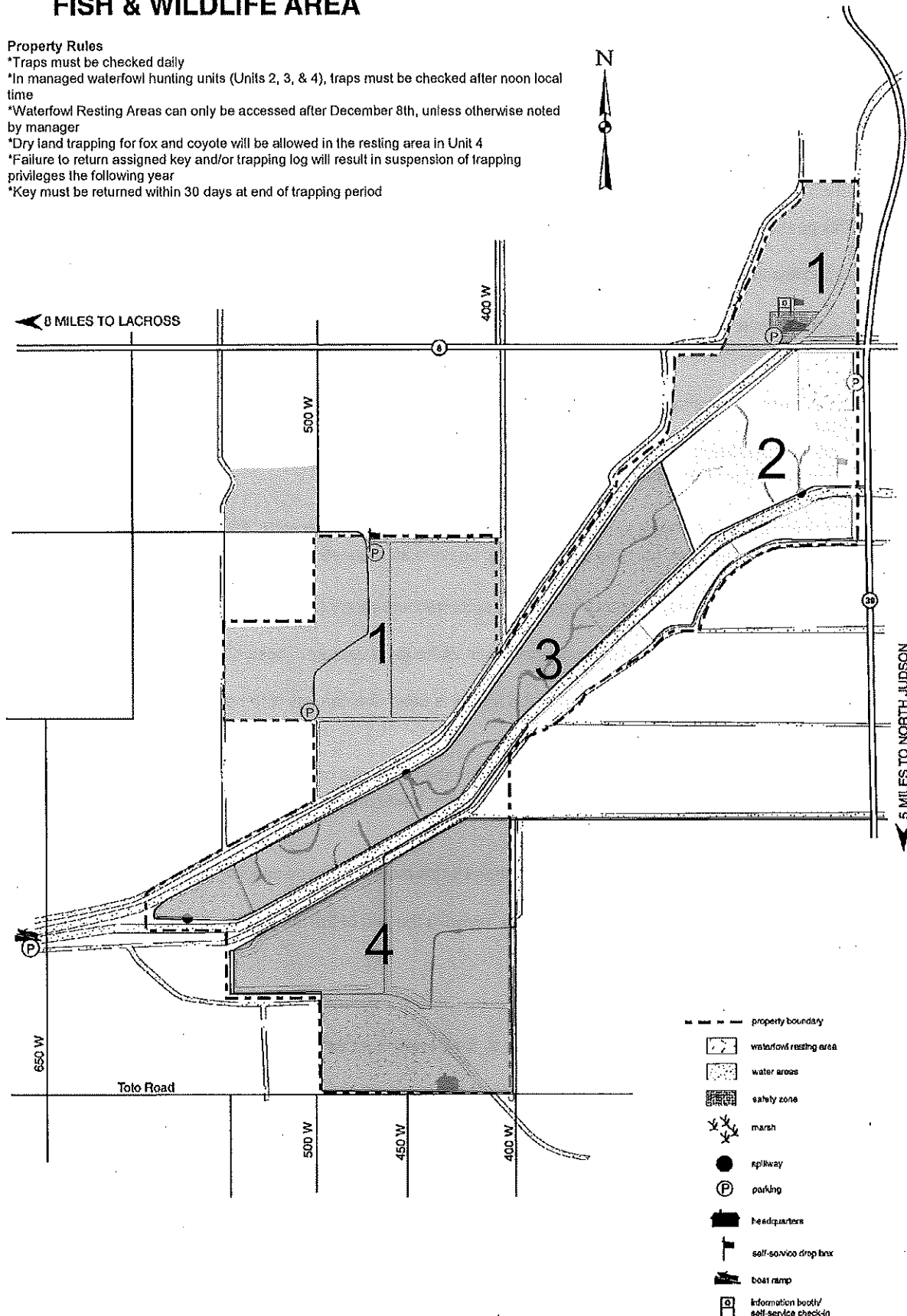

Trapping  
5 – Round Lake

0 1  
Approximate Scale in Miles