

ORDINANCE ESTABLISHING  
COUNTY COMMISSIONER DISTRICTS  
ORDINANCE NO. 2011-85-05

WHEREAS, the Wabash County Commissioners are required to establish County Commissioner Districts in 2011 pursuant to IC 36-2-2-4; and

WHEREAS, the purpose of this ordinance is to establish County Commissioner election districts in Wabash County.

Now therefore be it ORDAINED as follows: Wabash County is divided into three (3) County Commissioner election districts designated numerically as follows:

**District 1**

**This district shall consist of these townships: Chester 1, Chester 2, Chester 3, Chester 4, Chester 5, Chester 6, Pleasant 1, Pleasant 2 and Paw Paw.**

**District 2**

**This district shall consist of these townships: Lagro 1, Lagro 2, Lagro 3, Liberty 1, Liberty 2 and Waltz.**

**District 3**

**This district shall consist of these townships: Noble 1, Noble 2, Noble 3, Noble 4, Noble 5, Noble 6, Noble 7, Noble 8, Noble 9, Noble 10 and Noble 11.**

All ordinances, or parts of ordinances, in conflict with the provisions of this ordinance are hereby repealed.

If any section, provision, or any part of this ordinance is adjudged invalid by a court of competent jurisdiction, such adjudication shall not affect the validity of this ordinance as a whole, or any section, provision, or part thereof not adjudged invalid.

Passed this 3 day of Oct, 2011.

THE BOARD OF COMMISSIONERS OF THE  
COUNTY OF WABASH, INDIANA

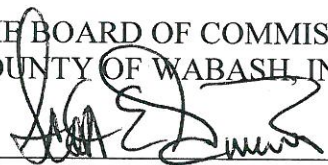
  
\_\_\_\_\_  
Scott E. Givens, Chairman  
Wabash County Commissioner

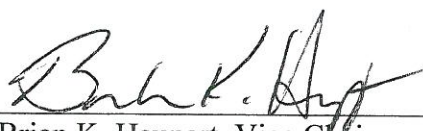
  
\_\_\_\_\_  
Brian K. Haupert, Vice Chairman  
Wabash County Commissioner

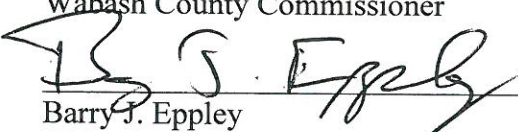
  
\_\_\_\_\_  
Barry J. Eppley  
Wabash County Commissioner

ATTEST:

  
\_\_\_\_\_  
Jane Ridgeway  
Wabash County Auditor



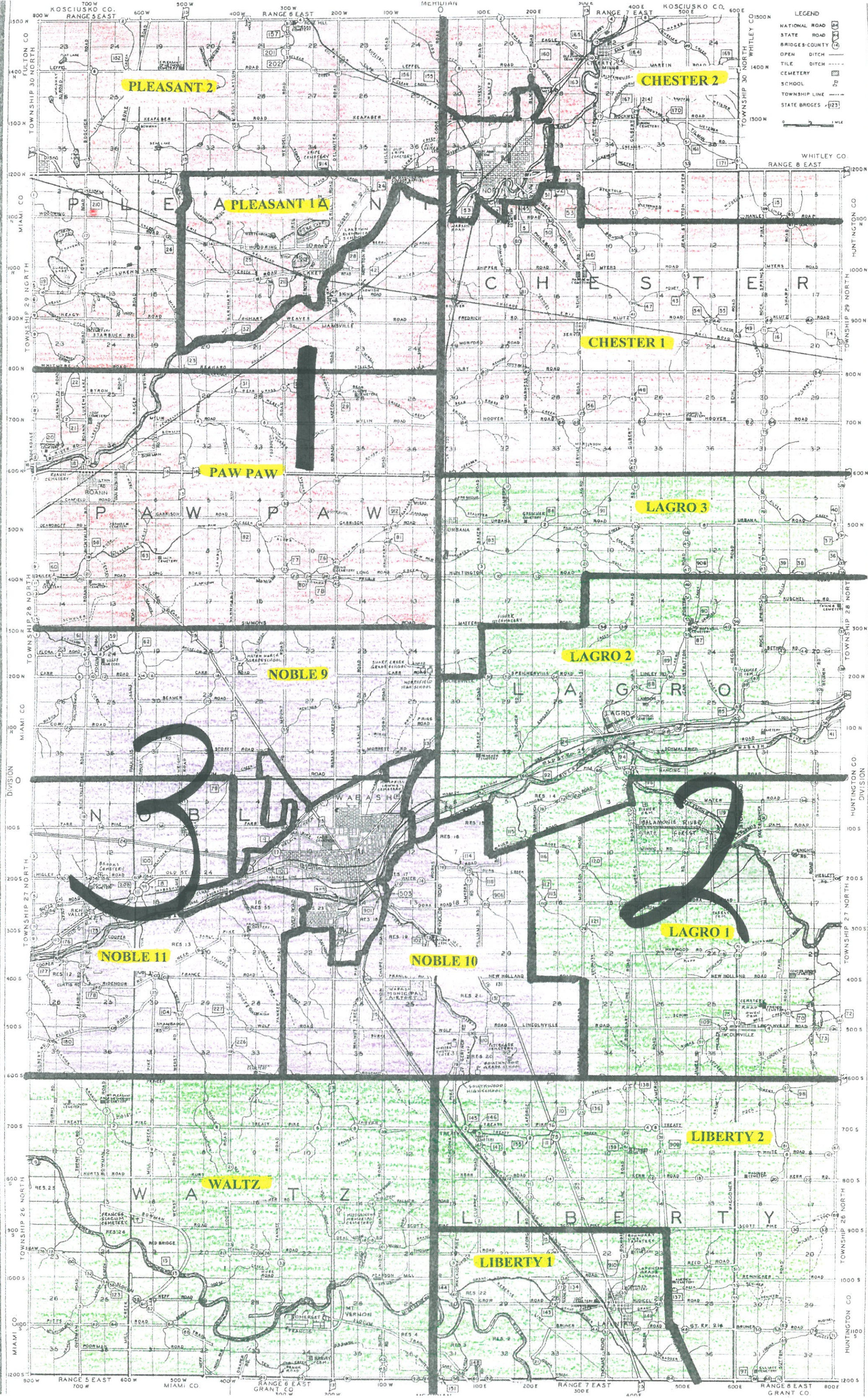

PLEASANT 2

CHESTER 2

PLEASANT 1A

CHESTER 1

PAW PAW

LAGRO 3

NOBLE 9

LAGRO 2

NOBLE 11

NOBLE 10

LAGRO 1

WALTZ

LIBERTY 2

LIBERTY 1

- LEGEND
- NATIONAL ROAD
  - STATE ROAD
  - BRIDGES-COUNTY
  - OPEN DITCH
  - TILE DITCH
  - CEMETERY
  - SCHOOL
  - TOWNSHIP LINE
  - STATE BRIDGES

0 1 MILE

Map grid coordinates: TOWNSHIP 30 NORTH, 29 NORTH, 28 NORTH, 27 NORTH, 26 NORTH; RANGE 5 EAST, 6 EAST, 7 EAST, 8 EAST.

County names: KOSCIUSKO CO., MIAMI CO., HUNTINGTON CO., GRANT CO., WHITLEY CO.

Section numbers: 1-36, 37-72, 73-108, 109-144, 145-180, 181-216, 217-252, 253-288, 289-324, 325-360.