

FIELD NOTES---EXPLANATION OF.

A	a	B	b	C	c	D	d	E	e	F	f	G	g
Y	6	6	5	6	4	6	3	6	2	6	1	5	4
Y	6		5		4		3		2		1	H	3.50
X	7	5	8	5	9	5	10	5	11	5	12	h	
X	6		5		4		3		2		1	I	3.24
W	18	4	17	4	16	4	15	4	14	4	13	i	
W	6		5		4		3		2		1	K	2.00
v	19	3	20	3	21	3	22	3	23	3	24	k	
V	6		5		4		3		2		1	L	1.19
u	30	2	29	2	28	2	27	2	26	2	25	l	
U	6		5		4		3		2		1	M	
t	31	1	32	1	33	1	34	1	35	1	36	m	
T	s	S	r	R	q	Q	p	P	o	O	n	N	

Township 14 North, Range 3rd East. of Lud. Prichard.

58 Links
175
76.39
57.75

57.80
157.30
162.42
172.42
179.55
167.59
145.00

77 70 82 29 3.50

78 80 81.50 3.24

79 20 80.60 2.00

80 00 80.50/50 1.19

80 07 81.00 1.86

var 52 55 6

Sugar Creek

Field Notes of Shelby County, Indiana.

Township 14 North, Range 3 East.

Corners.	Bearing Trees.	Diam.	Courses.	Dist.		Corners.	Bearing Trees.	Diam.	Courses.	Dist.
E	Beech	20	S 18 E	10		K'	Beech	15	S 33 E	31
	So	8	N 83 W	24			So	8	N 28 W	20
E'						L	So	14	N 62 W	19
F	Beech	12	N 72 E	19		L'	Sugar	6	S 22 E	25
	So	15	S 36 W	31			Beech	10	S 19 E	14
F'							So	14	N 38 E	21
G	Beech	12	N 11 E	12		M	So	14	S 44 E	13
	So	20	S 35 W	22			So	13	N 43 W	29
G'	Sugar	12	S 17 W	12		M'	So	14	N 25 W	38
	Beech	12	N 29 W	6			So	18	S 12 E	18
H	So	9	S 20 W	20		N	So	9	S 6 1/2 W	30
	So	15	N 70 E	9			Elm	6	N 36 E	17
H'	—	18	N	14		N'	Beech	15	N 45 E	15
I	Beech	10	S 76 W	64			So	6	S 41 W	25
	Sugar	15	S 7 1/2 E	10		O	Sycamore	20	S 71 E	15
	Beech	20	S 73 W	29			So	21	N 9 E	18
I	So	13	S W	12		O'	Beech	10	S 10 E	25
	Elm	36	S 63 E	14			So	6	N 11 W	22
K	Beech	16	S 25 W	21		P	So	10	S 17 W	21
	So	—	N 37 E	20			So	15	N 60 E	37
						P'				

Field Notes of Shelby County, Indiana.

Township 14 North, Range 3 East.

Corners.	Bearing Trees.	Diam.	Courses.	Dist.	Corners.	Bearing Trees.	Diam.	Courses.	Dist.
25, 26, 35, 36,	Beech	8	N 68 W	19	M to U				
	so	3	S 12 E	16	1	Beech	5	S 2 N	16
23, 24, 25, 26	Ash	36	N 35 W	9	"	so	4	N 31 E	12
	Beech	14	S 30 W	11	2	so	15	S 67 W	21
13, 14, 23, 24	so	12	N 9 E	14	"	so	10	S 15 E	18
	so	24	S 31 E	18	L to V				
1, 2, 11, 12,	Ash	30	S 10 W	20	1	Beech	12	S 33 W	—
	so	6	S 66 E	27	"	Sugar	4	N 14 W	4
26, 27, 34, 35	Sugar	6	S 3 E	21	2	Beech	15	S 46 E	28
	Hornwood	4	S 2 E	21	"	so	18	N 49 W	28
22, 23, 24, 27	Ash	6	S 78 W	6	K to W				
	so	4	N 11 E	32	1	Hickory	8	S 69 W	15
14, 16, 22, 23,	Beech	12	S 67 W	21	"	Beech	7	N 33 E	8
	so	10	N 60 E	34	2	so	20	N 83 W	23
2, 3, 10, 11,	so	20	S 56 E	10	"	so	6	N 30 E	4
	so	12	N 3 E	18	I to X				
					1	Sycamore	30	S 44 W	48
					"	N Beech	8	N 20 W	38
					2	Beech	20	N 39 W	11
					"	so	16	N 61 E	25

Field Notes of Shelby County, Indiana.

Township *14* North, Range *5* East.

Corners.	Bearing Trees.	Diam.	Courses.	Dist.		Corners.	Bearing Trees.	Diam.	Courses.	Dist.
H to Y						P to E				
1	Beech	15	N 6 E	12		1	Beech	15	S 27 E	26
"	Ash	6	S 38 N	14		"	So	24	S 45 N	12
2	Beech	12	N 18 N	21		2	Buckeye	12	S 78 N	15
	So	15	S 49 N	45		"	Beech	14	N 6 E	30
O to F						3	N-Oak	7	N 43 E	12
1	N Beech	6	N 83 N	82		"	Ash	20	S 14 N	17
"	Hackberry	24	S 64 E	4		4	Beech	30	S 58 E	17
2	Beech	14	N 25 E	32		"	So	6	S 2 E	29
"	Ash	18	S 66 N	14		5	So	12	N 1 N	22
3	Beech	12	S 7 E	44		"	So	6	S 70 E	19
"	So	18	N 4 N	39		6	So	8	S 61 E	13
4	So	6	S 89 N	20		"	Hickory	10	N	14
"	Walnut	6	S 22 E	21						
5	Beech	12	S 23 N	12						
"	So	15	N 12 E	27						
6	So	18	N 69 E	7						
"	So	16	S 39 N	11						

Record of Surveys in Shelby County, Indiana.

9

Section 1 Township 14 North, Range 3 East.

Date, Intermediate Corners, &c., &c.	Corners.	Stone, Mark, &c.	Acres.	Hund.	Bearings, Trees, &c.	Diam.	Courses.	Dist.
<p><i>Apr 2nd 1856</i></p>	Y	Stone			ash	24	S 4 E	23
					do	20	S 6 W	32
	R	"			ash	6	N 65 W	11
					do	12	N 82 E	17
	Q	"			elm	10	N 40 W	14
<p><i>Jargin - Surveyor</i></p> <p><i>16 Links E of</i></p> <p><i>68 " N. of</i></p> <p><i>24 links E + 31 north</i></p> <p><i>2075 Links East of same</i></p> <p><i>Nov 6/71 J Dugan Surveyor</i></p>	X, C	" <i>f</i>			No Nit			
	A	"			"			
	C	"	<i>marked 65</i>		Stone		S	34
	D	"	<i>marked 55</i>		"		"	35
	F	"	<i>marked 68</i>		"		E	28
	G	"	<i>marked 68</i>		Boulders		W	13
	F	"	Stone marked	F	Stone		E	26 1/2
	G	"	"	G	"		E	24
	H	"	"	H	"		W	40
	O	"	"	O	"		E	26
<p><i>J Dugan Surveyor Oct 29th 1878</i></p> <p><i>Sep 22nd + 23rd 1884</i></p> <p><i>Tested & found right & set Nit to</i></p> <p><i>Coyner S.H.C. & Murphy S.C.</i></p> <p><i>John W. Whitlock May 5th 1976</i></p>	A	"			"		N 23 3/4 E 72 1/2	
	C	"			"		S 49 W 40	
	E	"	P.K. Nail Found		"	See Tie File	"	* for explanation, see page 114

Record of Surveys in Shelby County, Indiana.

Section

Township

North, Range

East.

Date, Intermediate Corners, &c., &c.	Corners.	Stone, Mark, &c.	Acres.	Hund.	Bearings, Trees, &c.	Diam.	Courses.	Dist.
John W. Whitlock May 5, 1976	P	Stone			See Tie File		for explanation, see P. 114	
" Aug. 27, 1974	Z	Iron Pipe End.			"			
" May 5, 1976	L	Iron Pin (Set)			"			
" 8/7/78	A	P.R. Spike (Found)			"			

Record of Surveys in Shelby County, Indiana.

17

Section **2** Township **14** North, Range **5** East.

Date, Intermediate Corners, &c., &c.	Corners.	Stone, Mark, &c.	Acres.	Hund.	Bearings, Trees, &c.	Diam.	Courses.	Dist.
Sept 24 th 1850	A	Stone			Ash	20	N	17
					do	22	N E	57
	B				Sycamore	9	S 30 E	53
	C				Ash	17	S 40 N	45
	D				Oak	30	S 81 E	39
	E				Ash	18	S 67 1/2 E	11
	F				Beech	20	S 81 N	14
	G				do	16	N 88 E	39
	H				Cedar	4	S 55 E	45
	I				Beech	24	N 8 E	21
	J				do	16	N 87 1/2 E	20
	K				Beech	28	S 28 E	25
	L				do	17	N 68 E	42
	M				do	24	N 26 N	9 1/2
	N				do	8	N 35 E	14
	O				Oak	16	N 69 N	30
	P				Beech	20	S 49 N	55
	Q				do	30	N 30 N	22
	R				do	7	S	7
	S				do	10	N 30 E	26
	T				do	18	N 30 E	2
	U				Hickory	24	S 37 E	23
	V				do	30	S 62 E	7
	W				Oak	24	S 44 N	13

J. M. Calliott, Surveyor

Section *2* Township *14* North, Range *5* East.

Date, Intermediate Corners, &c., &c.	Corners.	Stone, Mark, &c.	Acres.	Hund.	Bearings, Trees, &c.	Diam.	Courses.	Dist.
<i>Sept - 5th 1867</i> <i>Miller - Surveyor</i> John W. Whitlock May 5, 1970 " "	W U A L	Stone " P.K. Nail End. Stone			Ch Nit B-Oak See Tie File "	36	N 33° E 40	
" Aug. 27, 1974 Kenneth L. Bowman ———	V Q	Iron Pipe End. Stone			" "		for explanation, see p. 114	
" ——— John W. Whitlock 4/24/80	Z E X	R.R. Spike — Iron Pipe (Found)			" "			

Record of Surveys in Shelby County, Indiana.

25

Section **11** Township **14** North, Range **3** East.

Date, Intermediate Corners, &c., &c.	Corners.	Stone, Mark, &c.	Acres.	Hund.	Bearings, Trees, &c.	Diam.	Courses.	Dist.
Nov - 1853	N	Stone			Bugart	10	N 40 W	13
					Beech	10	S 15 E	23
					Ch Nit			
Darwin Sumner 1/2 of Sept 4 th 1867	H M I L-K	" "			" "			
	A	Boulder			B-Oak	11	N 47 E	32
	L	Stone			Beech	13	S 72 W	38
	C	Boulder			Ch Nit			
	A	Stone			"			
3/2 R. S. of above cor 80 R. S		No Boulder			"			
	Same	"			"			
					Mr. H. Miller Sumner			
John W. Whitlock Aug 27, 1974	A	Iron Pipe End.			See Tie File			for explanation
" "	L	Iron Pipe End <small>acc. to Bowman</small> over Stone			"			see P. 114
" Nov. 8, 1976	V	1/2" I. Pipe End.			"			"
Kenneth L. Bowman	E	F.R. Spike			"			"
John W. Whitlock 4/24/80	C	Iron Pipe (Found)			"			"
" 4/24/80	N	Stone (Found)			"			"

Record of Surveys in Shelby County, Indiana.

Section 12 Township 14 North, Range 5 East.

Date, Intermediate Corners, &c., &c.	Corners.	Stone, Mark, &c.	Acres.	Hund.	Bearings, Trees, &c.	Diam.	Courses.	Dist.
March 1880,	M	Slata			Beech	18	S 43 1/2 N	37
					do	18	S 87 N	51
	N	Stone			R-Oak	18	S 2 N	47 1/2
					W Oak	24	N 84 E	40
					Spig Key	N 1/2 N		56
25 Chus East of 10 20 Chus S and 8 Chus E of 33 Chus East of	P	Boulder			No mark taken			
					Corner, Stone.		Buckey 12 E 7.	
	Q	Stone			Elm	15	S 37 1/2 E	17
					W Oak	36	N 2 1/2 N	48 1/2
to Charles W. Heister S.S.								
Aug 25th 1882	X	Iron Pipe in edge of creek						
April, 14, 1914	S	Stone			Wit. Stone		West	24 1/2
John W. Whitlock Aug. 27, 1974	E	Iron Pipe Found			See Tie File		for explanation,	
" "	P	Iron Pipe Over Stone			"		see P. 114	
" Nov. 8, 1976	Z	1/2" Iron Pipe Found			"			
" May 1, 1979	N	Iron Pin Set @ Cor. Post						

Geo. E. Oltman, Co. Surveyor S. S.

Record of Surveys in Shelby County, Indiana.

41

Section *13* Township *14* North, Range *5* East.

Date, Intermediate Corners, &c., &c.	Corners.	Stone, Mark, &c.	Acres.	Hnd.	Bearings, Trees, &c.	Diam.	Courses.	Dist.	
<p><i>No date, I cannot say who was the author of this piece of Record,</i></p>	M	Stone			Beech	20	E	19	
	N	"			Hard	2	N	12	
	D	"			Beech	20	N 55 W	19	
	I	"			So	14	N	29	
	H	"			H Oak	30	N 20 W	8	
	L	"			Hickory	27	N 10 W	62	
	U	"			Sugar	20	N 30 W	32	
	T	"			Beech	20	N 5 W	39	
	W	"			So	14	N 10 E	27	
	O	"			Ash	3	N	15	
<p><i>Chickals, Rock, Kaendricks, Elliott, Sargis, Summeyors, July 26th 1857 - Sargis - Summeyor - June 18th 1870 - G. F. Webster - Summeyor Survey made March 26th 27. and April 1. 1890. written notices served on all parties interested, by E. B. Stanley, John Carroll, flagman. George Summings and John L. means, claimant</i></p>	L	"			Beech	20	N 88 W	9	
	U	"			No Nit				
	T	"			Apple	16	N 70 W	2	
	W	"			Stone		N 25 W	30	
	O	"			Sugar	16	N 60 E	17	
	M	"			Beech	2	N 30 W	18	
	N	"	Boulder			Boulder		South.	9
	O	"	found right.					South.	
	H	"	long boulder with limestone at side.					Boulder	25
	P	"	Boulder			Boulder		North	12
P	"	Boulder			Boulder		North	25	

Thomas Finley. Survey of Shelby County

Record of Surveys in Shelby County, Indiana.

Section

13

Township

14

North, Range

5

East. 2nd P.M.

Date, Intermediate Corners, &c., &c.	Corners.	Stone, Mark, &c.	Acres.	Hund.	Bearings, Trees, &c.	Diam.	Courses.	Dist.
August 23, '06 set	C	Stone			Stone		West	30
and	N	Post in Road			Boulder	Large	N. 45° 10' E	34
W. H. Isley, Dep. S. S. Co.					Stake		North	18 1/2
John W. Whitlock Nov. 8, 1970	E	1/2" Iron Pipe Found			See Tie File		See Remarks	
"	X	Iron Pin Set					R. 114	
Kenneth L. Bowman	P	Iron Pipe over Stone			See Tie File			
"	O	Stone			See Tie File			
"	M	Stone			Wit. Stone		S. 15° E.	5.9 ft
"					Wit. Stone		S. 45° W.	14.5 ft

Record of Surveys in Shelby County, Indiana.

49

Section *14* Township *14* North, Range *3* East.

Date, Intermediate Corners, &c., &c.	Corners.	Stone, Mark, &c.	Acres.	Hurd.	Bearings, Trees, &c.	Diam.	Courses.	Dist.
<i>Mar 7th 1860</i>	<i>Z, O</i>	<i>Stones</i>			<i>No Nit</i>			
	<i>X, V</i>	<i>"</i>			<i>"</i>			
	<i>L, P</i>	<i>"</i>			<i>"</i>			
	<i>R, Q</i>	<i>"</i>			<i>"</i>			
<i>1/2 of</i>	<i>R-O</i>	<i>"</i>			<i>"</i>			
<i>1/2 of</i>	<i>Q-P</i>	<i>"</i>			<i>"</i>			
<i>Minchey Surveyor,</i>	<i>A</i>	<i>"</i>			<i>"</i>			
<i>Oct 22nd 1862</i>	<i>N</i>	<i>"</i>			<i>"</i>			
<i>Storiss Surveyor</i>								
<i>See Remarks Page 116</i>								
<i>Survey made March 26</i>	<i>M</i>	<i>large boulder</i>			<i>boulder,</i>		<i>North</i>	<i>17.</i>
<i>and 27, also April 1, 1890.</i>	<i>N</i>	<i>" boulder</i>			<i>boul der</i>		<i>S 10 W.</i>	<i>26.</i>
<i>All parties interested</i>								
<i>notified by writing</i>								
<i>John Curroll, George</i>								
<i>Armstrong, and John L.</i>								
<i>Meems, chairman.</i>								
<i>Thomas Finley</i>								
		<i>Co. Surveyor.</i>						
<i>John W. Whitlock April 11, 1877</i>	<i>Z</i>	<i>Stone</i>			<i>See Tie File</i>		<i>See Remarks</i>	
<i>"</i>	<i>X</i>	<i>P. K. Nail Set</i>			<i>See Tie File</i>		<i>P. 114</i>	
<i>Kenneth L. Bowman 7-10-65</i>	<i>I</i>	<i>Stone Found</i>			<i>"</i>			
<i>"</i>	<i>M</i>	<i>Stone Found</i>			<i>"</i>			
<i>"</i>	<i>L</i>	<i>Iron pipe over stone</i>			<i>"</i>			

Record of Surveys in Shelby County, Indiana.

Section

Township

North, Range

East.

Date, Intermediate Corners, &c., &c.	Corners.	Stone, Mark, &c.	Acres.	Hnd.	Bearings, Trees, &c.	Diam.	Courses.	Dist.
By KENNETH BOWMAN APR. 20 1961	" N "	R.R. SPIKE			NAIL IN TEL POLE NAIL IN POWER POLE		N W N E	
John W. Whitlock April 11, 1977	C	P.K. Nail Set			See Tie File			
" " "	E	Stone			"			
"	L	Iron Pin Found						
	N	Iron Pin ^{Set to} Found Replace R.R. Spike Found						
	P	Stone						
Oct 1978	Q	Road Nail Found						
	R	Stone Marked "R" with "+" on top found						
	S	P.K. Nail Found						
	Z	P.K. Nail Set						
* Search for stone was made at all corners, and either: (for corners by J.W. Whitlock)					1) Mon. fnd. before digging was reset 2) Mon. set from best evidence 3) Stone found			
John W. Whitlock 3/20/79	Q	R.R. Spike (Set)			See Tie File			

Record of Surveys in Shelby County, Indiana.

Section **24** Township **14** North, Range **3** East.

Date, Intermediate Corners, &c., &c.	Corners.	Stone, Mark, &c.	Acres.	Hud.	Bearings, Trees, &c.	Diam.	Courses.	Dist.
<p>Chickasaw Surveyor Apr 24th 1837c</p> <p>Cullitt Surveyor July 26th 1837c</p> <p>Sept 16th 1837c</p> <p>Sargin Surveyor Dec 5th 1892.</p> <p>26 16 1/2 feet North of In the Michigan Road.</p> <p>Set Bedford lime stone 947 1/2' S + 803 1/2' E of C. 24-14-5 this stone is 4' NW. of a tract of 2A Aug 15 1949 Geo. E. Oltman Reg. 673</p>	D	Stone			Beech	12	S 35 N	19
	O	"			do	12	N 23 E	7
	S	"			do	12	N 6 E	34
	W	"			Sugar	16	S 30 E	23
	B	"			do	18	N 46 E	49
	C	"			Beech	14	N 40 E	49
	V	"			do	6	N 8 N	10
	N	"	S		Buckeye	3	S 25 N	11
	P	"			Hackony	3	S 22 N	4
	R	"			Ash	9	N 79 N	13
Q	"			No Nit				
V	"			Beech	20	N 85 E	30	
S.E. of C,	"			No Nit				
C,	"			Stone		S 13 E	19	
C,	"			Beech	16	S 11 N	9	
	V	Large Boulder		Boulder		S 50 3/4 E	29 1/2 ft.	
				D. S. Finley, S.S. Co. By G. F. Webster Deputy.				

Record of Surveys in Shelby County, Indiana.

Section 24

Township

14

North, Range

5

East. 2nd P.M.

Date, Intermediate Corners, &c., &c.	Corners.	Stone, Mark, &c.	Acres.	Hund.	Bearings, Trees, &c.	Diam.	Courses.	Dist.
John W. Whitlock May 6, 1974	C	Iron Pin Set					See Remarks	
" May 6, 1974	N	R.R. Spike Set			See Tie File		Page 114	
" "	P	Iron Pin Found						
" May 6, 1974	X	Iron Pin Set			See Tie File			
" 9/3/80	L	Iron Pin (Set)			"			

Record of Surveys in Shelby County, Indiana.

73

Section *23* Township *14* North, Range *5* East.

Date, Intermediate Corners, &c., &c.	Corners.	Stone, Mark, &c.	Acres.	Hnd.	Bearings, Trees, &c.	Diam.	Courses.	Dist.
<i>Apr 24th 1851</i> <i>Calliote Sumner</i> <i>Sept 9th 1857</i> <i>See Remarks Page 118</i>	T	Stone			H- Wood	3	N 75° E	6
	U	"			Beech	11	N 8° N	19
	W	"			So	10	S 61° N	24
	L	"			So	12	N 13° E	20
	X	"			Oak	4	N 17° N	37
	N	"			H- Beech	3	N 41 1/2° E	13
	O	"			No Nit			
	D	"			Beech	8	31° E	9
	M	"			Stone		N	10
	B	"			Ash	4	N 17° E	6
<i>Apr. Sargin - Sumner</i>	O	"			Sugar	24	S 47° E	30
	O	"			H Walnut	10	N 62° E	16
	O	"			So	4	S 86° E	12
	O	"			Stone		S 70° N	27
					So		N 33° N	34

Record of Surveys in Shelby County, Indiana.

Section 25

Township 13 14

North, Range 6

East.

Date, Intermediate Corners, &c., &c.	Corners.	Stone, Mark, &c.	Acres.	Hund.	Bearings, Trees, &c.	Diam.	Courses.	Dist.
16 rods N. of 16 " N. " March 20 th (1900)	W " ✓	Stone Stone Stone			No. Wit. " " " "			
John W. Whitlock May 6, 1974 " July 18, 1974 " " # 7/18/74	C L V	Iron Pin Set Iron Pin Found Iron Pipe Found			See Tie File " "		See Remarks Page 114	

Millard F Crawford
Surveyor, of Shelby, Co.

Record of Surveys in Shelby County, Indiana.

75

Section

Township

North, Range

East.

Corner C, 25-14-5

PK Nail in
Pwp



20.40

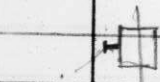

17.75

spike in Pwp



15.5

corner Post

86.82

Iron pin

Corner House

31' R/W

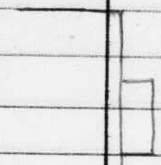

Mark, &c.

Acres.

Hand.

Bearings, Trees, &c.

Diam.

Courses.

Dist.

Record of Surveys in Shelby County, Indiana.

Section *33* Township *14* North, Range *3* East.

Date, Intermediate Corners, &c., &c.	Corners.	Stone, Mark, &c.	Acres.	Hund.	Bearings, Trees, &c.	Diam.	Courses.	Dist.
<p><i>Sept 25th 1887</i></p> <p><i>Mrs. Sargis, Surveyor</i> <i>See Plat & Remarks 118.</i> <i>Oct. 7th 1886</i> <i>Remains of Hoop's Witness, see Sec. 1 T13 R 5, corner E</i> <i>Mr R. Norris, Deputy C. S.</i></p>	<i>N</i>	<i>Stone</i>			<i>Stone</i>		<i>S 21 N</i>	<i>14</i>
	<i>M</i>	<i>"</i>			<i>do</i>		<i>E</i>	<i>10</i>
	<i>V</i>	<i>" N. 30.</i>	<i>See this</i>		<i>No Nit</i>		<i>N</i>	<i>30</i>
	<i>W.</i>	<i>"</i>			<i>Stone</i>		<i>ch</i>	<i>10</i>
	<i>R</i>	<i>"</i>			<i>do</i>		<i>ch</i>	<i>10</i>
	<i>I O</i>	<i>" S</i>			<i>No Nit</i>			
	<i>Q Y</i>	<i>" S</i>			<i>"</i>			
	<i>X</i>	<i>"</i>			<i>"</i>			
	<i>V</i>	<i>Boulder</i>			<i>Sycamore</i>	<i>36</i>	<i>N 22 1/2 E</i>	<i>94 1/2</i>
					<i>Ash Stump</i>	<i>16</i>	<i>N 36 E</i>	<i>162</i>
				<i>Honey Locust</i>	<i>12</i>	<i>S 80 1/2 W</i>	<i>18</i>	

Record of Surveys in Shelby County, Indiana.

Section *B 6* Township *14* North, Range *3* East.

Date, Intermediate Corners, &c., &c.	Corners.	Stone, Mark, &c.	Acres.	Hund.	Bearings, Trees, &c.	Diam.	Courses.	Dist.	
<i>Oct 18th 1849</i> <i>Elliott & Sumner</i> <i>Apr 19th 1866</i>	N	Stone			Beech	36	S 17 E	7	
	A	"			do	12	N 34 E	8	
		"	Stump			do	13	N 43 W	29
		"	"			do	14	S 44 E	13
<i>Geo. Keays Surveyor</i> <i>Aug 7th 1867</i> <i>Wm. Miller Surveyor</i> <i>Sept 1882</i> <i>Corrected by Agreement of</i> <i>the parties,</i> <i>Geo. Webster Surveyor</i>	B	"			No Nit				
	L	"			Beech	14	N 25 W	38	
	M	"			do	18	S 12 E	18	
		"	"			Callcotts	24	N 32 E	7
D	"	"			Beech	15	S 15 W	30	
	"	"			Sycamore	24	N 69 W	23	
	"	"			Locust	12	N 83 E	143	
<i>Aug 20th 1884</i> <i>3. 31 Chs South of</i> <i>12. 22 " " "</i> <i>Murphy Surveyor</i>	I	Stew			Old Corner		Stone East	25	
	M	"			no witness				
	W	"			no witness				
	M	"			R. Oak	16	N 21 3/4 W	87	
		"			" "	18	S 4 1/4 E	124	
		"			Elm	8	N 30 1/2 W	32	
		"			Beech	16	S 59 W	55	

REMARKS.

Corners by John W. Whitlock - Search for Stone was made at all corners

If stone wasn't found - either - Monument found before digging & was reset

or - Monument was set from best evidence

REMARKS.

(See 12) I have omitted a part of the Record made in this See by Mr Rock & Elliott, as useless, but it is required at any time it may be found in my complete Record, in the Records Office, G. B. Webster -

(See 14) Oct 22nd 1862 - Morris. Tested Fargius Corner A, and finds it right and Nicholls Cor A. to be wrong, and Nicholls Cor N, found right and Fargius Cor N, wrong -

Corners in London REMARKS. Dec 25. - 14 - 5.

On the South side of the Town of London, is a Lime Stone Planted, on the South side of the E & W. R.R. and 50 ft South of the middle line of said Road. Said Stone is marked 50, and is near the Corner of Gut - ch. now belonging to Marcus lease. - Apr 21st 1862 - Corviss - Surveyor

At the East End of the 30 ft Road in London, running parallel with the E & W. R.R. and lying between cut Guts or 2 & 3, is a Lime Stone Corner Established and marked 5.99 R.R. Said Stone is 5.99 chains North of the middle line of said Rail Road. - Also, 9.32 chains West of said Corner last mentioned a Bluish Boulder, marked 5.99 R.R. May 7th 1862 - Corviss - Surveyor

Also - 46 R 11 Links North of the middle line of the E & W. R.R. running through London, and on the West side of the street marked as - Street on the Town Plot, a Lime Stone Corner Established, marked 46. $\frac{11}{25}$ on the top - Feb'y 23th, 1863 - Corviss - Surveyor