

FIELD NOTES---EXPLANATION OF.

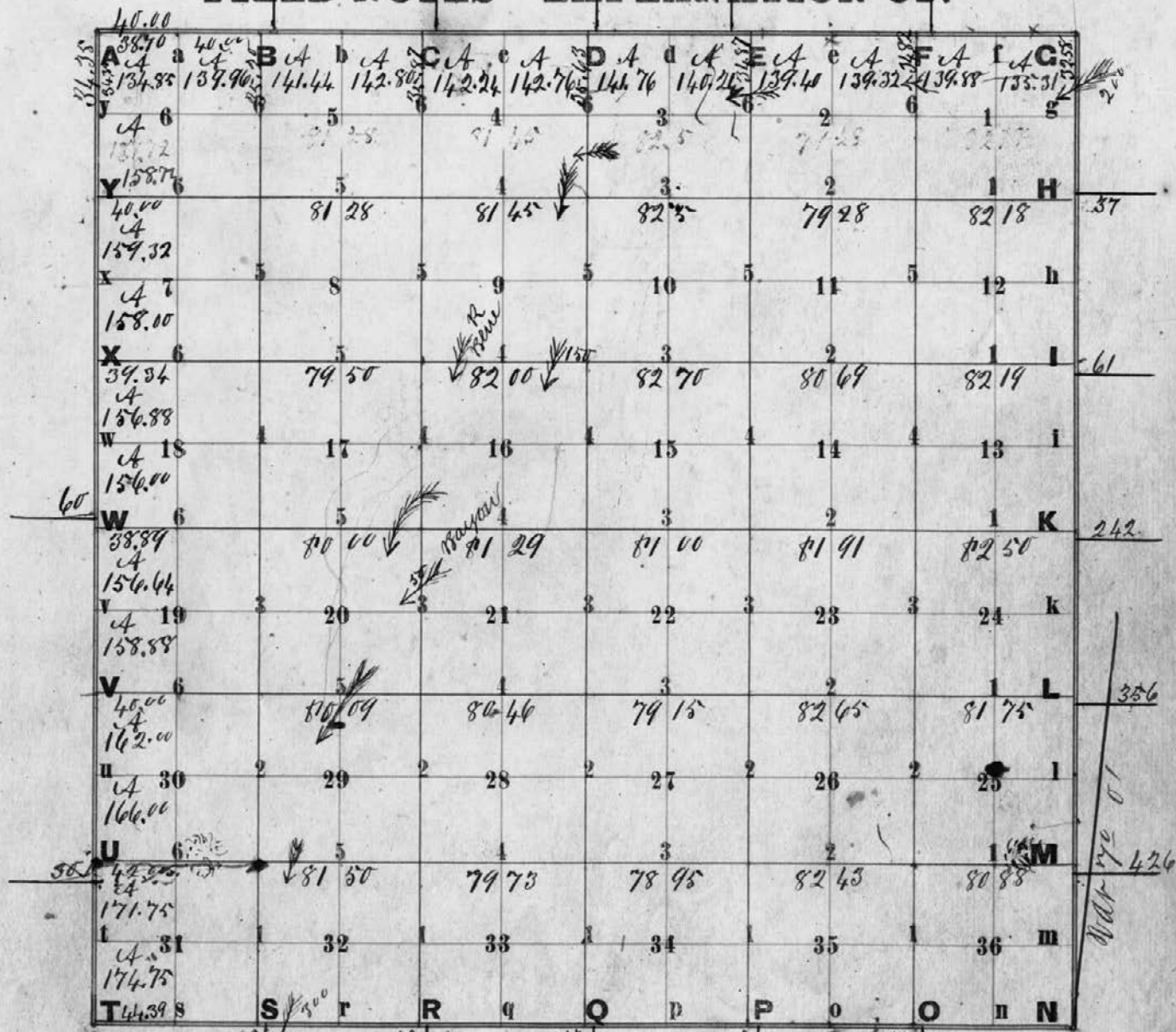

Township 12 North, Range 6 East of 2nd Principal Meridian

1.30 by ORIG RECORDED

Handwritten notes on the left margin:
 36.25
 40.00
 134.85
 139.90
 141.44
 142.80
 142.24
 142.76
 144.76
 140.25
 139.40
 139.32
 139.88
 135.31
 40.00
 158.77
 40.00
 159.32
 47
 158.00
 39.84
 156.88
 418
 156.00
 60
 38.89
 156.44
 419
 158.88
 40.00
 162.00
 430
 166.00
 56
 42.35
 171.75
 431
 174.75
 4439

Handwritten notes on the right margin:
 37
 61
 242
 9-17
 356
 14
 426
 WATER

Field Notes of Shelby County, Indiana.

Township *12* North, Range *6* East.

Corners.	Bearing Trees.	Diam.	Courses.	Dist.		Corners.	Bearing Trees.	Diam.	Courses.	Dist.
<i>A</i>	<i>Hickory</i>	<i>12</i>	<i>S 29 N</i>	<i>32</i>		<i>G</i>	<i>Elm</i>	<i>12</i>	<i>N 4 N</i>	<i>18</i>
	<i>Beech</i>	<i>10</i>	<i>N 30 E</i>	<i>31</i>			<i>So</i>	<i>12</i>	<i>S 65 E</i>	<i>20</i>
<i>A'</i>						<i>G'</i>	<i>Beech</i>	<i>10</i>	<i>N 68 N</i>	<i>18</i>
<i>B</i>	<i>Hickory</i>	<i>10</i>	<i>N 36 E</i>	<i>34</i>		<i>H</i>	<i>Sugar</i>	<i>10</i>	<i>N 76 E</i>	<i>20</i>
	<i>So</i>	<i>13</i>	<i>S 33 N</i>	<i>34</i>			<i>Beech</i>	<i>10</i>	<i>N 49 N</i>	<i>10</i>
<i>B'</i>						<i>H'</i>	<i>Hickory</i>	<i>9</i>	<i>N 65 E</i>	<i>29</i>
<i>C</i>	<i>Beech</i>	<i>15</i>	<i>N 68 1/2 E</i>	<i>27</i>			<i>Beech</i>	<i>7</i>	<i>N 33 N</i>	<i>8</i>
	<i>So</i>	<i>30</i>	<i>S 40 1/2 N</i>	<i>15</i>			<i>So</i>	<i>7</i>	<i>S 62 E</i>	<i>10</i>
<i>C'</i>						<i>I</i>	<i>So</i>	<i>27</i>	<i>N 35 N</i>	<i>4</i>
<i>D</i>	<i>Box Elder</i>	<i>2</i>	<i>N 35 E</i>	<i>23</i>			<i>Ash</i>	<i>9</i>	<i>S 83 E</i>	<i>18</i>
	<i>Hackberry</i>	<i>10</i>	<i>S 45 N</i>	<i>27</i>		<i>I'</i>	<i>Beech</i>	<i>21</i>	<i>N 5 E</i>	<i>17</i>
<i>D'</i>							<i>So</i>	<i>12</i>	<i>S 27 E</i>	<i>19</i>
<i>E</i>	<i>Buckeye</i>	<i>10</i>	<i>S 80 E</i>	<i>18</i>		<i>K</i>	<i>So</i>	<i>9</i>	<i>S 36 E</i>	<i>21</i>
	<i>Beech</i>	<i>8</i>	<i>N 64 E</i>	<i>30</i>			<i>Hickory</i>	<i>12</i>	<i>N 12 N</i>	<i>15</i>
<i>E'</i>						<i>K'</i>	<i>So</i>	<i>18</i>	<i>S 12 N</i>	<i>30</i>
<i>F</i>	<i>Elm</i>	<i>18</i>	<i>S 64 N</i>	<i>13</i>			<i>Beech</i>	<i>12</i>	<i>N 32 N</i>	<i>42</i>
	<i>So</i>	<i>10</i>	<i>S 62 E</i>	<i>20</i>		<i>L</i>	<i>So</i>	<i>7</i>	<i>N 33 E</i>	<i>4</i>
<i>F'</i>						<i>L'</i>	<i>Elm</i>	<i>24</i>	<i>S 68 N</i>	<i>26</i>
<i>F''</i>							<i>Beech</i>	<i>20</i>	<i>S 39 N</i>	<i>32</i>
							<i>So</i>	<i>12</i>	<i>N 32 E</i>	<i>26</i>
						<i>M</i>	<i>Ash</i>	<i>14</i>	<i>S 67 N</i>	<i>23</i>
							<i>Beech</i>	<i>12</i>	<i>N 31 E</i>	<i>20</i>

Field Notes of Shelby County, Indiana.

Township *12* North, Range *6* East.

Corners.	Bearing Trees.	Diam.	Courses.	Dist.		Corners.	Bearing Trees.	Diam.	Courses.	Dist.
<i>M'</i>	<i>Hickory</i>	<i>6</i>	<i>S 57 E</i>	<i>6</i>		<i>S</i>	<i>Buckeye</i>	<i>6</i>	<i>S 16 E</i>	<i>10</i>
	<i>Beech</i>	<i>4</i>	<i>N 55 W</i>	<i>—</i>			<i>S Oak</i>	<i>20</i>	<i>N 9 E</i>	<i>21</i>
<i>N</i>	<i>do</i>	<i>12</i>	<i>S 17 E</i>	<i>17</i>		<i>S'</i>	<i>H. Beech</i>	<i>7</i>	<i>S 36 W</i>	<i>5</i>
	<i>do</i>	<i>9</i>	<i>S 71 W</i>	<i>20</i>			<i>B. Ash</i>	<i>9</i>	<i>N 37 W</i>	<i>36</i>
<i>N'</i>	<i>Ash</i>	<i>20</i>	<i>N 22 E</i>	<i>2</i>		<i>T</i>	<i>Beech</i>	<i>9</i>	<i>W</i>	<i>30</i>
	<i>Elm</i>	<i>27</i>	<i>S 57 W</i>	<i>12</i>			<i>do</i>	<i>8</i>	<i>N 38 E</i>	<i>11</i>
<i>O</i>	<i>Ash</i>	<i>12</i>	<i>S 36 W</i>	<i>12</i>		<i>T'</i>				
	<i>Beech</i>	<i>5</i>	<i>N 33 W</i>	<i>33</i>						
<i>O'</i>	<i>Imp. Ash</i>	<i>6</i>	<i>S 67 W</i>	<i>29</i>		<i>U</i>	<i>R-Oak</i>	<i>60</i>	<i>N 12 W</i>	<i>14</i>
	<i>Beech</i>	<i>10</i>	<i>S 39 E</i>	<i>—</i>			<i>Ash</i>	<i>7</i>	<i>S 33 E</i>	<i>14</i>
<i>P</i>	<i>do</i>	<i>21</i>	<i>N 79 E</i>	<i>8</i>		<i>U'</i>				
	<i>Elm</i>	<i>9</i>	<i>S 11 E</i>	<i>2</i>						
<i>P'</i>	<i>Beech</i>	<i>8</i>	<i>S 47 W</i>	<i>11</i>		<i>V.</i>				
	<i>do</i>	<i>7</i>	<i>N 68 E</i>	<i>5</i>						
<i>Q</i>	<i>Hackberry</i>	<i>6</i>	<i>S 68 E</i>	<i>8</i>		<i>V'</i>				
	<i>Ash</i>	<i>6</i>	<i>N 26 W</i>	<i>15</i>						
<i>Q'</i>	<i>Beech</i>	<i>9</i>	<i>N 6 E</i>	<i>5</i>		<i>W.</i>	<i>Ash</i>	<i>18</i>	<i>N 11 E</i>	<i>30</i>
	<i>do</i>	<i>9</i>	<i>S 44 W</i>	<i>17</i>			<i>do</i>	<i>5</i>	<i>S 3 W</i>	<i>19</i>
<i>R</i>	<i>B. Ash</i>	<i>9</i>	<i>S 34 E</i>	<i>5</i>		<i>W'</i>				
	<i>B. Oak</i>	<i>4</i>	<i>S 72 W</i>	<i>18</i>						
<i>R'</i>	<i>Hickory</i>	<i>9</i>	<i>N 50 W</i>	<i>5</i>		<i>X.</i>				
	<i>Beech</i>	<i>12</i>	<i>S 39 E</i>	<i>26</i>		<i>X'</i>				
						<i>Y.</i>				
						<i>Y'</i>				

Field Notes of Shelby County, Indiana.

Township *12* North, Range *6* East.

Corners.	Bearing Trees.	Diam.	Courses.	Dist.	Corners.	Bearing Trees.	Diam.	Courses.	Dist.
<i>25.26.35.36</i>	<i>Maple</i>	<i>18</i>	<i>N 8 E</i>	<i>7</i>	<i>21.22.27.28</i>	<i>Elm</i>	<i>10</i>	<i>N 33 E</i>	<i>9</i>
	<i>do</i>	<i>14</i>	<i>S 8 N</i>	<i>19</i>		<i>Beech</i>	<i>5</i>	<i>S 16 E</i>	<i>8</i>
<i>23.24.25.26</i>	<i>B. Oak</i>	<i>34</i>	<i>N 30 E</i>	<i>14</i>	<i>15.16.21.22</i>	<i>do</i>	<i>7</i>	<i>N 43 N</i>	<i>6</i>
	<i>Hickory</i>	<i>16</i>	<i>S 54 N</i>	<i>32</i>		<i>do</i>	<i>5</i>	<i>S 80 E</i>	<i>8</i>
<i>13.14.23.24</i>	<i>B. Oak</i>	<i>27</i>	<i>S 3 N</i>	<i>22</i>	<i>9.10.15.16</i>	<i>Hickory</i>	<i>4</i>	<i>N 69 E</i>	<i>7</i>
	<i>Beech</i>	<i>5</i>	<i>N 3 N</i>	<i>5</i>		<i>Elm</i>	<i>14</i>	<i>N 58 N</i>	<i>15</i>
<i>11.12.13.14</i>	<i>do</i>	<i>14</i>	<i>S 77 E</i>	<i>9</i>	<i>3.4.9.10</i>	<i>Ash</i>	<i>6</i>	<i>S 53 -</i>	<i>44</i>
	<i>do</i>	<i>30</i>	<i>S 86 N</i>	<i>28</i>		<i>do</i>	<i>10</i>	<i>N 42 N</i>	<i>28</i>
<i>1.2.11.12</i>	<i>do</i>	<i>6</i>	<i>N 37 E</i>	<i>22</i>	<i>28.29.32.33</i>	<i>Beech</i>	<i>24</i>	<i>N 75 E</i>	<i>17</i>
	<i>do</i>	<i>10</i>	<i>N</i>	<i>30</i>		<i>Sugar</i>	<i>10</i>	<i>N 88 N</i>	<i>28</i>
<i>26.27.34.35</i>	<i>Oak</i>	<i>20</i>	<i>N 31 N</i>	<i>4</i>	<i>20.21.28.29</i>	<i>Hickory</i>	<i>12</i>	<i>S 68 1/2 E</i>	<i>14</i>
	<i>Hickory</i>	<i>12</i>	<i>S 76 E</i>	<i>31</i>		<i>Elm</i>	<i>14</i>	<i>S 38 N</i>	<i>9</i>
<i>22.23.26.27</i>	<i>Ash</i>	<i>15</i>	<i>S 47 E</i>	<i>20</i>	<i>16.17.20.21</i>	<i>B. Elder</i>	<i>9</i>	<i>S 13 N</i>	<i>34</i>
	<i>Oak</i>	<i>12</i>	<i>N 59 N</i>	<i>19</i>		<i>Hackberry</i>	<i>3</i>	<i>N 2 E</i>	<i>34</i>
<i>14.15.22.23</i>	<i>Beech</i>	<i>8</i>	<i>S 4 N</i>	<i>26</i>	<i>8.9.16.17</i>	<i>Elm</i>	<i>3</i>	<i>N 75 N</i>	<i>12</i>
	<i>H. Beech</i>	<i>6</i>	<i>N 7 E</i>	<i>15</i>		<i>Ash</i>	<i>4</i>	<i>S 14 N</i>	<i>31</i>
<i>10.11.14.15</i>	<i>Beech</i>	<i>16</i>	<i>S 49 E</i>	<i>23</i>	<i>4.5.8.9</i>	<i>Sugar</i>	<i>15</i>	<i>S 87 1/2 E</i>	<i>7</i>
	<i>do</i>	<i>30</i>	<i>N 6 E</i>	<i>22</i>		<i>do</i>	<i>14</i>	<i>N 6 N</i>	<i>9</i>
<i>2.3.10.11</i>	<i>Ash</i>	<i>15</i>	<i>S 47 E</i>	<i>9</i>	<i>29.30.31.32</i>	<i>Beech</i>	<i>4</i>	<i>S 3 E</i>	<i>8</i>
	<i>Beech</i>	<i>30</i>	<i>N 80 N</i>	<i>48</i>		<i>do</i>	<i>10</i>	<i>N 23 E</i>	<i>13</i>
<i>27.28.33.34</i>	<i>Poplar</i>	<i>30</i>	<i>N 48 E</i>	<i>30</i>	<i>19.20.29.30</i>	<i>Hackberry</i>	<i>14</i>	<i>N 78 E</i>	<i>12</i>
	<i>Walnut</i>	<i>18</i>	<i>S 66 N</i>	<i>19</i>		<i>Hickory</i>	<i>24</i>	<i>S 50 N</i>	<i>14</i>

Field Notes of Shelby County, Indiana.

Township *12* North, Range *6* East.

Corners.	Bearing Trees.	Diam.	Courses.	Dist.		Corners.	Bearing Trees.	Diam.	Courses.	Dist.
17.18.19.20	Beech	10	S 86 N	11		2	Ash	7	S 39 E	28
	So	9	N 56 E	48		"	So	6	N 56 N	19
7.8.17.18	Jugwood	4	S 64 N	29		3	Beech	10	S 64 N	30.
	Beech	6	N 64 E	20		"	So	10	N 79 E	20
5.6.7.8	So	9	S 55 E	3		4	So	4	N 68 N	4
	Jugwood	5	S 34 N	22		"	So	4	S 74 E	15
						5	Calm	20	S 70 E	14
M to U						"	Hackberry	5	S 79 N	43
1	Beech	20	S 32 N	3		6	Hickory	10	N 26 E	12
"	So	4	N 10 E	23			Calm	30	S 26 E	18
2	Sugar	6	S 21 N	8	K to W	1	Beech	4	N 27 E	16
"	So	12	N 39 1/2 E	21		"	So	30	S 21 E	23
3	Beech	4	N 58 E	20		2	Ash	16	E	21
"	Ash	4	S 34 N	20		"	So	10	S 83 N	36
4	Poplar	40	S 83 N	28		3	H. Oak	18	S 26 E	3
"	Sugar	15	N 63 E	25		"	Sugar	10	N 15-	14
5	H. Oak	60	S 9 E	29		4	Ash	30	N 45 E	12
"	Buckeye	10	N 13 N	29		"	Sugar	30	S 23 N	21
6	Beech	6	N 30 E	8		5	Ash	9	N 55 N	19
	So	10	S 20 E	8		"	-	12	S 31 E	44
L to V						6	H. Oak	20	N 40 E	25-
1	Hickory	18	N 89 N	39			Beech	7	S 43 N	3
	Ash	9	S 47 E	8						

Field Notes of Shelby County, Indiana.

Township *12* North, Range *6* East.

Corners.	Bearing Trees.	Diam.	Courses.	Dist.		Corners.	Bearing Trees.	Diam.	Courses.	Dist.
<i>II to X</i>										
<i>1</i>	<i>Ash</i>	<i>10</i>	<i>N 35 E</i>	<i>6</i>		<i>5</i>	<i>Ash</i>	<i>15</i>	<i>N 31 W</i>	<i>13</i>
<i>"</i>	<i>Beech</i>	<i>6</i>	<i>S 5 N</i>	<i>5</i>		<i>"</i>	<i>So</i>	<i>12</i>	<i>S 43 E</i>	<i>11</i>
<i>2</i>	<i>So</i>	<i>12</i>	<i>N 4 E</i>	<i>17</i>		<i>6</i>	<i>Beech</i>	<i>15</i>	<i>S 34 W</i>	<i>20</i>
<i>"</i>	<i>So</i>	<i>12</i>	<i>S 46 W</i>	<i>24</i>			<i>Ash</i>	<i>15</i>	<i>N 31 W</i>	<i>13</i>
<i>3</i>	<i>Hackberry</i>	<i>20</i>	<i>S 57 W</i>	<i>10</i>	<i>O to F</i>	<i>1</i>	<i>Beech</i>	<i>12</i>	<i>S 88 E</i>	<i>19</i>
<i>"</i>	<i>Buckeye</i>	<i>10</i>	<i>N 76 E</i>	<i>11</i>		<i>"</i>	<i>So</i>	<i>9</i>	<i>S 45 W</i>	<i>20</i>
<i>4</i>	<i>Hackberry</i>	<i>12</i>	<i>N 81 W</i>	<i>5</i>		<i>2</i>	<i>Ash</i>	<i>10</i>	<i>N 5 W</i>	<i>16</i>
<i>"</i>	<i>So</i>	<i>16</i>	<i>S 71 E</i>	<i>17</i>		<i>"</i>	<i>Thorn</i>	<i>4</i>	<i>S 26 W</i>	<i>17</i>
<i>5</i>	<i>Sugar</i>	<i>36</i>	<i>S 59 W</i>	<i>6</i>		<i>3</i>	<i>Sugar</i>	<i>6</i>	<i>N 4 E</i>	<i>8</i>
<i>"</i>	<i>Beech</i>	<i>7</i>	<i>N 86 E</i>	<i>24</i>		<i>"</i>	<i>Beech</i>	<i>10</i>	<i>S 6 W</i>	<i>31</i>
<i>6</i>	<i>So</i>	<i>30</i>	<i>S 77 W</i>	<i>9</i>		<i>4</i>	<i>Buckeye</i>	<i>10</i>	<i>S 66 E</i>	<i>23</i>
<i>"</i>	<i>Hickory</i>	<i>10</i>	<i>N 87 E</i>	<i>29</i>		<i>"</i>	<i>Hickory</i>	<i>10</i>	<i>N 52 W</i>	<i>17</i>
<i>H to Y</i>						<i>5</i>	<i>B. Ash</i>	<i>10</i>	<i>N 46 E</i>	<i>24</i>
<i>1</i>	<i>Beech</i>	<i>14</i>	<i>S 21 W</i>	<i>16</i>		<i>"</i>	<i>W. Beech</i>	<i>4</i>	<i>S 76 W</i>	<i>13</i>
<i>"</i>	<i>Sugar</i>	<i>5</i>	<i>N 20 W</i>	<i>18</i>		<i>6</i>	<i>Beech</i>	<i>10</i>	<i>S 18 E</i>	<i>18</i>
<i>2</i>	<i>Beech</i>	<i>10</i>	<i>N 47 W</i>	<i>7</i>			<i>Ash</i>	<i>30</i>	<i>N 4 W</i>	<i>3</i>
<i>"</i>	<i>So</i>	<i>10</i>	<i>S</i>	<i>24</i>	<i>P to E</i>	<i>1</i>	<i>Hickory</i>	<i>18</i>	<i>S 87 E</i>	<i>28</i>
<i>3</i>	<i>Haw</i>	<i>4</i>	<i>S 85 E</i>	<i>21</i>		<i>"</i>	<i>Elm</i>	<i>12</i>	<i>S 80 W</i>	<i>22</i>
<i>"</i>	<i>Buckeye</i>	<i>8</i>	<i>S 50 W</i>	<i>4</i>		<i>2</i>	<i>Poplar</i>	<i>18</i>	<i>N 69 1/2 E</i>	<i>21</i>
<i>4</i>	<i>Elm</i>	<i>4</i>	<i>N 17 W</i>	<i>8</i>		<i>"</i>	<i>Beech</i>	<i>10</i>	<i>S 78 1/2 W</i>	<i>39</i>
<i>"</i>	<i>Beech</i>	<i>15</i>	<i>S 34 W</i>	<i>20</i>						

Field Notes of Shelby County, Indiana.

Township 12 North, Range 6 East.

Corners.	Bearing Trees.	Diam.	Courses.	Dist.	Corners.	Bearing Trees.	Diam.	Courses.	Dist.
3	H Oak	14	S 74 E	27	R to C				
"	Ash	24	N 8 W	23	1	Oak	15	N 54 E	4
4	Beech	12	S 32 W	15	"	Sugar	8	N -	-
"	So	10	N 3 1/2 E	22	2	So	48	N 29 W	22
5	So	14	S 3 E	16	"	Beech	14	S 48 E	39
"	Cherry	3	N 49 W	31	3	Hickory	18	S -	4
6	Hackberry	15	S 5 E	3	"	Oak	12	N 42 E	11
Q to D	Buckeye	10	N 15 E	14	4	Haw	6	S 22 E	2
1	Maple	18	S 74 E	12	"	Hickory	18	N 34 W	31
"	Gum	7	N 80 W	16	5	Beech	15	S 8 1/2 E	34
2	Beech	10	N 86 E	24	"	So	20	S 82 W	23
"	So	20	N 81 W	24	6	Hickory	12	S 39 E	4
3	So	12	S 60 E	5	"	Beech	12	N 68 W	4
"	Sogwood	4	N 71 W	23	S to B				
4	Buckeye	9	S 60 E	13	1	Hackberry	18	N 15 W	15
"	So	5	S 81 W	24	"	So	10	S 20 W	38
5	Ash	6	S	47	2	Ash	14	N 79 E	18
"	So	10	N 12 W	39	"	Beech	20	S 81 W	27
6	Buckeye	10	N 4 E	45	3	So	10	S 62 E	3
"	Hackberry	30	S 17 W	12	"	So	30	N 53 W	-
					4	Sugar	20	N 23 E	9
					"	B. Ash	18	S 5 W	36

Field Notes of Shelby County, Indiana.

Township 12 North, Range 6 East.

Corners.	Bearing Trees.	Diam.	Courses.	Dist.	Corners.	Bearing Trees.	Diam.	Courses.	Dist.
3	Beech	80	N 25 E	19					
"	do	10	S 25 W	18					
6	do	15	S 84 E	8					
"	Ironwood	3	S 70 W	7					

Field Notes of Shelby County, Indiana.

8

INDEX

Township *12* North, Range *6* East.

Corners.	Bearing Trees.	Diam.	Courses.	Dist.	Corners.	Bearing Trees.	Diam.	Courses.	Dist.
<i>1</i>	<i>9</i>		<i>24</i>	<i>1 48</i>					
<i>2</i>	<i>15</i>		<i>25</i>	<i>1 51</i>					
<i>3</i>	<i>21</i>		<i>26</i>	<i>1 57</i>					
<i>4</i>	<i>25</i>		<i>27</i>	<i>1 63</i>					
<i>5</i>	<i>31</i>		<i>28</i>	<i>1 69</i>					
<i>6</i>	<i>37</i>		<i>29</i>	<i>1 75</i>					
<i>7</i>	<i>43</i>		<i>30</i>	<i>1 81</i>					
<i>8</i>	<i>49</i>		<i>31</i>	<i>1 87</i>					
<i>9</i>	<i>55</i>		<i>32</i>	<i>1 93</i>					
<i>10</i>	<i>61</i>		<i>33</i>	<i>1 99</i>					
<i>11</i>	<i>67</i>		<i>34</i>	<i>2 05</i>					
<i>12</i>	<i>73</i>		<i>35</i>	<i>2 11</i>					
<i>13</i>	<i>79</i>		<i>36</i>	<i>2 17</i>					
<i>14</i>	<i>85</i>								
<i>15</i>	<i>91</i>								
<i>16</i>	<i>97</i>								
<i>17</i>	<i>103</i>								
<i>18</i>	<i>109</i>								
<i>19</i>	<i>115</i>								
<i>20</i>	<i>121</i>								
<i>21</i>	<i>127</i>								
<i>22</i>	<i>133</i>								
<i>23</i>	<i>139</i>								

Remarks

Page
224.

to
274

Plats

Page
223
to
275

Record of Surveys in Shelby County, Indiana.

Section / Township / North, Range East.

Date, Intermediate Corners, &c., &c.	Corners.	Stone, Mark, &c.	Acres.	Bound.	Bearings, Trees, &c.	Diam.	Courses.	Dist.
Fargis, Surveyor	B.	Stone			Elm	30	S 30 E	14
					do	12	N 36 W	27
	L	Boulder			Sugar	18	S 60 E	20
	M	Stone			do	30	S 17 E	80
20 R. N of	W	"			Hawthorn	6	N 9 E	16 1/2
					Beech	6	S 30 E	24
20 R. N of Calliott, Surveyor. Mar 22nd 1833	V	"			H-Ash	20	N 88 E	43
					Beech	18	N 12 W	3
					do	9	S 70 W	22
Fargis Surveyor	Z	"			No Wit			
	Y	"			"			
	O	"			Beech	15	S 22 W	11
	M	"			do	15	N 31 W	13
21 Rods E of Aug 19th 1872 Perry Survey 88 1/2 15 64 chains S of 7 90 " S of 15 64 " S and 325 chains S 79 8 of 14 00 " S 15 W of the above corner 2 64 " S 44 E of the above corner	O	L Stone m 0			Elm	30	S 23 W	130
	M	" " m 11			Bash	10	N 54 W	48
					Buckeyes	14	S 3 W	33
					coffeenut	14	N 83 W	66
	A	L Stone m 15			H Locust		N 7 E	48 1/2
		" " 720			Beech	20	N 50 W	105
		" " 325			no wit Au			
		" " set 4 Rods S 18 W of the corner			no wit Au			
		" " set 5 Rods S 18 W of the corner			no wit Au			

Record of Surveys in Shelby County, Indiana.

Section /

Township 12

North, Range 6

East.

Date, Intermediate Corners, &c., &c.	Corners.	Stone, Mark, &c.	Acres.	Land.	Bearings, Trees, &c.	Diam.	Courses.	Dist.
<p>328 Chains West of 2164 " South of 775 " S41 E of the above Nov 14th 15 + 17th 1873 Jerry Dugan 856</p>	<p>L A</p>	<p>Stone m 13 " mark 6 " Set 30 links N 41 W of true corner mark 6</p>			<p>now it is</p>		<p>this Stone is on Range line South of B River ^{with} no</p>	

Record of Surveys in Shelby County, Indiana.

Section *2* Township *12* North, Range *6* East.

Date, Intermediate Corners, &c., &c.	Corners.	Stone, Mark, &c.	Acres.	Innd.	Bearings, Trees, &c.	Diam.	Courses.	Dist.	
<i>Rock Surveyor</i>	C				<i>Locust</i>	<i>23'</i>	<i>29 E</i>	<i>95'</i>	
	L				<i>Beech</i>	<i>18'</i>	<i>84 E</i>	<i>47'</i>	
					<i>do</i>	<i>10'</i>	<i>63 N</i>	<i>124 1/2'</i>	
	M N	L-Stone				<i>Sugar</i>	<i>16'</i>	<i>1 1/2 N</i>	<i>85'</i>
						<i>No Nit</i>			
	W	"				<i>Sugar</i>	<i>15'</i>	<i>87 E</i>	<i>19'</i>
					<i>do</i>	<i>16'</i>	<i>43 E</i>	<i>10'</i>	
<i>Elliott, Surveyor Apr 10th 1864</i>	M O X Y	" 2 Boulder G. Stone " 2							
						<i>No Nit</i>			
						<i>Stone</i>			<i>4 R.</i>
						<i>No Nit</i>			
<i>March 3rd 1887. 2 rods N. of 20 rods W. of</i>	O	M 200. Limestone			<i>Norris, Surveyor</i>				
	P	P 20. Limestone			<i>Finley, S. S.</i>				
<i>John W. Whitlock</i>	W	P. R. Rail			See Tie File		} See Remarks page 228		

Record of Surveys in Shelby County, Indiana.

Section *D* Township *12* North, Range *6* East.

Date, Intermediate Corners, &c., &c.	Corners.	Stone, Mark, &c.	Acres.	Diam.	Bearings, Trees, &c.	Diam.	Courses.	Dist.	
Aug 20 th } 19. R. E. 1847. } 73. R. S.	of	C	Stone			Beech	22	N 37 1/2 W	110
		Walnut	15	S 67 W	89 1/2				
		Maple	12	N 26 E	20				
		Ash	11	N 32 1/2 W	28				
Mar 20 th , 1847 20. R. S.	of	P	"			Buckeye	10	S 81 E	9
		do	14	S 18	16				
		Beech	30	N 60 W	12				
		Buckeye	8	S 83 W	19				
40. R. S. See, Remarks Page 226, 10 35 chus East of 10 ^{681.78} 33 chus East of October 1880. C. P. Webster S. C. 14.60 chains North of 12 chains North of 5 ³³² chains North of May 7 th 1888. J. Wiley S. C.	of	N	"			do nit			
		P	"			William Rock, Surveyor			
		E	"			Wackley	15	N 59 3/4 W	63
		N	"			do	24	N 86 E	78
						Elm	15	S 12 W	82 1/2
						Swamp Ash	18	S 48 1/2 W	75
	N	Lime "							
	L	Limestone							
	M	Limestone							
	U	Limestone							

William Rock, Surveyor

Wackley 15 N 59 3/4 W 63

do 24 N 86 E 78

Elm 15 S 12 W 82 1/2

Swamp Ash 18 S 48 1/2 W 75

Lime " in pond or gravel bar on side of river.

Limestone on East bank of river near ford place.

Limestone "

Record of Surveys in Shelby County, Indiana.

Section 3 Township 12 North, Range 6 East.

Date, Intermediate Corners, &c., &c.	Corners.	Stone, Mark, &c.	Acres.	Hund.	Bearings, Trees, &c.	Diam.	Courses.	Dist.
John W. Whitlock 18, JAN, 1979	C	Bolt			See Tie File		} See Remarks { page # 228	

Record of Surveys in Shelby County, Indiana.

Section **4**

Township **12**

North, Range **6**

East.

Date, Intermediate Corners, &c., &c.	Corners.	Stone, Mark, &c.	Acres.	Hand.	Bearings, Trees, &c.	Diam.	Courses.	Dist.
<i>Apr 9th 1831^c</i>	M	Stone			Buckeye	9	S 34 N	18
					Sugar	20	S 77 E	23
<i>Calliatt, Surveyor Dec 16th 1867^c 6 2/3 R N of</i>	O	Boulder			No Nit			
	W				Sycamore	30	S 25 N	22 1/2
					So	13	N 1 1/2 N	31 1/2
	Y				Beech	10	E	17
<i>40 R. N. of above 40 R. S. of above 40 R. E. of above Miller Surveyor 1/2 X to N. } <u>This is sec. 9.</u></i>	A	Stone			So	8	S 28 N	13
					Chaple	24	N 4 E	44
					Sycamore	9	S 34 N	39
			"		No Nit			
			"		"			
			"		Walnut	20	S 63 E	41
			"		Sycamore	18	N 30 N	67
			"		Beech	18	S 86 1/2 E	55
			"		Buckeye	12	S 82 E	51
			"		Hem Locust	10	S 58 N	90
<i>Old Stone Post 28 links deep for 10 3/4 chs East of Ia, 4, and C. P. Webster S.S.B. October 26th 1880</i>	N	"			Hackberry	36	N 48 1/4 N	64 1/2
					Hackberry	15	N 39 3/4 N	63
					So	24	N 86 E	78
	X				Stone		South	20 1/2
	Ia				Hickory	24	N 20 1/4 E	105 1/2
				Hackberry	15	S 90 1/2 N	100	
				So	17	N 77 1/2 E	13	

Record of Surveys in Shelby County, Indiana.

Section *5* Township *12* North, Range *6* East.

Date, Intermediate Corners, &c., &c.	Corners.	Stone, Mark, &c.	Acres.	Hnd.	Bearings, Trees, &c.	Diam.	Courses.	Dist.
	<i>A</i>	<i>Stone</i>			<i>Beech</i>	<i>22</i>	<i>S 17 1/2 N</i>	<i>33 3/4</i>
	<i>P</i>	<i>"</i>			<i>do</i>	<i>25</i>	<i>N 89 1/2 E</i>	<i>3 3</i>
	<i>O</i>	<i>"</i>			<i>Poplar</i>	<i>15</i>	<i>S 32 N</i>	<i>36 1/4</i>
	<i>D</i>	<i>"</i>			<i>Hickory</i>	<i>14</i>	<i>N 73 1/2 E</i>	<i>36 1/4</i>
	<i>N</i>	<i>"</i>			<i>Beech</i>	<i>8</i>	<i>S 19 1/2 N</i>	<i>27 1/2</i>
					<i>do</i>	<i>7</i>	<i>S 2 1/2 E</i>	<i>31 1/4</i>
					<i>do</i>	<i>18</i>	<i>N 52 1/2 E</i>	<i>48 3/4</i>
					<i>do</i>	<i>13</i>	<i>S 8 E</i>	<i>12</i>
					<i>Sugar</i>	<i>5</i>	<i>N 9 N</i>	<i>26 1/2</i>
<i>60. R. S</i>	<i>of same</i>	<i>L. Boulder</i>			<i>No Tit</i>			
<i>120 R. S</i>	<i>of same</i>				<i>Beech</i>	<i>6</i>	<i>S 66 N</i>	<i>7</i>
					<i>S. Wood</i>	<i>3</i>	<i>N 32 1/2 N</i>	<i>4</i>
	<i>M</i>	<i>Stone</i>			<i>Hickory</i>	<i>4</i>	<i>N 58 E</i>	<i>6 1/4</i>
					<i>Beech</i>	<i>8</i>	<i>N</i>	<i>21 1/4</i>
<i>60. R. S</i>	<i>of same</i>	<i>"</i>			<i>do</i>	<i>12</i>	<i>N 39 1/2 N</i>	<i>48</i>
					<i>H. Oak</i>	<i>40</i>	<i>N 75 1/2 N</i>	<i>61</i>
<i>120. R. S</i>	<i>of same</i>	<i>"</i>			<i>Beech</i>	<i>16</i>	<i>N 34 1/2 E</i>	<i>17 1/2</i>
					<i>Hickory</i>	<i>8</i>	<i>N 42 1/2 N</i>	<i>4 1/2</i>
	<i>C</i>	<i>"</i>			<i>Alum</i>	<i>10</i>	<i>S 23 N</i>	<i>30</i>
					<i>Oak</i>	<i>26</i>	<i>N 42 E</i>	<i>47 1/2</i>
	<i>S</i>	<i>"</i>			<i>Beech</i>		<i>N 34 E</i>	<i>42</i>
					<i>do</i>		<i>S 38 E</i>	<i>3 3</i>
	<i>T</i>	<i>"</i>			<i>do</i>	<i>16</i>	<i>N 4 N</i>	<i>30</i>
					<i>Hickory</i>	<i>15</i>	<i>N 31 1/2 E</i>	<i>36 1/2</i>

Record of Surveys in Shelby County, Indiana.

Section 3¹ Township 12 North, Range 6 East.

Date, Intermediate Corners, &c., &c.	Corners.	Stone, Mark, &c.	Acres.	Hund.	Bearings, Trees, &c.	Diam.	Courses.	Dist.
	U	Stone			Beech	28	S 41 E	17 1/2
					do	12	N 36 1/2 E	4 6/4
Rock Surveyor Mar 13 th 1862	R	"			Sugar	10	N 8 1/2 E	16 1/2
60 R S.	P	"			Ash	12	S 8 E	15
					Hickory	25	S 8 1/2 N	48
41. R. N.	Z	"			do	8	N 7 1/2 N	68
					Mulberry	8	N 75 E	79 1/2
60. R. S.	O	"			Y-ash	30	S 60 1/2 E	74 1/2
					Beech	30	N 71 1/2 N	29 1/2
6 R N	R	"			Hickory	10	S 53 1/2 N	36
					Sugar	12	N 11 N	3 3/4
118 R S 2 S 4 6 R N	O	"			St-wood	7	N 88 N	14
					Beech	26	N 35 1/2 N	25
	Y	"			Sugar	15	S 39 1/2 N	15
					Hickory	8	N 22 E	11
6. R. N.	Same	"			N-oak	14	N 49 N	17 1/2
					Beech	12	S 87 N	17 1/2
	X	"			Sugar	30	S 36 E	13
					Beech	24	N 64 1/2 E	43
24. R. N.	Same	"			Y-ash	12	N 85 N	83
					N-oak	12	N 17 N	15
24 R N	S	Boulders			N-elm	10	N 61 E	23 1/2
					do Nit			

Notiss, Surveyor

Record of Surveys in Shelby County, Indiana.

Section 6 Township 12 North, Range 6 East.

Date, Intermediate Corners, &c., &c.	Corners.	Stone, Mark, &c.	Acres.	Diam.	Bearings, Trees, &c.	Dist.
<p>Oct 24th 1849</p> <p>Elliott, Surveyor</p> <p>Aug 20th 1850</p>	H	Boulder			Kaickong	32
	Z	"			F. dates	
	V	"			Ash	49
	W	"			Beech	60
	X	"			so	94
	Y	"			Sugar	100
	B	"			Ash	33
	O	"			Kaickong	86
	D	"			Plum	34
	N	"			Kaickong	34
	M	"			so	36
					so	62
					so	172
				Green Berry	8	
		Stone		Kaickong	4	
		"		Calum	23	
		"		Kaickong	31	
		"		Ash	50	
		"		Poplar	18	
		"		so	20	
		"		B-ash	27	
		"		B-ash	28	

Sargin, Surveyor

Record of Surveys in Shelby County, Indiana.

Section 6 Township 12 North, Range 6 East.

Date, Intermediate Corners, &c., &c.	Corners.	Stone, Mark, &c.	Acres.	Hnd.	Bearings, Trees, &c.	Diam.	Courses.	Dist.
John W. Whitlock	12, June, 1978	Z	Iron Pin		See Tie File		See Remarks, pg. 228	
"	10, June, 1978	X	Stone		"		"	

Record of Surveys in Shelby County, Indiana.

Section

7

Township

12

North, Range

6

East.

Date, Intermediate Corners, &c., &c.	Corners.	Stone, Mark, &c.	Acres.	Hund.	Bearings, Trees, &c.	Diam.	Courses.	Dist.
<p>Set a Time stone 120.135 rds North of both in division of Sandefur Tract. Sept. 4, 1931. Ralph Cochran Co. Surveyor</p>	O & N							
<p>John W. Whitlock 12, June, 1978 " 10, June, 1978</p>	E C	Iron Pin Stone			See Tie File "		} See Remarks { page 228	

Record of Surveys in Shelby County, Indiana.

49

Section *8* Township *12* North, Range *6* East.

Date, Intermediate Corners, &c., &c.	Corners.	Stone, Mark, &c.	Acres.	Hnd.	Bearings, Trees, &c.	Diam.	Courses.	Dist.
<p>Nest End of Line Rock, Surveyor Feb 8th 1864 - 107. R. N. of same Sept 21st 1864 - Feb 27th 1864 - Farquie, Surveyor Mar 18th 1862 - 18. R. S. of 18. R. S. of 107. R. N. of Under dispute, by Mr. Clucker,</p>	L	Stone			Beech	5'	N 32 W	9 1/2
			"		Sugar	5'	S 87 E	6 1/2
			"		Beech	13'	S 89 W	20
			"		R-Oak	20'	N 48 W	16
			"		Sugar	20'	S 11 W	37 1/2
		W	"		No Nit			
		B	"		Beech	4'	S 58 E	7
			"		do	16'	S 70 W	7
		N	"		Sugar	16'	N 20 E	15
			"		do	12'	N 72 W	19
		M	"		Beech	7'	S 39 E	22
		F	"		do	24'	N 32 E	18 1/2
	G	"		Ash	20'	S 50 1/2 W	46	
	O	"		R-Oak	48'	N 75 W	65	
	E	"		S-Ash	40'	N 48 E	36 1/2	
	D	"		R-Oak	60'	N 20 W	30	
	V	"		R-Oak	30'	N 39 W	30	
	X	"		Ash	10'	S 71 1/2 E	3 1/2	
		"		Beech	24'	N 77 E	78 1/2	
		"		Hickory	10'	S 11 1/2 W	34	
		"		Ash	13'	S 57 W	51	
		"		No Nit				
		"		No Nit				

Large Boulder
&

Section 9 Township 12 North, Range 6 East.

Date, Intermediate Corners, &c., &c.	Corners.	Stone, Mark, &c.	Acres.	Hund.	Bearings, Trees, &c.	Diam.	Courses.	Dist.
7 rods North of Aug 13 th 1884 Mrs. p. h. S. Oct. 30 th , 1905.	X	Stone			Sycamore Ash	36 10	N 17 1/4 W S 35 E	40 39
Perpetuated a stone 14 chs. and 60 links west of Also one due south of above to show 28 chs. James E. Norris, S. S. County Nov. 19 th , 1906.	D	no witness.						
Re-located James E. Norris, assisted by W. St. Isley.	B	no witness						
Location for & 3' S. of North edge of floor	X	19' E. of of West end of Bridge Brass Bolt in concrete.						

Record of Surveys in Shelby County, Indiana.

61

Section 10

Township 12

North, Range 6

East.

Date, Intermediate Corners, &c., &c.	Corners.	Stone, Mark, &c.	Acres.	Hnd.	Bearings, Trees, &c.	Diam.	Courses.	Dist.
Rock & Sumeyor		Stone			No Nit			
B.R.S	of	" 8			"			
Same	of	" 34			"			
		" 34			"			
					"			
					"			
					"			
					"			
					"			
					"			
					"			
					"			
					"			
					"			
					"			
					"			
					"			
					"			
					"			
					"			
					"			
					"			
					"			
					"			
					"			
					"			
					"			
					"			
					"			
					"			
					"			
					"			
					"			
					"			
					"			
					"			
					"			
					"			
					"			
					"			
					"			
					"			
					"			
					"			
					"			
					"			
					"			
					"			
					"			
					"			
					"			
					"			

Record of Surveys in Shelby County, Indiana.

Section 11 Township 12 North, Range 6 East.

Date, Intermediate Corners, &c., &c.	Corners.	Stone, Mark, &c.	Acres.	Hnd.	Bearings, Trees, &c.	Diam.	Courses.	Dist.
<p><i>Gargiv - Surveyor</i> <i>Mar 1st 1881</i></p>	N	Stone			Hickory	20	S 80 E	13
	T	"			R-Oak	40	S 85 N	19
					Beech	14	S 10 N	12
	U	"	"		So	24	ct 35 E	16
					Sugar	10	E	15
	M	"	"		Hickory	20	ct 25 N	11
					Ash	15	ct 40 E	30
	R	"	"		Beech	24	ct 20 N	20
					So	8	S 31 E	46
	S.	"	"		Gum	30	S 68 1/2 E	48
Ash					16	S 34 1/2 N	64	
Y	"	"		Hickory	16	ct 37 N	70	
				Beech	14	S 82 E	24	
O		Line Stone	15 1/2	+ 0 1/2	Stone		S 18 N	30
				<i>C. F. Webster Deputy S.S.C.</i>				
<p><i>Feb. Elliott - Surveyor</i> <i>May 24th 1888</i></p> <p><i>Chain Carriers Jos. Meley &</i> <i>John Rinehart, Flagman</i> <i>Thomas Dawson.</i></p>	N	Line Stone			No Witness			
<p><i>March 14th, 1899</i></p>	S	Millard			J. Crawford Co. Superior			
<p><i>March 14th, 1899</i></p>	R	Line Stone			No Wit.			
<p><i>March 14th, 1899</i></p>		Boulder			No wit.			
				<i>Millard Crawford Co. Superior</i>				

Record of Surveys in Shelby County, Indiana.

Section

11

Township

12

North, Range

6

East.

Date, Intermediate Corners, &c., &c.	Corners.	Stone, Mark, &c.	Acres.	Hund.	Bearings, Trees, &c.	Diam.	Courses.	Dist.
John W. Whitlock	M	P.K. Nail			See Tie File		} See Remarks page 228	
"	B	"			"			
"	W	Iron Pin			"			"
"	L	P.K. Nails			"			"

Record of Surveys in Shelby County, Indiana.

Section 12 Township 12 North, Range 6 East.

Date, Intermediate Corners, &c., &c.	Corners.	Stone, Mark, &c.	Acres.	Hund.	Bearings, Trees, &c.	Diam.	Courses.	Dist.
Aug 27th 1832	M				Beech	14	N 10 E	53
					do	12	N 30 E	74
20 R. N Elliott, Surveyor Sept 19th 1868	L				do	16	N 33 E	5
	P				do	12	N 6 E	42.
	1/2 of O-P				Blk Hickory	20	N 22 W	30
					N-elm	5	N 73 W	30
					Beech	8	N	25
					do	15	N 3 E	27
1/2 of Torriss, Surveyor Apr 2nd 1868	D-E	stone			B-ash	14	N 10 E	41
					Hickory	12	N 33 E	24
1/2 of same corner 1847	M-N				do	20	N 71 W	73
					Ash	18	N 32 E	109
		Boulder			Beech	10	N 43 E	72
1/2 of	N-O	Small "			B-Oak Str	48	N 41 W	29
1/2 of	W-X	"			No Nit			
1/2 of	X-Y	"			Beech	12	N 39 E	17
		"			P. Notes			
Miller Surveyor July 26th 1875.	Y				N-Oak	48	N 53 E	53
	B	Lime Stone			Lime Stone		N 25 1/4 W	30
	M	Stone			Stone		N 47 E	42 1/2
J. F. Webster, Surveyor. Sept 22nd 1875.					do		N 41 1/4 W	41 1/2
	1/2 N to O	Stone + top			Hickory	8	N 56 1/2 E	58
					Swamp Ash	12	N 44 3/4 W	38 1/4

Record of Surveys in Shelby County, Indiana.

Section 12 Township 12 North, Range 6 East.

Date, Intermediate Corners, &c., &c.	Corners.	Stone, Mark, &c.	Acres.	Hund.	Bearings, Trees, &c.	Diam.	Courses.	Dist.
Sept 22nd 1875; C. F. Webster Surveyor, Jerry Dugan 856	1/2 of X to N 1/2 of S to R 1/2 of M to N	Stone ^{+ top} S. Stone Stone m 12						
May 30th 1880. 20 Rods N of 1752 Chas H if	L L	Stake "			H Oak Beech Do	12 6 12	N 7 W North N E	17 1/2 3 13
20 Chas H if C. F. Webster Surveyor 86	A	" for line						
Perpetuated	MI	Boulder			Beech Gray Ash	16 22	S 43 E N 39 E	73 1.28
Perpetuated	IB	Limestone			Beech Beech	18 18	N 5 E N 14 W	93 1/2 1.01
Chain } Eddie Morris, Carriers } Fields Vice & Vice's Son, Flagman. - John Findall, 4 man. - Fields Vice,								
John W. Whitlock	P	P. K. Nails			See Tie File		{ See Remarks page 228	

Survey made Oct. 1st & 2nd 1883.
by Wm R. Morris, Deputy County Surveyor.

Record of Surveys in Shelby County, Indiana.

Section 13 Township 12 North, Range 6 East.

Date, Intermediate Corners, &c., &c.	Corners.	Stone, Mark, &c.	Acres.	Inud.	Bearings, Trees, &c.	Diam.	Courses.	Dist.
<p>Perpetuated 4 $\frac{85}{11}$ chains S of 4 $\frac{85}{11}$ chains S of April 27th 1872 Jerry Cogan ssc</p>	<p>V M L</p>	<p>Stone m¹¹ " Stone m⁷</p>			<p>Scold witnesses Beech do no mt Au</p>	<p>18</p>	<p>S 5 E S 80 W</p>	<p>25 30</p>

Record of Surveys in Shelby County, Indiana.

Section *14* Township *12* North, Range *6* East.

Date, Intermediate Corners, &c., &c.	Corners.	Stone, Mark, &c.	Acres.	Hund.	Bearings, Trees, &c.	Diam.	Courses.	Dist.
<p><i>Jarvis - Surveyor</i> <i>Oct 24th - 1879</i> <i>Elliott - Surveyor</i></p> <p><i>Set by Measurement.</i></p>	T	Stone			<i>Wickory</i>	24	N 3° E	3'
	S	"			<i>W-Oak</i>	30	N 4° W	67'
	L.B.H	" x			<i>Wickory</i>	6	N 43° E	25'
	I.M	"			<i>B-Ash</i>	14	N 75° E	14'
	N	"			<i>No Nit</i>			
	C.	"			<i>L-Boulder</i>		N 77 1/2° W	83 1/2'
	V	"			<i>X W-Oak</i>	14	N 75° W	76 1/2'
	X	"			<i>Beech</i>	14	N 12° E	74 1/2'
	Z	"			<i>B-Oak</i>		of old Nit	
	O	Boulder			<i>Beech</i>		Stp of old Nit	
Y	"	14		<i>W-Oak</i>	14	N 70° E	104'	
B	Iron Pin			<i>do</i>	24	N 44 1/2° E	84'	
John W. Whitlock				<i>No Nit</i>				
				<i>See Tie File</i>			See Remarks page 228	

Record of Surveys in Shelby County, Indiana.

97

Section 16 Township 12 North, Range 6 East.

Date, Intermediate Corners, &c., &c.	Corners.	Stone, Mark, &c.	Acres.	Hund.	Bearings, Trees, &c.	Diam.	Courses.	Dist.
<i>Apr. - 23rd 1831</i>	N	<i>Stone</i>			<i>Hickory</i>	<i>24</i>	<i>S 31 E</i>	<i>19</i>
	H. E.	<i>"</i>			<i>Chick</i>			
<i>Calliatt Surveyor</i>	<i>"</i>	<i>"</i>			<i>Sycamore</i>	<i>6</i>	<i>N 57 W</i>	<i>4</i>
					<i>So</i>	<i>7</i>	<i>N 12 W</i>	<i>7</i>
	Z	<i>"</i>			<i>N. Elm</i>	<i>36</i>	<i>N 12 E</i>	<i>25</i>
	O.	<i>"</i>			<i>So</i>	<i>8</i>	<i>N 10 E</i>	<i>17</i>
<i>Norris Surveyor</i>					<i>So</i>	<i>10</i>	<i>N 27 W</i>	<i>17 1/2</i>
<i>Set by old writ.</i>	P				<i>Walnut</i>	<i>20</i>	<i>S 13 E</i>	<i>.35 1/2</i>
<i>Oct. 18 1892 Geo. S. Murphy S. J. C. S.</i>					<i>"</i>	<i>21</i>	<i>S 39 E</i>	<i>54</i>
<i>W. H. Juley - S. S. C. Sept. 16. 1902</i>	O	<i>"</i>			<i>Walnut stump</i>	<i>40</i>	<i>N 1/2 E</i>	<i>41</i>
					<i>Hickory Tree</i>	<i>20</i>	<i>N 12 W</i>	<i>38</i>
<i>location for</i>	C.	<i>19' E of West end of Bridge floor and</i>						
<i>3 ft S. of North edge of floor</i>		<i>Brass Bolt in concrete</i>						

Record of Surveys in Shelby County, Indiana.

103

Section *17* Township *12* North, Range *6* East.

Date, Intermediate Corners, &c., &c.	Corners.	Stone, Mark, &c.	Acres.	Hnd.	Bearings, Trees, &c.	Diam.	Courses.	Dist.
<p><i>off of the South Side</i></p> <p><i>Rock - Surveyor</i> <i>June 19th 1836</i></p> <p><i>Sargin - Surveyor</i> <i>Oct 27th 1846</i></p>	N		96		<i>Hickory</i>	22	<i>N 14 1/2 E</i>	43
	N-C				<i>Plum</i>	9	<i>N 8 7/8 W</i>	48
	L				<i>Beech</i>	10	<i>N 6 8/16 W</i>	24 1/2
	D.	Stone			<i>do</i>	24	<i>N 6 3 E</i>	24
	O.	"			<i>Walnut</i>	6	<i>S 13 E</i>	36 1/2
	M	Boulder			<i>Buckeye</i>		<i>N 3 7 W</i>	6 3/4
	W.	"			<i>No Nit</i>			
	X	"			<i>Beech</i>	10	<i>N 4 5 E</i>	9
	D	"			<i>do</i>	3	<i>S 7 2 W</i>	12
	E	"			<i>No Nit</i>			
<p><i>Norris - Surveyor</i> <i>35 2/3 Rods North of</i> <i>14 3/4 Chains East</i> <i>of last named corner.</i> <i>35 2/3 Rods North of</i></p>	Z	Stone			<i>Sycamore</i>	24	<i>N 31 W</i>	9
	W	Stone			<i>N. Elm</i>	15	<i>N 32 E</i>	47
	E	"			<i>Apple</i>	15	<i>N</i>	36
	D	"			<i>Mulberry</i>	8	<i>S 2 5 W</i>	11 1/2
	E	"			<i>2 Walnuts</i>	20	<i>N 7 5 E</i>	27
	Z	Stone			<i>Boulder</i>		<i>S 2 3 E</i>	33
	W	Stone			<i>do</i>		<i>N 3 2 W</i>	30
	E	Stone			<i>Beech</i>	30	<i>S 28 1/2 W</i>	125 1/2
	D	Stone			<i>Stone</i>		<i>S 11 E</i>	44
	W	"			<i>Beech</i>	15	<i>East</i>	19
<p><i>(28 3/4 Chains East and 35 7/8 Rods</i> <i>North of T. 3 and 14 9/2 Chns South of same</i></p>	E	Stone			<i>Stone</i>		<i>S 3 2 1/2 W</i>	26
	W	"			<i>Walnut</i>	14	<i>S 38 1/5 E</i>	69 1/2

Co. Webster
Surveyor
1836

Record of Surveys in Shelby County, Indiana.

Section 17 Township 12 North, Range 6 East.

Date, Intermediate Corners, &c., &c.	Corners.	Stone, Mark, &c.	Acres.	Hand.	Bearings, Trees, &c.	Diam.	Courses.	Dist.
15 ⁰⁶ / ₁₀₀ chains South of	P	Stone m 15			Beech	16	S 45 E	51 ¹ / ₂
16 ⁵³ / ₁₀₀ " S of the above		" "			do	16	N 85 E	38
16 ⁵³ / ₁₀₀ chains S of the above		Stone m 31			Stone		N	22 ¹ / ₂
15 ¹³ / ₁₀₀ " S of	M				do		E	22
15 ⁰⁶ / ₁₀₀ chains South of	M	Stone m 15			Stone		W	10
16 ⁵³ / ₁₀₀ chains S of the above		Stone m 17			do		S	26
Sept 16/74 Jerry Egan S S C					do		W	26
15 ⁰⁶ / ₁₀₀ chains South of	P	stone m 15			Beech	16	S 48 E	51 ¹ / ₂
15 ⁰⁶ / ₁₀₀ chains South of	M	" "			Stone	16	S 45 E	38
18 ⁷ / ₁₀₀ chains North of	W	" " 17			Walnut	10	S 44 E	60
13 ⁷⁸ / ₁₀₀ chains North of	"	" " 1			Bark	24	S 43 E	78
13 ⁷⁸ / ₁₀₀ chains North of	W	" " 6			Walnut	4	S 38 W	57
8 ⁷⁰ / ₁₀₀ chains North of	Z	" 878			Stone		South	24
13 ⁸⁶ / ₁₀₀ chains North of	"	" " 19			Beech	18	N 25	44
					do	20	S 46 ¹ / ₂ E	27 ¹ / ₂
15 ⁰⁶ / ₁₀₀ chains South of	P	Stone m 15			do	16	N 85 E	38 ¹ / ₂
					do	16	S 48 E	51 ¹ / ₂
8 ⁷⁰ / ₁₀₀ North & 8 ⁷⁰ / ₁₀₀ chains East of	Z	" " 14			Stone		South	20

J Egan Sept 8 S C
June 18th 1887

Record of Surveys in Shelby County, Indiana.

Section

Township

North, Range

East.

Date, Intermediate Corners, &c., &c.	Corners,	Stone, Mark, &c.	Acres.	Hund.	Bearings, Trees, &c.	Diam.	Courses.	Dist.
<i>Set by old wif</i>	<i>II</i>	<i>Stone</i>			<i>Walnut</i>	<i>20</i>	<i>S 13 E</i>	<i>.35 1/2</i>
<i>Oct. 18 1892 Geo. D. Murphy Dep. C. S.</i>		<i>+ L 17</i>			<i>"</i>	<i>21</i>	<i>S 39 E</i>	<i>54</i>
<i>Sep 3, 1903, W. H. Isley, S. S. O.</i>	<i>C</i>				<i>Oak Post</i>	<i>8</i>	<i>N</i>	<i>24</i>
<i>" " " " " "</i>	<i>L</i>	<i>Boulder</i>			<i>Relocated from Murphy's Witnesses above</i>			
<i>Sept 8 1913</i>	<i>X</i>						<i>Stone E. 22 1/2</i>	
							<i>Stone W 22 1/2</i>	

Record of Surveys in Shelby County, Indiana.

Section 18 Township 12 North, Range C East.

Date, Intermediate Corners, &c., &c.	Corners.	Stone, Mark, &c.	Acres.	Dist.	Bearings, Trees, &c.	Diam.	Courses.	Dist.
<p><i>Rock Surveyor</i></p> <p>June 16th 1865</p> <p><i>Keape Surveyor</i></p> <p>Nov 10th 1837</p>	M				Beech	12	N	15'
	N	Stone			do	9	N 65° E	27'
	O				Walkey	8	E	23
	B				N. Beech	4	N	11
	W				Bugay	16	N	4
<p><i>Sargin Surveyor</i></p> <p>April 8th 1892.</p>	H				Beech	17	N 75° E	29
	G				No Nit			
	X	Perpetuated			Beech	16	N	26
	X				do	18	N 77° E	30
	X				No Nit			
<p><i>T. S. Finley, C. S. S. C.</i></p> <p>I measured from X and W. 24.77 and 24.30. resp. North finding whole length of East and West lines of N & S E. gr. West. 40.43. E. 40.12.</p> <p><i>Plu last word is Error should be X</i></p> <p>Dec. 12, 1902. I set stones and posts as follows:</p>	X				Grey boulder large		S 58° E.	18 5/8 ft.
	X				Blue flinty "		N. 6 1/2° E.	18 1/2 ft.
	N	Post			Stone		West	24.
	N	Post			Forked White Elm	14	S 25° E	30 1/3.
	O	stone Marked +			Stone		West	24.
	O				Stone		East	16 2/3.
	O				Elm	10	S 85° E	22 2/4.
	O				Red Oak	10"	N 15° E	68.
	O				(over)			
	O							

Section 18 Township 12 North, Range 6 East.

Date, Intermediate Corners, &c., &c.	Corners.	Stone, Mark, &c.	Acres.	Hund.	Bearings, Trees, &c.	Diam.	Courses.	Dist.
18 ⁷³ / ₁₀₀ Chains North of W. H. Isley, Sur. S. C.	O	stone marked +			Stone		East	18

Record of Surveys in Shelby County, Indiana.

115

Section *19* Township *12* North, Range *6* East.

Date, Intermediate Corners, &c., &c.	Corners.	Stone, Mark, &c.	Acres.	Hund.	Bearings, Trees, &c.	Diam.	Courses.	Dist.
<p><i>Calliatt Surveyor</i> <i>1837 Sargis</i> "</p>	<p><i>M</i> <i>N</i> <i>W</i> <i>P.E.C.</i></p>	<p><i>Boulder</i> <i>stones</i></p>			<p><i>Beech</i> <i>do</i> <i>No Nit</i> <i>Beech</i> <i>Mulberry</i> <i>No Nit</i></p>	<p><i>30</i> <i>14</i> <i>24</i> <i>8</i></p>	<p><i>S 44 E</i> <i>N 13 E</i> <i>N 11 1/2 W</i> <i>N 39 W</i></p>	<p><i>36</i> <i>63</i> <i>21</i> <i>16</i></p>
<p><i>June 30-1916 relocated and</i> <i>Set Stone</i> <i>S P Harris county Surveyor</i></p>	<p><i>L</i></p>	<p><i>Limestone</i></p>			<p><i>No wit</i></p>		<p><i>ancher post NW</i></p>	<p><i>33 1/2 lines</i></p>

Record of Surveys in Shelby County, Indiana.

181

Section *20* Township *12* North, Range *6* East.

Date, Intermediate Corners, &c., &c.	Corners.	Stone, Mark, &c.	Acres.	Hund.	Bearings, Trees, &c.	Diam.	Courses.	Dist.
<i>Mar 14th 1851</i>	O				<i>Cherry</i>	<i>20</i>	<i>S 21 N</i>	<i>39</i>
	F				<i>R-Road</i>	<i>3'</i>	<i>N 16 N</i>	<i>3 1/2</i>
					<i>Beech</i>	<i>9</i>	<i>S 37 N</i>	<i>7 1/2</i>
					<i>do</i>	<i>14</i>	<i>N 16 E</i>	<i>2 1/2</i>
<i>J. M. Calliatt Surveyor Apr 5th 1867 Kerriss - Surveyor see Bond 1864</i>	H	<i>Stone</i>			<i>No Nit</i>			
	V	<i>V " Z</i>			<i>No Nit</i>			
	W	<i>" W</i>			<i>No Nit</i>			
	M	<i>"</i>			<i>Sugar</i>	<i>30</i>	<i>N 21 E</i>	<i>18</i>
<i>43. R. C. of Keop, Surveyor Sept 10th 1874 Dugan s s e</i>	T	<i>"</i>			<i>Buckeye</i>	<i>8'</i>	<i>S 37 E</i>	<i>19 1/2</i>
	S	<i>" 20</i>			<i>elm</i>	<i>4</i>	<i>N 15 E</i>	<i>10</i>
	N	<i>"</i>			<i>Maple</i>	<i>10</i>	<i>S 30 E</i>	<i>6 1/2</i>
	O	<i>Stone</i>	<i>o</i>		<i>Stone</i>		<i>S</i>	<i>27 1/2</i>
<i>May 25th 1883</i>	E	<i>Stone</i>	<i>f</i>		<i>do</i>		<i>S 60 E</i>	<i>46</i>
	F	<i>"</i>			<i>beech</i>	<i>16</i>	<i>N 19 1/2 W</i>	<i>90 1/2</i>
	F	<i>"</i>			<i>"</i>	<i>20</i>	<i>N 75 3/4 W</i>	<i>85</i>
	G	<i>"</i>			<i>Walnut</i>	<i>8</i>	<i>S 42 E</i>	<i>42</i>
<i>Geo. S. Murphy S.S.C</i>	H	<i>"</i>			<i>Beech</i>	<i>24</i>	<i>N 19 E</i>	<i>68</i>
	H	<i>"</i>			<i>No wit</i>		<i>" "</i>	

Record of Surveys in Shelby County, Indiana.

Section 20.

Township 12.

North, Range 6.

East.

Date, Intermediate Corners, &c., &c.	Corners.	Stone, Mark, &c.	Acres.	Hund.	Bearings, Trees, &c.	Diam.	Courses.	Dist.
<p>July 10. - 1895.</p> <p>chs. North of Survey for Barlow Girls and Andrew Feigler.</p>	<p>V W W</p>	<p>Boulder Stone Boulder</p>	<p>Set by original Wt. No Set. 40 Wt. cor.</p>					
<p>June 3rd 1901 M. F. Crawford</p>	<p>N</p>	<p>Large Boulder.</p>	<p>2 feet long</p>			<p>No</p>	<p>Witness</p>	
<p>Sept 8 1913</p>	<p>C</p>						<p>Stone E. 22 1/2" " " W. 22 1/2"</p>	

Record of Surveys in Shelby County, Indiana.

Section *21* Township *12* North, Range *6* East.

Date, Intermediate Corners, &c., &c.	Corners.	Stone, Mark, &c.	Acres.	Hund.	Bearings, Trees, &c.	Diam.	Courses.	Dist.
<i>Mar 23rd 1847^c</i>	<i>N</i>	<i>Stone</i>			<i>Beech</i>	<i>10</i>	<i>N 38¹/₂ E</i>	<i>32¹/₂</i>
					<i>do</i>	<i>14</i>	<i>N 65¹/₂ W</i>	<i>27¹/₂</i>
		<i>E</i>	<i>"</i>		<i>No Tit</i>			
		<i>D</i>	<i>"</i>		<i>Beech</i>	<i>18</i>	<i>N 79¹/₂ E</i>	<i>32¹/₂</i>
<i>Rock-Surveyor</i>					<i>do</i>	<i>24</i>	<i>S 57¹/₂ W</i>	<i>29¹/₂</i>
		<i>O</i>	<i>"</i>		<i>B-Oak</i>	<i>30</i>	<i>S 23¹/₂ E</i>	<i>10</i>
					<i>do</i>	<i>14</i>	<i>N 39¹/₂ W</i>	<i>20¹/₂</i>
<i>Mar 23rd 1850^c</i>	<i>X</i>	<i>Boulder</i>			<i>Beech</i>	<i>18</i>	<i>N 78¹/₂ W</i>	<i>5</i>
<i>Calliatt-Surveyor</i>					<i>do</i>	<i>13</i>	<i>S 61¹/₂ E</i>	<i>33</i>
<i>July 29th 1861 } 39 R 17 Q S of</i>	<i>C</i>	<i>Stone</i>			<i>Chm Locust</i>	<i>11</i>	<i>N 43¹/₂ E</i>	<i>8¹/₂</i>
	<i>A</i>	<i>"</i>			<i>Beech</i>	<i>19</i>	<i>N 40¹/₂ E</i>	<i>29</i>
<i>44⁷/₈ R. S. of above</i>					<i>do</i>	<i>14</i>	<i>N 64¹/₂ W</i>	<i>30</i>
		<i>Boulder</i>			<i>do</i>	<i>20</i>	<i>N 37¹/₂ W</i>	<i>6</i>
		<i>"</i>			<i>do</i>	<i>16</i>	<i>N 41¹/₂ W</i>	<i>33¹/₂</i>
<i>Corriss-Surveyor</i>	<i>C</i>				<i>B-Oak</i>	<i>36</i>	<i>S 33¹/₂ E</i>	<i>23</i>

Record of Surveys in Shelby County, Indiana.

Section *22* Township *12* North, Range *6* East.

Date, Intermediate Corners, &c., &c.	Corners.	Stone, Mark, &c.	Acres.	Hand.	Bearings, Trees, &c.	Diam.	Courses.	Dist.
<i>Apr 12th 1850 - var ^{87 ft} 5¹/₂ 35</i>	<i>L</i> <i>N</i> <i>D</i>	<i>Stone</i>			<i>Beech</i>	<i>8</i>	<i>S 5 3/4 N</i>	<i>30</i>
<i>Sept 22nd 1851 -</i>	<i>N</i> <i>D</i>	<i>"</i>			<i>Ash</i>	<i>3</i>	<i>N 60 W</i>	<i>26</i>
<i>Edliatt - Sumner</i>		<i>Boulder</i>			<i>Sugar</i>	<i>16</i>	<i>N 38 E</i>	<i>4 3/4</i>
<i>May 27th 1856 -</i>	<i>Z</i> <i>Y</i>	<i>Stone</i>			<i>Beech</i>	<i>20</i>	<i>N 73 E</i>	<i>50</i>
<i>Sargin - Sumner</i>		<i>"</i>			<i>No Nit</i>			
		<i>Stone</i>			<i>Beech</i>	<i>18</i>	<i>N 88 E</i>	<i>29</i>
		<i>"</i>			<i>Walnut</i>	<i>8</i>	<i>N 8 N</i>	<i>26</i>
<i>Mar 30th 1869 -</i>	<i>L</i> <i>M</i> <i>V</i> <i>W</i>	<i>Boulder</i>			<i>Fieldgate</i>			
		<i>"</i>			<i>N-Oak</i>	<i>36</i>	<i>N 35 E</i>	<i>32</i>
		<i>"</i>			<i>Beech</i>	<i>12</i>	<i>N 49 E</i>	<i>33</i>
<i>H. K. Miller - Sumner</i>	<i>W</i>	<i>"</i>			<i>N-Oak</i>	<i>30</i>	<i>N 41 W</i>	<i>24</i>
<i>Partition of Ed Miller Est,</i>	<i>C</i> <i>F</i>	<i>Stone</i>			<i>Walnut</i>	<i>15</i>	<i>S E</i>	<i>3</i>
		<i>Stake</i>			<i>Beech</i>	<i>20</i>	<i>S N</i>	<i>25</i>
		<i>"</i>			<i>Heickory</i>	<i>15</i>	<i>N N</i>	<i>25 1/2</i>
		<i>"</i>			<i>Beech</i>	<i>18</i>	<i>N 49 W</i>	<i>40 1/2</i>
	<i>N</i> <i>P</i>	<i>Long Boulder</i>			<i>Lime Stone</i>		<i>N 5 1/2 E</i>	<i>22 1/2</i>
		<i>Boulder</i>			<i>R-Oak</i>	<i>30</i>	<i>N E</i>	<i>22</i>

G. F. Webster
Sumner, S. C.

Record of Surveys in Shelby County, Indiana.

139

Section *23* Township *12* North, Range *6* East.

Date, Intermediate Corners, &c., &c.	Corners.	Stone, Mark &c.	Acres.	Hund.	Bearings, Trees, &c.	Diam.	Courses.	Dist.
	N				Beech	10	8	8
					do	8	N 20 E	18
	D				Hickory	8	8 10 N	10
					Beech	12	8 6 E	20
	O				do	10	N 22 E	13
					H-Oak	36	E	32
	F				Hickory	12	8	30
					Beech	8	8	50
	G				Ch Nit			
	H	Stone			H-Halnut	60	N 27 N	8
<i>Gargis - Surveyor</i> <i>Mar 30th 1869</i>					Beech	10	N 20 E	19
	Y	Boulder			Stone		N	30 1/2
	O	"			Oak	24	N 5 1/2 N	8 1/2
<i>Miller - Surveyor</i> <i>9 1/2 chs South of</i>	B	Long Pine Stone			Stone		N 2 1/2 E	74
<i>9 1/2 " South of</i>	C	Pine Stone 20.			do		East	100.
<i>Chas F. Webster, Surveyor,</i>								
	R	Stone on R 23			B oak	20	S 32 E	63
					Stone		N	27
	N	Stone on N			Sweet Gum	15	S 25 E	33
					Dash	18	N 69 E	30
	S	Stone on S 23			B Walnut	2	N 72 1/2 N	35
<i>Jerry Dugan Surveyor</i>	H	Stone on H 23			Stone		S 39 N	65

Section *L 3* Township *12* North, Range *16* East.

Date, Intermediate Corners, &c., &c.	Corners.	Stone, Mark, &c.	Acres.	Hund.	Bearings, Trees, &c.	Diam.	Courses.	Dist.
<i>I Susan 236 Aug 13th 1877</i>	B	<i>Stone Ink B</i>			<i>Stone</i>		<i>S 45 1/2 E</i>	<i>46</i>
	I	<i>Stone</i>			<i>no wit</i>			
<i>35 Rods South + 7 1/2 Chain West</i>	K	<i>"</i>			<i>"</i>			
<i>70 Rods South + 7.22 Chain West</i>	M	<i>Stone</i>			<i>H oak</i>	<i>24</i>	<i>N 32 1/2 W</i>	<i>72</i>
<i>35 Rods S of</i>	N	<i>"</i>			<i>Beach</i>	<i>18</i>	<i>N 11 1/2 W</i>	<i>89</i>
<i>70 Rods South of</i>	N	<i>"</i>			<i>no wit</i>			
<i>March 7th 1881</i>	N	<i>"</i>			<i>no wit</i>			
<i>54 Rods South of</i>	K	<i>Lime Stone marked</i>						
	L	<i>Sand "</i>	<i>"</i>		<i>2 Stones</i>		<i>S 62 E</i>	<i>57.</i>
<i>C. P. Webster Surveyor</i>	M	<i>Lime "</i>	<i>" 54</i>		<i>Burr Oak</i>	<i>40</i>	<i>S 81 W</i>	<i>98</i>
	M	<i>"</i>			<i>H Oak</i>	<i>18</i>	<i>N 10 E</i>	<i>122 1/3</i>
<i>54 Rods S of</i>	II	<i>Lime "</i>	<i>" 54</i>		<i>Oak</i>	<i>24</i>	<i>S 11 3/4 E</i>	<i>57 3/4</i>
	Q	<i>"</i>			<i>Beech</i>	<i>15</i>	<i>N 6 W</i>	<i>19 3/4</i>
	Q	<i>"</i>			<i>stone</i>		<i>East</i>	
<i>John W. Whitlock</i>	L	<i>P.K. Nail</i>			<i>See Tie file</i>		<i>{ See Remarks</i> <i>{ page 228</i>	
<i>"</i>	V	<i>Rd. Nail</i>			<i>"</i>			

Record of Surveys in Shelby County, Indiana.

Section **24** Township **12** North, Range **6** East.

Date, Intermediate Corners, &c., &c.	Corners.	Stone, Mark, &c.	Acres.	Hund.	Bearings, Trees, &c.	Diam.	Courses.	Dist.
<i>Nov 6th 1833</i>	U				Elm	10	S 10 E	19
	T				B-Oak	14	N 74 W	24
	W.				Beech	14	N 18 E	18
	O	x			do	12	S 28 E	28
	Y				do	20	N 82 E	4
	R				do	14	S 20 W	26
	N				do	12	S 27 W	22
	V				do	8	N 36 E	18
	Q				do	6	N 34 E	13
	M				N-do	4	S 10 E	17
	I				do Nit			
	K				Sugar	8	N 80 W	9
	D.	H.	Stones		Beech	24	N 32 W	37
	<i>Nov 10th 1837</i> <i>Garvin - Sumner</i>	E.	Stones		do Nit			
F.		Stones		Sugar	20	N 30 E	4	
G.		Stones		Beech	5	S 47 W	20	
H.		Stones		do	8	N 32 W	14	
	I.	Stones		Walckony	10	S 64 W	11	
	J.	Stones		Beech	18	S 44 E	23	
	K.	Stones		do	12	S 73 W	23	
	L.	Stones		do Nit				

Section 24

Township 12

North, Range 6

East.

Date, Intermediate Corners, &c., &c.	Corners.	Stone, Mark, &c.	Acres.	Hund.	Bearings, Trees, &c.	Diam.	Courses.	Dist.
John W. Whitlock	P	P.R. Nail			See Tie File		See Remarks	
"	Z	Rd. Nail			"		page 228	
"	M	Iron Pin			"		"	
"	L	R.R. Spike			"		"	

Record of Surveys in Shelby County, Indiana.

151

Section *Q 3¹* Township *12* North, Range *6* East.

Date, Intermediate Corners, &c., &c.	Corners.	Stone, Mark, &c.	Acres.	Hund.	Bearings, Trees, &c.	Diam.	Courses.	Dist.
	<i>T</i>	<i>Stone</i>			<i>Beech</i>	<i>8</i>	<i>N 30 E</i>	<i>11</i>
					<i>so</i>	<i>6</i>	<i>S 30 W</i>	<i>14</i>
	<i>I</i>	<i>"</i>			<i>Hickory</i>	<i>18</i>	<i>N 34 E</i>	<i>23</i>
					<i>S-Ash</i>	<i>10</i>	<i>S 30 W</i>	<i>34</i>
	<i>R</i>	<i>"</i>			<i>elm</i>	<i>18</i>	<i>N 38 E</i>	<i>18</i>
					<i>Sugar</i>	<i>8</i>	<i>S 35 E</i>	<i>34</i>
	<i>U</i>	<i>"</i>			<i>Beech</i>	<i>18</i>	<i>N 32 W</i>	<i>3</i>
					<i>so</i>	<i>18</i>	<i>S 20 E</i>	<i>42</i>
	<i>P. O</i>	<i>"</i>			<i>No Nit.</i>			
	<i>M</i>	<i>"</i>			<i>"</i>			
	<i>Y</i>	<i>"</i>			<i>Ash</i>	<i>3</i>	<i>S 44 E</i>	<i>13</i>
					<i>Beech</i>	<i>14</i>	<i>S 83 W</i>	<i>24</i>
	<i>N</i>	<i>"</i>			<i>so</i>	<i>12</i>	<i>S 56 E</i>	<i>19</i>
					<i>S-Ash</i>	<i>18</i>	<i>N 85 E</i>	<i>19</i>
	<i>T</i>	<i>"</i>			<i>Sugar</i>	<i>14</i>	<i>S 76 W</i>	<i>7</i>
					<i>Beech</i>	<i>10</i>	<i>S 32 W</i>	<i>14</i>
	<i>F</i>	<i>"</i>			<i>Ash</i>	<i>4</i>	<i>S 75 W</i>	<i>3</i>
					<i>so</i>	<i>8</i>	<i>N 22 E</i>	<i>18</i>
	<i>G</i>	<i>"</i>			<i>elm</i>	<i>48</i>	<i>S 55 W</i>	<i>25</i>
	<i>S. L</i>	<i>"</i>			<i>No Nit</i>			
	<i>K. A</i>	<i>"</i>			<i>"</i>			
	<i>E. B</i>	<i>"</i>			<i>"</i>			

*Margin - Surveyor
Nov 28th 1868*

Ed. Mitchell - Surveyor

Record of Surveys in Shelby County, Indiana.

153

Section *29*

Township

12

North, Range

6

East.

Date, Intermediate Corners, &c., &c.	Corners.	Stone, Mark, &c.	Acres.	Hund.	Bearings, Trees, &c.	Diam.	Courses.	Dist.
set Stone 10 chns W of	O	L Stone x						
" " 10 chns W "	Y	Sand Stone +						
" " 20.0 chns S "	O	Sand Stone +						
" " 10 chns W + 20.0 chns S of	O	L Stone +						
Sept 20-1904 S. P. Harris S. S. C.	Survey made for J. G. Duprez John Scheffler + Charles Ray							
June 10 1903 10.18 1/2 chns N of 10.9 1/2 chns N of S. P. Harris S. S. C.	V W	Stone M x Stone m x Stone m x			No wit No wit No wit			
John W. Whitlock	E	Red Nail			See Tie File } See Remarks pg. 228			

Section 26

Township 12

North, Range 6

East.

Date, Intermediate Corners, &c., &c.	Corners.	Stone, Mark, &c.	Acres.	Bound.	Bearings, Trees, &c.	Diam.	Courses.	Dist.
26 Rods South of 338 Chms East of	M	Boulder			Stone		S 38 ¹ / ₂ E	50
				At the Cor of House			S 37 ¹ / ₂ W	
338 Chms East of	W	Sand Stone			White Oak		N 12 ¹ / ₂ E	76 ¹ / ₂
					Red Oak		N 38 ¹ / ₂ W	73
44 Rods West and 26 Rods South of	M	Along ³ / ₄ line Boulder			Large Stone		N 3 ¹ / ₂ W	40
C. F. Webster Surveyor.								
6 Chains S of	P	Stone m 24			B Walnut	12	N 26 ¹ / ₂ W	75 ¹ / ₂
1166 ² / ₃ " East of	"	" " 47			Limestone		S 2 E	40
6 " South of the above	"	" " 24			"		North	25
See 6 th 1873 Jerry Cogan SS 6 Jan 26-1909								
Survey made for Wm Geigler & Melvin Collins by mutual agreement								
2 links north of	H	sand stone [*]			Stone		South	7
4 links north of	O	Lime stone [*]			Lime stone		West	22
Samuel P Harris Surveyor Shelby County								
John W. Whitlock	A	Rd. Nail			See Tie File		See Remarks pg. 228	

Section *27* Township *12* North, Range *6* East.

Date, Intermediate Corners, &c., &c.	Corners.	Stone, Mark, &c.	Acres.	Bound.	Bearings, Trees, &c.	Diam.	Courses.	Dist.
	<i>H</i>	<i>Stone</i>			<i>Hickory</i>	<i>9</i>	<i>S 7 N.</i>	<i>12 1/2</i>
					<i>Beech</i>	<i>14</i>	<i>S 7 1/2 E</i>	<i>22 1/2</i>
	<i>M</i>	<i>"</i>			<i>Oak</i>	<i>12</i>	<i>N 25 1/2 N</i>	<i>18 3/4</i>
					<i>So</i>	<i>16</i>	<i>N 7 1/2 N</i>	<i>10</i>
	<i>I</i>	<i>"</i>			<i>Ash</i>	<i>12</i>	<i>N 46 1/2 E</i>	<i>26 1/4</i>
					<i>So</i>	<i>4</i>	<i>S 21 1/2 N</i>	<i>12 1/2</i>
	<i>B</i>	<i>"</i>			<i>Hickory</i>	<i>4</i>	<i>S 15 E</i>	<i>18 3/4</i>
					<i>Beech</i>	<i>16</i>	<i>S 79 1/2 E</i>	<i>27 1/2</i>
<i>Rock - Sumner</i>	<i>K</i>	<i>"</i>			<i>So</i>	<i>12</i>	<i>N 3 1/2 E</i>	<i>39 1/4</i>
<i>Oct 3rd 1851 - Var 5 & 45</i>					<i>So</i>	<i>6</i>	<i>S 46 E</i>	<i>2 1/2</i>
	<i>E</i>	<i>"</i>			<i>Oak</i>	<i>24</i>	<i>N 22 N</i>	<i>63</i>
					<i>So</i>	<i>16</i>	<i>N 42 1/2 N</i>	<i>137</i>
	<i>O</i>	<i>"</i>			<i>Hickory</i>	<i>14</i>	<i>N 2 N</i>	<i>59</i>
					<i>S - ash</i>	<i>24</i>	<i>S 6 E</i>	<i>7 1/2</i>
<i>Calliatt - Sumner</i>	<i>P</i>	<i>"</i>			<i>Oak</i>	<i>36</i>	<i>S 84 E</i>	<i>83</i>
<i>Miller - "</i>					<i>Cherry</i>	<i>4</i>	<i>S 62 N</i>	<i>37</i>
<i>Survey for John Kennell</i>								
<i>N of Newcomb et al.</i>	<i>N</i>	<i>Stone</i>						
<i>L to N = 39 7/4 Chas.</i>								
<i>Smithland in Cross Roads.</i>	<i>M</i>	<i>is 5 links East of half of L to N. - old stake</i>						
<i>By agreement Set stake for fence Post 2 1/2 Links West of old stake and</i>								
<i>22 1/2 links North of S E Cor of San Hawkins 1/2 acre lot.</i>								
<i>L to A = 40 25 Chas.</i>	<i>K</i>	<i>Stake, no rock</i>						

(over)

Record of Surveys in Shelby County, Indiana.

Section 27

Township 12

North, Range 6

East.

Date, Intermediate Corners, &c., &c.	Corners.	Stone, Mark, &c.	Acres.	Hund.	Bearings, Trees, &c.	Diam.	Courses.	Dist.
Survey for Jm. Harrell et al B to M = 40.36 Chms. A to H = 20.20 1/2 Ch.	H	Stake in old fence line						
Sept. 1924 wit. for + on culv. head wall	N	+ SW 25 11' + NW. 40 11'			G. F. Webster Surveyor, etc			

Record of Surveys in Shelby County, Indiana.

Section *27* Township *12* North, Range *6* East.

Date, Intermediate Corners, &c., &c.	Corners.	Stone, Mark, &c.	Acres.	Hund.	Bearings, Trees, &c.	Diam.	Courses.	Dist.
	W	<i>Boulder</i> ²⁸			<i>No Nit</i>			
	N	"			<i>Red Oak</i>	<i>25</i>	<i>cr 30 N</i>	<i>40</i>
<i>14th 1868</i>	<i>of same</i>	"			<i>Hickory</i>	<i>30</i>	<i>cr 45 E</i>	<i>3</i>
	S	"			<i>Beech</i>		<i>cr 38 E</i>	<i>2 1/2</i>
<i>9th 1877</i>	<i>of same</i>	"			<i>B. Walnut</i>	<i>10</i>	<i>S 87 E</i>	<i>97</i>
	O	"			<i>W. Ash</i>	<i>13</i>	<i>cr 89 E</i>	<i>14 1/2</i>
	M	"			<i>B. Walnut</i>	<i>12</i>	<i>E</i>	<i>40</i>
<i>14th 1868</i>	<i>of same</i>	"			<i>Beech</i>	<i>10</i>	<i>S 15 E</i>	<i>14 1/2</i>
	R	" <i>28</i>			<i>No Nit</i>			
<i>Miller-Symyer</i>	X	" <i>28</i>			"			
<i>Jerry Dugan ssc</i>	D	"			<i>Beech</i>	<i>24</i>	<i>West</i>	<i>6 1/2</i>
<i>Aug 27th 1884</i>								
<i>March 8.70</i>	8	"			<i>Oak</i>	<i>30</i>	<i>S 12 1/2 W</i>	<i>5 6 1/2</i>
<i>West 9.32</i>	"	"						
<i>Murphy surveyor</i>								
<i>Apr 24th, 1905; M^{rs} Fern Est.</i>	S	<i>Stake</i>			<i>No witness</i>			
<i>39 rods, & 15 ft. west of</i>								
<i>James E. Norris,</i>		<i>S. C. Surveyor,</i>						

Record of Surveys in Shelby County, Indiana.

175

Section *29* Township *12* North, Range *6* East.

Date, Intermediate Corners, &c., &c.	Corners.	Stone, Mark, &c.	Acres.	Hurd.	Bearings, Trees, &c.	Diam.	Courses.	Dist.
	W	Stone			Sugar	3'	N 8° E	17
					Oak	15'	N 65 1/2° E	24 1/2
	M	"			Sycamore	36'	N 38 1/2° E	33 1/2
					Elm	25'	N 41 1/2° E	43
	N	"			Ash	14'	N 42 1/2° E	7
					do	12'	N 48° E	17
	D	"			Beech	30'	N 32° E	32
					Sugar	10'	N 8° W	46
	G	"			Box Elder	11'	N 33° W	13
					Elm	15'	N 73 1/2° E	40 1/4
	V				No Nit			
	L	& "			N-chates			
	H	"			Ash	12'	N 60° W	29
<p>See 21st 1866 c 33' Links East of Rock Surveyor</p>					Sycamore	15'	N 20° E	40
	O	Greyhead	0		Ash	14'	N 80 1/2° E	35
					Maple	10'	N 12° E	37
<p>1845 Chains N of</p>	O	Stone m 29			Elm	11'	N 16° E	21
					do	16'	N 59 1/2° W	8
	N	stone m N			stone marked with		N 52° E	52 links
	H	" m H			ash	15'	N 88 1/2° W	77
<p>May 9th 1881 Chas. Webster S. & Co. Jery Segan Deputy Surveyor</p>	W	" m W + B			Buck eye	12'	N 52 1/2° E	38
	W	" " W + B			Hick	24'	N 74 1/2° E	
					" "	36'	N 83° E	70 1/2

Record of Surveys in Shelby County, Indiana.

177

Section

Township

North, Range

East.

Date, Intermediate Corners, &c., &c.	Corners.	Stone, Mark, &c.	Acres.	Inud.	Bearings, Trees, &c.	Diam.	Courses.	Dist.
<p>May 17. & 18. 1909. I made survey & set stones as follows:</p>	<p>G O</p>	<p>Limestone concrete post Pebble in Top</p>			<p>Black Walnut Elm</p>	<p>8 30</p>	<p>North N 13° E</p>	<p>49 ¹/₄ 74 ³/₄</p>
<p>14" chains S. of O</p>	<p>N O</p>	<p>Concrete Mound with Iron Bolt in Top, concret mound Stake in Top</p>			<p>Gray Ash</p>	<p>3</p>	<p>N. 70° W.</p>	<p>16.</p>
<p>14" chains S & 7⁵/₆ chains E. of</p>	<p>M</p>	<p>Stone</p>			<p>No witness available.</p>			
					<p>Thorn</p>	<p>14</p>	<p>N. 25° 40' W.</p>	<p>15 ¹/₃</p>
					<p>"</p>	<p>10</p>	<p>S. 54° 15' W</p>	<p>14 ¹/₃</p>
					<p>Stone</p>		<p>North</p>	<p>11</p>

Record of Surveys in Shelby County, Indiana.

Section *30* Township *12* North, Range *6* East.

Date, Intermediate Corners, &c., &c.	Corners.	Stone, Mark, &c.	Acres.	Hund.	Bearings, Trees, &c.	Diam.	Courses.	Dist.
<i>Nickals - Sumner</i>	P	Stone			No Nit			
	M	"			Beech	24	N 68 E	3
	W	"			B- Gum	30	N	32
	N	"			B-Oak	14	N 7 E	24
	O	"			Ash	14	N	14
<i>Dargin - Sumner</i> <i>Mar 25th 1831</i>	N	"			So.	12	N 81 N	10
	O	"			Hickory	14	N 36 N	21
	D	"			Beech	18	N 63 E	4
	Y	"			Coconut	20	N 84 E	3
	C	"			Elm	38	N 13 E	15
<i>Calliatt - Sumner</i> <i>1828</i> Chains North of	D	"			N-ash	10	N 92 N	30
	Y	"			Ash	5	N 88 N	12
	N		Greyhead 30		Sugar	14	N 57 E	23
	C		limestone C		Stone on mt		N 23 E	25
	B		Stone B		Stone		East	23
<i>1879</i>	B				Do on mt		West	17
	A				B Locust	3	N 10 E	14
	O				Stone		East	
	V		" AEW		See field notes			
	L		" O		Stone		N 49 N	30 1/2
<i>Chas F. Webster S.S.C.</i> <i>Worshedle 4th 20'</i>	V				Nut	6	N 19 E	30
	L		La. 30.		Two So	8	N 78 N	48
	L				Elm	10	N 37 1/2 N	76 3/4
					Stone		N 42 1/2 N	11

Section *30* Township *12* North, Range *6* East.

Date, Intermediate Corners, &c., &c.	Corners.	Stone, Mark, &c.	Acres.	Hund.	Bearings, Trees, &c.	Diam.	Courses.	Dist.
<i>10 1/2 Chms South of</i>	<i>E</i>	<i>Stone</i>			<i>no nit</i>			
<i>21 7/10 Chms South of</i>	<i>E</i>	<i>Stone</i>			<i>"</i>			
<i>9 Chms South of</i>	<i>C</i>	<i>Stone</i>			<i>"</i>			
<i>17 9/5 Chms South of</i>	<i>C</i>							
<i>Co. B. Webster Survey &c.</i>								
<i>9 3/4 Chms S 15 1/2 W from</i>	<i>D</i>	<i>Stone</i>	<i>Set</i>	<i>in line with</i>	<i>Telegraph Poles</i>			
<i>10 5/2 Chms S 15 1/2 W from</i>	<i>Same</i>	<i>Stone</i>	<i>"</i>	<i>"</i>	<i>"</i>		<i>"</i>	
<i>18 8/4 Chms S 15 1/2 W "</i>	<i>Same</i>	<i>"</i>	<i>"</i>	<i>"</i>	<i>"</i>		<i>"</i>	
<i>21 7/5 Chms S 15 1/2 W "</i>	<i>Same</i>	<i>"</i>	<i>"</i>	<i>"</i>	<i>"</i>		<i>"</i>	
<i>In the Partition of the McKinney land, Co. B. Webster S. Co.</i>								
<i>The above Record belongs in Book for Sec 30 T 12 R 7 E.</i>								
<i>July 7th 1879.</i>	<i>O</i>	<i>Stone</i>			<i>Stone</i>		<i>S 60 1/2 E</i>	<i>25 1/2</i>
					<i>do</i>		<i>N 34 1/2 W</i>	<i>37</i>
					<i>Jugans Corner Stone</i>		<i>with</i>	<i>8</i>
	<i>Q</i>	<i>Stone</i>			<i>Sycamore</i>	<i>6</i>	<i>S 71 1/2 W</i>	<i>13</i>
					<i>Beech</i>	<i>10</i>	<i>S 68 E</i>	<i>18</i>
<i>4 8/1 Chms South of</i>	<i>Q</i>	<i>Stone</i>			<i>Elm</i>	<i>15</i>	<i>S 39 1/2 E</i>	<i>17</i>
					<i>Sash</i>	<i>12</i>	<i>N 32 1/2 E</i>	<i>29</i>
	<i>1/2 P to Q</i>	<i>Stake</i>			<i>Beech</i>	<i>15</i>	<i>N 49 E</i>	<i>51</i>
					<i>do</i>	<i>15</i>	<i>S 6 E</i>	<i>49</i>
	<i>R</i>	<i>Boulder</i>			<i>Stone</i>		<i>N 71 3/4 W</i>	<i>20 1/4</i>
					<i>do</i>		<i>N 68 E</i>	<i>27 3/4</i>
	<i>1/2 R to C</i>	<i>"</i>			<i>do</i>		<i>N 51 1/2 E</i>	<i>33</i>
					<i>Hayden</i>	<i>15</i>	<i>N 31 1/2 W</i>	<i>10 5/2</i>

should be 30-12-7

Record of Surveys in Shelby County, Indiana.

183

Section 30

Township 12

North, Range 6

East.

Date, Intermediate Corners, &c., &c.	Corners.	Stone, Mark, &c.	Acres.	Hund.	Bearings, Trees, &c.	Diam.	Courses.	Dist.
9.72 chains south of	P	stone			stone	10	N 86 1/2 E	28
9.72 chains south of	O"	stone			Iron Wood	8	N 7° W	25
From Hackberry, Gov't wit found Relocated	A N	Boulder			Stone 1 set. Large Limestone	10	S 86 1/2 W	22
		"			Boulder	12	Due East	15/100
Apr 40, 1901. W. H. Isley, Deputy Surveyor, S.C.,					Boulder	6	N 30° 40' W	4 3 1/2
Dec. 8, 1902 Set Stones as follows					" "	6	N. 41° 30' E	4 4 7/10
5 chains West of	O	Boulder Marked +			Small Boulder		N. 45° W.	35
2 chains North of	O	Boulder Marked +			" "		S. 45° E.	18
2 chains North of 5 chains West of	O	Boulder Marked +			Boulder		East	22 3/4
					"		North	22 3/4
					"		South	18
W. H. Isley, Surveyor Shelby County								
April 19 - 1912 Set Stone 24.31 1/4 ch. S. of O. marked + no wit.								
Set Stone 24.34 1/4 ch. Set P. Stone marked + Stone marked + S 12 3/4								
Geo. E. Altman S, S, C. Above is dividing line bet. C. J. & Thomas Chappelow.								

Section 30 Township 12 North, Range 6 East.

Date, Intermediate Corners, &c., &c.	Corners.	Stone, Mark, &c.	Acres.	Hud.	Bearings, Trees, &c.	Diam.	Courses.	Dist.
4 1/2 chms South of	R	Large Boulder C. F. Webster Survey, S. 6.						

Record of Surveys in Shelby County, Indiana.

187

Section *B1*

Township *12*

North, Range *6*

East.

Date, Intermediate Corners, &c., &c.	Corners.	Stone, Mark, &c.	Acres.	Land.	Bearings, Trees, &c.	Diam.	Courses.	Dist.
<i>June 5th 1846</i>	X	<i>Stone</i>			<i>hackberry</i>	<i>24</i>	<i>N 3 1/2 E</i>	<i>41</i>
	V	<i>L-Boulders</i>			<i>Sugar</i>	<i>36</i>	<i>N 42 1/2 W</i>	<i>66 1/2</i>
		<i>"</i>			<i>B-Oak</i>	<i>36</i>	<i>N 8 1/2 E</i>	<i>21</i>
		<i>"</i>			<i>Buckeye</i>	<i>10</i>	<i>N 16 E</i>	<i>10</i>
<i>Rock-Sumeyar Sept 30th 1834</i>	O	<i>"</i>			<i>So</i>	<i>14</i>	<i>N 21 1/2 E</i>	<i>17 1/2</i>
	F	<i>"</i>			<i>Beech</i>	<i>6</i>	<i>N 14 W</i>	<i>8</i>
	G	<i>"</i>			<i>So</i>	<i>8</i>	<i>S 38 E</i>	<i>31</i>
	<i>"</i>	<i>"</i>			<i>So</i>	<i>10</i>	<i>N 29 E</i>	<i>8</i>
	<i>"</i>	<i>"</i>			<i>So</i>	<i>6</i>	<i>S 44 W</i>	<i>29</i>
<i>Calliott-Sumeyar July 3th 1862</i>	N	<i>Boulder</i>			<i>New measurements</i>			
<i>marked T by mistake Sept 9th 1873 Jerry Dugan 38 &</i>	I	<i>Stone</i>			<i>Notes, Sumeyar</i>			
		<i>no wit or</i>						
<i>7th chains N of</i>	P	<i>Stone</i>			<i>Beech</i>	<i>14</i>	<i>S 25 E</i>	<i>20 1/2</i>
<i>9th chains N of</i>	O	<i>Stone</i>			<i>S ash</i>	<i>5</i>	<i>N 70 E</i>	<i>24 1/2</i>
<i>9th chains N + 1 1/2 chains W of</i>	<i>"</i>	<i>"</i>			<i>Beech</i>	<i>16</i>	<i>S 78 1/2 W</i>	<i>47 1/2</i>
<i>9th chains N + 1 1/2 chains W + 2 1/2 chains N of</i>	<i>"</i>	<i>"</i>			<i>"</i>	<i>18</i>	<i>S 78 1/2 E</i>	<i>41</i>
<i>12 1/2 chains N of</i>	<i>"</i>	<i>"</i>			<i>no wit avail</i>			
<i>marked 25th 1878 Jerry Dugan 38 &</i>	<i>"</i>	<i>"</i>			<i>" " "</i>			
<i>August 16th 1883</i>	D	<i>"</i>			<i>Murphy 16 N 58 1/2 W 80 1/2</i>			
					<i>Geo. S. Murphy S.S.</i>			

Section 31

Township 12

North, Range 6

East.

Date, Intermediate Corners, &c., &c.	Corners.	Stone, Mark, &c.	Acres.	Hund.	Bearings, Trees, &c.	Diam.	Courses.	Dist.
Oct. 27, 1902. I set stones as follows								
Found under the road	N	N			I set Stone witness		West	21
4 ⁵⁰ chains East of	"	"			"		North	22
6 chains North "	"	"			Large Stake		East	22
6 chains North + 4 ⁵⁰ chains East "	C				No visit. available			
17 ⁶³ " South of	C				" "	"		
17 ⁶³ " South 71 ² / ₃ East of	"				W. H. Isley,	"		

194 Record of Surveys in Shelby County, Indiana.

Section **32** Township **12** North, Range **6** East.

Date, Intermediate Corners, &c., &c.	Corners.	Stone, Mark, &c.	Acres.	Hund.	Bearings, Trees, &c.	Diam.	Courses.	Dist.
7 ⁸⁰ / ₁₀₀ chains S of	N P	Stone my			Stone		S 30 W	12 5/8
10 ¹⁰⁰ / ₁₀₀ chains W of		" " 40			Beech	18	N 42 1/2 W	32
10 ¹⁰⁰ / ₁₀₀ chains W of	K	" " 40			do	14	S 22 E	26
		" " 40			Stone		S	10 1/2
22 chains S of	M	Stone			do		W	21
57 Links N 60 W of		"						
at 1/2 15 th 1877 Jerry Dugan & S.S.	C C Y	" " 66			oak	10	S 1 1/2 W	58
		" " 20			Stone		N 88 W	38
16 ⁵⁰ / ₁₀₀ chains W 1/2 1 1/2 South of	C C Y	" " 66			Redbud	10	S 35 1/2 W	71
16 ⁵⁰ / ₁₀₀ " " " 4 ⁰⁰ / ₁₀₀ " "		" " 20			Sycamore	15	N 10 1/2 W	64
13 ⁷⁵ / ₁₀₀ " South of		" " 55			Maple	26	N 70 1/2 E	31 1/2
		" " 17			Elm	13	N 13 E	20
Chas. F. Webster S.S. 1879	D	Stake on Island.			Ash	15	S 20 1/2 E	9
					Maple	20	S 27 W	27
					Elm	12	N 76 1/2 W	32
October, 1878. (Var 2 x 30')	M							
5.51 ch South 60° East of a stone in the middle of R.R. Str. & S & M. Turn Pike.					Marietta.			
4.90 ch S & 2.50 ch W of Survey for Snyder & Mrs.		Boulder at hit			Stone on N side of R.R. Str. Locust.		N 24 3/4	
								C. F. Webster, S.S.C.

Record of Surveys in Shelby County, Indiana.

199

Section *33* Township *12* North, Range *6* East.

Date, Intermediate Corners, &c., &c.	Corners.	Stone, Mark, &c.	Acres.	Hund.	Bearings, Trees, &c.	Diam.	Courses.	Dist.
	N				Beech	12	N 40 W	25'
	O				Gum	16	S 75 E	26
	G				Beech	8	N 80 W	17 1/2
	D				So	14	N 30 W	16
	M				So	18	N	36
	W				Hackberry	8	S 60 W	36
	O				Hackberry	18	N	31
	Y				Oak	24	N 60 W	46
<p><i>Apr 2nd 1866</i></p> <p><i>13. R. E</i></p> <p><i>Same</i></p>	<p><i>M</i></p> <p><i>W</i></p> <p><i>O</i></p> <p><i>Y</i></p>	<p><i>Boulder</i></p> <p><i>" 33</i></p> <p><i>"</i></p> <p><i>"</i></p>			<p><i>Beech</i></p> <p><i>No Hit</i></p> <p><i>Mulberry</i></p> <p><i>No Hit</i></p>		<p><i>16</i></p> <p><i>N 80 1/2 W</i></p> <p><i>38</i></p> <p><i>35 1/2</i></p>	
<p><i>April 24th, 1905; M^{rs} Ferren Est.</i></p> <p><i>60.52 rds south of</i></p> <p><i>60.7 " " "</i></p>	<p><i>C</i></p> <p><i>B</i></p>	<p><i>Stake</i></p> <p><i>Iron "</i></p>			<p><i>No witness</i></p>			
<p><i>James E. Norris S. C. Surveyor.</i></p>								

Hoops - Surveyor

Record of Surveys in Shelby County, Indiana.

Section *B 4*

Township *12*

North, Range *6*

East.

Date, Intermediate Corners, &c., &c.	Corners.	Stone, Mark, &c.	Acres.	Hund.	Bearings, Trees, &c.	Diam.	Courses.	Dist.
	H	Stone			Sugar	10	S 40 E	6
	K	"			B-Oak	18	S 45 N	29
	M	"			Beech	4	S 3	5
	O	"			Ash	10	N	19
	W	"			Lim			
	Y	"			Hickory	14	E	3
	C	"			B-Oak	30	S 2 N	31
	N	"			Beech	18	S 80 N	12
	B	"			So	8	N 80 E	18
<i>Nickols & Sumner</i>	Y	"			So	3	S	30
	C	"			Hickory	20	S N	17
	N	"			Beech	18	N 3/4 E	6 3/4
	B	"			So	13	N 6 3/4 N	3 6 1/4
	C	"			Ash	12	N 6 2 1/2 N	8 3/4
	D	"			So	3	S 7 1/2 N	3
<i>see 1st 1831</i>	B	"			Beech	18	N 31 N	9 7/2
	C	"			Oak	36	N 31 E	112
	D	"			Ash	8	N 1 1/2 E	51
	H	Boulder			Hickory	9	N 6 7 E	6 5/2
	E	"			Beech	10	N 16 E	33
	O	"			So	12	N 8 1/2 N	77
<i>Calliatt & Sumner</i>	L. H.	Stones			No Nit			
<i>Mar 13th 1860</i>	E. O.	"			Stakes			
					<i>W. H. Miller & Sumner</i>			

Section *34* Township *12* North, Range *6* East.

Date, Intermediate Corners, &c., &c.	Corners.	Stone, Mark, &c.	Acres.	Hund.	Bearings, Trees, &c.	Diam.	Courses.	Dist.
<p>March 26th 1878 Adugan & Co April 1881, C. H. Helister Surveyor, &c. See page 226.</p>	Y	Stone marked Y			Beech	10	S 29 $\frac{1}{2}$ E	62
	T	Gine Stone			do	16	S 10 E	63 $\frac{1}{2}$
	U	"			No Nit			
		"			"			

Record of Surveys in Shelby County, Indiana.

Section *B 5* Township *12* North, Range *4* East.

Date, Intermediate Corners, &c., &c.	Corners.	Stone, Mark, &c.	Acres.	Hand.	Bearings, Trees, &c.	Diam.	Courses.	Dist.
<p><i>June 28th 1847</i> <i>Rock-Sumeyor</i></p>	Y	<i>Stone</i>			<i>Elm</i>	<i>30</i>	<i>N 80 W</i>	<i>23</i>
					<i>so</i>	<i>12</i>	<i>S</i>	<i>25</i>
		N	<i>"</i>		<i>W-ash</i>	<i>4</i>	<i>S 18 1/2 E</i>	<i>12 1/2</i>
					<i>W-ash</i>	<i>10</i>	<i>N 66 1/2 W</i>	<i>30</i>
		L	<i>"</i>		<i>Beech</i>	<i>14</i>	<i>S 45 W</i>	<i>20</i>
					<i>so</i>	<i>9</i>	<i>S 59 E</i>	<i>47</i>
		M	<i>"</i>		<i>Hickory</i>	<i>20</i>	<i>N 60 W</i>	<i>20</i>
					<i>Beech</i>	<i>5</i>	<i>S 43 E</i>	<i>11</i>
		I	<i>"</i>		<i>so</i>	<i>9</i>	<i>N 76 E</i>	<i>32</i>
	<p><i>J. M. Elliott-Sumeyor</i></p>	K	<i>"</i>		<i>W-ash</i>	<i>5</i>	<i>S 27 E</i>	<i>17</i>
				<i>Hickory</i>	<i>12</i>	<i>S 27 W</i>	<i>12</i>	
		N	<i>"</i>		<i>Beech</i>	<i>8</i>	<i>N 38 W</i>	<i>12</i>
					<i>Ash</i>	<i>4</i>	<i>S 71 E</i>	<i>7</i>
					<i>so</i>	<i>12</i>	<i>N 47 W</i>	<i>33</i>
<p><i>Darwin-Sumeyor</i></p>	W	<i>"</i>		<i>Beech</i>	<i>6</i>	<i>S 60 E</i>	<i>8</i>	
				<i>Hickory</i>	<i>20</i>	<i>N 48 W</i>	<i>23</i>	
		O	<i>"</i>		<i>Beech</i>	<i>10</i>	<i>N 68 W</i>	<i>8</i>
					<i>so</i>	<i>18</i>	<i>S 74 E</i>	<i>26</i>
		Z	<i>"</i>		<i>No Mt</i>			
		M-I	<i>"</i>		<i>"</i>			
<i>1/2 of</i>	L-K	<i>"</i>		<i>"</i>				
<i>1/2 of</i>	A-E	<i>"</i>	<i>1</i>	<i>"</i>				
	P-T-V	<i>"</i>	<i>1</i>	<i>"</i>				

210 Record of Surveys in Shelby County, Indiana.

Section *35* Township *12* North, Range *6* East.

Date, Intermediate Corners, &c., &c.	Corners.	Stone, Mark, &c.	Acres.	Hund.	Bearings, Trees, &c.	Diam.	Courses.	Dist.
Ed. Winchel. Surveyor March 8 th 1848,	X, U I-B	Stones "			No Nit "			
W to X 20.35) 12 72 + 763) C. F. Webster Surveyor.	W to X M to N	Stone Stone			No Nit Beech	10	N E	5
Aug 15 th 1877 Jerry Egan surveyor	C	Stone m c + x			ash Stone	10	S 17 1/2 W N 32 1/2 W	58 32

Record of Surveys in Shelby County, Indiana.

Section *B6* Township *12* North, Range *6* East.

Date, Intermediate Corners, &c., &c.	Corners.	Stone, Mark, &c.	Acres.	Hund.	Bearings, Trees, &c.	Diam.	Courses.	Dist.
	A	Stone			Calum	20	N 44 W	113
					So	10	N 73 1/2 E	83
	B	"			Ash	10	N 23 E	43
					Beech	9	N 84 1/2 E	39
	C	"			No Nit			
	D	"			W-Ash	4	N 25 E	23
					Calum	8	N 34 W	26
	E	"			W-Ash	6	N 31 E	52
					So	12	N 3 E	40
	F	"			Beech	12	N 1 1/2 E	23
					Hickory	14	N 74 E	21
	G, H	" S			No Nit			
	L	"			Beech	16	N 48 W	58
					So	6	N 31 W	9
	M	"			Calum	10	N 42 W	22 1/2
					Beech	14	N 62 1/2 E	30 1/2
	N	"			W-Ash	14	N 38 E	34
					Beech	12	N 7 1/2 E	32
	O	"			Calum	13	N 16 E	7 1/2
					So	3	N 47 E	31
	P	"			Oak	3	N 83 E	40
					Beech	13	N 70 E	40 1/2
	Q	"			So	13	N 2	26 1/2
					So	7	N 30 E	16 1/2

Section *B 6*Township *12*North, Range *6*

East.

Date, Intermediate Corners, &c., &c.	Corners.	Stone, Mark, &c.	Acres.	Hnd.	Bearings, Trees, &c.	Diam.	Courses.	Dist.
	<i>R</i>	<i>stone</i>			<i>Beech</i>	<i>12</i>	<i>N 37 W</i>	<i>37</i>
					<i>S-ash</i>	<i>5</i>	<i>S 29 E</i>	<i>20</i>
	<i>S, T</i>	<i>"</i>			<i>No Nit</i>			
	<i>U</i>	<i>"</i>			<i>S-ash</i>	<i>7</i>	<i>N 31 W</i>	<i>29</i>
					<i>do</i>	<i>5</i>	<i>S 15 W</i>	<i>25</i>
	<i>V</i>	<i>"</i>			<i>stone</i>		<i>S 43 W</i>	<i>20</i>
	<i>X, Y</i>	<i>" S</i>			<i>No Nit</i>			
	<i>Z</i>	<i>"</i>			<i>"</i>			
	<i>R</i>	<i>"</i>			<i>"</i>			
		<i>"</i>			<i>"</i>			
		<i>"</i>			<i>"</i>			
	<i>Q</i>	<i>"</i>			<i>"</i>			
		<i>"</i>			<i>"</i>			
		<i>"</i>			<i>"</i>			
		<i>"</i>			<i>"</i>			

*Eed, Minchel, Surveyor**2.65 Chs North of**5.30 " " "**7.95 " " "**2.64 " " "**5.28 " " "**7.92 " " "**The above Stones were set Nov 8th 1884 in the Partition of the McCarly Est
Geo. S. Murphy surveyor*

REMARKS.

(Sec 3) Widow Weickman's Corner - N. W. Cor. Hackberry 12 ft 36 in 4 7/8
 S. W. Cor. Buckeye 4 ft 2 in 31 }
 Walnut 60. S 25 W 12 } Rock, Surveyor
 Buckeye 14 ft 8 in 4 6 1/2

(Sec. 32) Corner to S. W. Elliott & J. Engler, Elm 24 ft 33 1/2 in 140
 J. W. Elliott, Surveyor

Nov 20th 1879, Sec 29, T12, R6, Snd 4 1/2 S 1/4.

Set a Corner Stone for the N. W. Cor. of Spencer Johnson's Share. Witnessed by
 Apple tree S 63 Links So S E 80%

Set a Stone for the NE Corner of George Johnson's Share, Witnessed by
 Walnut Stump South 28 1/2 links. Hackberry 15 ft E 50.

North-East Corner of Spencer's Share. Stone, Ash 15 ft 17 Sycamore 15 ft E 47.
 C. F. Webster Surveyor, S.S.

Hoaning made a Survey and Established Corners. V, W, X, and Y.
 Abraham Beustlyon took an appeal, Judge Reed granted a
 Re Survey, and appointed Elliott and after wards appointed J. Hoop.
 I went with Hoop and we changed the Corners that I had set
 East, and agreed that said Corners are now in their proper places
 and should be respected, but the Court did not provide for
 any Record being made of the same, C. F. Webster Surveyor S.S.
 Juggans Corner Y was found to be North-East of true Corner.
 C. F. Webster S.S.

REMARKS.

Corners by John W. Whitlock - Search for stone was made at all corners
If stone wasn't found - either - Monument found before digging & was reset
or - Monument was set from best evidence