

United States Department of the Interior  
National Park Service

National Register of Historic Places Continuation Sheet

Name of Property Additional documentation, Vincennes  
Historic District

County and State Knox County, Indiana

Name of multiple property listing (if applicable)

Section number 8 Page 1

Vincennes Historic District - Resource Count, Additional Documentation

The official documentation for the Vincennes Historic District on file at the NPS states that the district encompasses 1,087 resources. It is unknown how that figure was determined, since the documentation did not include a comprehensive list of resources. Based on the attached inventory, the district includes the following resources:

1,161 Contributing buildings	405 Non-contributing buildings
5 Contributing sites	6 Non-contributing sites
9 Contributing structures	5 Non-Contributing structures
37 Contributing objects	3 Non-contributing objects

1,212 Contributing 419 Non-contributing

205 vacant and parking lots are included in the attached inventory, for locational purposes, but are not included in the resource count. Only primary buildings are included in the count (no garages or temporary buildings such as yard sheds). Buildings that have been demolished since the inventory was first completed in 1997 have been included and noted in the attached inventory for locational purposes, but they were not counted in the above tally.

The non-contributing buildings are either too recent (post-1955 - see significance section), or have been too altered to contribute. Non-contributing buildings have lost historical feeling through application of siding that obscures detail, re-sizing of window openings, additions that compromise the historic form, removal of historic elements, or, a combination of the above. The net result is that these buildings are unable to convey their time and place in the development of Vincennes.

Vincennes Historic District - Statement of Significance, Additional Documentation (based on March 1997, *Knox County Interim Report*, by Indiana Division of Historic Preservation / Historic Landmarks Foundation of Indiana)

The purpose of this document is to expand the period of significance of the Vincennes Historic District. Additionally, this submittal includes a comprehensive inventory of every resource within the boundaries of the district as-listed. Listed in the National Register of Historic Places in 1974, the district encompasses much of the town's area. The district includes the oldest, continuously inhabited land in Indiana beginning with the Piankeshaw Indian Village. Locally the district can be divided into five different areas: the Riverfront area; Old French Town; the Courthouse area; the Downtown Commercial area; and a residential area.

The period of significance indicated in the original nomination includes check boxes for 18<sup>th</sup> Century, 19<sup>th</sup> Century, and 20<sup>th</sup> Century. Based on more current policies and approaches to the period of significance concept, this document establishes the period of significance as c.1787 (date of Fort Knox, deposits of which are known to exist in the district) - 1955. It should be noted that although the date c.1787 is cited here,

United States Department of the Interior  
National Park Service

National Register of Historic Places Continuation Sheet

Name of Property Additional documentation, Vincennes  
Historic District

County and State Knox County, Indiana

Name of multiple property listing (if applicable)

Section number 8 Page 2

Vincennes undoubtedly could yield data as far back as c.1732 (construction of a French fort and subsequent French settlement). For the end of the period of significance, the year 1955 was chosen since it appears to coincide with both architectural and historical trends in Vincennes. As an industrial center, Vincennes was beginning a long descent by 1955. Additionally, after 1955, the number of buildings that contribute to the district falls off sharply.

The district's collection of early architecture is significant. Within the Riverfront area lies the site of the 1787 Fort Knox (26305), which was America's westernmost outpost at that time, and Grouseland (26069), the home of William Henry Harrison, Indiana's first Territorial Governor and the 9<sup>th</sup> President of the United States. Also included in this area are the 1806 Michel Brouillet House (26948). Reflecting the town's French heritage, and the Indiana Territory Capitol (26048) which was moved to its current location in 1949.

Old French Town includes the 1826 St. Francis Xavier Cathedral (26668), the oldest cathedral building in the state, St. Gabriel's College and the St. Francis Xavier Rectory (26671, 26670). The earliest known records of this parish date to 1749. The early 1800's ushered in a period of growth for the village, whose northern boundary at that time was Busseron Street with the eastern boundary stretching no further than 6<sup>th</sup> Street. In 1806, Vincennes University was founded as the College of Vincennes making it the oldest college in Indiana (26018).

The town's commercial activity included the organization of the Bank of Vincennes in 1814. Andrew Gardner opened a cabinet shop in 1816, later shifting from making caskets to conducting funerals. This business continues to this day as the Gardner Funeral Home (26566). Two of the town's business ventures, the Vincennes Bank and the Vincennes Steam Mill failed in 1821, although four years later, the town's first cotton mill opened for business. For the next three decades, Vincennes remained primarily an agricultural community.

It was the coming of the railroad during the 1850s that ushered Vincennes into a period of prosperity. Following the Civil War, the town's economic base expanded to include manufacturing. A number of factories were built along the river in the late 19<sup>th</sup> and early 20<sup>th</sup> centuries, including the Vincennes Foundry and Machine Company (26920). Shotgun houses such as the Leeds House (26942) and the Butler-Clark House (26943) provided housing for the factories' workers.

It was during the late nineteenth century and early twentieth century that Vincennes reached its zenith. Nowhere is this more evident than in the town's downtown business district. Main Street is lined with a number of outstanding commercial blocks, many incorporating locally-made cast iron and pressed metal architectural details. Among the most notable of these buildings are the Adam Gimbel Block (26480,26482), the Moore and Harris Drug Store (26542), the Frank Fay Building (26471) and the Moses Wile Store (26491). The downtown business district retained its singular role as the most important commercial center in Knox County well into the mid-twentieth century. The taverns, restaurants, and theaters of Vincennes were popular spots for servicemen during World War II.

United States Department of the Interior  
National Park Service

National Register of Historic Places Continuation Sheet

Name of Property Additional documentation, Vincennes  
Historic District

County and State Knox County, Indiana

Name of multiple property listing (if applicable)

Section number 8 Page 3

This period also saw a residential boom. A number of the city's prominent families had their houses built in the area surrounding the downtown area, often employing some of Vincennes most prominent architects. This significant collection of architect-designed homes provides examples of the most popular architectural styles of the era. The 1889 Hiram Foulkes House (26325), and the William P. Ritterskamp House (27388) both designed by Thomas Campbell are two outstanding examples of the Queen Anne style. Louis Osterhage designed the Ray E. Fortune house (26284) in the Craftsman style. Osterhage and Campbell collaborated on the Romanesque Revival style Andrew Bruner House (26327) and the Colonial Revival style Marlin Mail House (26366).

Local architects were also responsible for a number of prominent public buildings in Vincennes. Foremost of these architects were John W. Gaddis and John Bayard. Gaddis' designs for a number of public and religious buildings are noteworthy. The Vincennes Presbyterian Church (27350) and St. John Evangelical United Brethren Church (27318), built two years apart are outstanding examples of the Gothic Revival style. Gaddis was also responsible for the 1903 Knox County Sheriff's Residence and Jail (27619) and the Clark Jr. High School (27439). Vincennes had a long tradition of interest in education. One of the first "libraries" in the Old Northwest Territory was the collection of Rev. Benedict Flaget, who organized a library, housed within the Vincennes Cathedral complex in 1794. Vincennes was also the site of Indiana's first college, as mentioned earlier. Two of John Bayard's most prominent educational buildings of the twentieth century are the Collegiate Gothic Revival style Vincennes Public Library (1919) and the LaSalle School (1927) (27493, 27510). Additionally, the Adams Coliseum (1926) is an example of a Collegiate Gothic gym that served the educational needs of the community.

Although the Great Depression of the 1930s hit Vincennes particularly hard, the formation of the George Rogers Clark Memorial Commission sparked renewed interest in the area's history. The construction in 1932 of the George Rogers Clark Memorial (26965), designed by Frank C. Hiron, commemorated the contributions of this Revolutionary War figure. On June 14, 1936, President Franklin Delano Roosevelt dedicated the memorial and 30 years later, the site was designated as a National Park. Another important Depression-era structure, the Lincoln Memorial Bridge (26617) was dedicated in 1933.

During World War II, industries in Vincennes contributed to the war effort. Undoubtedly, the town's links to the coal industry and its rail connections were useful as well. The U.S. Army Air Corps established George Field, just across the Wabash River in Lawrenceville, Illinois in 1942. By 1944, George Field was used for glider tow training, home to both C-47 crews and glider pilots. Vincennes established a USO club to entertain airmen and crew stationed at George Field. Many servicemen from George Field found housing or enjoyed the commercial and public attractions of Vincennes during the war. New businesses, such as the Art Moderne Fort Sackville Theater (1940, 711 Church St.) undoubtedly saw increases in patronage.

As manufacturing declined as an economic force in Vincennes and commercial activity shifted east and north of town with construction of a bypass, the community has concentrated more on the promotion of its rich past. The National Park site, the

United States Department of the Interior  
National Park Service

National Register of Historic Places Continuation Sheet

Name of Property Additional documentation, Vincennes  
Historic District

County and State Knox County, Indiana

Name of multiple property listing (if applicable)

Section number 8 Page 4

Territory site and several restored buildings reflecting the city's settlement period, provide the visitor a glimpse of Vincennes rich heritage.

Photo Log

Vincennes Historic District - Additional Documentation  
9/2013

Name of Property: Vincennes Historic District, Additional Documentation  
City or Vicinity: Vincennes  
County and State: Knox Co., Indiana  
Photographer: Amy Kotzbauer  
Date Photographed: July 8, 2013  
Location of Original  
Digital Files: Indiana DNR - Division of Historic Preservation &  
Archaeology

Description of Photograph and number:

IN\_KnoxCounty\_VincennesHistoricDistrict0001.tif

First Baptist Church at 432 Broadway St., camera looking east.

IN\_KnoxCounty\_VincennesHistoricDistrict0002.tif

Fort Sackville Theater, 1940, 711 Main St., camera facing west.

IN\_KnoxCounty\_VincennesHistoricDistrict0003.tif

Fortnightly Club, 1928, 421 N. 6<sup>th</sup> St., camera facing east.

IN\_KnoxCounty\_VincennesHistoricDistrict0004.tif

George Rogers Clark Memorial, 1932, South 2<sup>nd</sup> Street at Vigo St., camera facing west/northwest.

IN\_KnoxCounty\_VincennesHistoricDistrict0005.tif

LaSalle School, 1927, 302 S. 7<sup>th</sup> St., camera facing southwest.

IN\_KnoxCounty\_VincennesHistoricDistrict0006.tif

Vincennes Masonic Lodge, 1916, 501 Broadway St., camera facing west.

IN\_KnoxCounty\_VincennesHistoricDistrict0007.tif

New Moon Theater, 1939, 529 Main St., camera facing northwest.

IN\_KnoxCounty\_VincennesHistoricDistrict0008.tif

Pantheon Theater, 1921, 428 Main St., camera facing north.

United States Department of the Interior  
National Park Service

National Register of Historic Places Continuation Sheet

Name of Property Additional documentation, Vincennes  
Historic District

---

County and State Knox County, Indiana

---

Name of multiple property listing (if applicable)

---

Section number 8 Page 5

---

IN\_KnoxCounty\_VincennesHistoricDistrict0009.tif

American National Bank, 1917, 302 Main St., camera facing northwest.

IN\_KnoxCounty\_VincennesHistoricDistrict0010.tif

Sisters of Providence Home, 1927, 828 Vigo St., camera facing east.

IN\_KnoxCounty\_VincennesHistoricDistrict0011.tif

U.S. Post Office, 1907, 501 Busseron St., camera facing south.

IN\_KnoxCounty\_VincennesHistoricDistrict0012.tif

Vincennes Public Library, 1919, 502 N. 7<sup>th</sup> St., camera facing north.

IN\_KnoxCounty\_VincennesHistoricDistrict0013.tif

Oliphant Building, 214 Main St., 1916, 214 Main St., camera facing northeast.

Vincennes Historic District 2013 Inventory Data -- East/West Streets

Survey #	St. #	Type	Style	Const. dt.	rating	2013 Status	Notes
College Ave (South side)							
	26001 NA	parking lot	NA	NA	NC		
	26002 213-217	commerical bldg	Contemporary	c.1960	NC		
	26003 303	commerical bldg	Vernacular	c.1980	NC		
	26004 315	house	Gable-front	c.1900	C		
	26005 319	house	Vernacular	c.1893	C		
	26006 323	house	T-plan	c.1897	C		
	26007 327	house	Bungalow	c.1898	C		
	26008 411	house	Vernacular	c.1950	NC		
	26009 417	commerical bldg	Vernacular	c.1950	NC		
	26010 NA	parking lot	NA	NA	NC		
	26011 505	commerical bldg	Vernacular	c.1950	NC		
	26012 723	house	T-plan	c.1940	C		
	26013 817	house	Bungalow	c.1919	C		
Harrison Street (North Side)							
	26014 NA	Barracks	Vernacular	1943/1952	C	Demo	c.1995
	26015 NA	parking lot	NA	NA	NC		
	26016 NA	Health Occupation Bldg	Contemporary	1971	NC		
	26017 NA	Historical Marker	NA	1938	C		
	26018 NA	Historical Marker	NA		C		
	26019 NA	Entry gate	Vernacular	1878/1981	C		
	26020 8	Maria Creek Chapel	Gable-front	1970	C		Relocation of Vincennes University to this campus
	26021 110	Shircliff Humanities Ctr.	Contemporary	1972	NC		History of founding of Vincennes University
	26022 216	House	T-plan	c.1900	C		
	26023 314	commerical bldg	Vernacular	c.1900	C		
	26024 404	house	Gable-front	c.1910	C		
	26025 406	commerical bldg	Vernacular	c.1940	C		
	26026 412	house	Gable-front	c.1910	NC		
	26027 414	house	Ranch	c.1950	NC		
	26028 NA	vacant lot	NA	NA	NC		
	26029 NA	parking lot	NA	NA	NC		
	26030 NA	parking lot	NA	NA	NC		
	26031 708	House	Colonial Revival	c.1937	N		
	26032 720	house	Bungalow	c.1914	C		
	26033 NA	vacant lot	NA	NA	NC		
	26034 816	house	Bungalow	c.1912	C		
	26035 916	house	Vernacular	c.1920	NC		
	26036 926	house	Hall-and-Parlor	c.1880	C		
	26037 NA	vacant lot	NA	NA	NC		
Harrison Street (South Side)							
	26038 NA	industrial bldg.	Vernacular	c.1960	NC		
	26039 NA	levee	NA	c.1930	N		
	26040 NA	Vincennes Water Dept. Pumphouse	Raomanesque Revival	1886	O		
	26041 NA	parking lot	NA	NA	NC		
	26042 NA	house	Log Hall-and-Parlor	c.1810/1964	N		
	26043 NA	Maurice Thompson House	Single-pen	c.1840/1966	N		
	26044 NA	shed	Vernacular	c.1970	NC		

Marker states she was born 1814; daughter of Zachary Taylor and married Jefferson Davis in 1835  
Explains origins and use of millstones

26045 NA	Sarah Knox Taylor Historic Marker	NA	1814-1835	C	
26046 NA	Emerson Mills Historical Marker	NA	1804	C	
26047 NA	commerical bldg	Gable-front	1954	C	
26048 NA	The Capital	I-house	1805	O	NR; HABS!
26049 NA	parking lot	NA	NA	NC	
26050 NA	parking lot	NA	NA	NC	
26051 NA	parking lot	NA	NA	NC	
26052 313	Thomas Kiffoil Tin Works	Vernacular	1916	N	Louis Osterhage, architect
26053 409	house	Bungalow	c.1925	C	
26054 411	house	Bungalow	c.1915	C	
26055 NA	house	Gabled-ell	c.1900	C	
26056 515	house	Gable-front	c.1890	C	
26057 521	house	Central-passage	c.1890	C	
26058 609	house	Hall-and-Parlor	c.1870	C	
26059 721	house	Vernacular	c.1950	NC	
26060 807	house	Bungalow	c.1919	C	
26061 909	commerical bldg	Vernacular	c.1930	C	
26062 913	house	Vernacular	c.1940	NC	
26063 NA	vacant lot	NA	NA	NC	
West Scott Street (North Side)					
26064 NA	barn	NA	c.1980	NC	
26065 15	John Hack House	Gabled-ell	1886	C	Peter Sertel, builder
26066 3	WAC Barracks	Vernacular	1943	C	
26067 NA	Grouseland historical marker	NA	1803-1804	C	Denotes home of William Henry Harrison
26068 NA	Grouseland National historical Landmark	NA	1803-1804	C	Designates Harrison home as a National Historic Landmark
26069 3	Grouseland	Federal	1803	O	NR; HABS; NHL
26070 NA	Brick Street	NA	1915	C	
East Scott Street (North Side)					
26071 NA	vacant lot	NA	NA	NC	
26072 220	commerical bldg	Contemporary	c.1960	NC	
26073 NA	vacant lot	NA	NA	NC	
26074 310	house	Gable-front	1897	C	
26075 402	house	Central-passage	c.1895	C	
26076 422	house	American four-square	c.1900	C	
26077 424	house	Gabled-ell	c.1900	C	
26078 506	house	American four-square	c.1900	C	
26079 510	house	American four-square	c.1900	C	
26080 518	house	Bungalow	c.1897	C	
26081 526	house	Hall-and-Parlor	c.1879	C	
26082 616	house	American four-square	c.1907	C	
26083 712	house	Bungalow	c.1925	C	
26084 816	house	Bungalow	c.1916	C	
26085 924	house	Central-passage/Greek Rev.	c.1870	C	
26086 1008	house	Hall-and-Parlor	c.1910	C	
26087 1018	house	Central-passage	c.1900	NC	
West Scott Street (South Side)					
26088 NA	levee	NA	c.1950	N	
26089 NA	Baltimore & Ohio Railroad Bridge	Warren Through Truss/Pratt	c.1900	O	
26090 NA	parking lot	NA	NA	NC	
East Scott Street (South Side)					
26091 NA	parking lot	NA	NA	NC	
26092 303	John B. LaPlante House	I-house; Greek Revival	c.1860	C	

26093 307	house	Bungalow	c.1920	C
26094 309	house	Bungalow	c.1910	C
26095 403-405	house	Queen Anne Cottage	c.1910	C
26096 409	house	Vernacular	c.1903	C
26097 419	house	American four-square	c.1905	C
26098 429	Robert Wallace House	Vernacular	1883	C
26099 509-511	house	Double-pen	c.1892	C
26100 611	house	Vernacular	c.1868	C
26101 613	house	Central-passage	c.1898	C
26102 NA	parking lot	NA	NA	NC
26103 913	house	Bungalow	c.1918	C
26104 1019	house	Central-passage	c.1890	C
Shelby Street (North Side)				
26105 NA	parking lot	NA	NA	NC
26106 8	commercial bldg	Vernacular	c.1940	C
26107 104	commercial bldg	Contemporary	c.1980	NC
26108 104	garage	Vernacular	c.1950	NC
26109 214	house	Vernacular	c.1905	NC
26110 216	apartment bldg	Contemporary	c.1960	NC
26111 320	house	Shotgun	c.1910	C
26112 420	James M. House House	Craftsman	c.1895/1916	C
26113 502	house	Vernacular	c.1890	C
26114 504	house	T-plan	c.1890	C
26115 510	house	T-plan	c.1890	C
26116 612	Squire B. Helms Jr. House	Bungalow	1912	C
26117 820	house	Bungalow	c.1924	C
26118 926	house	Bungalow	c.1915	C
26119 1006	house	Colonial Revival	c.1930	C
Shelby Street (South Side)				
26120 NA	shed	NA	c.1980	NC
26121 117	apartment bldg	Contemporary	c.1970	NC
26122 215	house	American four-square	c.1913	C
26123 319-321	duplex	Vernacular	c.1940	C
26124 405-407	house	Craftsman	c.1910	C
26125 509	house	American four-square	c.1915	C
26126 NA	parking lot	NA	NA	NC
26127 703	house	American four-square	c.1920	C
26128 707	house	Colonial Revival	c.1947	C
26129 821	house	American four-square	c.1910	C
26130 825	house	American four-square	c.1910	C
26131 827	house	American four-square	c.1903	C
26132 925	house	Contemporary	c.1970	NC
Hart Street (North Side)				
26133 10	house	Vernacular	c.1980	NC
26134 12	commercial bldg	Vernacular	c.1940	C
26135 14	commercial bldg	Vernacular	c.1920	C
26136 118-120	duplex	Gable-front	c.1870	C
26137 208	house	Gable-front	c.1910	C
26138 222	house	Italianate	c.1886/c.192	C
26139 NA	First Church of Christ Scientist	Colonial Revival	1915-1916	N
26140 304	Shuler McCormick House	Vernacular	1915	C
26141 306	Otto Heinekemp House	Bungalow	c.1919	C
26142 318	house	Gabled-ell	c.1896	C

Campbell & Osterhage, architects



26143 324	house	Gabled-ell	c.1893	C
26144 326-328	duplex	American four-square	c.1910	C
26145 NA	parking lot	NA	NA	NC
26146 504	Charles G. McCord House	Free Classic	1889	C
26147 506	house	Free Classic	c.1898	C
26148 510	house	Upright-and-wing	c.1859	C
26149 NA	parking lot	NA	NA	NC
26150 NA	parking lot	NA	NA	NC
26151 812	House	Bungalow	c.1923	C
26152 818	apartment bldg	Craftsman	c.1898	C
26153 826	house	Gabled-ell	c.1880	C
26154 1022	house	Gable-front	c.1880	C
26155 1024	house	Gable-front	c.1947	C
26156 1030	house	T-plan	c.1890	C
				Demo
				Demo
Hart Street (South Side)				
26157 NA	levee	NA	c.1930	C
26158 11-13	commerial bldg	Vernacular	c.1890	C
26159 NA	vacant lot	NA	NA	NC
26160 103	William Nugent House	Central-passage	1880	C
26161 115	house	Vernacular	c.1906	C
26162 215	house	Bungalow	c.1926	C
26163 NA	parking lot	NA	NA	NC
26164 501	apartment bldg	Vernacular	1937	C
26165 NA	parking lot	NA	NA	NC
26166 NA	parking lot	NA	NA	NC
26167 801	house	NA	NA	NC
26168 803	house	American four-square	c.1895	C
26169 811	house	Cottage	c.1906	C
26170 815	house	Craftsman	c.1913	C
26171 821	house	Free Classic	c.1900	C
26172 823	Central Church of Christ	American four-square	c.1915	C
26173 903	house	20th Century Gothic Rev.	1951	C
26174 907	house	Free Classic	c.1905	C
26175 913	house	Bungalow	c.1925	C
26176 917	house	T-plan	c.1910	C
26177 921	house	Gabled-ell	c.1900	NC
26178 925	house	Queen Anne Cottage	c.1903	C
26179 1015	commerial bldg	Hall-and-Parlor	c.1870	C
26180 1021	commerial bldg	Contemporary	c.1970	NC
		Contemporary	c.1970	NC
Seminary Street (North Side)				
26181 NA	parking lot	NA	NA	NC
26182 112	George Hitt House	Double-pen	1847/1919	C
26183 120	house	Cottage	c.1915	C
26184 NA	vacant lot	NA	NA	NC
26185 128	house	Cottage	c.1922	C
26186 NA	parking lot	NA	NA	NC
26187 714	house	Bungalow	c.1930	C
26188 716	house	Bungalow	c.1920	C
26189 720	house	Bungalow	c.1911	C
26190 810	house	Bungalow	c.1926	C
26191 816	house	Vernacular	c.1880	C
26192 826	house	Gable-front	c.1950	C
26193 830	house	Vernacular	c.1890	C

26194 904	house	Bungalow	c.1920	C
26195 910	house	Colonial Revival	c.1936	C
26196 916	house	Colonial Revival	c.1939	C
26197 920	house	Bungalow	c.1919	C
26198 928	house	Central-passage	c.1880	C
26199 1004	apartment bldg	Contemporary	c.1970	NC
26200 NA	parking lot	NA	NA	NC
26201 1028	house	Gabled-ell	c.1910	NC
Seminary Street (South Side)				
26202 209	apartment bldg	Vernacular	c.1910	C
26203 213-217	apartment bldg	Contemporary	c.1960	NC
26204 NA	parking lot	NA	NA	NC
26205 411	house	American four-square	c.1920	NC
26206 415	house	Ranch	c.1958	NC
26207 621	house	Contemporary	c.1951	NC
26208 NA	parking lot	NA	NA	NC
26209 715	house	Bungalow	c.1921	C
26210 719	Christian H. Meyer House	Queen Anne	1896	C
26211 729	house	Colonial Revival	c.1939	N
26212 803	Louis A. Meyer House	Queen Anne	c.1895	N
26213 809	house	Central-passage	c.1870	C
26214 815	house	Cruciform	c.1870	C
26215 825	house	Contemporary	c.1984	NC
26216 829	house	Vernacular	c.1880	C
26217 903	house	Vernacular	c.1900	NC
26218 905	house	Free Classic	c.1904	C
26219 907	house	Free Classic	c.1904	C
26220 911	house	Gable-front	c.1905	C
26221 915	house	Bungalow	c.1908	C
26222 917	house	Bungalow	c.1920	C
26223 1003	house	T-plan	c.1900	C
26224 1005	house	T-plan	c.1905	C
26225 1007	house	T-plan	c.1900	C
26226 1009	house	T-plan	c.1905	C
26227 1029	commercial bldg	Contemporary	c.1980	NC
Perry Street (North Side)				
26228 212	house	Vernacular	c.1910	C
26229 216	house	Central-passage	c.1870	C
26230 220	house	Gable-front	c.1880	C
26231 416	house	American four-square	c.1900	C
26232 420	house	American four-square	c.1900	C
26233 422	house	Cottage	c.1945	C
26234 508	Benjamin Wheeler House	Queen Anne	c.1910	N
26235 516	house	I-house/Greek Revival	c.1850	C
26236 610	St. James Episcopal Church	20th Century Gothic Rev.	c.1906	N
26237 612	house	Free Classic	c.1910	C
26238 710	house	Cottage	c.1945	C
26239 720	house	American four-square	c.1910	C
26240 728	house	American four-square	c.1910	C
26241 730	house	American four-square	c.1910	C
26242 804	house	T-plan	c.1890	C
26243 806	house	Vernacular	c.1910	C
26244 812	house	Bungalow	c.1900	C

Thomas Campbell, architect

26245 816	house	Bungalow	c.1900	C	
26246 826	house	Bungalow	c.1910	C	
26247 830	house	Bungalow	c.1910	C	
26248 902	house	Contemporary	c.1960	NC	
26249 922	house	American four-square	c.1910	C	Demo
26250 930	house	Queen Anne Cottage	c.1900	C	
26251 1004	house	American four-square	c.1910	C	
26252 1012	house	Free Classic	c.1910	C	
26253 1014	house	Free Classic	c.1910	C	
26254 1018	house	T-plan	c.1910	NC	
26255 1020	house	T-plan	c.1910	C	
26256 1024	house	T-plan	c.1910	C	
Perry Street (South Side)					
26257 NA	Sidewalk	NA	c.1900	C	
26258 NA	parking lot	NA	NA	NC	
26259 211	commercial bldg	Vernacular	c.1915	C	
26260 215	house	American four-square	1916	C	
26261 415	H.W. Frund House	T-plan	1887	C	
26262 417-419	house	Vernacular	c.1910	C	
26263 NA	parking lot	NA	NA	NC	
26264 NA	parking lot	NA	NA	NC	
26265 715	house	Free Classic	c.1890	C	Demo
26266 727	house	T-plan	c.1910	C	
26267 729	house	I-house	c.1910	C	
26268 803	William S. Racey House	Free Classic	c.1897	C	Demo
26269 807	Thomas F. Palfrey House	Vernacular	1898	C	
26270 811	house	Craftsman	c.1915	N	
26271 819	house	American four-square	c.1910	C	
26172 827	house	Vernacular	c.1900	C	
26273 829	house	Craftsman	c.1920	C	
26274 915	house	Bungalow	c.1920	C	
26275 921	house	I-house	c.1910	C	
26276 929	house	Central-passage	c.1870	C	
26277 1013	house	Ranch	c.1950	NC	
26278 1015	house	Ranch	c.1950	NC	
Buntin Street (North Side)					
26279 NA	vacant lot	NA	NA	NC	
26280 NA	vacant lot	NA	NA	NC	
26281 214	commercial bldg	Vernacular	c.1920	NC	
26282 216	John Werker House	American four-square	1917	C	
26283 NA	parking lot	NA	NA	NC	
26284 416	Ray E. Fortune house	Craftsman	1915	N	Louis Osterhage, architect
26285 420	house	American four-square	c.1915	C	
26286 422	Theofore M. Jackson House	Craftsman	c.1911	C	
26287 620	Adams Coliseum	20th Century Gothic Rev.	1926	C	
26288 702	house	American four-square	c.1920	C	
26289 706	house	American four-square	c.1920	N	
26290 710	house	American four-square	c.1920	C	
26291 714	house	Craftsman	c.1920	C	
26292 718	house	Queen Anne Cottage	c.1910	C	
26293 722	house	Queen Anne Cottage	c.1890	C	
26294 726	house	Queen Anne Cottage	c.1890	C	
26295 810	house	Ranch	c.1950	NC	

26296 816	John C. Haartje House	Vernacular	1883	C
26297 822	house	Free Classic	c.1910	C
26298 828	house	Spanish Eclectic	c.1930	C
26299 902	house	Craftsman	c.1920	C
26300 914	house	Contemporary	c.1970	NC
26301 1018	house	Vernacular	c.1900	C
26302 1020	house	Pyramidal-roof	c.1900	C
26303 1022	house	Pyramidal-roof	c.1900	C
Buntin Street (South Side)				
26304 NA	vacant lot	NA	NA	NC
26305 NA	Fort Knox Historical Marker	NA	1787	C
26306 NA	parking lot	NA	NA	NC
26307 NA	parking lot	NA	NA	NC
26308 121	U.S. Social Security Office	Contemporary	c.1980	NC
26309 NA	parking lot	NA	NA	NC
26310 215	August Schultheis House	Free Classic	1907	C
26311 221	house	American four-square	c.1910	C
26312 225	house	American four-square	c.1910	N
26313 401	William A. Miller House	American four-square	c.1910	C
26314 NA	parking lot	NA	NA	NC
26315 421	commercial bldg	Contemporary	c.1970	NC
26316 NA	Park	NA	NA	NC
26317 517	house	Free Classic	c.1900	C
26318 609	house	American four-square	c.1910	C
26319 613	house	Craftsman	c.1910	C
26320 701	house	Free Classic	c.1910	C
26321 707	house	Free Classic	c.1910	C
26322 715	house	American four-square	c.1915	C
26323 725	house	Central-passage	c.1860	C
26324 727	George Reily House	Queen Anne	c.1881	O
26325 803	Hiram Foulkes House	Queen Anne	1889	O
26326 813	house	Free Classic	c.1910	N
26327 815	Andrew Bruner House	Romanesque Revival	1910	N
26328 819	House	American four-square	c.1910	C
26329 903	House	American four-square	c.1910	C
26330 905	house	Bungalow	c.1910	C
26331 911	house	Bungalow	c.1915	C
26332 915	house	Bungalow	c.1915	C
26333 917	house	Bungalow	c.1915	C
26334 919	house	Gabled-all	c.1900	C
26335 923	house	T-plan	c.1900	C
26336 925	house	Vernacular	c.1900	NC
26337 1015	house	T-plan	c.1900	C
26338 NA	vacant lot	NA	NA	NC
26339 1021	house	Bungalow	c.1910	C
26340 1027	house	Hall-and-Parlor	c.1880	C
Broadway Street (North Side)				
26341 104	commercial bldg	Vernacular	c.1890	NC
26342 NA	vacant lot	NA	NA	NC
26343 202	commercial bldg	Contemporary	c.1970	NC
26344 210	commercial bldg	Contemporary	c.1970	NC
26345 NA	parking lot	NA	NA	NC
26346 310	Marone House	T-plan	c.1870	C

J. H. Stem; architect  
Thomas Campbell; architect

Campbell & Osterhage; architects

26347	316	house	Vernacular	c.1900	NC
26348	NA	parking lot	NA	NA	NC
26349	324	commerial bldg	Contemporary	c.1960	NC
26350	420	U.S. Post Office	Contemporary	1969	NC
26351	430	house	American four-square	c.1915	C
26352	NA	parking lot	NA	NA	NC
26353	432	First Baptist Church	Neoclassical	1915	O
26354	502	Rush Bond house	Colonial Revival	1909	N
26355	NA	parking lot	NA	NA	NC
26356	524	Dr. John H. Rabb House	Italianate	1876	C
26357	602	apartment bldg	Contemporary	c.1970	NC
26358	612	Captain Allen Tindolph House	Italianate	1881	C
26359	618	Ella agnew House	Gable-front	c.1910	C
26360	624-638	commerial bldg	Contemporary	c.1980	NC
26361	702	house	I-house	c.1908	NC
26362	708	Frank G. Reiter House	American four-square	c.1908	C
26363	714	house	American four-square	c.1908	N
26364	718	house	Central-passage	c.1860	N
26365	724	E.A. Bryan House	Queen Anne	1889	N
26366	804	Marlin Mail House	Colonial Revival	1910	N
26367	810	house	Central-passage	c.1900	C
26368	816	house	Cruciform	c.1910	C
26369	818	house	American four-square	c.1910	C
26370	822	house	American four-square	c.1910	C
26371	828	house	Vernacular	c.1880	C
26372	904	house	Prairie	c.1915	C
26373	912	house	Bungalow	c.1920	C
26374	914	house	American four-square	c.1915	C
26375	918	house	Vernacular	c.1880	C
26376	926	house	Queen Anne Cottage	c.1910	C
26377	1002	house	Craftsman	c.1915	C
26378	1004-1006	duplex	American four-square	c.1900	C
26379	1012	house	Gabled-ell	c.1910	C
26380	1014	house	Gabled-ell	c.1900	C
26381	1020	house	T-plan	c.1910	C
26382	1026	house	Shotgun	c.1900	C
26383	NA	commerial bldg	Contemporary	1995	NC
26384	NA	parking lot	NA	NA	NC
26385	NA	parking lot	NA	NA	NC
26386	NA	Brick Street	NA	1995	NC
26387	215-217	apartment bldg	Vernacular	c.1990	NC
26388	NA	parking lot	NA	NA	NC
26389	301	First Christian Church	Contemporary	1978	NC
26390	NA	parking lot	NA	NA	NC
26391	NA	First Indiana Masonic Lodge Historical Mark	NA	1809	C
26392	501	Vincennes Masonic Lodge No 1	Neoclassical	1916	N
26393	NA	parking lot	NA	NA	NC
26394	517	commerial bldg	Contemporary	c.1975	NC
26395	NA	parking lot	NA	NA	NC
26396	NA	parking lot	NA	NA	NC
26397	605	House	Greek Revival	1859	N
26398	NA	parking lot	NA	NA	NC

Broadway Street (South Side)

Louis Osterhage; architect

Campbell & Osterhage ; architects

John W. Gaddis; architect

26399	619	house	Greek Revival	c.1860	C
26400	NA	parking lot	NA	NA	NC
26401	NA	parking lot	NA	NA	NC
25402	NA	U.S.C. & G. A. Survey Marker	NA	1930	C
26403	NA	parking lot	NA	NA	NC
26404	809	Knox County Records Library	Contemporary	c.1980	NC
26405	NA	parking lot	NA	NA	NC
26406	823	Christian Hoffman House	Vernacular	c.1902	C
26407	903	S.S. Hollingsworth House	Italianate	1883	C
26408	907	House	Queen Anne Cottage	c.1895	C
26409	909	A.M. Yelton House	Queen Anne Cottage	1897	C
26410	911	House	Queen Anne Cottage	c.1890	C
26411	925	St. Paul Lutheran Church	20th Century Gothic Rev.	1950	C
26412	1001	House	Vernacular	c.1860	C
26413	1017	House	Queen Anne Cottage	c.1870	C
26414	1019	House	Gabled-ell	c.1915	C
26415	1023	House	Contemporary	c.1960	NC
Besseron Street (North Side)					
26416	NA	Brick sidewalk	NA	c.1992	NC
26417	NA	parking lot	NA	NA	NC
26418	NA	parking lot	NA	NA	NC
26419	NA	parking lot	NA	NA	NC
26420	NA	parking lot	NA	NA	NC
26421	402	commerial bldg	Contemporary	c.1960	NC
26422	NA	parking lot	NA	NA	NC
26423	NA	vacant lot	NA	NA	NC
26424	522	Wilson M. Tyler House	Queen Anne	1881	C
26425	NA	parking lot	NA	NA	NC
26426	820	John A. Iouis House	Gable-front	1869	NC
26427	824	Simon Pagen House	Queen Anne Cottage	1876	C
26428	904	house	Craftsman	c.1915	N
26429	906	house	Gable-front	c.1910	C
26430	910	Rudolph Grubeck House	Vernacular	1936	C
26431	914	house	Craftsman	c.1920	C
26432	916	house	Gable-front	c.1915	C
26433	926	house	Gable-front	c.1910	C
26434	1003	Herman H. Ostendorf House	Gabled-ell	c.1884	C
26435	1008	house	Gable-front	c.1880	C
26436	1010	house	Gable-front	c.1890	C
26437	1014	house	Hall-and-Parlor	c.1870	C
26438	1016	house	Bungalow	c.1920	C
26439	1018	house	Gable-front	c.1900	C
26440	1026	house	French Vernacular	c.1840	C
Busseron Street (South Side)					
26441	117	commerial bldg	Vernacular	c.1970	NC
26442	NA	parking lot	NA	NA	NC
26443	403	Vincennes Water Dept.	Contemporary	c.1988	NC
26444		Brick sidewalk	NA	NA	NC
26445		parking lot	NA	NA	NC
26446		parking lot	NA	NA	NC
26447	501	U.S. Post Office	Neoclassical	1907/1936	O
26448	609	Hoosier Gas Co.	Contemporary	1962	NC
26449		Substation	Vernacular	c.1980	NC

J. H. Stem; architect

J.A. Piel; builder

James Knox Taylor; architect:1907; John B. Bayard ; architect 1936  
Leser W. Roatt & Assoc.; architects

Demo

26450	parking lot	NA	NA	NC
26451	Goodyear Tire Company	Contemporary	1961	NC
26452	parking lot	NA	NA	NC
26453	General George McCoy House	American four-square	c.1908	C
26454	Lyle C. Simpson House	American four-square	c.1910	C
26455	Harry W. Beggs House	American four-square	c.1911	C
26456	commercial bldg	Contemporary	c.1960	NC
26457	Samuel Dunn House	Double-pen/federal	1847	O
26458	William B. Robinson House	Italianate	1876	O
26459	House	Bungalow	c.1910	C
26460	House	Hall-and-Parlor	c.1870	C
26461	House	Ranch	c.1970	NC
26462	House	Bungalow	c.1920	C
26463	House	Central-passage	c.1870	C
26464	House	American four-square	c.1915	C
26465	House	American four-square	c.1910	C
26466	House	T-plan	c.1910	C
26467	House	Cottage	c.1915	C
26468	House	American four-square	c.1910	C
26469	vacant lot	NA	NA	Demo
26470	William Burch & William J. Heberd Dry Goo	Federal	1828	C
26471	Frank Fay Building	Italianate	1890	N
26472	Bey Brothers Building	Romanesque Revival	1902	N
26473	commercial bldg	Italianate	c.1900	C
26474	commercial bldg	Vernacular	c.1900	C
26475	McKenny Bank Building	Vernacular	c.1880	C
26476	John B. Page Harness Shop	Vernacular	c.1880	C
26477	William A. Weed Hardware Store	Vernacular	1912	N
26478	Heberd Store	Italianate	1868	N
26479	Cornoyer Building	Federal	c.1830	C
26480	Adam Gimbel Block	Italianate	1857/1904	N
26481	Adam Gimbel Block	Italianate	1859/1878	N
26482	Bernard Kuhn Building	Italianate	1859/1879	N
26483	Isaac Kuhn Building	Vernacular	c.1895/1929	C
26484	J.T. Oliphant Building	Neoclassical	1916	O
26485	Montgomery Ward	Vernacular	1937	C
26486	commercial bldg	Indeterminate	Indeter.	NC
26487	S.S. Kresge	Contemporary	1961	NC
26488	American National Bank	Neoclassical	1917	O
26489	Ostendorf-Oliphant Building	Indeterminate	1915/c.1970	NC
26490	American National Bank	Vernacular	c.1905	N
26491	Moses Wile Store	Italianate	1875	N
26492	commercial bldg	Italianate	c.1880	C
26493	Bernard Building	Vernacular	1929/c.1970	NC
26494	William & Ulysses Heberd Building	Italianate	1873	O
26495	commercial bldg	Indeterminate	c.1960	NC
26496	commercial bldg	Indeterminate	c.1960	NC
26497	commercial bldg	Indeterminate	c.1955	NC
26498	commercial bldg	Vernacular	c.1960	NC
26499	commercial bldg	Italianate	1887	C
26500	E.J. Loten Building	Italianate	1887	N
26501	Mrs. E. J. Loten Building	Italianate	1883	C

Robert Boyd; architect

John W. Gaddis; architect

Garnes & Moore; architects  
John W. Gaddis; Architect

Peter Sertej; builder

Main Street (North Side)

26502 418	Herman J. Werker Building	Vernacular	c.1910	N	
26503 420-424	commercial bldg	Vernacular	c.1900	C	
26504 428	Pantheon Theater	Renaissance Revival	1921	O	John B. Bayard; architect
26505 506	William Farrel Building	Italianate	1914	C	
26506 508-518	Henry Ebervine Building	Italianate	1894	C	
26507 522	commercial bldg	Indeterminate	Indeter.	NC	
26508 526	commercial bldg	Vernacular	c.1910	C	
26509 528	commercial bldg	Vernacular	c.1950	NC	
26510 620	service station	Contemporary	c.1980	NC	
26511 NA	parking lot	NA	NA	NC	
26512 702	commercial bldg	Contemporary	c.1960	NC	
26513 NA	parking lot	NA	NA	NC	
26514 806	Andrew Weiler House	Queen Anne Cottage	1905	N	
26515 810	John J. Murphy House	Queen Anne Cottage	1907	N	
26516 812	commercial bldg	Vernacular	c.1965	NC	
26517 828	Maryland Oil Company Station	Mission Revival	1928	N	
26518 NA	parking lot	NA	NA	NC	
26519 NA	parking lot	NA	NA	NC	
26520 910	commercial bldg	Vernacular	c.1920	C	
26521 912	commercial bldg	Indeterminate	Indeter.	NC	
26522 914	commercial bldg	Italianate	c.1900	C	
26523 NA	vacant lot	NA	NA	NC	
26524 920	commercial bldg	Vernacular	c.1910	C	
26525 922	commercial bldg	Vernacular	c.1955	NC	
26526 924-926	commercial bldg	Vernacular	c.1955	NC	
26527 NA	parking lot	NA	NA	NC	
26528 1002	Albert Miller Drug Store	Vernacular	1911	C	
26529 1008	commercial bldg	Indeterminate	Indeter.	NC	
26530 NA	parking lot	NA	NA	NC	
26531 1022	commercial bldg	Vernacular	c.1970	NC	
26532 NA	parking lot	NA	NA	NC	
26533 NA	vacant lot	NA	NA	NC	
26534 NA	parking lot	NA	NA	NC	
26535 NA	Park	NA	NA	NC	
26536 201-203	German National Bank	Romanesque Revival	1905	N	
26537 205	commercial bldg	Indeterminate	1903	C	
26538 207-209	commercial bldg	Vernacular	c.1868	NC	
26539 211-213	Victor Schoenfeld Building	Italianate	1888	N	
26540 215	commercial bldg	Neoclassical	1904	N	
26541 217	First National Bank	Neoclassical	1913	O	
26542 221	Moore & Harris Drug Store	Italianate	1875/1885	O	Edward P. Clark; architect
26543 223	Oslo Building	Indeterminate	Indeter.	NC	
26544 227-229	Joseph L Bayard Building	Italianate	1878	O	J.H. Stern; architect
26545 231	commercial bldg	Indeterminate	1905/1957	NC	
26546 301	Duesterberg & Kramer Building	Vernacular	1925	C	
26547 305	commercial bldg	Vernacular	c.1910	NC	
26548 307-309	J.C. Penny Building	Vernacular	1936	C	
26549 315	N. Smith & Sons Building	Indeterminate	1907/1963	NC	
26550 317	Hustage Building	Italianate	1876	N	
26551 319	Brokhage Building	Italianate	1899	C	
26552 321	Benoit Fritsch Building	Vernacular	1899	C	John W. Gaddis; architect
26553 323	Foelke Building	Italianate	c.1900	C	

Main Street (South Side)



26554	325	commerical bldg	Italianate	1890	C
26555	329	commerical bldg	Indeter.	Indeter.	NC
26556	331	Watson Building	Italianate	1856/1877/1	N
26557	401	Nicolas Smith Building	Indeterminate	1886/c.1960	NC
26558	405	commerical bldg	Vernacular	c.1925	C
26559	409	Emil Yungahs Building	Vernacular	c.1890	N
26560	413	commerical bldg	Italianate	1904	N
26561	417	Edward Londner Saloon	Italianate	1895	C
26562	419-421	commerical bldg	Vernacular	c.1925	C
26563	423	commerical bldg	Indeterminate	Indeter.	NC
26564	425	Bishop Block	Neoclassical	1888	N
26565	NA	parking lot	NA	NA	NC
26566	505	Bonner-Allen House	Federal/Greek Revival	1842	O
26567	509	Paul C. Schultz Building	Neoclassical	1916	N
26568	513	Major Gould-Knights of Columbus Building	Italianate/Mission Revival	1883/1920	O
26569	521	Cyrus Allen House	Greek Revival	1865	O
26570	529	New Moon Theater	Art Deco	1939	O
26571	601	commerical bldg	Vernacular	c.1940	C
26572	NA	parking lot	NA	NA	NC
26573	NA	Bank drive -thru	Contemporary	c.1980	NC
26574	619	commerical bldg	Contemporary	c.1980	NC
26575	701	Risch & Heller Building	Italianate	1894	N
26576	NA	parking lot	NA	NA	NC
26577	711	Fort Sackville Theater	Art Deco	c.1940	N
26578	717	House	Queen Anne	c.1895	C
26579	729	William Hayes House	I-house/Greek Revival	1865	N
26580	803	St. John Rectory	Greek Revival	1857/1914	N
26581	811	St. John the Baptist Catholic Church	Gothic Revival	1851/1866/1	O
26582	901-905	commerical bldg	Vernacular	c.1935	C
26583	911	house	Bungalow	c.1935	C
26584	913	House	T-plan	c.1915	C
26585	915	House	T-plan	c.1915	C
26586	921	commerical bldg	Vernacular	c.1935	C
26587	NA	parking lot	NA	NA	NC
26588	1001	Sebastian Risch Building	Italianate	c.1892	C
26589	1003	commerical bldg	Italianate	C.1910	C
26590	NA	parking lot	NA	NA	NC
26591	1013	commerical bldg	Art Deco	c.1940	C
26592	1023	commerical bldg	Indeterminate	Indeter.	NC
26593	NA	parking lot	NA	NA	NC
26594	NA	parking lot	NA	NA	NC
26595	216	commerical bldg	Contemporary	c.1980	NC
26596	NA	parking lot	NA	NA	NC
26597	424	Moffet Pontiac Showroom	Contemporary	1936	C
26598	426	commerical bldg	Contemporary	c.1970	NC
26599	NA	parking lot	NA	NA	NC
26600	504	gas station	Vernacular	c.1995	NC
26601	NA	parking lot	NA	NA	NC
26602	516	commerical bldg	Vernacular	1936	C
26603	NA	parking lot	NA	NA	NC
26604	702	commerical bldg	Contemporary	c.1970	NC
26605	704	commerical bldg	Contemporary	c.1970	NC

Vigo Street (North Side)

26606 708-710	house	Gable-front	c.1920	C
26607 718	House	Vernacular	c.1880	C
26608 722	house	T-plan	c.1910	C
26609 726	house	Gabled-ell	c.1910	C
26610 800	Flaget Elementary School	Vernacular	1953/1963	C
26611 828	Sisters of Providence Home	Colonial Revival	1927	C
26612 904	Joseph Faenger house	Free Classic	c.1910	C
26613 910	House	Bungalow	c.1925	C
26614 928	Vincennes Fire Dept. Station no 1	Contemporary	c.1970	NC
26615 NA	storage building	Vernacular	c.1930	NC
26616 1030	storage building	Vernacular	c.1975	NC
26617 NA	Lincoln Memorial Bridge	NA	1933	O
26618 201	Vincennes City Hall	Contemporary	1990	NC
26619 NA	parking lot	NA	NA	NC
26620 317	House	Queen Anne	c.1890	C
26621 319	commercial bldg	Contemporary	c.1970	NC
26622 NA	parking lot	NA	NA	NC
26623 401	commercial bldg	Contemporary	c.1970	NC
26624 NA	parking lot	NA	NA	NC
26625 415	commercial bldg	Contemporary	c.1975	NC
26626 NA	parking lot	NA	NA	NC
26627 513	commercial bldg	Contemporary	c.1980	NC
26628 NA	parking lot	NA	NA	NC
26629 NA	parking lot	NA	NA	NC
26630 703	commercial bldg	Contemporary	c.1994	NC
26631 709	house	Hall-and-Parlor	c.1870	C
26632 709 1/2	house	Gabled-ell	c.1925	C
26633 715	house	Queen Anne	c.1915	C
26634 721	house	English Cottage	c.1930	C
26635 729	house	Queen Anne Cottage	c.1890	C
26636 815	House	Queen Anne Cottage	c.1890	C
26637 827	house	Hall-and-Parlor	c.1920	C
26638 901	House	American four-square	c.1915	C
26639 907	House	Bungalow	c.1915	C
26640 911	House	Queen Anne Cottage	c.1900	C
26641 917	House	Bungalow	c.1920	C
26642 921	House	T-plan	c.1900	C
26643 925	House	T-plan	c.1900	C
26644 NA	storage building	Vernacular	c.1970	NC
26645 1009	garage	Vernacular	c.1955	NC
26646 310	Mary O'Flynn House	Gable-front	c.1876 <sup>1</sup>	NC
26647 312	Anna O'Flynn House	Queen Anne	1886	C
26648 314	House	Queen Anne Cottage	c.1905	NC
26649 316	House	Queen Anne Cottage	c.1915	C
26650 322	House	Craftsman	c.1915	C
26651 412	House	Queen Anne Cottage	c.1895	C
26652 420	House	Vernacular	c.1895	C
26653 422	House	Queen Anne	c.1905	C
26654 426	House	Queen Anne Cottage	c.1900	C
26655 NA	parking lot	NA	NA	NC
26656 712	House	Ranch	1965	NC

Vigo Street (South Side)

William E. Parsons; architect, Raul Jossett, sculptor

Church Street (North Side)

26657	718	House		Queen Anne Cottage	c.1900	C	
26658	724	House		American four-square	c.1915	C	
26659	728	House		Central-passage	c.1920	C	
26660	820	House		Bungalow	c.1920	C	
26661	824	House		Bungalow	c.1920	C	
26662	904	House		Queen Anne	c.1885	C	
26663	906	House		Cruciform	c.1915	C	
26664	910	House		Queen Anne Cottage	c.1900	C	
26665	914	House		Free Classic	c.1905	C	
26666	1022	City Electric Lighting Co. Power Plant		Romanesque Revival	1900	C	Thomas Campbell; architect
26667	NA	Pierre Gibault Statue		NA	1936	C	Albin Ploasek, sculptor
26668	201	St. Francis Xavier Catholic Church Library		Greek Revival	1826-1841	O	NR, HABS, John Rogers, architect
26669	203	St. Francis Xavier Rectory		Greek Revival	1841	O	NR, HABS
26670	205	St. Gabriel's College		Greek Revival	1841	O	NR, HABS
26671	205	Bishop Simon Brute Library		Federal	1837	O	NR, HABS
26672	205	Old St. Rose Chapel		Contemporary	1968	NC	
26673	205	Cemetery		Gable-front		C	
26674	205	Cemetery		NA		C	
26675	205	Janne Boneau Grave Marker		NA	1846	C	
26676	205	Eliza F. Thomas Gravestone		NA	1800	C	
26677	205	Rev. Jean Francois Rivet historical Marker		NA	1757-1804	C	
26678	205	Rev. Jean Francois Rivet historical Marker		NA	1757-1804	C	
26679	205	Gravestone		NA		C	
26680	205	Mrs. Eunice Vouillon LeRoy Gravestone		NA	1826	C	
26681	205	Caroline Benedict Gravestone		NA	1845	C	
26682	205	Our Lady of Lourdes Grotto		NA	1951	NC	
26683	205	Old Cathedral Bell		NA	1839	C	
26684	205	parking lot		NA		C	
26685	NA	St. Francis Xavier Parochial School		Italianate	1884	O	Dietrich Bohlen, architect
26687	303	House		Queen Anne	c.1900	C	
26688	307	House		American four-square	c.1925	C	
26689	313	House		American four-square	c.1925	C	
26690	313	John Moore Historical Marker		NA	1820-23	C	
26691	313	Mary O'Donnell House		Colonial Revival	1907	O	
26692	409	John Klein House		Queen Anne	c.1890	N	
26693	415	House		Vernacular	c.1915	C	
26694	421	House		Central-passage/Greek Rev.	c.1860	N	
26695	509	House		American four-square	c.1887	C	
26696	513	Henry Duesterberg & Sons Bldg		Vernacular	c.1897	C	
26697	519	house		Queen Anne	c.1895/1905	C	
26698	529	parking lot		Free Classic	1905	C	
26699	NA	House		NA	NA	NC	
26700	609	House		T-plan	c.1900	C	
26701	611-613	House		Cruciform	c.1890	C	
26702	617	Henry Tehar House		Hall-and-Parlor	c.1883	C	
26703	621	Edwin L. Glass house		Bungalow	1898	C	
26704	625	House		Ranch	c.1960	NC	
26705	703	House		Craftsman	c.1915	C	
26706	711	George Keinklaus House		Vernacular	1878/1925/1	NC	
26707	713	house		T-plan	c.1900	C	
26708	721	House		Cruciform	c.1900	C	

Church Street (South Side)

26709 727	House	Contemporary	c.1980	NC	
26710 NA	garage	Vernacular	c.1930	C	
26711 NA	vacant lot	NA	NA	NC	
26712 815	house	Ranch	c.1955	NC	
26713 NA	garage	Gable-front	c.1935	C	
26714 1017	house	Hall-and-Parlor	c.1900	C	
26715 1023	house	Vernacular	c.1910	NC	
<b>Barnett Street (North Side)</b>					
26716 210	Gibault School	Colonial Revival	1924/1963	N	John Bayard; architect
26717 310	House	Double-pile	c.1910	C	
26718 312-318	House	Craftsman	c.1915	C	
26719 320	House	T-plan	c.1905	C	
26720 408	House	Vernacular	c.1900	C	
26721 416	House	American four-square	c.1910	C	
26722 418	House	Vernacular	c.1900	NC	
26723 518	House	Bungalow	c.1900	C	
26724 522	House	Bungalow	c.1900	C	
26725 610	House	Bungalow	c.1910	C	
26726 614	House	Bungalow	c.1910	C	
26727 618	House	Bungalow	c.1910	C	
26728 626	House	Double-pen	c.1910	C	
26729 630	House	Gabled-ell	c.1895	C	
26730 714	Playground	NA	NA	NC	
26731 720	House	T-plan	c.1885	NC	
26732 810	House	Gabled-ell	c.1890	C	
26733 818	House	Free Classic	c.1900	N	
26734 822	House	Bungalow	c.1920	C	
26735 1002	Herman Kruger House	Central-passage	1845	C	
26736 1010	House	T-plan	c.1910	C	
26737 1014	House	T-plan	c.1910	C	
26738 1018	House	Bungalow	c.1945	C	
26739 1022	William Schlomer House	Hall-and-Parlor	1910	C	
26740 1028	House	Hall-and-Parlor	c.1895	C	
<b>Barnett Street (South Side)</b>					
26741 311	House	T-plan	c.1910	C	
26742 319	House	American four-square	c.1920	C	
26743 407	House	Cottage	c.1920	C	
26744 411	George R. Gardner House	Gabled-ell	1890	C	
26745 415	House	Ranch	1956	NC	
26746 515	house	Bungalow	c.1910	C	
26747 607	House	Bungalow	c.1910	C	
26748 613	House	Gabled-ell	c.1910	NC	
26749 621	House	Ranch	c.1960	NC	
26750 817	House	Bungalow	c.1910	C	
26751 821	House	Contemporary	c.1960	NC	
26752 829	House	Hall-and-Parlor	c.1860	C	
26753 923	House	Gabled-ell	c.1940	NC	
26754 925	Paul Doddridge House	Bungalow	1912	C	
26755 929	house	T-plan	c.1910	NC	
26756 1001	House	Ranch	c.1970	NC	
26757 NA	vacant lot	NA	NA	NC	
26758 1019	house	Bungalow	c.1930	C	
26759 1023	house	Bungalow	c.1920	C	

Address	Description	Year/Date	Style	Notes
26760 1027	house	c.1920	Bungalow	C
26761 202	house	c.1930	Bungalow	C
26762 204	house	c.1930	Bungalow	C
26763 312	House	c.1920	Gable-front	C
26764 NA	vacant lot	NA	NA	NC
26765 410	commercial bldg	c.1895	Vernacular	C
26766 510	House	c.1915	American four-square	C
26767 514	House	c.1915	American four-square	C
26768 612	House	c.1910	American four-square	C
26769 614	House	c.1900	T-plan	C
26770 618	House	c.1920	Bungalow	C
26771 620	House	c.1920	Bungalow	C
26772 NA	parking lot	NA	NA	NC
26773 NA	vacant lot	NA	NA	NC
26774 818	House	c.1910	T-plan	C
26775 902	Wayne Fitzgerald house	1936	Vernacular	NC
26776 924-926	Duplex	c.1940	Gable-front	NC
26777 932-934	Duplex	c.1940	Bungalow	C
26778 936	House	c.1920	English Cottage	C
26779 1002-1010	apartment bldg	c.1970	Ranch	NC
26780 1014	House	c.1880	Hall-and-Parlor	C
26781 1020	House	c.1920	Bungalow	C
26782 1026	House	c.1920	Bungalow	C
26783 1032	House	c.1920	Bungalow	C
26784 301	House	c.1960	Contemporary	NC
26785 311	House	c.1910	Bungalow	NC
26786 313	House	c.1900	Gable-front	NC
26787 317	House	c.1890	Gable-front	C
26788 319-321	Duplex	c.1970	Vernacular	NC
26789 323	House	c.1890	Queen Anne Cottage	C
26790 409	House	c.1875	Italianate	N
26791 413	House	c.1890	Cottage	C
26792 419	House	c.1910	Bungalow	C
26793 505	House	c.1900	American four-square	N
26794 513	house	c.1930	Gabled-ell	NC
26795 517	House	c.1950	Ranch	NC
26796 607-611	commercial bldg		Contemporary	NC
26797 615	commercial bldg		Ranch	NC
26798 911-913	House	c.1880	double-pen	C
26799 917	House	c.1950	Gable-front	NC
26800 923	House	c.1900	Vernacular	C
26801 939	House	c.1880	Hall-and-Parlor	C
26802 1001	commercial bldg	c.1950	Vernacular	C
26803 1021	house	c.1900	Cottage	C
26804 NA	vacant lot	NA	NA	NC
26805 312	house	c.1920	Bungalow	C
26806 326	house	c.1920	Bungalow	C
26807 410	house	c.1900	Gabled-ell	NC
26808 504	house	c.1955	Ranch	NC
26809 510	house	c.1900/c.198	T-plan	C

Nicholas Street (North Side)

26810 514	house	Contemporary	c.1970	NC
26811 518	House	Indeterminate	c.1890/1990	NC
26812 522	House	T-plan	c.1890/1960	C
26813 600	apartment bldg	Contemporary	c.1980	NC
26814 910	House	Colonial Revival	c.1940/c.196	NC
26815 920	House	Bungalow	c.1920/1980	NC
26816 1010	House	Indeterminate	c.1900	NC
26817 1012	House	Hall-and-Parlor	c.1870	C
26818 1024	House	Bungalow	c.1920	C
26819 1028	House	Contemporary	c.1945	NC
26820 203	House	Indeterminate	indeter.	NC
26821 205	House	Indeterminate	c.1900	NC
26822 309	House	Bungalow	c.1905	C
26823 315	House	Bungalow	c.1910	C
26824 321	commerial bldg	Contemporary	c.1970	NC
26825 411	House	Bungalow	c.1920	C
26826 419	House	T-plan	c.1890	NC
26827 427	House	Queen Anne Cottage	c.1890	C
26828 515	House	Ranch	c.1970	NC
26829 NA	parking lot	NA	NA	NC
26830 NA	parking lot	NA	NA	NC
26831 NA	parking lot	NA	NA	NC
26832 911	House	Bungalow	c.1920	C
26833 917	House	Bungalow	c.1929	C
26834 1005	House	T-plan	c.1885	C
26835 1017	House	T-plan	c.1885	C
26836 1021	House	Central-passage	c.1860	NC
26837 1027	House	Bungalow	c.1920	C
26838 318	House	Dutch Colonial	c.1910	C
26839 322	House	Indeterminate	c.1980	NC
26840 410	House	Vernacular	1883/1912	C
26841 414	house	Vernacular	1883/1912	C
26842 502	House	Hall-and-Parlor	c.1870	NC
26843 510	House	Vernacular	c.1890	NC
26844 514	Dr. J.P. Reynolds House	Vernacular	1844	NC
26845 520	House	Queen Anne Cottage	c.1890	C
26846 914	House	Contemporary	c.1950	NC
26847 319	House	Hall-and-Parlor	indeter.	NC
26848 327	house	Gabled-ell	indeter.	NC
26849 407	house	Bungalow	c.1920	C
26850 411	house	Gabled-ell	c.1900	C
26851 413	house	shotgun	c.1890	C
26852 421	house	Hall-and-Parlor	c.1900	C
26853 425	house	Hall-and-Parlor	c.1890	C
26854 NA	parking lot	NA	NA	NC
26855 515	commerial bldg	Ranch	c.1980	NC
26856 1003	apartment bldg	Contemporary	c.1960	NC
26857 1019	commerial bldg	Contemporary	1975	NC
26858 NA	parking lot	NA	NA	NC

Nicholas Street (South Side)

Bayou Street (North Side)

Bayou Street (South Side)

Prairie Street (North Side)

26859	626	commercial bldg	Ranch	c.1970	NC
26860	NA	parking lot	NA	NA	NC
26861	920	House	Central-passage	c.1880	C
26862	611	house	Pyramidal-roof	c.1920	NC
26863	615	house	Gabled-ell	c.1905	C
26864	623	house	Queen Anne Cottage	c.1900	C
26865	625	house	shotgun	c.1900	C
26866	627	house	Indeterminate	c.1890	NC
26867	711	house	Gabled-ell	c.1900	C
26868	715	house	Gable-front	c.1880/c.191	C
26869	717	house	Gabled-ell	c.1950	NC
26870	723	house	Bungalow	c.1940	NC
26871	727	house	shotgun	c.1900	NC
26872	731	house	Gabled-ell	c.1900	C
26873	803	house	American four-square	c.1910	C
26874	807	house	Bungalow	c.1920	C
26875	811	house	T-plan	c.1900	C
26876	815	house	T-plan	c.1890	C
26877	819	house	T-plan	c.1890	C
26878	823	house	Ranch	c.1900	NC
26879	903	house	Bungalow	c.1920	C
26880	907	house	T-plan	c.1890	NC
26881	911	house	Gabled-ell	c.1890	NC
26882	915	house	Dutch Colonial	c.1890	NC
26883	917	commercial bldg	Vernacular	c.1900	NC
26884	921	house	Free Classic	c.1910	NC
26885	312	gas station	Craftsman	c.1920	C
26886	412	house	Bungalow	c.1920	NC
26887	414	house	Gable-front	c.1950	NC
26888	426	house	Vernacular	c.1950	NC
26889	NA	vacant lot	NA	NA	NC
26890	510	commercial bldg	Vernacular	c.1950	NC
26891	610	house	Vernacular	c.1970	NC
26892	708	commercial bldg	Vernacular	c.1970	NC
26893	714	commercial bldg	Vernacular	c.1980	NC
26894	810	house	Vernacular	c.1950	NC
26895	822	house	Vernacular	c.1950	NC
26896	920	house/commercial bldg	Vernacular	c.1940	NC
26897	924	House	Bungalow	c.1920	NC
26898	928	commercial bldg	Vernacular	c.1950	NC
26899	NA	Greenlawn Cemetery	NA	1788-present	C
26900	NA	Red Banks Trace Historical Marker	NA	c.1780	C

Willow Street

Vincennes Historic District 2013 Inventory Data -- North/South Streets

Survey #	St. #	Type	Style	Const. dt.	rating	2013 Status	Notes
Culbertson Boulevard (West Side)							
26901	NA	concrete wall	NA	1930	C		
26902	NA	Pumphouse	Vernacular	c.1950	NC		
26903	NA	House	Hall-and-parlor	c.1900	C		
Culbertson Boulevard (East Side)							
26904	NA	Brick street	NA	1913	C		
North 1st Street (West Side)							
26905	NA	Charles Grator Historical Marker	NA	1779	C		
26906	NA	George Rogers Clark historical Marker	NA	1779	C		
26907	NA	George Rogers Clark historical Marker	NA	1779	C		
26908	NA	Parking lot	NA	NA	NC		
26909	2	Hellert Saloon	Italianate	c.1900	C		Thomas Campbell, architect
26910	16	Terre Haute Brewing Company	Mission Revival	1902	N		
26911	20	Commercial bldg	Vernacular	1890	C		
26912	NA	Commercial bldg	Vernacular	c.1975	NC		
26913	26	Allen B. Daniel Building	Federal	1839	N		
26914	104	Commercial bldg	Vernacular	c.1915	C		
26915	104	Atlas Mills	Vernacular	c.1920	C		
26916	104	Baltic Mills	NA	1936	C		
26917	NA	Parking lot	NA	NA	NC		
26918	NA	brick sidewalk	NA	NA	NC		
26919	NA	Vacant lot	NA	NA	NC		
26920	406	Vincennes Foundry & Machine Co.	NA	1885/1984	N	Demo	
26921	NA	Parking lot	NA	NA	NC		
26922	406	Medical Bldg	Contemporary	1988	NC		
26923	NA	Parking lot	NA	NA	NC		
26924	NA	Parking lot	NA	NA	NC		
26925	518	House	American four-square	c.1910	C	Demo	
26926	528	House	Central-passage	c.1895	C		
26927	602	Commercial bldg	Vernacular	c.1890	C		
26928	NA	Vacant lot	NA	NA	NC		
North 1st Street (East Side)							
26929	NA	Northwest Territory Monument	NA	1787	N		
26930	NA	Knox County Gold Star Honor Roll Monument	NA	1937	N		
26931	NA	Commercial bldg	Vernacular	c.1890	NC		
26932	19	John M. Murphy Tavern	Italianate	1899	N		
26933	27	Commercial bldg	Vernacular	c.1890	C		
26934	29	Commercial bldg	Vernacular	c.1885	C		
26935	NA	brick sidewalk	NA	1913	C		
26936	NA	Vacant lot	NA	NA	NC		
26937	NA	brick sidewalk	NA	1913	C		
26938	NA	Parking lot	NA	NA	NC		
26939	NA	Parking lot	NA	NA	NC		
26940	NA	Shed	NA	NA	NC		
26941	401	Commercial bldg	Vernacular	c.1970	NC		
26942	407	Elizabeth Leeds House	Shotgun	c.1930	C		
26943	409	Anna Butler-Jennie Clark House	Shotgun	c.1880	N		
26944	411	House	Shotgun	c.1880	C		
26945	413	Commercial bldg	Gable-front	c.1885	C		
			Vernacular	c.1900	C		



26946	NA	Parking lot	NA	NA	NC	
26947	NA	Jefferson Davis Historical Marker	NA	NA	C	
26948	509	Michel Brouillet House	Creole Cottage	c.1806	O	NR; HABS
26949	515	house	Side-hall/Italianate	1906	C	
26950	517	George W. Hanes House	I-house	c.1880	C	
26951	601	House	Central-passage	c.1860	C	
26952	605	House	Bungalow	c.1925	C	
26953	611	House	Gabled-ell	c.1900	C	
26954	615	Paul Schultz House	Gabled-ell	c.1910	C	
26955	617	Christian W. Schultz House	Queen Anne Cottage	1903	C	
South 2nd Street (West Side)						
26956	519	Helen Allen House	Vernacular	1914	NC	
26957	401	Park	NA	1933	C	
26958	425	House	Contemporary	c.1950	NC	
26959	401	Clark Memorial Visitor's Center	Vernacular	c.1960	C	
26960	NA	Fort Sackville Historical marker	NA	NA	C	
26961	NA	Francis Vigo Statue	NA	1936	N	John Angel, sculptor
26962	NA	Wabash River Historical Marker	NA	NA	C	
26963	NA	Park	NA	NA	NC	
26964	NA	Fort Sackville Historical marker	NA	NA	C	
26965	NA	George Rogers Clark Memorial	Neoclassical	1932	O	NR; Frederic C. Hiron, architect
26966	NA	USS Vincennes Historical Marker	NA	NA	NC	
26967	NA	Francois marie Bissot, Sieur de Vincennes Histori	NA	NA	C	
26968	2	Second National Bank	Neoclassical	1912	O	
26969	10	Cincinnati & St. Louis Exchange Saloon	Vernacular	c.1858	C	
26970	12	Phillip Schumacher Building	Italianate	1872	C	
26971	14	Commercial bldg	Vernacular	c.1920	C	
26972	16	Commercial bldg	Vernacular	c.1935	C	
26973	20	Commercial bldg	Vernacular	c.1935	C	
26974	24	Commercial bldg	Italianate	c.1905	N	
26975	28	Commercial bldg	Contemporary	c.1965	NC	
26976	NA	Parking lot	NA	NA	NC	
26977	NA	Francis Vigo House Historical Marker	NA	1800	C	
26978	NA	Grand Opera House Historical Marker	NA	1858	C	
26979	NA	brick sidewalk	NA	c.1994	NC	
26980	NA	Second State Bank Historical Marker	NA	NA	C	
26981	114	Second State Bank	Greek Revival	1838/1966	O	NR; HABS
26982	118	Commercial bldg	Vernacular	c.1930	C	
26983	202	Commercial bldg	Contemporary	c.1979	NC	
26984	NA	Parking lot	NA	NA	NC	
26985	NA	Vacant lot	NA	NA	NC	
26986	302-310	Commercial bldg	Contemporary	c.1915/c.1985	C	
26987	NA	Parking lot	NA	NA	NC	
26988	328	E. Bierhaus & Sons Grocery	Romanesque Revival	1901	N	Thomas Campbell, architect
26989	402-404	John Hoffman Store	Italianate	1892	N	Peter Sertel, contractor
26990	410	House	Vernacular	c.1915	C	
26991	414	House	Queen Anne	c.1900	C	
26992	418	House	American four-square	c.1915	C	
26993	424	House	Bungalow	c.1925	C	
26994	426	House	Free Classic	c.1895	N	
26995	430	House	Free Classic	c.1895	C	
26996	504-506	House	Free Classic	c.1900	N	
26997	508	House	T-plan	c.1910	C	

26998	510	House	Colonial Revival	c.1915	N
26999	520	House	American four-square	c.1910	C
27001	524	House	American four-square	c.1910	C
27002	602	House	Queen Anne Cottage	c.1890	C
27003	610	House	American four-square	c.1900	C
27004	616	House	Gable-front	c.1910	NC
27005	NA	Parking lot	NA	NA	NC
27006	624	J.M. Duesterberg Building	Italianate	1893	C
27007	706	Commercial bldg	Vernacular	c.1920	C
27008	NA	Parking lot	NA	NA	NC
27009	NA	Parking lot	NA	NA	NC
South 2nd Street (East Side)					
27010	526	House	Vernacular	c.1910	NC
27011	516	House	Gabled-ell	c.1900	C
27012	512	House	Queen Anne Cottage	c.1890	C
27013	424	House	T-plan/Queen Anne	c.1895	NC
27014	422	House	Contemporary	c.1980	NC
27015	408	House	Double-pen	c.1880	C
27016	404	House	Ranch	c.1965	NC
27017	306	House	Gable-front	c.1900	C
27018	302	Robert H. Perry House	Gabled-ell	1907	C
27019	NA	Park	NA	NA	C
27020	12	Hoffman House	Vernacular	1946	C
North 2nd Street (East Side)					
27021	11-13	John Ebner Building	Vernacular	1860/1895	N
27022	NA	Parking lot	NA	NA	NC
27023	101	John Morone Saloon	Vernacular	c.1898/1967	C
27024	NA	Ellis Mansion Historical Marker	NA	1838	C
27025	111	Judge Abner T. Ellis House	Greek Revival	1838	N
27026	119	Samuel Judah Building	Vernacular	c.1860	C
27027	121	Samuel Judah Building	Indeterminate	1878	NC
27028	125	Commercial bldg	Indeterminate	Indeter.	NC
27029	127	Samuel Judah Building	Italianate	1860	C
27030	207	E. Bierhaus & Sons Building	Italianate	1891	N
27031	211	Commercial bldg	Italianate	1893	C
27032	219	Commercial bldg	Italianate	1894	C
27033	225	Allen B. Daniels House	I-house/Greek Revival	1849	N
27034	307	Commercial bldg	Contemporary	c.1980	NC
27035	NA	Parking lot	NA	NA	NC
27036	321	L. Park Colenbaugh Building	Vernacular	1907	C
27037	NA	Parking lot	NA	NA	NC
27038	401	Commercial bldg	Vernacular	c.1870	C
27039	NA	Parking lot	NA	NA	NC
27040	415	L. Park Colenbaugh Building	Colonial Revival	1911	C
27041	421	House	Vernacular	c.1890	C
27042	425	House	Central-passage	c.1860	C
27043	427	House	American four-square	c.1910	C
27044	429	House	Bungalow	c.1920	C
27045	501	Esco Walk house	Queen Anne	1893	C
27046	509	House	Gable-front	c.1900	C
27047	511	House	Ranch	c.1985	NC
27048	515	P.J. Barns House	T-plan	1910	C
27049	521	House	Queen Anne Cottage	c.1895	C

Thomas Campbell, architect

Campbell & osterhage, architects

27050	603	House	Free Classic	c.1900	C
27051	607	House	Vernacular	c.1900	C
27052	609	House	Contemporary	c.1980	NC
27053	613	Samuel Judah-John I. Baty House	Double-pile	1824/1840	C
27054	615	Dr. J. T. Baty Historical Marker	NA	c.1830	C
27055	619	House	Contemporary	c.1970	C
27056	703-705	J & F Merchant Building	Vernacular	1912	C
27057	707	Commercial bldg	Vernacular	c.1948	C
27058	NA	Parking lot	NA	NA	NC
27059	713	Pomil house	Italianate	1903	C
27060	715	Peter Pomil Building	Italianate	c.1880	NC
27061	717	Ralph Westfall Building	Vernacular	1947	C
27062	805-807	August Boik Building	Vernacular	1917/1930	C
27063	809	Commercial bldg	Contemporary	c.1975	NC
27064	821	garage	Contemporary	c.1975	NC
27065	901-903	Albert E. Schory Building	Vernacular	c.1898/1967	C
27066	905	House	Pyramidal-roof	c.1890	C
27067	909	House	Pyramidal-roof	c.1900	C
27068	911	House	Vernacular	c.1880	C
27069	913	House	Gable-front	c.1910	C
27070	925	Commercial bldg	Contemporary	1990	NC
South 3rd Street (West Side)					
27071	531	House	Bungalow	c.1920	C
27072	529	House	Bungalow	c.1920	C
27073	527	House	Shotgun	c.1900	C
27074	523	House	Hall-and-parlor	c.1900	C
27075	519	House	Bungalow	c.1920	C
27076	515	House	Queen Anne Cottage	c.1905	C
27077	511	House	Vernacular	c.1910	C
27078	503	House	Gabled-ell	c.1920	NC
27079	423	House	Central-passage	c.1900	C
27080	417	House	Queen Anne	c.1900	C
27081	415	House	Vernacular	c.1905	C
27082	411	Schotz House	Dutch Colonial	c.1912	C
27083	403	House	American four-square	c.1910	C
27084	313	House	I-house	c.1880	C
27085	309	Commercial bldg	Vernacular	c.1920	NC
27086	305	House	Bungalow	c.1925	C
27087	301	House	Bungalow	c.1925	C
27088	NA	Parking lot	NA	NA	NC
27089	NA	Clock	NA	NA	C
27090	19	Commercial bldg	Vernacular	c.1905	C
27091	15	Commercial bldg	Italianate	c.1895	C
27092	NA	Commercial bldg	Vernacular	c.1940	NC
North 3rd Street (East Side)					
27093	20	Commercial bldg	Vernacular	c.1945	NC
27094	NA	Parking lot	NA	NA	NC
27095	102	Commercial bldg	Contemporary	c.1965	NC
27096	NA	Parking lot	NA	NA	NC
27097	NA	Parking lot	NA	NA	NC
27098	210	Apartment Building	Craftsman	c.1905	C
27099	218	House	Free Classic	c.1905	C
27100	302	House	Bungalow	c.1920	C

Campbell & Osterhage, architects

27101 302	House	American four-square	1915	C
27102 304	House	American four-square	1915	C
27103 306	House	American four-square	1915	C
27104 308	House	American four-square	1915	C
27105 322	House	American four-square	1915	C
27106 326	House	American four-square	1915	C
27107 402	House	American four-square	1915	C
27108 406	House	Vernacular	c.1915	C
27109 410	House	Side-hall plan	c.1905	C
27110 416	House	Prairie	c.1930	C
27111 420	House	Gabled-ell	c.1950	NC
27112 506	Henry Cauthorn House	Italianate	1866	N
27113 520	House	Colonial Revival	c.1940	C
27114 522	House	Italianate	c.1875	C
27115 602-604	Apartment Building	Contemporary	c.1955	NC
27116 612	Benjamin Knirihm House	Central-passage	1876	C
27117 622	Dora Hackman House	Italianate	1880	C
27118 708	House	Queen Anne Cottage	c.1900	C
27119 712	House	Queen Anne Cottage	1900	C
27120 906	House	Gabled-ell	c.1910	C
27121 NA	Vacant lot	NA	NA	NC
27122 912	House	T-plan	c.1910	C
27123 914	House	T-plan	c.1910	C
27124 916	House	T-plan	c.1910	C
27125 928	House	Contemporary	c.1950	NC
South 3rd Street (East Side)				
27126 528	House	Contemporary	c.1890/c.1980	NC
27127 524	House	T-plan	c.1900	C
27128 520	House	Queen Anne Cottage	c.1890	C
27129 514	House	T-plan	c.1900	C
27130 510	House	Bungalow	c.1920	C
27131 506	House	Bungalow	c.1920	C
27132 502	House	Bungalow	c.1920	C
27133 420	John D. LaCroix House	Federal	c.1855/c.1938	N
27134 412	Jacob Cassell House	Side-hall plan/Greek Revival	1886	C
27135 314	John Decirie House	French Colonial	c.1867	O
27136 304	House	Central-passage/Federal	c.1840	N
27137 226	House	Queen Anne	c.1903	C
27138 222	House	Free Classic	c.1903	C
27139 216	House	Colonial Revival	c.1940	C
27140 118	House	Vernacular	c.1865	C
27141 104	Commercial bldg	Contemporary	c.1990	NC
27142 NA	Parking lot	NA	NA	NC
North 3rd Street (East Side)				
27143 NA	Parking lot	NA	NA	NC
27144 27	Commercial bldg	Vernacular	c.1900	C
27145 101	Commercial bldg	Contemporary	c.1965	NC
27146 NA	Parking lot	NA	NA	NC
27147 NA	Parking lot	NA	NA	NC
27148 201-203	Apartment Building	Contemporary	c.1970	NC
27149 217	Bowers-Lescher Sanitorium	Vernacular	c.1910	C
27150 221	House	American four-square	c.1910	C
27151 303	J. B. LaPlante House	Italianate	1888	C

Peter Sertel, builder

27152 307	J. B. LaPlante House	Queen Anne	1888	N	1888
27153 311	J. B. LaPlante House	Free Classic	1889	C	1889
27154 317	Charles LaPlante House	Queen Anne	1873	C	1873
27155 321	Charles LaPlante House	Free Classic	1893	C	1893
27156 329	Charles LaPlante House	Queen Anne	1893	C	1893
27157 401	P.E. LaPlante House	T-plan	c.1890	C	c.1890
27158 403	P.E. LaPlante House	T-plan	c.1890	C	c.1890
27259 411	House	Colonial Revival	c.1925	C	c.1925
27160 415	House	Contemporary	c.1980	NC	c.1980
27161 419	House	Prairie	c.1910	C	c.1910
27162 423	House	Ranch	c.1985	NC	c.1985
27163 429	House	Vernacular	c.1890	C	c.1890
27164 501	Henry V. Somes House	American four-square	1901	C	1901
27165 509	House	Pyramidal-roof	c.1910	NC	c.1910
27166 515	House	Cottage	c.1880	C	c.1880
27167 523	Duplex	Italianate	c.1875	C	c.1875
27168 611	House	Free Classic	c.1910	C	c.1910
27169 623	House	Gable-front	c.1900	C	c.1900
27170 709	House	Free Classic	c.1905	N	c.1905
27171 711	House	Bungalow	c.1915	C	c.1915
27172 803	Commercial bldg	Contemporary	c.1925/1985	NC	c.1925/1985
27173 NA	Parking lot	NA	NA	NC	NA
27174 903	Commercial bldg	Shotgun	c.1910	C	c.1910
27175 909	Commercial bldg	Ranch	c.1990	NC	c.1990
27176 911-915	Duplex	Vernacular	c.1910	C	c.1910
27177 917	House	Contemporary	c.1975	NC	c.1975
South 4th Street (West Side)					
27178 611	House	Vernacular	c.1960	NC	c.1960
27179 601	House	Bungalow	c.1935	C	c.1935
27180 533	House	Colonial Revival	c.1955	NC	c.1955
27181 527	House	Vernacular	c.1945	NC	c.1945
27182 NA	Vacant lot	NA	NA	NC	NA
27183 519	W. F. Holman House	I-house	c.1895	C	c.1895
27184 513	House	T-plan	c.1895	C	c.1895
27185 509	House	T-plan	c.1900	C	c.1900
27186 501	House	T-plan	c.1910	C	c.1910
27187 425	House	Gabled-ell	c.1910	C	c.1910
27188 421	House	Bungalow	c.1910	C	c.1910
27189 415	House	T-plan	c.1910	C	c.1910
27190 307	Apartment Building	Contemporary	c.1900	NC	c.1900
27191 235	House	Gable-front	c.1900	C	c.1900
27192 225	House	Vernacular	c.1910	C	c.1910
27193 219	House	Side-hall plan	c.1880	C	c.1880
27194 211	House	Ranch	c.1960	NC	c.1960
27195 207	Anton Kapps House	Vernacular	1886	C	1886
27196 NA	Parking lot	NC	NA	NC	NA
27197 NA	Park	NC	NA	NC	NA
27198 15	Commercial bldg	NC	c.1900	NC	c.1900
27199 7	Commercial bldg	NC	c.1900/1970	NC	c.1900/1970
North 4th Street (West Side)					
27200 18-30	Commercial bldg	Modern	c.1930/1970	NC	c.1930/1970
27201 102	Maxwell Showroom	Vernacular	1915	C	1915
27202 NA	Parking lot	NA	NA	NC	NA

Louis Osterhage, architect

27203	NA	Parking lot	NA	NC	NA	NC
27204	222	William Heberd House	Double-pem/Greek Revival	1863/1931	N	N
27205	NA	NiBlack Mansion Historical Marker	NA	1813-1834	C	C
27206	318	House	Gabled-ell	c.1915	C	C
27207	324	John T. Boyd House	Queen Anne	1898	N	N
27208	404	William J. Wise House	Federal/ Italianate	1859	O	O
27209	420	House	Dutch Colonial	c.1900	C	C
27210	422	Frank L. Oliphant House	Colonial Revival	1905	O	O
27211	424	House	Free Classic	c.1910	C	C
27212	430	John T. Oliphant House	Queen Anne Cottage	1911	N	N
27213	504	General Henry Knirihm House	Side-hall plan/italianate	c.1872	C	C
27214	514	House	American four-square	c.1910	C	C
27215	518	House	American four-square	c.1910	C	C
27216	528	House	Vernacular	c.1900	C	C
27217	612	House	Bungalow	c.1920	NC	NC
27218	614	House	Gable-front	c.1900	C	C
27219	622	House	Craftsman	c.1915	N	N
27220	704	House	Hall-and-parlor	c.1870	C	C
27221	708	House	Cottage	c.1900	C	C
27222	720	August Heinekamp house	Colonial Revival	c.1910	N	N
27223	804	House	Hall-and-parlor	c.1900	NC	NC
27224	814	House	American four-square	c.1910	C	C
27225	820	House	Gabled-ell	c.1900	C	C
27226	824	House	gable-front/Queen Anne	c.1900	C	C
27227	828	John Kilfoil house	Vernacular	1890	NC	NC
27228	608	House	Vernacular	c.1950	NC	NC
27229	604	House	Colonial Revival	c.1940	C	C
27230	534	House	Queen Anne Cottage	c.1890	C	C
27231	532	Commercial bldg	Vernacular	c.1900/1980	NC	NC
27232	530	House	Cottage	c.1900	C	C
27233	528	House	Gable-front	c.1890	C	C
27234	526	House	Cape Cod	c.1945	NC	NC
27235	514	House	T-plan	c.1880	NC	NC
27236	510	House	Bungalow	c.1920	C	C
27237	504	House	American four-square	c.1920	C	C
27238	422	Jacob Kuhn House	I-house	c.1870	N	N
27239	420	House	American four-square	c.1920	NC	NC
27240	418	House	American four-square	c.1920	NC	NC
27241	416	House	Bungalow	c.1920	C	C
27242	412	House	Bungalow	c.1920	C	C
27243	408	House	Bungalow	c.1920/1980	C	C
27244	404	House	Bungalow	c.1920/1980	NC	NC
27245	320	Gardner Undertaking Garage	Vernacular	1910	C	C
27246	236	House	Vernacular	c.1880/1980	NC	NC
27247	232	House	Vernacular	c.1880	C	C
27248	222	House	Central-passage	c.1850	C	C
27249	212	House	Bungalow	1910	N	N
27250	204	John Hartigan House	Eclectic	1898	O	O
27251	106	Commercial bldg	Vernacular	c.1965	NC	NC
27252	NA	Parking lot	NA	NA	NC	NC
27253	24	Commercial bldg	Vernacular	c.1880	NC	NC
27254	NA	Parking lot	NA	NA	NC	NC

Robert Laird, builder

South 4th Street (East Side)

Address	Property Name	Style	Year	Notes
27255 12	N. Smith & Sons Building	Neoclassical	c.1907	C
27256 17	Mrs. E.J. Loten Building	Neoclassical	1901	C
27257 19	Kixmiller Auto Showroom	Neoclassical	1919	C
27258 215	House	American four-square	c.1910	C
27259 303	Samuel Wise House	Side-hall plan	1839	N
27260 309	E. Clinton Reel House	Colonial Revival	c.1920	C
27261 315	House	American four-square	c.1910	C
27262 319	William E. Brown House	Greek Revival	1855/1936	N
27263 411	First Methodist Episcopal Church	Richardsonian Romanesque	1899/1918	O
27264 417	Office	Contemporary	1959	NC
27265 NA	Parking lot	NA	NA	NC
27266 503	Prosper Eluere House	Queen Anne	1886	N
27267 525	St. Rose Academy	Contemporary	1963	NC
27268 603	House	Queen Anne	c.1890/1970	NC
27269 609	House	Central-passage	c.1860/c.1920	NC
27270 NA	Parking lot	NA	NA	NC
27271 615	House	American four-square	c.1910	C
27272 623	Will Heinekamp House	Bungalow	c.1915	C
27273 703	House	Ranch	c.1970	NC
27274 707	House	Queen Anne Cottage	c.1900	C
27275 713	House	Gable-front	c.1900/c.1980	NC
27276 813	House	American four-square	c.1910	NC
27277 817	House	Vernacular	c.1870	NC
27278 821	House	Bungalow	c.1920	NC
27279 823	House	Bungalow	c.1920	C
27280 825	House	Bungalow	c.1920	C
27281 NA	Vacant lot	NA	NA	NC
27282 625	House	NA	c.1980	NC
27283 615	House	Indeterminate	c.1900/c.1980	NC
27284 529	House	Queen Anne	c.1890/c.1930	NC
27285 525	House	Queen Anne Cottage	c.1890	C
27286 NA	House	Bungalow	c.1920	C
27287 515	House	Hall-and-parlor	c.1860	C
27288 421-419	House	Vernacular	c.1890	C
27289 415	House	Cruciform	c.1910	NC
27290 409	House	Ranch	c.1960	NC
27291 403	House	T-plan	c.1880/c.1980	NC
27292 307	Commercial bldg	Contemporary	c.1970	NC
27294 303	House	T-plan	c.1890	NC
27295 229	House	Queen Anne Cottage	c.1890/1960	NC
27296 223	House	Queen Anne Cottage	c.1890/1960	NC
27297 219	House	American four-square	c.1910	C
27298 215	House	Craftsman	c.1910	NC
27299 NA	Parking lot	NA	NA	NC
27300 27	Commercial bldg	Vernacular	c.1900	NC
27301 26	Commercial bldg	Vernacular	c.1960	NC
27302 36	Commercial bldg	Contemporary	c.1930	NC
27303 102	Commercial bldg	Contemporary	c.1950	NC
27304 NA	Early Campus of Vincennes Historical marker	NA	1853-1953	C
27305 NA	Parking lot	NA	NA	NC

27306 NA	Commercial bldg	Art Moderne	c.1940	C	
27307 302	Otto Ritterskamp House	Dutch Colonial	c.1909	C	
27308 404	Henry Redelsheimer House	Free Classic	1910	C	
27309 408	House	Dutch Colonial	c.1920	N	
27310 414	House	Gable-front/ Greek Revival	c.1860	C	
27311 418	House	Free Classic	c.1905	O	
27312 422	John W. Gaddis House	Queen Anne	1890	N	John W. Gaddis , architect
27313 428	John Wilhelm House	Queen Anne Cottage	1887	N	Peter Sertel, builder
27314 NA	Parking lot	NA	NA	NC	
27315 602	St. John's Parsonage	Ranch	c.1960	NC	
27316 612	St. John School	Romanesque Revival	1903	N	
27317 NA	St. John School	Functional	1957	NC	
27318 622	St. John Evangelical United Brethren Church	Gothic Revival	1886/1935	O	John W. Gaddis, architect
27319 702	House	Free Classic	c.1900	N	
27320 708	House	Free Classic	c.1900	C	
27321 NA	Vacant lot	NA	NA	NC	
27322 802	House	American four-square	c.1910	nC	
27323 804	House	gable-front	c.1900	NC	
27324 808	House	American four-square	c.1910	C	
27325 810	House	Queen Anne Cottage	c.1880	NC	
27326 820	Catherine Goudy House	I-house/Greek Revival	1857	C	
37327 824	House	Bungalow	c.1920	NC	
27328 828	House	Bungalow	c.1920	C	
27329 NA	Vacant lot	NA	NA	NC	
27330 906	House	Double-pile	c.1900	C	
27331 910	Commercial bldg	Contemporary	c.1980	NC	
South 5th Street (East Side)					
27332 NA	Parking lot	NA	NA	NC	
27333 526	House	Vernacular	c.1890	C	
27334 520	Vacant lot	NA	NA	NC	
27335 512	House	Hall-and-parlor	c.1910	C	
27336 508	House	Free Classic	c.1905	NC	
27337 504	House	Queen Anne	c.1890	N	
27338 420	House	Greek Revival	c.1850	NC	
27339 416	Jacob Weissenbach House	Central-passage	1872	O	
27340 404	Frank Weiler House	Colonial Revival	1909	N	
27341 314	House	Vernacular	c.1920	NC	
27342 308	House	I-house	c.1870	C	
27343 232	House	American four-square	c.1910	C	
27344 226	House	Cottage	c.1880	C	
27345 222	House	Cruciform	c.1900	NC	
27346 214	House	Cruciform	c.1910	C	
27347 202	House	Vernacular	c.1960	NC	
27348 NA	Parking lot	NA	NA	NC	
27349 NA	Parking lot	NA	NA	NC	
North 5th Street (East Side)					
27350 101	Vincennes Presbyterian Church	Gothic Revival	1884/1899	O	John H. Stern & John W. Gaddis, architects
27351 NA	Tennis Court	NA	NA	NC	
27352 423	House	Bungalow	c.1945	NC	
27353 427	Eugene Hack House	Queen Anne	1888	O	
27354 NA	Parking lot	NA	NA	NC	
27355 607-609	Duplex	Contemporary	c.1960	NC	
27356 615	House	Ranch	c.1960	NC	



27357 713	House	American four-square	c.1920	C
27358 717	House	American four-square	c.1920	C
27359 723	House	Bungalow	c.1915	C
27360 805	House	Colonial Revival	c.1915	C
27361 809	House	American four-square	c.1900	C
27362 813	House	Gable-front	c.1900	C
27363 815	House	Hall-and-parlor	c.1860	C
27364 819	House	Gable-front	c.1865	C
27365 903	House	Double-pen	c.1860	C
South 6th Street (West Side)				
27366 801	Commercial bldg	Contemporary	c.1900	NC
27367 NA	Parking lot	NA	NA	NC
27368 527	House	Queen Anne Cottage	c.1890	C
27369 525	House	Queen Anne Cottage	c.1890	C
27370 521	House	Queen Anne Cottage	c.1890	C
27371 519	House	T-plan	c.1896	C
27372 501	Commercial bldg	Contemporary	c.1980	NC
27373 429	Commercial bldg	Contemporary	c.1980	NC
27374 NA	Parking lot	NA	NA	NC
27375 407	House	Bungalow	c.1900	NC
27376 405	House	Bungalow	c.1920	NC
27377 403	House	Bungalow	c.1920	NC
27378 313	House	Vernacular	c.1910	NC
27379 309	House	Craftsman	c.1910	NC
27380 303	House	Free Classic	c.1900	C
27381 227	Commercial bldg	Indeterminate	indeter.	NC
27382 223	House	Cottage	c.1900	NC
27383 219	House	Pyramidal-roof	c.1910	C
27384 211	House	Queen Anne	c.1900	C
27385 103	Citizen's Bank Of Vincennes	Contemporary	c.1980	NC
27386 29	Gas Station	Contemporary	c.1990	NC
North 6th Street (West Side)				
27387 122	Commercial bldg	Contemporary	c.1970	NC
27388 216	William P. Ritterskamp house	Queen Anne	1901	O
27389 222	House	T-plan	c.1880	C
27390 300	Clark Middle School	Collegiate Gothic	1927/1963	N
27391 400	Dr. George Von Knappe house	Romanesque Revival	1904	O
27392 408	House	Colonial Revival	1920	C
27393 414	C.H. DeBolt House	Queen Anne	1892	N
27394 424	Charles Bierhaus House	Queen Anne/Colonial Rev.	1894	O
27395 NA	Parking lot	NA	NA	NC
27396 602	William H. Vollmer House	Queen Anne	1909	N
27397 608	House	Free Classic	c.1910	C
27398 612	House	Gabled-ell	c.1910	C
27399 618	House	Queen Anne Cottage	c.1900	C
27400 622	Margaret Simpson house	Queen Anne Cottage	1898	C
27401 702	House	Italianate	c.1880	C
27402 708	House	Bungalow	c.1910	C
27403 710	L.B. Smith House	Second Empire Cottage	1877	C
27404 714	L.B. Smith House	Second Empire Cottage	1877	C
27405 722	House	Free Classic	c.1905	N
27406 810	House	T-plan	c.1895	C
27407 812	House	American four-square	c.1910	C

Thomas Campbell, architect

Samuel K. Hannaford, architect

Demo

27408	816	House	Gable-front	c.1900	C
27409	818	House	Gable-front	c.1900	C
27410	820	House	T-plan	c.1895	C
27411	822	House	T-plan	c.1895	C
27412	824	Commercial bldg	Contemporary	c.1995	NC
South 6th Street (East Side)					
27413	702	Commercial bldg	Vernacular	c.1930	C
27414	626	Commercial bldg	Vernacular	c.1920	C
27415	NA	Parking lot	NA	NA	NC
27416	NA	Parking lot	NA	NA	NC
27417	NA	hospital	Contemporary	c.1970	NC
27418	402	Commercial bldg	Italianate	c.1895/1961	C
27419	314	Erhard Bogner House	Gable-front	1877	C
27420	304	House	Cruciform	c.1900	C
27421	226	House	Gable-front	c.1880	C
27422	222	House	American four-square	c.1910	C
27423	NA	Parking lot	NA	NA	NC
27424	202	Commercial bldg	Contemporary	c.1970	NC
27425	NA	Parking lot	NA	NA	NC
27426	NA	Parking lot	NA	NA	NC
27427	102	Commercial bldg	Art Moderne	c.1940	C
27428	18	Commercial bldg	Contemporary	c.1990	NC
27429	14	Commercial bldg	Vernacular	c.1935	C
North 6th Street (East Side)					
27430	NA	Commercial bldg	Contemporary	c.1990	NC
27431	NA	Parking lot	NA	NA	NC
27432	NA	Parking lot	NA	NA	NC
27433	103	Commercial bldg	Contemporary	c.1994	NC
27434	117	House	Double-pile	c.1880	C
27435	211	Apartment Building	Contemporary	c.1975	NC
27436	215	House	Gable-front	c.1920	C
27437	221	House	Gabled-ell	c.1905	C
27438	223	J. S. Spiker House	Queen Anne	1909	C
27439	301	Clark Jr. High School	Neoclassical	1916	O
27440	421	Vincennes Fortnightly Club	Renaissance Revival	1928	O
27441	505	H.E. Peck-Joseph L. Bayard House	Italianate	c.1910	O
27442	521	House	Central-passage	c.1855	C
27443	603	House	Free Classic	c.1900	C
27444	609	House	Queen Anne	c.1910	N
27445	617	House	Queen Anne Cottage	c.1900	C
27446	619	House	American four-square	c.1910	C
27447	621	House	Gable-front	c.1890	C
27448	703	Duplex	Craftsman	1910	C
27449	709	House	American four-square	c.1910	C
27450	711	House	Gable-front	c.1900	C
27451	713	House	Bungalow	c.1925	C
27452	715	House	Bungalow	c.1920	C
27453	801	House	Free Classic	c.1915	C
27454	813	House	Free Classic	c.1915	C
27455	815	House	Queen Anne Cottage	c.1915	C
27456	819	House	Queen Anne	c.1915	C
27457	825	Miffin K. Thomas House	Queen Anne Cottage	c.1915	C
27458	827	House	I-house	c.1870/1894	C
			Central-passage	c.1860	C

John W. Gaddis, architect  
Lester Rouff, architect

27459 901	Commercial bldg	Functional	c.1970	NC
27460 911	House	Bungalow	c.1915	C
27461 913	House	Bungalow	c.1920	C
27462 927	Commercial bldg	Contemporary	c.1980	NC
South 7th Street (West Side)				
27463 711	House	Ranch	c.1960	NC
27464 625-621	Commercial bldg	Contemporary	c.1970	NC
27465 615	House	Gable-front	c.1920/1990	NC
27466 409	House	T-plan	c.1910	C
27467 NA	Parking lot	NA	NA	NC
27468 401	House	Bungalow	c.1925	C
27469 305	Apartment Building	Ranch	c.1965	NC
27470 303	House	Central-passage	c.1880	C
27471 227	House	American four-square	c.1920	C
27472 927	House	Contemporary	c.1960	NC
27473 NA	Parking lot	NA	NA	NC
27474 NA	Parking lot	NA	NA	NC
27475 NA	Parking lot	NA	NA	NC
27476 NA	Parking lot	NA	NA	NC
North 7th Street (West Side)				
27477 NA	Parking lot	NA	NA	NC
27478 NA	Parking lot	NA	NA	NC
27479 30	Planke Brothers Building	Neoclassical	c.1913	N
27480 102	Court House Annex	Contemporary	c.1970	NC
27481 112	Commercial bldg	Indeterminate	indeter.	NC
27482 114-116	C.G. McCord Building	Italianate	1902	C
27483 118	Commercial bldg	Vernacular	c.1960	NC
27484 120	Commercial bldg	Vernacular	c.1960	NC
27485 122	Commercial bldg	Vernacular	c.1960	NC
27486 124-132	Lazarus Noble Block	Vernacular	1869	C
27487 208	Commercial bldg	Vernacular	c.1930	NC
27488 NA	Parking lot	NA	NA	NC
27489 402	Hall Brothers Building	Italianate	1874	C
27490 404	Henry Hall Building	Italianate	1910	C
27491 406	Commercial bldg	Vernacular	c.1880	NC
27492 NA	Parking lot	NA	NA	NC
27493 502	Vincennes Public Library	Collegiate Gothic	1919	O
27494 502	Knox County Public Library	Contemporary	1978	NC
27495 614	C.P. McGrady House	Gothic Revival	1859	C
27496 622	Edward Watson House	Italianate	1878	O
27497 704	House	Prairie	c.1915	O
27498 720	House	Gabled-ell	c.1945	C
27499 722	John Matters House	Side-hall plan	1860	C
27500 804-806	Duplex	Italianate	c.1870	N
27501 812	House	Free Classic	c.1890	C
27502 820	Herman Wiegelt House	Vernacular	1883	C
27503 822	House	Ranch	c.1950	NC
27504 830	Commercial bldg	Indeterminate	c.1950/1970	NC
27505 902	Commercial bldg	Vernacular	c.1915	C
27506 NA	Commercial bldg	Vernacular	c.1945	C
27507 NA	Commercial bldg	Vernacular	c.1935	C
27508 NA	Parking lot	NA	NA	NC

Address	Property Name	Style	Year	Notes
27509 520	Good Samaritan Hospital	Contemporary	1971	NC
27510 302	LaSalle School	Collegiate Gothic	1927	N
27511 228	House	T-plan	c.1900	NC
27512 226	House	Queen Anne	c.1910	C
27513 218	House	Bungalow	c.1925	C
27514 214	House	Ranch	c.1950	NC
27515 120	House	Central-passage	c.1900	C
27516 114	House	Double-pen	c.1870	NC
27517 NA	Parking lot	NA	NA	NC
27518 NA	Commercial bldg	Gable-front	c.1900	NC
<b>North 7th Street (East Side)</b>				
27519 101	Knox County Courthouse	NA	1873-1874	O
27520 NA	Civil War Monument	NA	1861-1865	N
27521 NA	Ten Commandments Monument	NA	1958	NC
27522 211	House	Craftsman	c.1925	C
27523 311	House	Hall-and-parlor	c.1900	NC
27524 317	House	American four-square	c.1910	C
27525 NA	Parking lot	NA	NA	NC
27526 403	Allen McGrady House	Central-passage	c.1855	C
27527 409	House	Vernacular	c.1850/1910	C
27528 415	House	Colonial Revival	c.1915	C
27529 421	House	I-house/Federal	c.1840	N
27530 501	GAR Building	Vernacular	c.1900	C
27531 505	Commercial bldg	Vernacular	c.1950	NC
27532 511	Library Building	Vernacular	c.1960	NC
27533 519	Frederic Hall House	Gabled-ell	1888	C
27534 523	Commercial bldg	Vernacular	c.1940/1970	NC
27535 527	John H. Schulze Building	Italianate	1888	C
27536 603	House	Central-passage	c.1860	NC
27537 607	J.M. Clark House	Queen Anne	1892	C
27538 611	House	Queen Anne	c.1910	C
27539 617-619	Duplex	Vernacular	c.1895	C
27540 621	House	Craftsman	c.1920	C
27541 NA	Parking lot	NA	NA	NC
27542 709-711	House	Double-pen/Greek Revival	c.1860	C
27543 715	House	Queen Anne Cottage	c.1900	C
27544 801	House	Indeterminate	indeter.	NC
27545 805	House	Prairie	c.1920	C
27546 809-811	House	Double-pen	c.1930	C
27547 813-815	Jack Marsh Duplex	Vernacular	1883	C
27548 829	Commercial bldg	Contemporary	c.1975/1985	NC
27549 903	Commercial bldg	Contemporary	c.1975	NC
27550 917	Commercial bldg	Contemporary	c.1994	NC
27551 927	Joseph Risch Building	Vernacular	1903	C
27552 NA	Rotary Park Floral Urn	NA	1915	N
<b>South 8th Street (West Side)</b>				
27553 727	House	Hall-and-parlor	c.1900	C
27554 719	House	Shotgun	c.1900	C
27555 711	House	Colonial Revival	c.1930	C
27556 NA	Vacant lot	NA	NA	NC
27557 NA	Parking lot	NA	NA	NC
27558 NA	Medical Building	Vernacular	c.1940	C
27559 NA	Parking lot	NA	NA	NC

27560 231	House	Colonial Revival	c.1940	C
27561 223	House	Queen Anne	c.1915	C
27562 217	House	T-plan	c.1900	C
27563 215	House	Bungalow	c.1910	C
27564 209	House	Craftsman	c.1910	C
27565 207	House	American four-square	c.1910	C
27566 115	House	T-plan	c.1910	C
27567 111	House	Queen Anne Cottage	c.1910	C
27568 21	House	Queen Anne Cottage	c.1910	C
27569 17	House	Ranch	c.1965	NC
27570 9-13	Apartment Building	Contemporary	c.1990	NC
North 8th Street (West Side)				
27571 420	House	Vernacular	c.1935/1970	C
27572 504	House	Italianate	c.1874	N
27573 510	House	Gabled-ell	c.1910	C
27574 520	House	Central-passag	c.1886	C
27575 604	John Schulze House	Queen Anne	1901	C
27576 608	House	Central-passag	c.1870	N
27577 610	House	T-plan	c.1915	C
27578 618	House	Hall-and-parlor	c.1900	C
27579 702	Bethany Presbyterian Church	Gothic Revival	1907	O
27580 708	House	Gable-front	c.1915	C
27581 712	House	American four-square	c.1920	C
27582 716-718	Duplex	Pyramidal-roof	c.1910	C
27583 724	House	T-plan	c.1870/1890	C
27584 800	house	T-plan	1879	C
27585 808	house	Central-passag	c.1890	C
27586 812	House	Central-passag	c.1900	C
27587 818	House	Ranch	c.1965	NC
27588 824	House	Hall-and-parlor	c.1900	C
27589 828	House	Central-passag	c.1875	C
27590 NA	Vacant lot	NA	NA	NC
27591 908	House	Gabled-ell	c.1880	C
27592 912	House	Hall-and-parlor	c.1910	C
27593 916	House	Central-passag	c.1900	C
27594 922	House	Central-passag	c.1920	C
South 8th Street (East Side)				
27595 720	House	Vernacular	c.1870	NC
27596 712	House	Queen Anne	c.1900	C
27597 630	House	Colonial Revival	c.1940	C
27598 624	House	Colonial Revival	c.1935	C
27599 618	House	Colonial Revival	c.1935	C
27600 NA	Parking lot	NA	NA	NC
27601 NA	Parking lot	NA	NA	NC
27602 312	House	Vernacular	c.1900	NC
27603 308	House	Free Classic	c.1910	C
27604 304	House	Queen Anne Cottage	c.1900	C
27605 228	House	Ranch	c.1955	C
27606 222	House	Ranch	c.1950	NC
27607 218	House	Queen Anne Cottage	c.1905	C
27608 214	House	Side-hall plan	c.1870	N
27609 204	House	Vernacular	c.1900	C
27610 208	House	American four-square	c.1915	C

Address	Structure	Architectural Style	Year	Notes	Architect
27611 124	House	Queen Anne Cottage	c.1905		
27612 118	Joseph Hershey House	American four-square	1910		
27613 112	House	American four-square	c.1915		
27614 108	House	Contemporary	c.1980		
27615 102	House	Vernacular	c.1900		
<b>North 8th Street (East Side)</b>					
27616 3	Commercial bldg	Contemporary	1970		
27617 NA	Commercial bldg	Contemporary	1970		
27618 135	Knox County Law Enforcement Center	Contemporary	1982		Wayne & Larry Donovan . Architects
27619 147	Knox County Sheriff's Residence/ Jail	Romanesque Revival	1903		John W. Gaddis, architect
27620 NA	House	Queen Anne	c.1895		
27621 303	House	Ranch	c.1965		
27622 503	House	American four-square	1915		
27623 507	House	Cottage	c.1910		
27624 603	House	T-plan	c.1900		
27625 607	House	T-plan	c.1900		
27626 611	House	Double-pen	c.1900		
27627 617	House	Gable-front	c.1900		
27628 619	House	American four-square	c.1915/1994		
27629 703	St. John Lutheran School	Vernacular	c.1925/1958		
27630 707	St. John Evangelical Lutheran Church	Gothic Revival	1876		Wefel, architect
27631 803	House	I-house	c.1920		
27632 807	House	T-plan	c.1900/1965		
27633 813	House	I-house	c.1890		
27634 819	House	Gable-front	c.1880		
27635 823	House	Bungalow	c.1925		
27636 827	Henry Roesche House	Greek Revival	c.1865		
27637 903-905	Duplex	Double-pen	c.1890		
27638 909	House	Double -pen	c.1890		
27639 911	House	American four-square	c.1910		
27640 915	House	Double -pen	c.1890		
27641 917	House	Queen Anne Cottage	c.1900		
27642 923	August Kixmiller House	Queen Anne Cottage	1898		
<b>South 9th Street (West Side)</b>					
27643 741	House	Second Empire	c.1895		
27644 731	House	T-plan	c.1900		
27645 727	House	Gable-front	c.1905		
27646 725	House	T-plan	c.1900		
27647 709	House	T-plan	c.1895		
27648 703	House	Double-pen	c.1900		
27649 629	House	Ranch	c.1960		
27650 627	House	T-plan	c.1900/c.1965		
27651 617	House	Queen Anne Cottage	c.1900		
27652 615	House	Vernacular	c.1905/c.1945		
27653 601	House	Colonial Revival	c.1920		
27654 NA	Parking lot	NA	NA		
27655 425	House	Contemporary	c.1970		
27656 NA	Parking lot	NA	NA		
27657 401	House	Ranch	c.1980		
27658 311	House	Queen Anne	c.1900		
27659 225	House	Vernacular	c.1910		
27660 217	House	Queen Anne	c.1905		
27661 211	House	Queen Anne Cottage	c.1905		Demo

27662	207	House	Queen Anne Cottage	c.1905	C
27663	205	House	Ranch	c.1965	NC
27664	123	House	Vernacular	c.1900	C
27665	111	House	Central-passage	c.1900	C
27666	NA	Parking lot	NA	NA	NC
North 9th Street (West Side)					
27667	16	W.B. Robinson Carriage House	Vernacular	1879	C
27668	220	Commercial bldg	Vernacular	c.1920/c.1980	NC
27669	220	House	Vernacular	c.1905	C
27670	610	House	Bungalow	c.1930	C
27671	614	House	Gable-front	1920	C
27672	704	House	Ranch	c.1958	NC
27673	NA	playground	NA	NA	NC
27674	NA	Parking lot	NA	NA	NC
27675	802	Henry Knauth House	Bungalow	1923	N
27676	808	House	Bungalow	c.1915	C
27677	812	House	Bungalow	c.1915	C
27678	816	House	American four-square	c.1910	C
27679	820-820 1/2	House	Gable-front	c.1910	C
27680	824	House	Bungalow	c.1925	C
27681	828	House	Bungalow	c.1920	C
27682	902	House	Central-passage	c.1895	NC
27683	906	House	Vernacular	c.1910	C
27684	914	House	Hall-and-parlor	c.1895	NC
27685	916	House	Gabled-ell	c.1910	C
27686	918	House	Italianate	c.1880	C
27687	924	House	Bungalow	c.1920	C
South 9th Street (East Side)					
27688	NA	Vacant lot	NA	NA	NC
27689	736	House	T-plan	c.1880/c.1900	C
27690	730	House	Ranch	c.1900/1970	NC
27691	724	House	Ranch	c.1950	NC
27692	722	Alfred LaGros house	Queen Anne Cottage	1910	C
27693	630	House	Bungalow	c.1930	C
27694	626	House	Bungalow	c.1930	C
27695	620	House	T-plan	c.1900/c.1990	NC
27696	618	House	Gabled-ell	c.1910	C
27697	614	House	Queen Anne	c.1910	C
27698	610	House	American four-square	c.1910	C
27699	606	House	American four-square	c.1910	C
27700	602	House	American four-square	c.1910	C
27701	528	House	Queen Anne Cottage	c.1895	C
27702	514	House	Ranch	c.1965	NC
27703	510	House	Central-passage	c.1940	C
27704	NA	Vacant lot	NA	NA	NC
27705	416	House	Bungalow	c.1920/1994	NC
27706	414	House	Bungalow	c.1920	C
27707	412	House	Queen Anne	c.1905	C
27708	410	House	Queen Anne Cottage	c.1900/1970	NC
27709	402	House	Queen Anne Cottage	c.1900	C
27710	308	House	Bungalow	c.1925	NC
27711	304	House	American four-square	c.1920	C
27712	NA	park	NA	NA	NC

27713 16	House	Queen Anne	c.1895	N
27714 10-6	Commercial bldg	Vernacular	c.1950	NC
27715 4	Commercial bldg	Neoclassical	c.1925	C
North 9th Street (East Side)				
27716 17	House	Prairie	c.1920	C
27717 109	Commercial bldg	Vernacular	c.1920	NC
27718 115	House	Ranch	c.1965	NC
27719 215	House	American four-square	c.1915	C
27720 311	House	Bungalow	c.1925	C
27721 315	House	Gable-front	c.1915	C
27722 317	House	American four-square	c.1915	C
27723 413	House	Vernacular	c.1920	NC
27724 601	House	gable-front	c.1915	C
27725 607	House	Queen Anne Cottage	c.1905	C
27726 613	House	Vernacular	c.1905	NC
27727 621	Thomas Campbell House	Queen Anne	c.1910	C
27728 703	House	Bungalow	c.1925	C
27729 709	House	Greek Revival	c.1860	C
27730 713	House	Central-passag	c.1870/c.1920	C
27731 715	House	Vernacular	c.1910	NC
27732 721	House	Central-passag	c.1860/c.1910	C
27733 803	House	Hall-and-parlor	c.1910	C
27734 807	House	Double-pen	c.1910	C
27735 815	House	Gabled-ell	c.1915/c.1970	NC
27736 817	House	Central-passag	c.1895	C
27737 821	House	T-plan	c.1900	C
27738 829	House	Central-passag	c.1910	C
27739 903	House	Queen Anne Cottage	c.1900	C
27740 907	House	Gabled-ell	c.1900	C
27741 911	House	T-plan	c.1900	NC
27742 915	House	I-house	c.1900	C
27743 919	House	Gabled-ell	c.1880	C
27744 925	House	Central-passag	c.1880	C
South 10th Street (West Side)				
27745 749	House	T-plan	c.1900	C
27746 747	House	Queen Anne Cottage	c.1910	C
27747 737	House	Gabled-ell	c.1910	C
27748 735	House	Contemporary	c.1950	C
27749 717	House	Gable-front	c.1930	C
27750 715	House	Gable-front	c.1950	C
27751 713	House	Gable-front	c.1930	C
27752 711	House	Gable-front	c.1915	C
27753 709	House	Vernacular	c.1900	C
27754 707	House	Gable-front	c.1900	C
27755 631	House	Shotgun	c.1890	N
27756 619	House	Queen Anne Cottage	c.1900	C
27757 617	House	Vernacular	c.1900	C
27758 613	House	Shotgun	c.1875	N
27759 609	House	Shotgun	c.1875	N
27760 NA	Vacant lot	NA	NA	NC
27761 603	House	Shotgun	c.1905	NC
27762 531	House	Hall-and-parlor	c.1890/c.1915	C
27763 527	House	Bungalow	c.1925	NC



27764	523	House	Bungalow	c.1925	C
27765	519	House	Bungalow	c.1925	C
27766	515	House	Bungalow	c.1925	C
27767	511	House	Bungalow	c.1925	C
27768	507	House	Craftsman	c.1925	C
27769	503	House	Craftsman	c.1925	C
27770	429	House	Central-passage	c.1890/c.1920	C
27771	417	House	American four-square	c.1920/c.1990	C
27772	403	House	Double-pen	c.1930	C
27773	123	House	Bungalow	c.1915	C
27774	119	House	Bungalow	c.1920	C
27775	115	C.B. Goodwin House	American four-square	1918	C
27776	NA	Parking lot		NA	NC
North 10th Street (West Side)					
27777	102	House	Ranch	c.1950	NC
27778	114	House	Gabled-ell	c.1910/1965	C
27779	304	House	T-plan	c.1905/c.1920	NC
27780	308	House	Bungalow	c.1915	C
27781	312	House	Gabled-ell	c.1902/1990	C
27782	416	House	Indeterminate	c.1910	NC
27783	508	House	Shotgun	c.1900	NC
27784	604	House	Vernacular	c.1935	C
27785	608	House	Vernacular	c.1935	C
27786	612	House	Gabled-ell	c.1910	C
27787	616	House	T-plan	c.1910	C
27788	706	House	T-plan	c.1900	NC
27789	712	House	Hall-and-parlor	c.1915	C
27790	716	House	Central-passage	c.1910	C
27791	720	House	Central-passage	c.1910	NC
27792	802	Sarah M Clarke house	Italianate	1887	N
27793	810-808	Duplex	Double-pen	c.1920	NC
27794	812	House	Central-passage	c.1900	C
27795	822	House	Gabled-ell	c.1900/c.1980	C
27796	824	House	Gabled-ell	c.1900/c.1980	C
27797	826	House	Queen Anne Cottage	c.1890	C
27798	NA	Commercial bldg	Contemporary	c.1970	NC
South 10th Street (East Side)					
27799	632	House	Hall-and-parlor	c.1880/c.1920	C
27800	628	House	Queen Anne Cottage	c.1910	C
27801	NA	Vacant lot	NA	NA	NC
27802	612	House	Bungalow	c.1920	C
27803	608	House	Bungalow	c.1920	C
27804	NA	Vacant lot	NA	NA	NC
27805	NA	Vacant lot	NA	NA	NC
27806	526	House	Bungalow	c.1910	C
27807	NA	Vacant lot	NA	NA	NC
27808	516	House	Bungalow	c.1920	C
27809	512	House	Gable-front	c.1920/1995	C
27810	430	House	Bungalow	c.1925	C
27811	428	House	Bungalow	c.1925	C
27812	416	House	Bungalow	c.1925	C
27813	410	Commercial bldg	Vernacular	c.1900	C
27814	406	House	Queen Anne Cottage	c.1900	C

27815 404	House	Double-pen	c.1900	C
27816 402	Frank Krack Building	Vernacular	1897	C
27817 312	Apartment Building	Ranch	c.1950	NC
27818 216	House	T-plan	c.1905	C
27819 212	Apartment Building	Contemporary	c.1970	NC
27820 208	House	T-plan	c.1900	C
27821 204	House	Bungalow	c.1915	C
27822 128	House	Gable-front	c.1890/c.1915	C
27823 120-122	Duplex	American four-square	c.1920	C
27824 116	House	Gable-front	c.1930	C
27825 112	House	Gable-front	c.1915	C
27826 104	Gerhart Recker House	Gable-front	1874	N
27827 34	House	Central-passage	c.1900/c.1970	C
27828 26	House	Craftsman	c.1915	C
North 10th Street (East Side)				
27829 11	Commercial bldg	Functional	c.1960	NC
27830 13	Commercial bldg	Vernacular	c.1970	NC
27831 217	Apartment Building	Contemporary	c.1970	NC
27832 303	Apartment Building	Queen Anne	c.1910	NC
27833 307	House	T-plan	c.1910	C
27834 311	House	T-plan	c.1910	C
27835 317	House	T-plan	c.1910	N
27836 515	House	Central-passage	c.1915	C
27837 603	House	Queen Anne Cottage	c.1900	C
27838 607	House	Queen Anne Cottage	c.1880/1900	C
27839 611	House	Queen Anne Cottage	c.1880/1900	C
27840 621	House	Hall-and-parlor	c.1910	C
27841 623	House	Queen Anne Cottage	c.1900	C
27842 705	House	Vernacular	c.1920/c.1985	NC
27843 709	House	T-plan	c.1970/c.1950	C
27844 717	House	T-plan	c.1905	C
27845 805	House	Free Classic	c.1910	C
27846 811	House	Gabled-ell	c.1910	NC
27847 817-817 1/2	House	Gabled-ell	c.1905	NC
27848 823	House	Hall-and-parlor	c.1880	NC
27849 827	House	Double-pen	c.1880	NC
27850 NA	Vacant lot	NA	NA	NC
27851 913	House	Hall-and-parlor	c.1910	C
27852 917	House	Queen Anne Cottage	c.1910	C
27853 923	House	Gabled-ell	c.1910	NC
27854 925	Commercial bldg	Contemporary	c.1960	NC
South 11th Street (West Side)				
27855 635	House	Ranch	c.1960	NC
27856 633	House	Gable-front	c.1910	C
27857 NA	House	Bungalow	c.1925	C
27858 NA	Parking lot	NA	NA	NC
27859 NA	House	T-plan	c.1905	C
27860 523	House	T-plan	c.1910	C
27861 519	House	T-plan	c.1910	NC
27862 515	House	Gabled-ell	c.1935	C
27863 505	House	Vernacular	c.1940	NC
27864 217	House	Hall-and-parlor	c.1900	C

27865 608	House	Hall-and-parlor	c.1900	C
27866 612	House	Central-passage	c.1860	C
27867 624	House	Gable-front	c.1900	C
27868 704	House	T-plan	c.1900	C
27869 706	House	Vernacular	c.1955	NC
27870 710	House	Vernacular	c.1910	NC
27871 712	House	Ranch	c.1980	NC
27872 NA	Vacant lot	NA	NA	NC
27873 902	House	Gabled-ell	c.1900	C
27874 908	House	Gable-front	c.1900	NC
27875 914	House	Double-pen	c.1900	C
27876 918	House	Double-pen	c.1900	C
27877 922	House	Queen Anne Cottage	c.1900	C
27878 928	House	Hall-and-parlor	c.1880	C

YINCENNES HISTORIC DISTRICT  
 ADDITION DOCUMENTATION, 9/2013  
 KNOX CO. IN

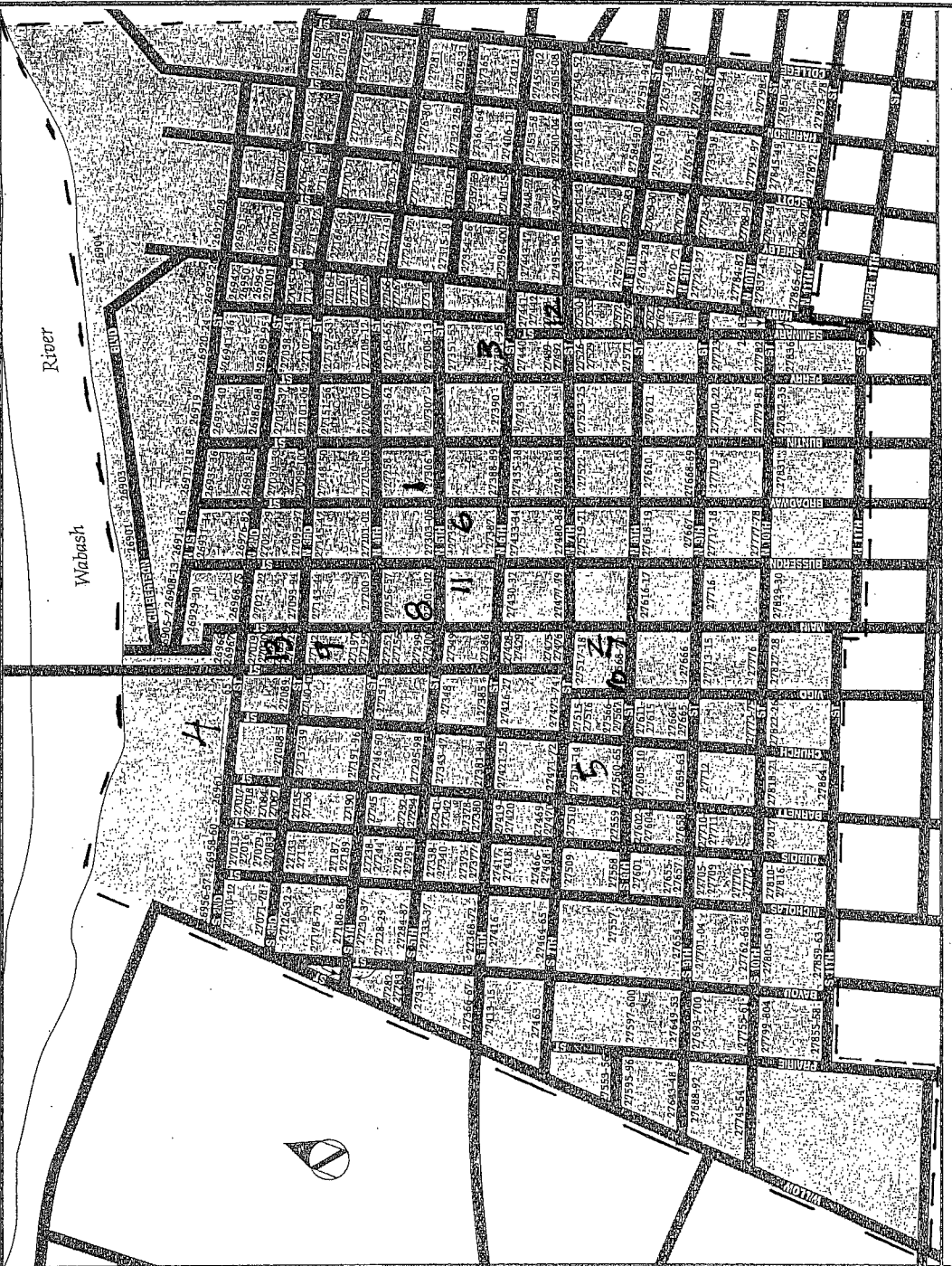

KEY.  
 --- BOUNDARY  
 (AS LISTED &  
 CURRENT)  
 3 PHOTO  
 LOCATION