

NEW AUGUSTA HISTORIC DISTRICT

INDIANAPOLIS, IN

A=16 564 790 4415100

B=16 565 280 4415140

C=16 565 440 4414780

D=16 564 850 4414740

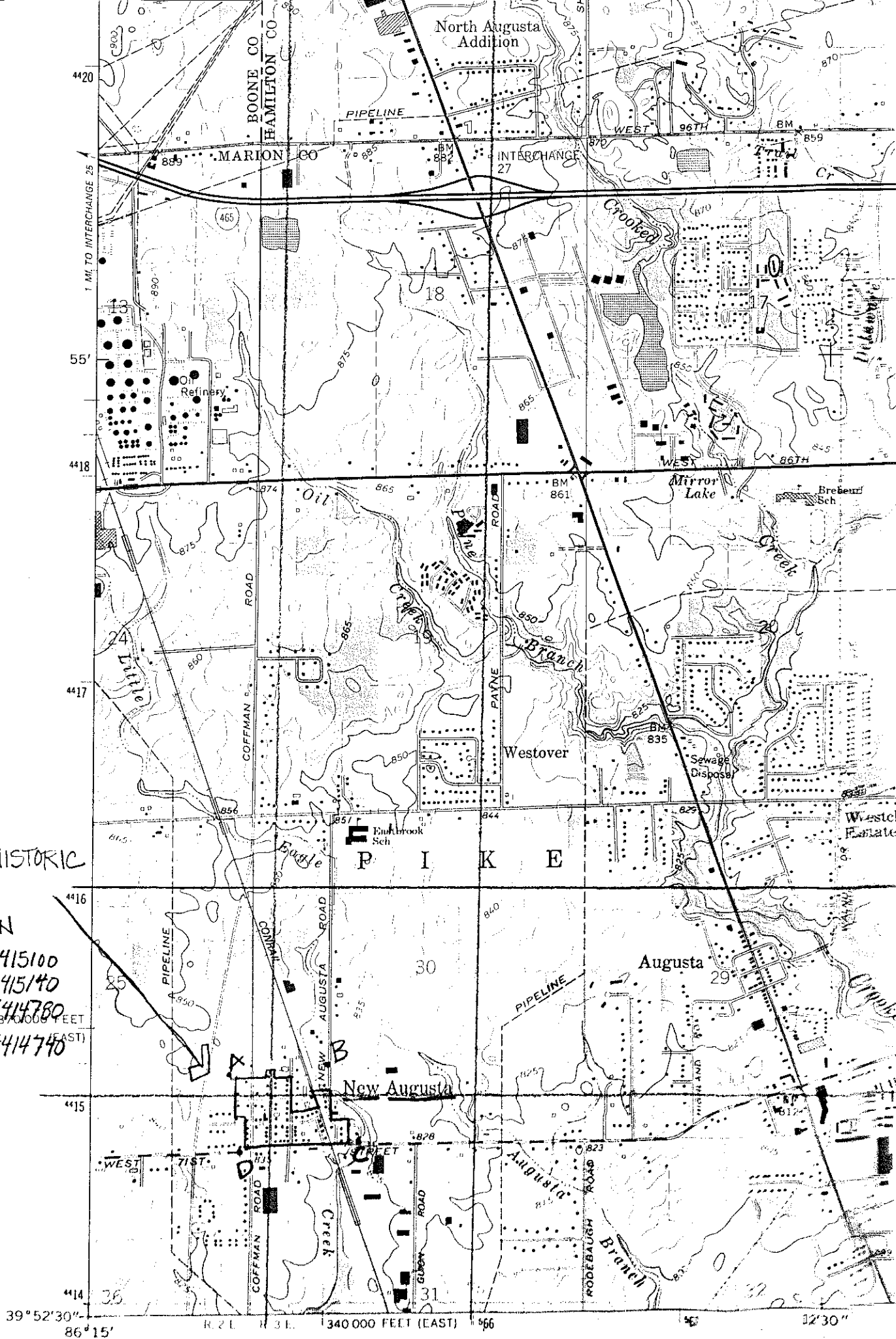

39° 52' 30" 86° 15' R. 2 E. T. 3 E. 340 000 FEET (EAST) 966 12' 30"

