

FINAL

STATE: HABS No. IND-84	
INDIANA	
COUNTY: Jefferson	
FOR NPS USE ONLY	
ENTRY NUMBER	DATE
	JUN 18 1973

NATIONAL REGISTER OF HISTORIC PLACES  
INVENTORY - NOMINATION FORM

(Type all entries - complete applicable sections)

1. NAME	
COMMON:	Jefferson County Jail
AND/OR HISTORIC:	Jefferson County Jail and Sheriff's House

2. LOCATION			
STREET AND NUMBER: "Courthouse Square," Corner of Main and Walnut streets.			
CITY OR TOWN: Madison			
STATE Indiana	CODE IN-18	COUNTY: Jefferson	CODE 077

3. CLASSIFICATION					
CATEGORY (Check One)	OWNERSHIP		STATUS	ACCESSIBLE TO THE PUBLIC	
<input type="checkbox"/> District <input type="checkbox"/> Site <input type="checkbox"/> Object	<input checked="" type="checkbox"/> Building <input type="checkbox"/> Structure <input type="checkbox"/> Object	<input checked="" type="checkbox"/> Public <input type="checkbox"/> Private <input type="checkbox"/> Both	Public Acquisition: <input type="checkbox"/> In Process <input type="checkbox"/> Being Considered	<input checked="" type="checkbox"/> Occupied <input type="checkbox"/> Unoccupied <input type="checkbox"/> Preservation work in progress	Yes: <input checked="" type="checkbox"/> Restricted <input type="checkbox"/> Unrestricted <input type="checkbox"/> No
PRESENT USE (Check One or More as Appropriate)					
<input type="checkbox"/> Agricultural <input type="checkbox"/> Commercial <input type="checkbox"/> Educational <input type="checkbox"/> Entertainment	<input checked="" type="checkbox"/> Government <input type="checkbox"/> Industrial <input type="checkbox"/> Military <input type="checkbox"/> Museum	<input type="checkbox"/> Park <input type="checkbox"/> Private Residence <input type="checkbox"/> Religious <input type="checkbox"/> Scientific	<input type="checkbox"/> Transportation <input type="checkbox"/> Other (Specify)	<input type="checkbox"/> Comments	

4. OWNER OF PROPERTY			
OWNER'S NAME: Jefferson County, Indiana			
STREET AND NUMBER: Courthouse, "Courthouse Square," Corner of Main and Jefferson street			
CITY OR TOWN: Madison	STATE: Indiana	CODE IN-18	

5. LOCATION OF LEGAL DESCRIPTION			
COURTHOUSE, REGISTRY OF DEEDS, ETC.: Recorder's Office, Courthouse, Jefferson County			
STREET AND NUMBER: Courthouse, Corner of Main and Jefferson streets.			
CITY OR TOWN: Madison	STATE: Indiana	CODE IN-18	

6. REPRESENTATION IN EXISTING SURVEYS			
TITLE OF SURVEY: Historic American Buildings Survey- Indiana			
DATE OF SURVEY: August 1971	<input checked="" type="checkbox"/> Federal	<input type="checkbox"/> State	<input type="checkbox"/> County <input type="checkbox"/> Local
DEPOSITORY FOR SURVEY RECORDS: Library of Congress, Division of Prints and Photographs			
STREET AND NUMBER:			
CITY OR TOWN: Washington	STATE: D.C.	CODE DC-11	

SEE INSTRUCTIONS

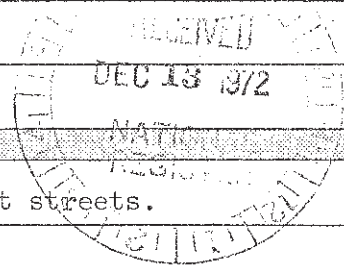

STATE: INDIANA  
 COUNTY: Jefferson  
 ENTRY NUMBER: JUN 18 1973  
 FOR NPS USE ONLY  
 DATE:

7 DESCRIPTION

CONDITION	(Check One)					
	<input type="checkbox"/> Excellent	<input checked="" type="checkbox"/> Good	<input type="checkbox"/> Fair	<input type="checkbox"/> Deteriorated	<input type="checkbox"/> Ruins	<input type="checkbox"/> Unexposed
	(Check One)			(Check One)		
	<input type="checkbox"/> Altered	<input checked="" type="checkbox"/> Unaltered		<input type="checkbox"/> Moved	<input checked="" type="checkbox"/> Original Site	

DESCRIBE THE PRESENT AND ORIGINAL (if known) PHYSICAL APPEARANCE

The Jefferson County Jail and Sheriff's House is located on the half block, "Courthouse Square," to the eastward of the Jefferson County Courthouse. A decorative fence of wrought iron originally enclosed the Courthouse and Jail. Now only the stone base of the fence remains.

The temple-like form of heavy masonry, virtually unchanged since its erection in the mid-nineteenth century, encloses the utilitarian jail block to the rear of the building with the Sheriff's residence in front, facing northward to Main Street. The two-storied front (north) facade is well proportioned with its classic pedimented gable, and the recessed and pilastered entrance of Greek Revival design. Exterior walls and cornice of the jail block are of massive ashlar masonry; the walls of the front residential section are of stuccoed brick with a cornice of wood. The west elevation is plain, penetrated with double-hung windows, simple transomed door to the jail entry, and high grilled windows of the jail block.

The interior trim and the stair of the front residential section are attractively designed, and were executed by skilled craftsmen.

The central cell block of the Jail, which is still in use, is massively built of solid ashlar stone, with eight small cells on each of the two levels. The ceiling-floor system above the lower cells is of 3/4" iron plate; the ceiling of the upper cells is of 8" stone slabs topped with 2 feet of rubble masonry fill. The inner entrance door to the jail block and the doors to the cells are grilles of wrought-iron straps. The cat walk for the upper tier of cells is built of iron straps and plate. In one cell there are large iron rings to which prisoners were apparently shackled.

SEE INSTRUCTIONS

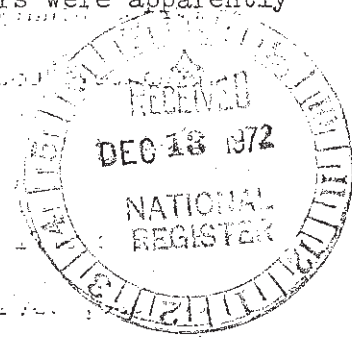

SEE INSTRUCTIONS

8. SIGNIFICANCE

PERIOD (Check One or More as Appropriate)

<input type="checkbox"/> Pre-Columbian	<input type="checkbox"/> 16th Century	<input type="checkbox"/> 18th Century	<input type="checkbox"/> 20th Century
<input type="checkbox"/> 15th Century	<input type="checkbox"/> 17th Century	<input checked="" type="checkbox"/> 19th Century	

SPECIFIC DATE(S) (If Applicable and Known) 1849-50

AREAS OF SIGNIFICANCE (Check One or More as Appropriate)

<input type="checkbox"/> Aboriginal	<input type="checkbox"/> Education	<input checked="" type="checkbox"/> Political	<input type="checkbox"/> Urban Planning
<input type="checkbox"/> Prehistoric	<input type="checkbox"/> Engineering	<input type="checkbox"/> Religion/Philosophy	<input type="checkbox"/> Other (Specify)
<input checked="" type="checkbox"/> Historic	<input type="checkbox"/> Industry		<input checked="" type="checkbox"/> Penal
<input type="checkbox"/> Agriculture	<input type="checkbox"/> Invention	<input type="checkbox"/> Science	
<input checked="" type="checkbox"/> Architecture	<input type="checkbox"/> Landscape	<input type="checkbox"/> Sculpture	
<input type="checkbox"/> Art	<input type="checkbox"/> Architecture	<input type="checkbox"/> Social/Humanitarian	
<input type="checkbox"/> Commerce	<input type="checkbox"/> Literature	<input type="checkbox"/> Theater	
<input type="checkbox"/> Communications	<input type="checkbox"/> Military	<input type="checkbox"/> Transportation	
<input type="checkbox"/> Conservation	<input type="checkbox"/> Music		

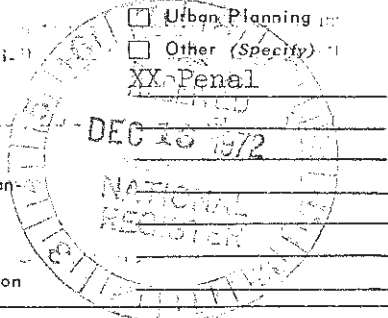

STATEMENT OF SIGNIFICANCE

The Jefferson County Jail was begun in 1848 and was completed in 1850, with a kitchen wing added in 1859. The jail block is still in use. This civic structure is remarkable on several counts:

- (1) Noteworthy is the architectural idea of containing in one huge pedimented volume a stuccoed brick house in the forepart, and a stone jail in the rear, giving the structure a suitably simplified yet imposing scale. Like its predecessor of 1835, the present jail--the fourth or fifth to sit on the same site--combines the Sheriff's House with the Jail in one structure. This is given a suitable civic expression with the large pedimented Sheriff's House fronting on Main Street and becoming a major supportant element to the Courthouse and the Courthouse Square--an important public space still framed by the 19th century commercial buildings.
- (2) Equally noteworthy is the architectural organization of the interior of the jail block; the scale suggests drawings by Piranesi through the combination of the two-tiered block of cells surrounded by the open high vaulted spaces whose illumination is from high grilled exterior windows. The sturdy ironwork at the windows, cell doors and locks, and the jail block entrance door are superbly worked and give both a fine scale to the interior, and concentrated patterns of detail against the otherwise unbroken surfaces of the large blocks of quarried stone.
- (3) The evidence of the actual workmanship, supported and explained by rather complete records and specifications, and of the sub-contractors and suppliers are in themselves an unusual record in the history of building technology. No name of a chief contractor, architect, or supervisor solely responsible is shown in the records but rather that of a practical approach to building, let out in various contracts to a series of carpenters, ironworkers, stone masons, and brick masons with local importance, demonstrated by the evidence of other of their surviving structures in the city and county environs. Chief among these were Robert McKim and James Falconer (Faulkner), stone masons; Patrick Dillon, John Kaufman (Coffman), and John Kirk, brick masons; Joseph Farnsworth, ironwork; John Torrence, locksmith; Abram Todd and Monroe W. Lee, carpenters; W. R. Davison, tinsmith; and F. E. Ouisse, glasier. Monroe W. Lee and John Kirk were also supervisors of the work on the Sheriff's House and the County Jail.

9. MAJOR BIBLIOGRAPHICAL REFERENCES

The following records are available in the Jefferson County Courthouse:  
 County Commissioner's Records, 1848 to 1850;  
 Perspective drawings of Courthouse (& Jail) 1854, by David Dufor.  
 In Madison & Jefferson County Public Library:  
 Old photo, undated;  
 "Items from Early Newspapers of Jefferson Co., Ind. 1817-1886," presented  
 by John Paul Chapter D. A. R., February 1945.  
 1971 written data from the Historic American Buildings Survey.

10. GEOGRAPHICAL DATA

LATITUDE AND LONGITUDE COORDINATES DEFINING A RECTANGLE LOCATING THE PROPERTY			OR	LATITUDE AND LONGITUDE COORDINATES DEFINING THE CENTER POINT OF A PROPERTY OF LESS THAN TEN ACRES		
CORNER	LATITUDE	LONGITUDE		LATITUDE	LONGITUDE	
	Degrees Minutes Seconds	Degrees Minutes Seconds		Degrees	Minutes	Seconds
NW	° ' "	° ' "		38°	44'	10"
NE	° ' "	° ' "		85°	22'	35"
SE	° ' "	° ' "				
SW	° ' "	° ' "				

APPROXIMATE ACREAGE OF NOMINATED PROPERTY: East 1/2 of "Courthouse Square," (.5 acre)

LIST ALL STATES AND COUNTIES FOR PROPERTIES OVERLAPPING STATE OR COUNTY BOUNDARIES

STATE:	CODE	COUNTY	CODE
Indiana	IN-18	Jefferson	077
STATE:	CODE	COUNTY:	CODE
STATE:	CODE	COUNTY:	CODE
STATE:	CODE	COUNTY:	CODE

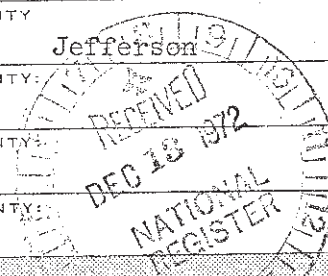

SEE INSTRUCTIONS

11. FORM PREPARED BY

NAME AND TITLE: Melvin M. Rotsch, Architect, Project Supervisor, Historic American Buildings Survey, and Philip H. Dole, Historian, same.

ORGANIZATION: Historic American Buildings Survey, National Park Service, Department of the Interior  
 DATE: July 1971

STREET AND NUMBER: Field Office: Box 393 (Old Junior High School Bldg.)

CITY OR TOWN: Madison  
 STATE: Indiana  
 CODE: IN-18

12. STATE LIAISON OFFICER CERTIFICATION

As the designated State Liaison Officer for the National Historic Preservation Act of 1966 (Public Law 89-665), I hereby nominate this property for inclusion in the National Register and certify that it has been evaluated according to the criteria and procedures set forth by the National Park Service. The recommended level of significance of this nomination is:

National  State  Local

Name: N. Donald Dwyer  
 Title: State Liaison Officer  
 Date: 12-6-72

NATIONAL REGISTER VERIFICATION

I hereby certify that this property is included in the National Register.

Robert M. Utley  
 Chief, Office of Archeology and Historic Preservation

Date: 6/18/73

ATTEST:  
Robert M. Utley  
 Keeper of The National Register  
 Date: June 5, 1973

NATIONAL REGISTER OF HISTORIC PLACES

INVENTORY - NOMINATION FORM

8. Significance  
page 2

(Continuation Sheet)

STATE HABS No. IND-84	
INDIANA	
COUNTY	
Jefferson	
FOR NPS USE ONLY	
ENTRY NUMBER	DATE
	JUN 18 1973

(Number all entries)

- (4) The survival of this remarkable structure is noteworthy in itself, but it is now in jeopardy. It has been condemned recently as a penal institution, and only a shortage of funds has delayed its replacement with a more modern facility. There are citizens of the community who hope to see this venerable building preserved while proposing that a new jail facility be constructed elsewhere.

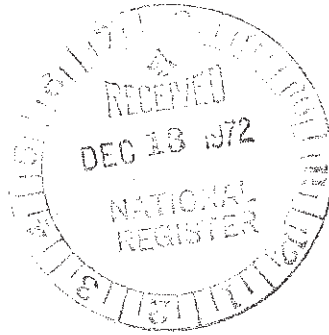

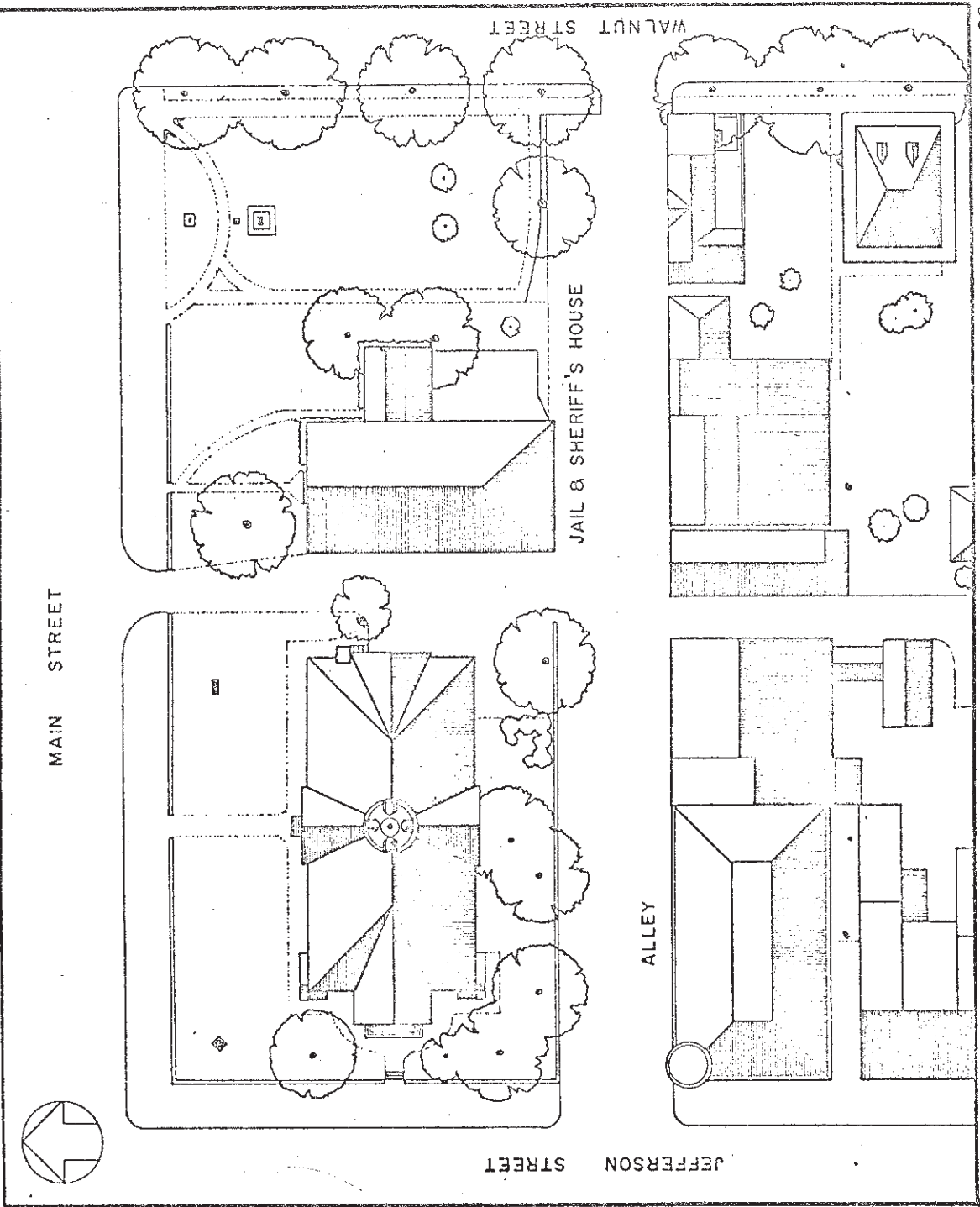

SCALE: 1" = 60'

JEFFERSON COUNTY JAIL & SHERIFF'S HOUSESITE PLAN  
 Madison, Indiana

DEC 18 1972  
 NATIONAL REGISTER

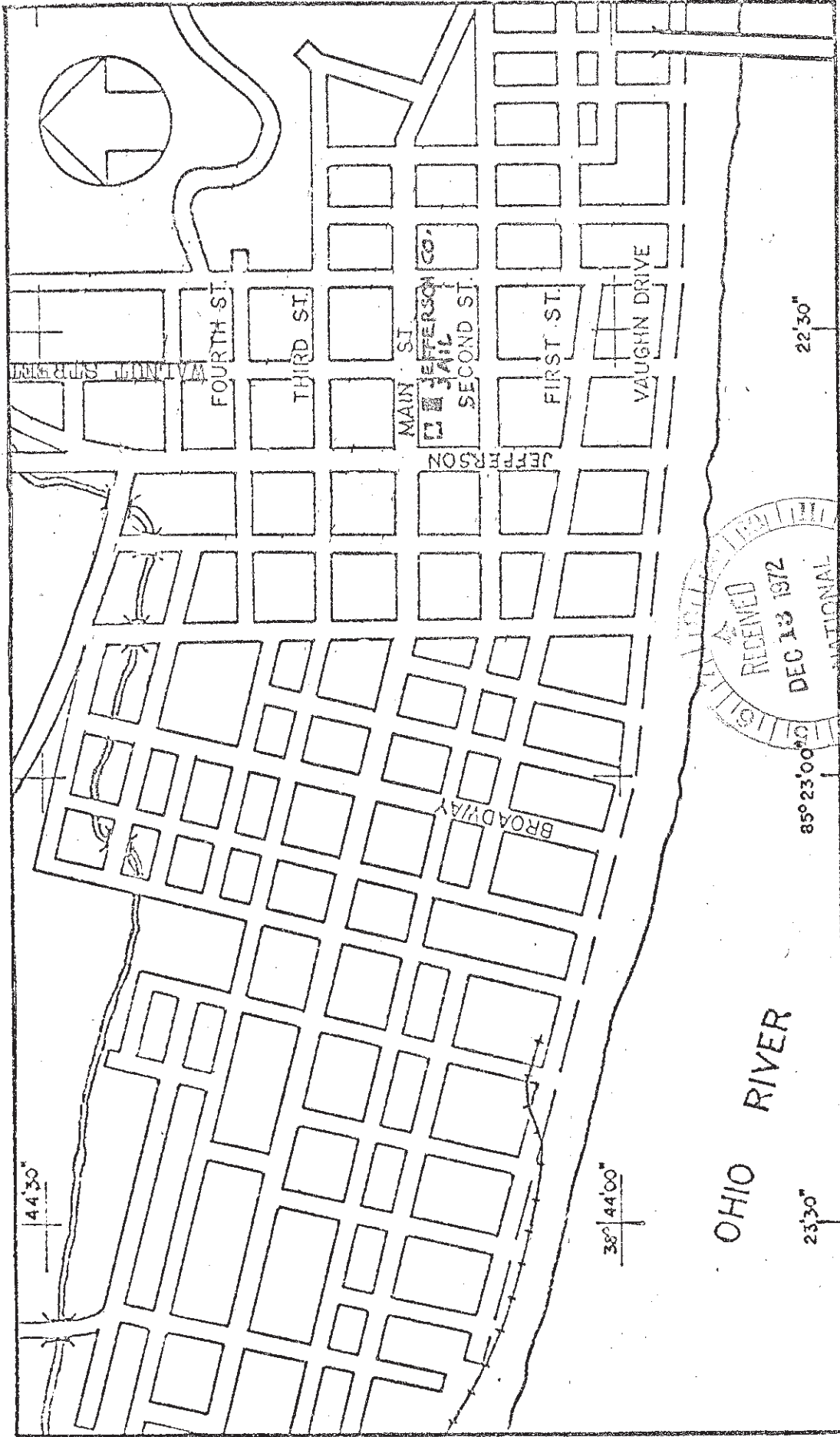

SCALE: 1" = 800'



RECEIVED  
 DEC 13 1972  
 NATIONAL REGISTER

MADISON, INDIANA

OHIO RIVER

MAP PREPARED BY THE HISTORIC AMERICAN BUILDINGS SURVEY, 1971  
 adapted from U.S. Department of Interior Geological Survey, Madison Quad. (E&W) 1964