

United States Department of the Interior
National Park Service

National Register of Historic Places
Registration Form

This form is for use in nominating or requesting determinations for individual properties and districts. See instructions in How to Complete the National Register of Historic Places Registration Form (National Register Bulletin 16A). Complete each item by marking "x" in the appropriate box or by entering the information requested. If an item does not apply to the property being documented, enter "N/A" for "not applicable." For functions, architectural classification, materials, and areas of significance, enter only categories and subcategories from the instructions. Place additional entries and narrative items on continuation sheets (NPS Form 10-900a). Use a typewriter, word processor, or computer, to complete all items.

1. Name of Property

historic name Otis Park & Golf Course

other names/site number

2. Location

street & number Tunnelton Road N/A not for publication

city or town Bedford N/A vicinity

state Indiana code IN county Lawrence code 093 zip code 47421

3. State/Federal Agency Certification

As the designated authority under the National Historic Preservation Act, as amended, I hereby certify that this nomination request for determination of eligibility meets the documentation standards for registering properties in the National Register of Historic Places and meets the procedural and professional requirements set forth in 36CFR Part 60. In my opinion, the property meets does not meet the National Register criteria. I recommend that this property be considered significant nationally statewide locally. (See continuation sheet for additional comments.)

Signature of certifying official/Title

Date

Indiana Department of Natural Resources

State or Federal agency and bureau

10.25.02

In my opinion, the property meets does not meet the National Register criteria. (See continuation sheet for additional comments.)

Signature of certifying official/Title

Date

State or Federal agency and bureau

4. National Park Service Certification

I hereby certify that the property is:

Signature of the Keeper

Date of Action

entered in the National Register.
 See continuation sheet.

determined eligible for the
National Register
 See continuation sheet.

determined not eligible for the
National Register

removed from the National Register

other, (explain:)

Otis Park & Golf Course
Name of Property

Lawrence IN
County and State

5. Classification

Ownership of Property

(Check as many boxes as apply)

- private
- public-local
- public-State
- public-Federal

Category of Property

(Check only one box)

- building
- district
- site
- structure
- object

Number of Resources within Property

(Do not include previously listed resources in the count)

Contributing	Noncontributing	
5	5	buildings
4	1	sites
8	0	structures
5	0	objects
22	6	Total

Name of related multiple property listing

(Enter "N/A" if property is not part of a multiple property listing.)

N/A

Number of contributing resources previously listed in the National Register

0

6. Function or Use

Historic Functions

(Enter categories from instructions)

RECREATION/CULTURE Music Facility
RECREATION/CULTURE Outdoor Recreation
LANDSCAPE: Street
LANDSCAPE: Park
RECREATION/CULTURE Sports Facility

Current Functions

(Enter categories from instructions)

RECREATION/CULTURE: Music Facility
RECREATION/CULTURE: Outdoor Recreation
LANDSCAPE: Street Furniture/Object
LANDSCAPE: Park
RECREATION/CULTURE: Sports Facility

7. Description

Architectural Classification

(Enter categories from instructions)

19th & 20th c. REVIVALS: Classical Revival
19th & 20th c. AMER.: Bungalow/Craftsman
OTHER: Works Progress

Materials

(Enter categories from instructions)

foundation CONCRETE
walls STONE: Limestone
roof METAL
other WOOD

Narrative Description

(Describe the historic and current condition of the property on one or more continuation sheets.)

8. Statement of Significance

Applicable National Register Criteria

(Mark "x" in one or more boxes for the criteria qualifying the property for National Register listing.)

- A** Property is associated with events that have made a significant contribution to the broad patterns of our history.
- B** Property is associated with the lives of persons significant in our past.
- C** Property embodies the distinctive characteristics of a type, period, or method of construction or represents the work of a master, or possesses high artistic values, or represents a significant and distinguishable entity whose components lack individual distinction.
- D** Property has yielded, or is likely to yield, information important in prehistory or history.

Criteria Considerations

(Mark "x" in all the boxes that apply.)

Property is:

- A** owned by a religious institution or used for religious purposes.
- B** removed from its original location.
- C** a birthplace or grave.
- D** a cemetery.
- E** a reconstructed building, object, or structure.
- F** a commemorative property.
- G** less than 50 years of age or achieved significance within the past 50 years.

Narrative Statement of Significance

(Explain the significance of the property on one or more continuation sheets.)

Areas of Significance

(Enter categories from instructions)

ARCHITECTURE _____
 ENTERTAINMENT/RECREATION _____
 SOCIAL HISTORY _____

Period of Significance

1923-1952 _____

Significant Dates

1923 _____
 1937 _____

Significant Person

(Complete if Criterion B is marked above)

Cultural Affiliation

Architect/Builder

Pearson, Henry _____
 Cezar, Joe _____

9. Major Bibliographic References

Bibliography

(Cite the books, articles, and other sources used in preparing this form on one or more continuation sheets.)

Previous documentation on file (NPS):

- preliminary determination of individual listing (36 CFR 67) has been requested
- previously listed in the National Register
- previously determined eligible by the National Register
- designated a National Historic Landmark
- recorded by Historic American Buildings Survey # _____
- recorded by Historic American Engineering Record # _____

Primary location of additional data:

- State Historic Preservation Office
- Other State agency
- Federal agency
- Local government
- University
- Other

Name of repository:

Lawrence Co. Courthouse, City of Bedford

10. Geographical Data

Acreage of Property 145 acres

UTM References

(Place additional UTM references on a continuation sheet.)

1 16 546560 4301230
Zone Easting Northing

3 16 547760 4301330
Zone Easting Northing

2 16 546890 4301340
Zone Easting Northing

4 16 547770 4300680
Zone Easting Northing

See continuation sheet

Verbal Boundary Description

(Describe the boundaries of the property on a continuation sheet.)

Boundary Justification

(Explain why the boundaries were selected on a continuation sheet.)

11. Form Prepared By

name/title Jennifer Anderson, Mary Margaret Stipp, Amy Walker
organization Historic Preservation Committee of Bedford Revitalization, Inc; DHPA date 02-10-2001
street & number 919 14th St. telephone (812) 275-8047
city or town Bedford state IN zip code 47421

Additional Documentation

Submit the following items with the completed form:

Continuation Sheets

Maps

- A USGS map (7.5 or 15 minute series) indicating the property's location.
- A Sketch map for historic districts and properties having large acreage or numerous resources.

Photographs

Representative black and white photographs of the property.

Additional items

(Check with the SHPO or FPO for any additional items)

Property Owner

(Complete this item at the request of SHPO or FPO.)

name City of Bedford
street & number City Hall; 1102 16th St. telephone 812/ 275- 6555
city or town Bedford state IN zip code 47421

Paperwork Reduction Act Statement: This information is being collected for applications to the National Register of Historic Places to nominate properties for listing or determine eligibility for listing, to list properties and to amend existing listings. Response to this request is required to obtain a benefit in accordance with the National Historic Preservation Act, as amended (16 U.S.C. 470 et seq.).

Estimated Burden Statement: Public reporting burden for this form is estimated to average 18.1 hours per response including time for reviewing instructions, gathering and maintaining data, and completing and reviewing the form. Direct comments regarding this burden estimate or any aspect of this form to the Chief, Administrative Services Division, National Park Service, P.O. Box 37127, Washington, DC 20013-7127; and the Office of Management and Budget, Paperwork Reductions Projects (1024-0018), Washington, DC 20503.

**United States Department of the Interior
National Park Service**

**National Register of Historic Places
Continuation Sheet**

Section number 7 Page 1

Otis Park & Golf Course
Bedford, Lawrence County, Indiana

Narrative Description

Otis Park and Golf Course, a city-owned recreation district located at the east city limits of Bedford, encompasses nearly 150 acres and features a collection of historic limestone structures from the early 20th century reflecting Craftsman and Neo-Classical architecture. It lies between Leatherwood Road and Tunnelton Road and is roughly a pie-shaped wedge. The property began as the farm of William A. Ragsdale and his house is still a part of the property, although today it is known as Pine Hall. Due to its much earlier Period of Significance, a separate nomination has been written for that small parcel of the overall complex. Otis Park and Golf Course was acquired by the city of Bedford in 1935 as a gift from Fred B. Otis, a Bedford newspaperman. The majority of the construction on the grounds occurred between 1937 and 1941 and was funded with grants from the Works Progress Administration (WPA).

There are a total of 23 contributing resources within the park. These include five contributing buildings (bathhouse, clubhouse, restroom, shelter house, and stone shed), four contributing sites (tennis courts, baseball field, golf course, and rock garden), ten contributing structures (two bridges, four picnic shelters, band shell, and gazebo), and six contributing objects (the entry gates and four sections of rock wall). The non-contributing features include five buildings (three storage buildings, the concession stand, and the restrooms) and one site (the playground).

The main entrance into Otis Park is located at the northwest corner off of Tunnelton Road. There is a random ashlar **stone wall** that extends along most of the parkland abutting Tunnelton and Leatherwood Roads (Photos 1 and 2). The stone wall was made of small boulders gathered from Leatherwood Creek, the creek that runs through the property. The wall, built by two Irish immigrants, is believed to be the first of its kind built in south central Indiana. This wall was extended throughout the park as part of work done with WPA grants. Flanking either side of the main drive are two four-foot square running bond **limestone piers**, each topped with a limestone sculpture of a golf ball (Photo 3). These were constructed with post-1937 on poured concrete foundations. . On the back of the one on the left, inscribed with "Otis," is a tablet detailing the acquisition of the land by Fred Otis in 1935 and its gift to the city for the people of Bedford. On the back of the column on the right, the one inscribed with "Park," is a chronology of Pine Hall from its construction in 1867 to the period it was owned by the Bedford Country Club.

Two **bridges** with double metal arches were constructed across Leatherwood Creek using irregular shaped pieces of local limestone in random ashlar design with regular courses (Photo 4). The sides of the bridges are topped with irregular pieces of similarly sized stone placed vertically, giving a picket effect. Ten thousand feet of ornamental rock fences were built and rebuilt in similar fashion within the park complex.

The Otis Park **band shell** (built 1939 in the Neo-Classical style), a formidable structure paralleling Tunnelton Road in the northwest corner of the park, was planned by Indiana WPA engineers and is the only band shell of its kind in the nation built by the WPA. A foundation of solid rock supports the hundreds of tons of Indiana buffstone walls which are approximately two stories high (Photos 5 and 6).

United States Department of the Interior
National Park Service

National Register of Historic Places
Continuation Sheet

Section number 7 Page 2

Otis Park & Golf Course
Bedford, Lawrence County, Indiana

Narrative Description-continued

All of the stone, some pieces weighing as much as three-fourths of a ton, was cut by hand and a special pattern was used for the placement of the stones in the shell's six sweeping, tiered self-supporting arches. The proscenium arch is simple but the center point is denoted with a scrolled keystone. In each corner above the radiating arches is a Grecian figure in profile playing the lyre. At each side of the arches are two limestone Doric columns, handcarved by WPA artisans, complete with dentilated cornice and triglyphs and metopes (Photo 7). The stage area is 56' wide. At each end of the stage front is a pier, topped with a limestone urn (Photo 8). The 25'6" back wall is made of running bond limestone.

On the north side of the main drive is a **rock garden** that was also a part of the WPA building campaign. There are a series of random ashlar limestone levels that follow the natural topography of the land. A variety of plants and flowers have been interspersed among the levels. (Photo 9).

Beyond the rock garden is a cluster of buildings that include contributing WPA-era buildings in the Craftsman style and one non-contributing modern storage building. The contributing buildings on the south side of the drive are the bathhouse and the clubhouse. The **bathhouse** was constructed post-1937 with WPA funds (Photo 10). It has a concrete foundation, random ashlar limestone walls, and a metal seam roof. The corners of the building are offset with smooth faced limestone quoins. At the center of the building are three doorways, all outlined with smooth faced limestone quoins. The center door is lower than the others but is crowned with a panel reading "Otis Park Pool". The two easternmost doors have been covered with wood and the third contains a modern metal door. The majority of the windows are set high into the wall and have smooth faced limestone sills and lintels. A series of modern lighting fixtures rise from the roof of the building. The 1928 pool was removed in 1984 so the use of the bathhouse has been relegated to storage. All are clad in random ashlar limestone.

Like the bathhouse, the **clubhouse** was constructed by the WPA on a concrete foundation with limestone walls and a metal seam roof (Photo 11). The windows here are fairly small and have smooth faced limestone sills and lintels. There are also decorative limestone features on the projecting stone fireplace. Despite the fact that the clubhouse has been added onto, it is still a contributing feature within Otis Park.

Located below the grade of the main drive are two smaller buildings that overlook Leatherwood Creek. One is the **stone shed** and the other contained **restrooms** (Photo 12). Both buildings follow the pattern of construction that was established on the other side of the road: concrete foundation with random ashlar limestone walls. They also have quoins that mimic those of the bathhouse. The stone shed currently has an asphalt shingle roof. The roof of the restroom building reflects the construction of the bridges and the stone walls with the placement of irregular pieces of similarly sized stone placed vertically, resulting in a jagged finish to the roofline. These buildings were also a part of the post-1937 building campaign.

As the road continues past the cluster of buildings, it curves to the southeast and gradually turns northeast past the tennis courts and baseball field (both contributing) and the non-contributing concession stand, restrooms, and playground. It is unknown when the **tennis courts** and **baseball field** were constructed

**United States Department of the Interior
National Park Service**

**National Register of Historic Places
Continuation Sheet**

Section number 7 Page 3

Otis Park & Golf Course
Bedford, Lawrence County, Indiana

Narrative Description-continued

(Photo 13). However the construction of these facilities were stipulations in Fred Otis' donation of the property in circa 1937 and WPA workers built the baseball diamond and bleachers.

Farther along the drive on the north slope are four limestone **picnic shelters** with fireplaces all built in 1938 by WPA workers. Elliptical in shape, each measures 44' x 43' (Photos 14 and 15). They were built of random ashlar stone with steps and walls encircling stone floors. Smooth limestone caps the walls, stepped railings, fireplaces, and chimneys. The picnic benches in each area are also constructed of limestone.

Reaching the east boundary of the park and overlooking the golf course at its highest point is a Craftsman style **shelter house** (post-1937). Built on a concrete foundation with random ashlar limestone walls and an asphalt shingle roof, the shelter house has a gabled roof and a fireplace at each end (Photo 16). Measuring 73' x 28', the building features a columned porch (73' x 15') on the west side with a center gable and steps leading down to toward the golf course. Additional steps are located on one end and a handicapped accessible ramp is on the opposite end. The main portion of the building is veneered in random ashlar limestone with quoins, as is a lean-to on the back at the south end. Porch columns and railings along the steps are random ashlar limestone, and limestone fashions both the interior and porch floors. The building was originally an open-air facility, but in recent years wooden doors and window shutters have been added so the structure can be locked and secured. The shelter house overlooks the 13th green (Photo 17).

The last of the WPA era buildings in the park is the Craftsman style **gazebo** that is located along the western edge of the park, near to Pine Hall (Photo 18). Constructed of limestone, it measures 7' x 14'8" and features four limestone columns and is enclosed on three sides by limestone paneled walls supporting a wood-structured hipped roof with exposed rafter tails. It was constructed after 1937. Inside the gazebo there are limestone bullnosed benches attached to the three walls.

The original 9-hole **golf course** (Photo 19), built in 1923, became an 18-hole course in 1937. Over the next few years it was lengthened and the par was increased to 72.

**United States Department of the Interior
National Park Service**

**National Register of Historic Places
Continuation Sheet**

Section number 8 Page 1

Otis Park & Golf Course
Bedford, Lawrence County, Indiana

Statement of Significance

Otis Park and Golf Course, a nearly 150-acre complex at the east edge of Bedford city limits, has played a significant role for more than 135 years in the history of Lawrence County. Following the organization of Lawrence County in 1818, the site featured prominently as a farm until its conversion to a golf course in 1923. The property originally consisted of an 1865 Italianate mansion and the accompanying agricultural fields. Due to its much earlier period of significance, the William A. Ragsdale mansion is being nominated to the National Register of Historic Places separately. Otis Park and Golf Course is eligible for the National Register of Historic Places under Criterion A for its value to the Bedford community in the areas of entertainment/recreation and social history and under Criterion C because of its WPA era designed features which exemplify limestone construction in the Neo-Classical and Craftsman styles.

The land on which Otis Park is located is in Shawswick Township, one of five townships created when Lawrence County was organized in 1818. At that time, Shawswick Township was considered the most important township because of its centralized location within the county--between the East Fork of the White River to the south and the second most important county creek, Salt Creek, to the west. Flowing from northeast to southwest through the township was Leatherwood Creek, along which lay prime farmland. The topography west to east ranged from gently sloping to strongly sloping—2 to 20 percent. This area was later known as Leatherwood District and was famous for abundant harvests and prosperous farmers. This is the area that William A. Ragsdale decided to settle in 1865.

In 1865 William A. Ragsdale, one of the wealthiest farmers and largest landowners in the county, decided to build a home in Shawswick Township. He and his wife selected a site overlooking Leatherwood Creek at the west edge of their 750 acres for a 10-room, two-story Italianate-style mansion. Due to financial problems Mr. Ragsdale was forced to divide his land holdings and in 1875 Nathan Hall, a local stonecutter known as the "Father of Indiana Limestone," purchased 197 acres including the mansion at a sheriff's sale. It is unknown what happened to the remainder of the property.

Alvin Tobias Hert, a national figure in the Republican party and reputed to be one of the wealthiest men to come out of southern Indiana, purchased the farm from the Hall estate in 1899 and by 1902 had established the Pine Hall Dairy Company. Mr. Hert is the one to name the mansion Pine Hall, after the grove of thirty-seven stately pine trees in the front yard. In early spring of 1923 a group of Bedford businessmen purchased Pine Hall Dairy Farm from the Hert estate with the intention of developing the Bedford Country Club. Harry S. Scoop of Indianapolis laid out a nine-hole golf course of 3,140 yards the first summer. The course was complete by September 1923 and the Ragsdale mansion was converted into the country club. Little is known about the original course.

Due to management and financial problems, the Bedford Country Club went bankrupt in 1934. Later in that year, the Stone City Bank purchased the land and attempted to locate municipal ownership but was unsuccessful in these efforts. Finally, on October 31, 1935, Fred B. Otis, owner/publisher of the Bedford Daily Mail, announced that he had purchased the Bedford Country Club from the bank. He intended to

**United States Department of the Interior
National Park Service**

**National Register of Historic Places
Continuation Sheet**

Section number 8 Page 2

Otis Park & Golf Course
Bedford, Lawrence County, Indiana

Statement of Significance

donate it to the city for a park if the board of works and city council agreed to some stipulations. He wanted the city to:

- repair and maintain the mansion and use it as a museum;
- to preserve the pine trees which the original builder, William A. Ragsdale, had planted;
- to erect a band shell to seat at least forty musicians;
- to build a baseball field complete with seating;
- to provide a tennis court;
- to protect animal life; and
- to never permit the sale of intoxicants and name the property Otis Park.

The board of works in special session accepted Otis' offer and an ordinance passed immediately by the council, accepting the gift and agreeing to his requests. Bedford Mayor Henry S. "Dot" Murray immediately began the process of applying for various federal funds to rebuild the park since local resources were stressed by the economic hardships caused by the Depression. While the local limestone industry in Bedford did not immediately feel the effects of the Depression, by 1935 severe unemployment had besieged the area and local relief funds alone were insufficient to meet the needs of the county.

With Franklin D. Roosevelt's election as president in November 1932, several federal programs were initiated with his New Deal response to the Depression. The most successful of these early programs was the Federal Emergency Relief Administration (FERA), established in May 1933. It made grants-in-aid to states on approval of applications from governors. However, in 1935 there was a shift in New Deal policy and FERA was abolished and the Works Progress Administration (WPA) emerged. The WPA provided work relief for employable Americans. This program not only helped downtrodden Americans survive the Depression but provided a nation-wide beautification effort with its work projects.

The WPA, which started operation in Indiana in July 1935, was among the largest and most important federal efforts to relieve the suffering brought on by the Great Depression. By October 1935 there were 74,708 Hoosiers on WPA rolls and in January 1936, there were 2,042 Lawrence County people on the rolls. By May 1937, 12,248 persons were working on WPA projects in Lawrence County alone. The hub of WPA activity in Bedford occurred on the grounds of Otis Park. Grants for the park were estimated to total up to \$1.5 million. Beginning in January 1938 between 30 and 50 unemployed stone workers had jobs there. Projects completed between 1937 and 1941 include the expansion of the golf course and the construction of a series of new buildings including a clubhouse, bathhouse, and shelter house. Other activities at the park included 10,000 feet of ornamental rock wall built and rebuilt, two limestone bridges with double arches constructed across Leatherwood Creek, picnic areas laid out, swimming pool facilities altered, 9,000 feet of water lines laid and three miles of roads and parking areas improved, all with WPA labor. Buildings and bridges feature random ashlar design with regular courses, as do the piers of the stone walls, contrasting with the irregular courses of the walls.

**United States Department of the Interior
National Park Service**

**National Register of Historic Places
Continuation Sheet**

Section number 8 Page 3

Otis Park & Golf Course
Bedford, Lawrence County, Indiana

Statement of Significance

The nine-hole golf course was expanded due to WPA efforts to an 18-hole, par-60 course, totaling 5,694 yards. It is possible that a young city engineer, Henry Pearson, was instrumental in the renovation of the expanded golf course since he oversaw the construction of both a new clubhouse and bathhouse.

Official opening day at Otis Park was June 27, 1937, featuring a pro-amateur golf tournament and band concert. At the time it was the largest public park in Bedford and it remains so today. Over the next few years WPA work continued. The golf course was lengthened by 1,199 yards and the par increased to 72, a baseball diamond and bleachers were built, the old bath house stone veneered, formal rock gardens installed across the road from the pool, and two miles of stone fence rebuilt.

The Otis Park band shell was planned by WPA engineers and designed by a local architect, Joe Cezar. Construction began in early 1938 and took one and one-half years to complete. All the stone, some weighing as much as three-fourths of a ton, was cut by hand at the site, and a special pattern used for each stone in the shell's six giant arches. On Sunday, August 27, 1939, a 4:30pm program and band concert dedicated the new Otis Park band shell, fulfilling one of benefactor Fred Otis' requests. At that time, this unique limestone structure, which limestone industry spokesmen doubted could be built, was the only limestone band shell of its kind in the nation built by the Works Progress Administration.

Otis Park was nearly complete in 1941. Mr. Otis died in 1945 and in his will established a trust fund to be used by the City of Bedford for improvements, upkeep, and maintenance of Otis Park. Some of the stipulations of his will included that Pine Hall function as a museum and community hall; that the band shell be constructed according to the designs of Joseph O. Cezar; that the shelter house be constructed according to plans; and that the park have a baseball diamond. It is assumed that the will was in existence for some time prior to Mr. Otis' death since the band shell and the shelter house were both constructed prior to 1945. Since that time, more modern facilities have been added to the grounds. These include a restroom building and concession stand near the baseball field and a playground. An addition has also been attached to the clubhouse.

Today Otis Park and Golf Course are frequently used facilities within Bedford. The gazebo and grounds are used for weddings and other celebrations. Band concerts continue each summer. Both young and old alike for utilize the athletic facilities as long as possible during the year. For the past 75 years Otis Park and Golf Course has contributed to the recreational and cultural life of not only the citizens of Bedford but Lawrence County as well. A gift to the City of Bedford in the heart of the Great Depression by prominent Bedford newspaper owner-publisher Fred Otis, whose name it bears, today it continues and expands the elegance and atmosphere of the country club which it succeeded.

**United States Department of the Interior
National Park Service**

**National Register of Historic Places
Continuation Sheet**

Section number 9 & 10 Page 1

Otis Park & Golf Course
Bedford, Lawrence County, Indiana

Bibliography

Bedford Daily Times-Mail. Obituary of Fred B. Otis. February 12, 1945.

Guthrie, J. M. *A Quarter Century in Lawrence County, Indiana 1917-1941*. Bedford, IN: The Stone City Press, 1984.

_____. *Thirty-Three Years in the History of Lawrence County, Indiana*. Greenfield, IN: Mitchell-Fleming Printing, Inc., 1958.

Historic Landmarks Foundation of Indiana. *Lawrence County Interim Report: Indiana Historic Sites and Structures Inventory*. Indianapolis: Historic Landmarks Foundation of Indiana, 1992.

History of Lawrence County, 1884.

Indianapolis News. "Dutchtown, Politely Known as East Bedford, becomes Haven of Happiness, Due to the Generosity of Fred B. Otis, Bachelor-editor of The Bedford Mail". October 24, 1936.

Madison, James H. *Indiana Through Tradition and Change*. Indianapolis: Indiana Historical Society, 1982.

Verbal Boundary Description

The property under consideration, known as Otis Park, consists of all that part of Section Twenty-four (24), Township Five (5) North, Range One (1) West and Section Nineteen (19) Township Five (5) North and Range One (1) East, that lies between the center of the old Bedford and Leesville Road and the center of the Bedford and Tunnelton Road, excepting 7.91 acres, more or less, and described as follows: Beginning at the center stone of Section Nineteen (19), Township Five (5) North, Range One (1) East, thence north 566.5 feet to a stake, thence north 77 degrees west 620 feet to a stake, thence south 14 degrees west 459 feet, thence south 70 degrees east 760.5 feet to the place of beginning, containing in all, less said exception, 145.85 acres, more or less.

This description also includes a portion of land allotted to Pine Hall for which a separate nomination to the National Register of Historic Places has been prepared. Therefore, the following parcel is not included for the Otis Park and Golf Course nomination: The south boundary is a line parallel to and 20 feet from the south wall of Pine Hall. The east boundary is a line parallel to and 20 feet from the east wall of the house. The north boundary is a line parallel to and 10 feet from the north wall of the house. The west boundary is the right-of-way for Tunnelton Road and includes a portion of random ashlar wall to the south of the entrance to Otis Park. However at the point where the random ashlar wall meets the dry-laid rock wall, Pine Hall ends and Otis Park begins.

**United States Department of the Interior
National Park Service**

**National Register of Historic Places
Continuation Sheet**

Section number 10 Page 2 Otis Park & Golf Course
Bedford, Lawrence County, Indiana

Verbal Boundary Justification

The boundaries of Otis Park include all of the buildings, structures, objects, and sites and are the boundaries as described in the Warranty Deed from Fred Otis to the city of Bedford, IN, which was recorded on October 31, 1935. However excluded from this boundary justification is an 1867-era building known as Pine Hall and a portion of land surrounding it for which a separate description has been formulated and allotted in order to submit a separate nomination to the National Register of Historic Places.

Photographs

The following information applies to all photographs:

Otis Park, Bedford, Lawrence County, Indiana

J. & M. Stipp, photographers

Date of photographs: September-November 2001

Location of Negatives: Division of Historic Preservation & Archaeology, 402 W. Washington St., W274,
Indianapolis, IN 46204-2739

Photo #1

Portion of stone wall at entrance to park, camera facing northwest

Photo #2

Close-up of stone wall construction at entrance to park, camera facing northwest

Photo #3

One of two limestone piers at park entrance, camera facing east

Photo #4

One of two stone bridges over Leatherwood Creek, camera facing southeast

Photo #5

Band shell, camera facing north

Photo #6

Close-up of band shell stage, camera facing northeast

Photo #7

West end of band shell showing Doric columns, camera facing north

Photo #8

Close-up of urn and pedestal at east end of band shell, camera facing northeast

**United States Department of the Interior
National Park Service**

**National Register of Historic Places
Continuation Sheet**

Section number _____ Photographs Page 2

Otis Park & Golf Course
Bedford, Lawrence County, Indiana

Photographs-continued

Photo #9

Formal rock garden north of main drive through golf course, camera facing southeast

Photo #10

Bath house for former pool, camera facing southwest

Photo #11

West portion of clubhouse, camera facing southeast

Photo #12

Two small utility buildings, one a restroom, camera facing northeast

Photo #13

Ball diamond with dugouts, storage building, and concession stand at right, camera facing north

Photo #14

One of three picnic circles with single fireplace, camera facing north

Photo #15

Picnic circle with double fireplace, camera facing northwest

Photo #16

Shelter house at east boundary of golf course, camera facing east

Photo #17

View of 13th hole in front of shelter house, camera facing west

Photo #18

Gazebo south of Pine Hall, camera facing south

Photo #19

View from 17th tee overlooking 11th hole on right and 17th fairway on left, camera facing west

UNITED STATES
DEPARTMENT OF THE INTERIOR
GEOLOGICAL SURVEY

DEPART

3661 NE
(00L1710)



86° 30'
38° 52' 30"

546 RIW

27' 30" RIE

548

4302000m. N.

OTTS PARK #
GOLF COURSE
LAWRENCE CO, IN
A 16 546500 4301130
B 16 546890 4301340
C 16 547700 4301330
D 16 547770 4300680
E 16 547540 4300600
F 16 546800 4300870
G 16 546740 4301020
H 16 546890 4301050
I 16 546890 4301120
J 16 546680 4301100

4300

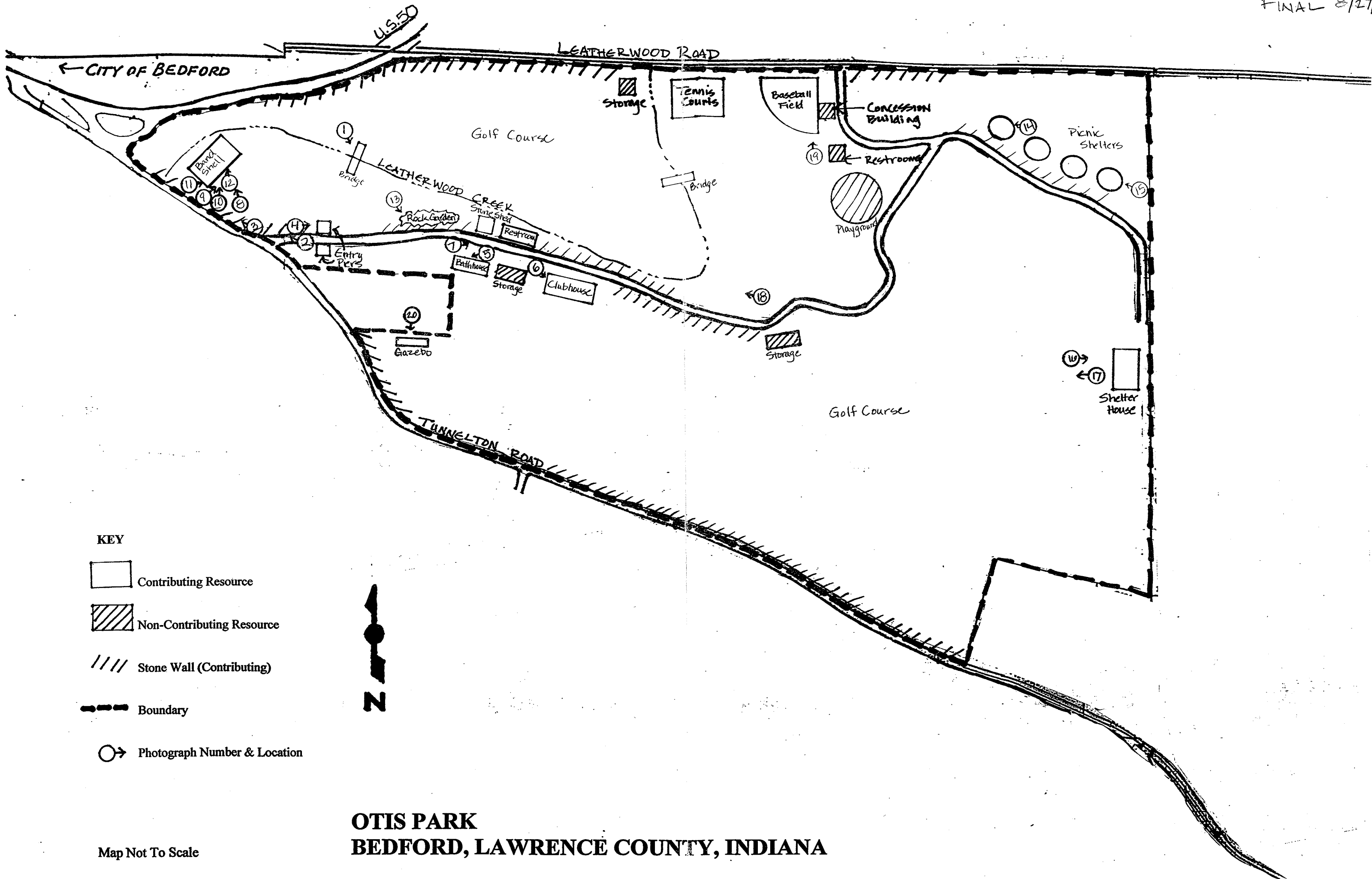

KEY

□ Contributing Resource

▨ Non-Contributing Resource

/// Stone Wall (Contributing)

--- Boundary

○→ Photograph Number & Location



OTIS PARK
BEDFORD, LAWRENCE COUNTY, INDIANA

Map Not To Scale