

United States Department of the Interior
National Park Service

FINAL

National Register of Historic Places
Registration Form

This form is for use in nominating or requesting determinations for individual properties and districts. See instructions in How to Complete the National Register of Historic Places Registration Form (National Register Bulletin 16A). Complete each item by marking "X" in the appropriate box or by entering the information requested. If an item does not apply to the property being documented, enter "N/A" for "not applicable." For functions, architectural classification, materials, and areas of significance, enter only categories and subcategories from the instructions. Place additional entries and narrative items on continuation sheets (NPS Form 10-900a). Use a typewriter, word processor, or computer, to complete all items.

1. Name of Property

historic name Catherine Street Historic District
other names/site number North 9th Street Historic District 057-464-34000

2. Location

street & number roughly bounded by Harrison, Clinton, west side of 9th and east side of 10th N/A not for publication
city or town Noblesville N/A vicinity
state Indiana code IN county Hamilton code 057 zip code 46060

3. State/Federal Agency Certification

As the designated authority under the National Historic Preservation Act, as amended, I hereby certify that this nomination request for determination of eligibility meets the documentation standards for registering properties in the National Register of Historic Places and meets the procedural and professional requirements set forth in 36CFR Part 60. In my opinion, the property meets does not meet the National Register criteria. I recommend that this property be considered significant nationally statewide locally. (See continuation sheet for additional comments.)

Jon C. St D-SAPO 7.23.01
Signature of certifying official/Title Date
Indiana Department of Natural Resources
State or Federal agency and bureau

In my opinion, the property meets does not meet the National Register criteria. (See continuation sheet for additional comments.)

Signature of certifying official/Title Date
State or Federal agency and bureau

4. National Park Service Certification

I hereby certify that the property is:

- entered in the National Register.
 See continuation sheet.
- determined eligible for the National Register
 See continuation sheet.
- determined not eligible for the National Register
- removed from the National Register
- other, (explain:)

Signature of the Keeper

Date of Action

Catherine Street Historic District
Name of Property

Hamilton IN
County and State

5. Classification

Ownership of Property
(Check as many boxes as apply)

- private
- public-local
- public-State
- public-Federal

Category of Property
(Check only one box)

- building
- district
- site
- structure
- object

Number of Resources within Property
(Do not include previously listed resources in the count)

Contributing	Noncontributing	
50	3	buildings
1	0	sites
0	0	structures
0	0	objects
51	3	Total

Name of related multiple property listing
(Enter "N/A" if property is not part of a multiple property listing.)

Number of contributing resources previously listed in the National Register

N/A

2

6. Function or Use

Historic Functions
(Enter categories from instructions)

DOMESTIC: Single Dwelling
 DOMESTIC: Secondary Structure
 COMMERCE/TRADE: Specialty Store
 HEALTH CARE: Clinic

Current Functions
(Enter categories from instructions)

DOMESTIC: Single Dwelling
 DOMESTIC: Secondary Structure
 DOMESTIC: Multiple Dwelling
 VACANT

7. Description

Architectural Classification
(Enter categories from instructions)

LATE VICTORIAN: Queen Anne
 LATE VICTORIAN: Italianate
 19th & 20th c. AMER.: Bungalow/Craftsman

Materials
(Enter categories from instructions)

foundation BRICK
 walls BRICK
 WOOD: Weatherboard
 roof ASPHALT
 other BRICK
 WOOD

Narrative Description

(Describe the historic and current condition of the property on one or more continuation sheets.)

8. Statement of Significance

Applicable National Register Criteria

(Mark "x" in one or more boxes for the criteria qualifying the property for National Register listing.)

- A Property is associated with events that have made a significant contribution to the broad patterns of our history.
- B Property is associated with the lives of persons significant in our past.
- C Property embodies the distinctive characteristics of a type, period, or method of construction or represents the work of a master, or possesses high artistic values, or represents a significant and distinguishable entity whose components lack individual distinction.
- D Property has yielded, or is likely to yield, information important in prehistory or history.

Criteria Considerations

(Mark "x" in all the boxes that apply.)

Property is:

- A owned by a religious institution or used for religious purposes.
- B removed from its original location.
- C a birthplace or grave.
- D a cemetery.
- E a reconstructed building, object, or structure.
- F a commemorative property.
- G less than 50 years of age or achieved significance within the past 50 years.

Areas of Significance

(Enter categories from instructions)

ARCHITECTURE
COMMUNITY PLANNING &

Period of Significance

1870-1937

Significant Dates

Significant Person

(Complete if Criterion B is marked above)

Cultural Affiliation
N/A

Architect/Builder

Unknown

Narrative Statement of Significance

(Explain the significance of the property on one or more continuation sheets.)

9. Major Bibliographic References

Bibliography

(Cite the books, articles, and other sources used in preparing this form on one or more continuation sheets.)

Previous documentation on file (NPS):

- preliminary determination of individual listing (36 CFR 67) has been requested
- previously listed in the National Register
- previously determined eligible by the National Register
- designated a National Historic Landmark
- recorded by Historic American Buildings Survey # _____
- recorded by Historic American Engineering Record # _____

Primary location of additional data:

- State Historic Preservation Office
- Other State agency
- Federal agency
- Local government
- University
- Other

Name of repository:

Catherine Street Historic District
Name of Property

Hamilton IN
County and State

10. Geographical Data

Acreage of Property 4.25 Acres

UTM References

(Place additional UTM references on a continuation sheet.)

1 | 16 | 584040 | 4433480 |
Zone Easting Northing

3 | 16 | 584360 | 4433280 |
Zone Easting Northing

2 | 16 | 584360 | 4433500 |

4 | 16 | 584040 | 4433280 |

See continuation sheet

Verbal Boundary Description

(Describe the boundaries of the property on a continuation sheet.)

Boundary Justification

(Explain why the boundaries were selected on a continuation sheet.)

11. Form Prepared By

name/title Carol Ann Schweikert/Historic Preservation Consultant
organization _____ date _____
street & number 307 North 10th Street telephone 317-776-1239
city or town Noblesville state IN zip code 46060

Additional Documentation

Submit the following items with the completed form:

Continuation Sheets

Maps

- A USGS map (7.5 or 15 minute series) indicating the property's location.
- A Sketch map for historic districts and properties having large acreage or numerous resources.

Photographs

Representative black and white photographs of the property.

Additional Items

(Check with the SHPO or FPO for any additional items)

Property Owner

(Complete this item at the request of SHPO or FPO.)

name _____
street & number _____ telephone _____
city or town _____ state _____ zip code _____

Paperwork Reduction Act Statement: This information is being collected for applications to the National Register of Historic Places to nominate properties for listing or determine eligibility for listing, to list properties and to amend existing listings. Response to this request is required to obtain a benefit in accordance with the National Historic Preservation Act, as amended (16 U.S.C. 470 et seq.).

Estimated Burden Statement: Public reporting burden for this form is estimated to average 18.1 hours per response including time for reviewing instructions, gathering and maintaining data, and completing and reviewing the form. Direct comments regarding this burden estimate or any aspect of this form to the Chief, Administrative Services Division, National Park Service, P.O. Box 37127, Washington, DC 20013-7127; and the Office of Management and Budget, Paperwork Reductions Projects (1024-0018), Washington, DC 20503.

United States Department of the Interior
National Park Service

**NATIONAL REGISTER OF HISTORIC PLACES
CONTINUATION SHEET**

Section 7 Page 1

 Catherine Street Historic District
name of property
 Hamilton County, IN
county and State

7. Narrative Description

The Catherine Street Historic District lies north of the square and south of the old fairgrounds. The district consists of portions of two north/south streets, 9th and 10th from Clinton to Harrison. Until the 1890s, 9th Street was known as Catherine Street and 10th as Anderson Street. The lots are part of the Noblesville Original Plat and include several fractional lots, lots which lie along the river and are smaller than the full size lots. The house styles include Queen Anne, Craftsman, Foursquare and one 1937 house. Most are 2-story, but several 1 and 1 1/2 story homes are found. One home, the Harrell House, was listed on the National Register in 1984. The majority of the homes remain single-family residential with only a few multi-family and one small commercial building. The sidewalks, mature street trees, and street pattern as a whole count as a contributing site.

North 9th Street - West side

- 247 c. 1911; 2 1/2 story American foursquare with front dormer. Hipped roof and stucco facade. six-over-six windows. One-story front porch with concrete block half-wall and square wood posts. Contributing.
- 265 c. 1882/1920; 1 1/2 story gable-front cottage. Front porch has brick/wood square supports. One-over-one windows. Central chimney. Contributing with contributing outbuilding.
- 297 c. 1870 ; 2 story Victorian t-plan with wide bracketed eaves. Tall, narrow one over one windows have simple window hoods. Contributing.
- 307 c. 1870; Gabled-ell Italianate with end chimney. Paired brackets under wide eaves. One-story front porch primarily along ell with pairs of round columns. One-over-one windows with simple window trim. Leaded glass picture windows on front first floor. Hipped roof outbuilding. Contributing with contributing outbuilding.
- 325 c. 1912; 1 1/2 story bungalow with hipped roof and low front dormer. One, four and six-over-one windows. One-story brick porch with limestone accents. Central entrance has sidelights with diamond panes. Side bay with leaded glass window. Outbuilding is joined to the outbuilding at 339 N. 9'. Contributing with contributing outbuilding.
- 339 c. 1891/1922; 2 story Dutch Colonial Revival. Gambrel roof has large, side dormers. Five over one windows. First floor windows have window hoods. Small front portico. Contributing with contributing outbuilding.
- 355 c. 1937; 1 1/2 story with front portico. Symmetrical front facade with six-over-one windows. Central chimney. Contributing.
- 397 c. 1872; 1 -story Victorian t-plan with chimney in front facade and one-over-one windows. Contributing.

United States Department of the Interior
National Park Service

**NATIONAL REGISTER OF HISTORIC PLACES
CONTINUATION SHEET**

Section 7 Page 2

Catherine Street Historic District
name of property
Hamilton County, IN
county and State

-
- 397 c. 1872; 1-story Victorian t-plan with chimney in front facade and one-over-one windows. Contributing.
N. 9th Street - East Side
- 208 c. 1891; 2-story Queen Anne with one-over-one windows and decorative peak siding. Wrap around porch with turned porch supports and decorative frieze. Contributing with non-contributing outbuilding.
- 220 c. 1890/1920; 1½ story hipped roof bungalow. Low front dormer and central chimney. Front brick porch with off-center entrance. Contributing with contributing outbuilding.
- 240 c. 1891; 2½ story Queen Anne with enclosed front porch. Circular tower with bell-shaped roof. Raised front gable in front facade. Tall one-over-one windows. Contributing with contributing outbuilding.
- 248 c. 1892; 2-story Victorian with one-story front porch and central chimney. Turned porch supports and decorative woodwork in porch gable. One-over-one windows. Contributing with contributing outbuilding.
- 264 c. 1892; 2-story Victorian with front and side gables. Decorative motif in front gable. Small portico at entrance. One-over-one windows and central chimney. Contributing with non-contributing outbuilding.
- 298 c. 1885; 2-story with front inset porch and small side porch. Six-over-six windows. Hipped roof with cross gable. Central chimney. Contributing with contributing outbuilding.
- 308 c. 1898/1920; 1½ story gable-front Victorian cottage with one-over-one windows and wide bracketed eaves. Front porch has round columns with two entrances. Hipped roof outbuilding with exposed eaves. Contributing with contributing outbuilding.
- 324 c. 1900; 2 story Queen Anne with Gothic Revival elements. 2 story round tower with conical roof. The secondary front gable is sharply pitched and protrudes from the main gambrel roof. One-story front porch with rough-faced concrete block supports. Contributing with non-contributing outbuilding.
- 340 c. 1898; 2 story L-plan with hipped roof, wide eaves and central chimney. Screened front porch has half squared supports with round columns. 1½ story outbuilding. Contributing with contributing outbuilding.
- 354 c. 1880/1925; 2 story gabled ell with inset front porch. Side chimney. Tall, narrow four-over-four windows. Small balcony over front porch. Contributing with contributing outbuilding.

United States Department of the Interior
National Park Service

**NATIONAL REGISTER OF HISTORIC PLACES
CONTINUATION SHEET**

Section 7 Page 3

Catherine Street Historic District
name of property
Hamilton County, IN
county and State

N. 9th Street - East Side

- 398 c. 1900; 2½ story Queen Anne with hipped roof, multiple gables, front balcony, and small porches on front and side. Other details include leaded glass windows, bracketed eaves, front peak motifs, scalloped peak siding and fan light window in side peak. 2 story 3-car outbuilding with 2nd floor converted to apartment. Contributing with contributing outbuilding.

North 10th Street - West side

- 307 c. 1909; 2½ story American foursquare with hipped roof, front gable and side dormers. 1st floor side bay. Two and three-over-one windows. One story front porch with brick pillars and half-wall. Wide exposed eaves. 2 story outbuilding with 2nd floor converted to apartment. Contributing with contributing outbuilding.
- 339 c. 1910; 2½ story American foursquare with hipped roof and front dormer. Multi-pane windows and side bay. One-story front porch with brick piers. Original detached outbuilding has been connected to house. Contributing with contributing outbuilding.
- 399 c. 1898; 2½ story high-style Queen Anne with multi-gable/hip roof and 3 story polygonal tower. Wrap around front porch across two facades. Hipped roof porte-cochere on side. Multi-shaped and sized windows with a variety of pane configurations, including some stained glass. The original owner's name "S. Harrell M.D." is found in the stained glass window at side entrance. 2 story outbuilding. Listed on the National Register in 1984. Contributing with contributing outbuilding.

North 10" Street - East side

- 308 c. 1901; Gable-front cottage with enclosed side porch and one-over-one windows. Contributing with contributing outbuilding.
- 320 c. 1901; 1-story t-plan cottage with side porch. Simply turned porch supports and one-over-one windows. Octagonal window in front peak. Contributing.
- 338-40 c. 1904; 1½-story hipped roof Craftsman-style with front dormer. Large front picture window and side screened porch. Contributing.
- 354 c. 1870/1916; 2 story American foursquare with low-hipped roof and very low front dormer. Five-over-one and six-over-six windows. One-story front porch with brick piers and half-wall. Contributing with contributing outbuilding.

United States Department of the Interior
National Park Service

**NATIONAL REGISTER OF HISTORIC PLACES
CONTINUATION SHEET**

Section 7 Page 4

 Catherine Street Historic District
name of property
 Hamilton County, IN
county and State

=====
North 10th Street - East side

398 House - 1889-Corner Store - 1924; House: 2-story Queen Anne T-plan with one-story wrap around front porch. Contributing with two contributing outbuildings. Corner store: 1-story with hipped roof and wide eaves. Upper half of walls are windows. Contributing.

Wayne Street - North side

824 c. 1925; 1-story T-plan Craftsman with exposed eaves, hipped roof and front porch. Contributing with contributing outbuilding.

838 c. 1915; 2-story L-plan with side front porch, concrete block piers on porch and one-over-one windows. Contributing.

United States Department of the Interior
National Park Service

**NATIONAL REGISTER OF HISTORIC PLACES
CONTINUATION SHEET**

Section 8 Page 5

 Catherine Street Historic District
name of property
 Hamilton County, IN
county and State

8. Statement of Significance

The Catherine Street Historic district is significant under Criteria A and C for its contribution to architecture, community planning and development. The residential integrity of this neighborhood continues to be strong with no commercial re-zones and almost all remain single-family units. A modern bank building on the southwest corner of the district is the only infill. Since the boundaries were easily drawn around it, no infill structures exist within the district, helping keep the architectural integrity intact. Several elements add to the historic integrity and feel of the neighborhood. Mature trees line 9th Street's sidewalks and there are numerous retaining walls along the east side of 9th. Several areas of brick sidewalks are also found in this district.

Criterion A

This district is associated with events that have made a significant contribution to the broad patterns of Noblesville's history. Although platted with the original Noblesville plat in 1823, it took sixty to seventy years for this area to fully develop. Neither Noblesville's incorporation nor the railroad had a significant impact on this neighborhood. By 1870, a wide variety of businesses in Noblesville were supported by a population of 1,435. Despite this growth, only a few lots in this district were improved before the 1880s.

It was not until natural gas was discovered in 1888, that this quiet, under-developed area was quickly transformed by the rapid growth. We see a distinct change as the gas boom brought more jobs and money. Evidence of this growth and influx of money is seen in the tax values from the 1886 assessment to the 1891 assessment. A large, marked increase is seen in many areas of Noblesville with some land values increasing more than four times their pre-natural gas values. The increase in land values for this immediate area is seen with the next two assessments which shows how this area's major development followed the gas boom growth,

Thirteen of the existing 27 homes in this district were built during the 1880s and 1890s, with ten of those during the 1890s. The homes in the 200 block of the east side of north 9th were all built in the early 1890s. When the Sanborn. maps were printed in April, 1898, only one of the existing five homes had been constructed on the east side of the 300 block. By 1900, all five were built. This area is a clear representation of how significantly the discovery of natural gas affected Noblesville and how quickly the town grew.

The development of Noblesville and the district attracted a number of prominent persons to live here. These were doctors, businessmen, bankers and politicians. Their contributions to the city are well-remembered by our citizens.

Albert & Baker (240 N. 9th) was born in Hamilton County and studied at Union High School in Westfield and in schools at Adrian, Michigan. He was active in politics holding several city and county offices. He served as treasurer of Hamilton County from 1890-92. In 1900 he was elected Mayor of Noblesville and served for four

United States Department of the Interior
National Park Service

**NATIONAL REGISTER OF HISTORIC PLACES
CONTINUATION SHEET**

Section 8 Page 6

 Catherine Street Historic District
name of property
 Hamilton County, IN
county and State

years. In 1908 he was elected trustee of Noblesville township. He also served on the city council and on the board of education. In addition to his political offices, he held a variety of other jobs during his lifetime. He taught school until 1872 when he went into the drug business with George W. Vestal. He owned a livery for 13 years and also farmed. He married in 1873 and had four children.

George S. Christian (265 N. 9th and 338-40 N. 10th) was born in 1861 and spent much of his adult life in the banking industry. He started out as deputy in the county clerk's office under his brother, Judge Ira Christian. He left this position to become cashier of the First National Bank. In 1910, he with several others, organized the American National Bank. He served first as cashier and then as its president until his death in 1930.

Dr. Samuel Harrell (399 North 10th) was a prominent Noblesville physician for more than 25 years. He graduated from the University of Michigan Homeopathic Medical School in 1893 and studied in Paris and Vienna. He was especially skilled in bone and abdominal surgery. With his brother, Dr. Madison Harrell, he established the county's first hospital, Harrell Hospital, in 1908. They operated the hospital until 1915 when it was sold to the county. He built his Queen Anne home on N. 10th Street in 1898. The entrance under the porte cochere still bears his name. He died in 1931, and his wife in 1959. The Harrell house remained in the family until 1970.

Will Mabee (398 N. 10th Street) was the proprietor of Grandpa's Candy Store, a small corner store at 10th and Harrison. He learned the candy trade under his father-in-law, George Hawkins. Mr. Hawkins was known all over Indiana and other states as GranPa, selling candies, crackerjack and other sweets at fairs, meetings, political gatherings, etc. Mabee invented the famous brand of crackerjack, known as "Gran'Pa's Wonderful Popcorn. Candy." He also introduced ice cream cones, ice cream sandwiches and the ten-cent lolly pops to this community. Under Mabee, the business grew and in 1903 he built a small store on the corner of North 10th Street and a candy kitchen on the rear of the lot. He made 49 kinds of candies in that building. The significance of a candy store may be lost on those outside of Noblesville, but here it was a landmark. Gran'Pa's candy store is still fondly remembered by Noblesville citizens.

Charles B. Macy (340 N. 9th) knew more about the manufacture of paper than anyone else in Hamilton County at the turn of the century. He was born in New York, the son of a paper manufacturer. After several moves in Ohio and Indiana, he came to Noblesville in 1890 to complete the construction of the American Strawboard Company's plant, one of their largest. He remained here as its superintendent for 10 years before moves to Chicago, New York and Massachusetts. In 1902, he returned to Noblesville to his previous position. His financial interests extended to the Kline-Macy Foundry Company, the Sheridan Packing Company, the American National Bank, the Wainwright Trust Company and the water works. He was married twice and died in 1921 at age 75.

United States Department of the Interior
National Park Service

**NATIONAL REGISTER OF HISTORIC PLACES
CONTINUATION SHEET**

Section 8 Page 7

Catherine Street Historic District
name of property
 Hamilton County, IN
county and State

Dr. David D. Miesse (308 N. 10th) was an early Noblesville physician. He located in Noblesville in 1860 after practicing medicine since the 1830s. He was skillful in preparing and mixing the medicines he prescribed since drug stores were not always available. He practiced medicine in Noblesville until he retired in the late 1800s.

George Nagle (308 North 10th) was sheriff of Hamilton County for one term from 1890-1892. He was born in Pennsylvania and served in the Union Army during the Civil War. In 1867, he moved to Arcadia, Indiana and married in 1870. When he was elected sheriff, he moved to Noblesville. After his term as sheriff, he served as a policeman at the state house.

Criterion C

This district includes a variety of architectural styles including Italianate, Craftsman, American Foursquare, Victorian and Queen Anne, but because of the major construction period of the 1880s and 1890s, the predominant styles are Victorian and Queen Anne. An excellent example of the Queen Anne style is the Dr. Samuel Harrell House, listed on the National Register in 1984. Other homes with a high degree of architectural integrity are:

- 307 N. 9th - Italianate
- 220, 240, 248 and 398 North 9th - Queen Anne
- 247 N. 9th - American Foursquare
- 307, 339 and 354 N. 10th - American Foursquare

A more detailed description of these structures is found in Section 7: Description.

In several instances in this neighborhood, the architectural style does not reflect its original construction date. Several homes built in the 1880s and 1890s, underwent a major remodeling in the 1910s or 1920s and now reflect a totally different architectural style. One of those is the Dutch Colonial home at 339 N. 9th which was originally built in 1891 and dramatically changed around 1922. Others like this include:

- 229 N. 9th - 1891-1920 - Bungalow
- 308 N. 9th - 1898/1920 - Victorian with Craftsman details
- 354 N. 10th - 1870/1916 - American Foursquare

United States Department of the Interior
National Park Service

**NATIONAL REGISTER OF HISTORIC PLACES
CONTINUATION SHEET**

Section 9 Page 8

 Catherine Street Historic District
name of property
 Hamilton County, IN
county and State

9. Major Bibliographical References

Annual Statistics and Post Office Directory of Hamilton County Indiana 1893-4. Noblesville, Indiana: Ledger Book and Job Print, 1894.

Fire Insurance Maps. Sanborn Map & Publishing Co. New York: 1898, 1905, 1914, 1922 and 1933.

Foland, John A. *Remembrances.* Noblesville, Indiana: Rowland Printing Company, 1976.

Haines, John F. *History of Hamilton County Indiana: Her People. Industries. and Institutions.* Indianapolis: B.F. Bowen & Company, 1915.

Hamilton County, Office of Transfer and Mapping, Transfer Books.

Hamilton County, Recorder's Office, Deed Books.

History of Hamilton County, Indiana, with Illustrations and Biographical sketches. Chicago: Kingman Brothers, 1889.

Newspaper articles from 1921-1959. *Noblesville Daily Ledger.*

Polk's Noblesville City Directory. Indianapolis: R.L. Polk & Co., 1938.

Portrait and Biographical Record of Madison and Hamilton Counties, Indiana Chicago-Biographical Publishing Co., 1893.

Sheriffs of Hamilton County 1823 -1992. 1992.

Shirts, August Finch. *A History of the Formation. Settlement and Development of Hamilton County, Indiana. From The Year 1818 to the Close of the Civil War.* 1901.

W,H. Hoffinan's City Directory of Noblesville IN. Quincy: Hoffman Directories, 1916, 1920, 1922, 1924, 1926, 1929, 1938,1948.

United States Department of the Interior
National Park Service

**NATIONAL REGISTER OF HISTORIC PLACES
CONTINUATION SHEET**

Section 10 Page 9

 Catherine Street Historic District
name of property
 Hamilton County, IN
county and State

Verbal Description

Beginning at the intersection of the alleys behind and beside 247 North 9th Street and running north along the east side of the north/south alley to the north side of Wayne Street. Turn west and run to the SW corner of 824 Wayne Street. Turn north and follow the property line to the NW corner. Turn east and run along the north property lines of 824 and 838 Wayne street to Parkview Place. Run north along the east side of Parkview Place to the SW corner of 355 N. 9th. Follow the west property lines of 355 and 397 N. 9th to the NW corner of 397. Turn east and run along the north property line of 397 to 9th Street. Run on the south side of Harrison to the alley between 10th and 11th Streets. Follow the west side of the alley south to the north side of Wayne Street. Run west along the north side of Wayne to the alley between 9th and 10th Streets. Turn south along the west side of the alley to the north side of Clinton. Run west along the north side of Clinton to 9th Street then north on the east side of 9th Street to the alley beside 247 N. 9th. Run west along the north side of the alley to place of beginning.

Boundary Justification

The Catherine Street Historic District was laid out in the Hamilton County Interim Report. These boundaries follow those in the report with three additions. 355 and 297 N. 9th were included as contributing properties since they are the last properties on North 9th which fall within the period of significance. Homes north of this boundary are newer homes outside the period of significance. 824 and 838 Wayne were included as they are the last two homes west on Wayne before the turn in the street and the commercial square begins. The final addition to the interim report district are five homes on the east side of 10th Street. These homes fall within the period of significance and are not likely to be included in a district east of their property lines since that area has declined significantly. Within these five homes is the only remaining corner store in Noblesville and it is regarded as an important property to this community.

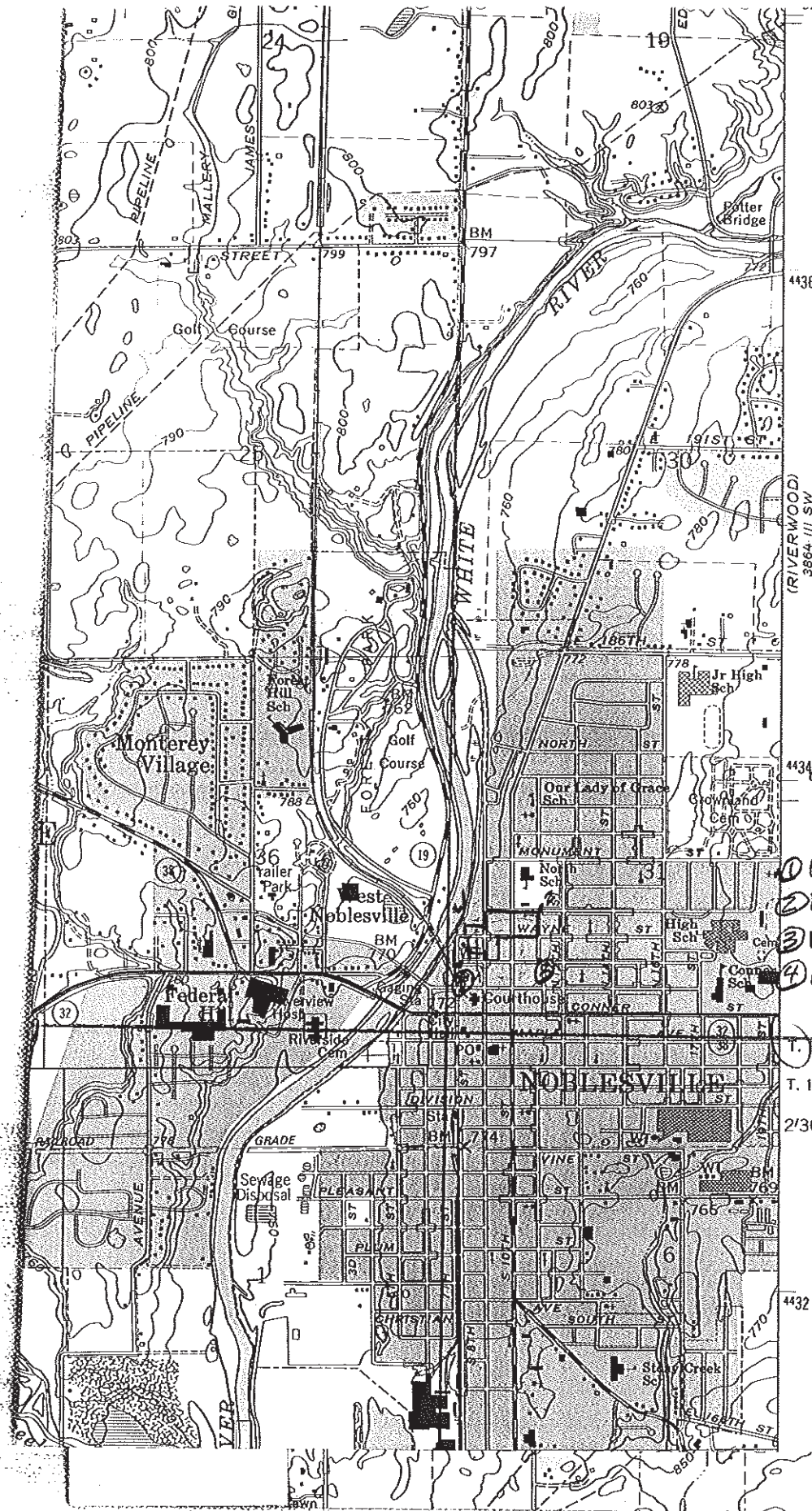

(RIVERWOOD
3864 III SW

4434 CATHELINE STREET
HISTORIC TRAIL STREET
HAMILTON CO., IN
UTMS 2

- ① 16 5840404433480
- ② 16 584360 4433500
- ③ 16 584360 4433280
- ④ 16 5840404433280

T. 19 N.
T. 18 N.
2'30"

4433

4432