

United States Department of the Interior
National Park Service

National Register of Historic Places
Registration Form

This form is for use in nominating or requesting determinations for individual properties and districts. See instructions in *How to Complete the National Register of Historic Places Registration Form* (National Register Bulletin 16A). Complete each item by marking "x" in the appropriate box or by entering the information requested. If an item does not apply to the property being documented, enter "N/A" for "not applicable." For functions, architectural classification, materials, and areas of significance, enter only categories and subcategories from the instructions. Place additional entries and narrative items on continuation sheets (NPS Form 10-900a). Use a typewriter, word processor, or computer, to complete all items.

1. Name of Property

historic name Hurlbert, Lewis, Sr., House

other names/site number 029-029-51183

2. Location

street & number 412 Fifth Street N/A not for publication

city or town Aurora N/A vicinity

state Indiana code IN county Dearborn code 029 zip code 47001

3. State/Federal Agency Certification

As the designated authority under the National Historic Preservation Act, as amended, I hereby certify that this nomination request for determination of eligibility meets the documentation standards for registering properties in the National Register of Historic Places and meets the procedural and professional requirements set forth in 36 CFR Part 60. In my opinion, the property meets does not meet the National Register criteria. I recommend that this property be considered significant nationally statewide locally. (See continuation sheet for additional comments.)

Signature of certifying official/Title _____ Date _____
Indiana Department of Natural Resources
State of Federal agency and bureau

In my opinion, the property meets does not meet the National Register criteria. (See continuation sheet for additional comments.)

Signature of certifying official/Title _____ Date _____
State or Federal agency and bureau

4. National Park Service Certification

I hereby certify that the property is:

Signature of the Keeper

Date of Action

- entered in the National Register.
 See continuation sheet.
- determined eligible for the National Register
 See continuation sheet.
- determined not eligible for the National Register.
- removed from the National Register.
- other, (explain:)

Lewis Hurlbert Sr. House
Name of Property

Dearborn County, Indiana
County and State

5. Classification

Ownership of Property
(Check as many boxes as apply)

- private
- public-local
- public-State
- public-Federal

Category of Property
(Check only one box)

- building(s)
- district
- site
- structure
- object

Number of Resources within Property
(Do not include previously listed resources in the count.)

Contributing	Noncontributing	
3	1	buildings
0	0	sites
2	0	structures
0	0	objects
5	1	Total

Name of related multiple property listing
(Enter "N/A" if property is not part of a multiple property listing.)

N/A

Number of contributing resources previously listed in the National Register

0

6. Function or Use

Historic Functions
(Enter categories from instructions)

DOMESTIC: single dwelling
DOMESTIC: secondary structure

Current Functions
(Enter categories from instructions)

DOMESTIC: single dwelling
DOMESTIC: secondary structure

7. Description

Architectural Classification
(Enter categories from instructions)

Greek Revival
Italianate
OTHER: double pile

Materials
(Enter categories from instructions)

foundation STONE: limestone
walls WOOD: weatherboard
roof ASPHALT
other METAL: cast iron

Narrative Description

(Describe the historic and current condition of the property on one or more continuation sheets.)

Lewis Hurlbert Sr. House
Name of Property

Dearborn County, Indiana
County and State

8. Statement of Significance

Applicable National Register Criteria

(Mark "x" in one or more boxes for the criteria qualifying the property for National Register listing.)

- A** Property is associated with events that have made a significant contribution to the broad patterns of our history.
- B** Property is associated with the lives of persons significant in our past.
- C** Property embodies the distinctive characteristics of a type, period, or method of construction or represents the work of a master, or possesses high artistic values, or represents a significant and distinguishable entity whose components lack individual distinction.
- D** Property has yielded, or is likely to yield, information important in prehistory or history.

Criteria Considerations

(Mark "x" in all the boxes that apply.)

Property is:

- A** owned by a religious institution or used for religious purposes.
- B** removed from its original location.
- C** a birthplace or grave.
- D** a cemetery.
- E** a reconstructed building, object, or structure.
- F** a commemorative property.
- G** less than 50 years of age or achieved significance within the past 50 years.

Narrative Statement of Significance

(Explain the significance of the property on one or more continuation sheets.)

9. Major Bibliographical References

Bibliography

(Cite the books, articles, and other sources used in preparing this form on one or more continuation sheets.)

Previous documentation on file (NPS):

- preliminary determination of individual listing (36 CFR 67) has been requested
- previously listed in the National Register
- previously determined eligible by the National Register
- designated a National Historic Landmark
- recorded by Historic American Buildings Survey # _____
- recorded by Historic American Engineering Record # _____

Areas of Significance

(Enter categories from instructions)

COMMERCE

ARCHITECTURE

Period of Significance

1844-1873

Significant Dates

1844

Significant Person

(Complete if Criterion B is marked above)

Hurlbert, Lewis, Sr.

Cultural Affiliation

N/A

Architect/Builder

Unknown

Primary location of additional data:

- State Historic Preservation Office
- Other State agency
- Federal agency
- Local government
- University
- Other

Name of repository: Indiana Historic Sites
and Structures Inventory

Lewis Hurlbert, Sr. House
Name of Property

Dearborn County, Indiana
County and State

10. Geographical Data

Acreage of Property Less than one acre

UTM References

(Place additional UTM references on a continuation sheet.)

1

1	6
---	---

6	8	1	4	0	0
---	---	---	---	---	---

4	3	2	4	7	2	0
---	---	---	---	---	---	---

Zone Easting Northing

3

--	--	--	--	--	--	--	--	--	--

--	--	--	--	--	--	--	--	--	--

--	--	--	--	--	--	--	--	--	--

Zone Easting Northing

See continuation sheet

Verbal Boundary Description

(Describe the boundaries of the property on a continuation sheet.)

Boundary Justification

(Explain why the boundaries were selected on a continuation sheet.)

11. Form Prepared By

name/title Cheri Ann Ascherman

organization N/A date February 20, 1994

street & number 412 Fifth Street telephone 812-926-3452

city or town Aurora state IN zip code 47001

Additional Documentation

Submit the following items with the completed form:

Continuation Sheets

Maps

A **USGS map** (7.5 or 15 minute series) indicating the property's location.

A **Sketch map** for historic districts and properties having large acreage or numerous resources.

Photographs

Representative **black and white photographs** of the property.

Additional items

(Check with the SHPO or FPO for any additional items)

Property Owner

(Complete this item at the request of SHPO or FPO.)

name Richard L. and Cheri A. Ascherman

street & number 412 Fifth Street telephone _____

city or town Aurora state IN zip code 47001

Paperwork Reduction Act Statement: This information is being collected for applications to the National Register of Historic Places to nominate properties for listing or determine eligibility for listing, to list properties, and to amend existing listings. Response to this request is required to obtain a benefit in accordance with the National Historic Preservation Act, as amended (16 U.S.C. 470 *et seq.*).

Estimated Burden Statement: Public reporting burden for this form is estimated to average 18.1 hours per response including time for reviewing instructions, gathering and maintaining data, and completing and reviewing the form. Direct comments regarding this burden estimate or any aspect of this form to the Chief, Administrative Services Division, National Park Service, P.O. Box 37127, Washington, DC 20013-7127; and the Office of Management and Budget, Paperwork Reductions Projects (1024-0018), Washington, DC 20503.

United States Department of the Interior
National Park Service

**National Register of Historic Places
Continuation Sheet**

Section number 7 Page 1

The Lewis Hurlbert, Sr. House is a two story, five bay, side gabled, wood frame double pile residence with characteristics of the Greek Revival and Italianate detailing. Built in 1844, the house stands in a residential section of the Ohio River town of Aurora. The site has a marked drop in grade to the north, as the town occupies the foot of a hillside.

The Hurlbert House has wood clapboard walls and rests on a rough cut limestone foundation. The forty foot by thirty foot main block is adjoined by a twenty-six foot, six inch by sixteen foot addition (dating from the mid-1800s) to the east. There is a basement under the eastern two-thirds of the main block of the house and a crawl space under the western third. The addition has a full basement as well.

The main elevation faces south to Fifth Street. Centered on the first floor of the main block is the main entry. It is sheltered by a wooden, square columned, flat roofed portico. The original roofline balustrade is missing, and the columns are replacements. The floor of the portico is at grade; a sidewalk-like concrete slab serves as the floor. The columns have vernacular Doric capitals and the portico entablature has simple cornice moldings as well. Wooden bench seats spanning between the columns and matching pilasters were added in the early 1900s. The door is likely an early 1900s replacement, it is stained, twelve light door topped with rectangular three light transom. Two evenly spaced windows stand to either side of the entry. These are six-over-six wood double hung sash with functional wood shutters. As with all window openings, there is no decorative lintel treatment. Five matching windows align with openings of the first story on the second story of the main elevation. Decorative scroll brackets with drop pendants mark the open eaves. They are paired between windows and evenly spaced at the corners. The side gabled asphalt shingled roof has two internal brick chimneys (rebuilt in the 1980s) located toward either gable end. A chimney has been removed from the near northwest corner, and the roof originally had wooden stop gutters. Modern aluminum gutters are now in place.

The addition to the east is setback about four and half feet from the front southeast corner of the main block, but the full length one story porch of this section is nearly flush with the front

**United States Department of the Interior
National Park Service**

**National Register of Historic Places
Continuation Sheet**

Section number 7 Page 2

**Lewis Hurlbert, Sr. House
Dearborn County, Indiana**

wall of the main block. The porch is similar in detail to the front portico. There are two six-over-six shuttered windows on the first floor with two aligning six pane casement windows with shutters on the second level. Eaves and bracketing generally match the main block, but the brackets are smaller.

The east elevation has the gable end of the main block with the gable end of the addition superimposed over it. Under the porch of the addition on the first floor is a transomed door. Aligned over this at the second level is a single six-over-six window, overlapped by the eaves of the addition. At the apex of the main gable is a single six-over-six window. Paired six-over-six windows are located on the first story of the main section, behind (north) the addition. The gable end has raked pendant brackets. The gable end of the addition has no first floor openings, but has two symmetrically placed six pane casement windows on the second story. The gable end has raked brackets.

The west elevation is a gable end to the main block. Two windows exist on the first floor; one is centered, the other is to the north. These windows are similar to the front sash, but extend to the interior floor level. A single second floor window is aligned over the north first floor opening. A small six-over-six window is centered at the apex of the gable. Raking brackets mark the eaves.

The north elevation faces downtown Aurora and the Ohio River. The hillside location commands an impressive view. The foundation/retaining wall is exposed to view on this elevation. The main block has three bays on this side. On the first floor, a doorway is to the east, with two windows to the west. On the second floor, windows align with the first floor openings. The center one has double casements with four panes, while the end bays have four-over-four double hung windows. Brackets and eaves match the front facade. The full width one story square columned porch is similar to the front porches. The addition is set back from the main block. A small staircase leads down to a basement door at the northeast corner which is partly below grade. The first floor contains three bays, one door to the west and two six-

**United States Department of the Interior
National Park Service**

**National Register of Historic Places
Continuation Sheet**

Section number 7 Page 3

**Lewis Hurlbert, Sr. House
Dearborn County, Indiana**

over-six windows. The second floor has three six pane casements aligned over the first floor openings.

The interior of the Hurlbert House would seem to have a central passage, double pile plan. However, the layout varies somewhat from the traditional double pile format, with a full width room at the rear intersecting with the central hall. Plain woodwork consists of four-panel doors, simple surrounds with molded cornices, and varied width pine floors throughout the house.

A narrow stair hall extends to half the depth of the house, with the stairs on the east wall. The staircase has a turned newel post, molded cherry hand rail and turned balusters. The half wall under the stairs has paneled wainscoting. A door stands at the end of the central hall. Square parlors are to either side of the hall toward the front of the house. Fireplaces in these rooms, as throughout the first floor, have been replaced with Italianate cast iron mantels with round arch openings and marbled finish. The room to the southeast has an exterior door to the addition's front porch and an interior door to the addition, both flanking the fireplace.

The rear half of the house has two rooms. In the northeast corner is a small square room which is now a kitchen, historic function unknown. The rest of the rear is occupied by a double parlor divided by a broad segmental arch with implied pilasters having simple bases and capitals. The full length windows mentioned earlier are on the west wall. Cast plaster ceiling medallions are in each half of the double parlor. Original plaster cornices have been removed at some point. The double parlor is believed to have been the public area of the house, its untraditional location perhaps due to the fine panorama it afforded of the town and river.

The second floor follows the double pile plan more closely, having a T-shaped hall leading to four bedrooms. To the left of the stairs is a round arched opening into a small sitting room over the front portico. The sitting room has two windows, two closets,

United States Department of the Interior
National Park Service

National Register of Historic Places
Continuation Sheet

Section number 7 Page 4

Lewis Hurlbert, Sr. House
Dearborn County, Indiana

a false door and the entrance to the attic stairs. The two front bedrooms are largest, each has a large fireplace with original Greek Revival wood mantels. These mantels have vernacular Doric details. The openings have replacement cast iron surrounds. In the room in the southwest corner, closets flank the fireplace, however, in the southeast room there is a closet only to the left of the fireplace. The bedrooms to the northeast and northwest corners are slightly smaller and do not contain fireplaces.

The addition located east of the main block contains small rooms with low ceilings and very plain woodwork. On the first floor is one room which is entered from a hallway leading from the southeast room of the main house. This hallway has a basement door. Possibly this room was the original kitchen. It has a fireplace with plain mantle on the east wall flanked by built in cupboards. The room has original horizontal wainscoting. An enclosed stairway to the second floor is in the southeast corner of the room. The second floor has a hallway along the north wall. Several steps lead up into the northeast bedroom in the main section. Two small bedrooms on the second floor of the addition may have been servant's quarters. Ceilings are angled toward the eaves. The east room has a small fireplace with plain mantle on its east wall. This room is currently a large bathroom.

The double lots occupied by the Hurlbert House contain other contributing resources, including two sections of cast iron fencing, a stable, and an outhouse. A 1960s metal sided two car garage also stands on the site. These resources, including the house itself, count as 3 contributing buildings, 2 contributing structures, and one non-contributing building.

The stable has a limestone foundation, balloon-framed, clapboarded walls, exposed rafters, metal clad gable roof, and simple brackets on the south facing gable. This side also has three openings, two on the first floor and one in attic level, having wooden slats rather than windows or doors. The west wall has a door and vented opening, the north wall is blank, and the east wall has a pair of vertical, side hinged doors. The outhouse is next to the northeast

United States Department of the Interior
National Park Service

National Register of Historic Places
Continuation Sheet

Section number 7 & 8 Page 5

Lewis Hurlbert, Sr. House
Dearborn County, Indiana

corner of the stable. It has a brick foundation, clapboard siding, a flat roof, and door with vented opening on the east side. The interior is finished with lath and plaster. The building, which is in deteriorated condition, has two adult seats and two shorter children's seats with hinged covers.

Section 8-Statement of Significance

The Lewis Hurlbert House is eligible for inclusion in the National Register of Historic Places under Criteria B and C. Built for prominent businessman Lewis Hurlbert in 1844, the house is a locally outstanding example of a vernacular Greek Revival-Italianate double pile house type. Hurlbert is noted for his many contributions to commerce in Aurora. Although the house is located in the already listed Downtown Aurora Historic District (now pending in Washington, D.C.), the house merits individual recognition.

Settlement began in earnest in Dearborn County in the 1820s, when eastern settlers began to take advantage of the area's fertile lands and river front sites. Many advances took place during the early years of settlement in Aurora, which was founded by the Aurora Association for Internal Improvements in 1819. A post office was established that year and July 4, 1824 saw the launching of the first steamboat named the "Clinton". The vessel was built in Aurora by Pinkney James of Cincinnati; it marked the beginning of a long era of prosperity based on river travel, commerce, and industry in Aurora. In 1836, George Lane spanned Hogan Creek with a permanent bridge, opening Aurora to easy overland travel. An influx of enterprising "young men of energy" soon came; among were Dr. George Sutton, L.C. Hastings, A.C. Cole, Charles and Thomas Folbre, George W. Cochran, and Issac Hancock.

The 1840 census indicated 490 residents in Aurora, but by 1844, when the Hurlbert House was built, the city began to develop rapidly. The construction of business blocks and homes increased property values. Grand homes were built by established

United States Department of the Interior
National Park Service

National Register of Historic Places
Continuation Sheet

Section number 8 Page 6

Lewis Hurlbert, Sr. House
Dearborn County, Indiana

citizens and also by wealthy newcomers who were attracted to the growing community.

By 1852, Aurora had a population of 3,000, supported two newspapers, and had some of most impressive homes in the state. The 1850s were the high tide mark of river traffic on the Ohio, however, Aurora also had railroad connections. The town continued to prosper, thanks to local industries which played an important role in the growth of the community.

One such industry was started by Hurlbert. Lewis G. Hurlbert, Sr. (1813-1873) was a native of Albany, New York. During his youth he traveled to Boston and then to New Orleans by boat. After a brief stay in Louisiana, Hurlbert settled in Aurora in 1835. He later built a prosperous lumber business and achieved a prominent position in the community. After settling in Aurora, Lewis Hurlbert married Emma L. Conwell, daughter to Elias Conwell, one of the early founders of Aurora, being a member of the first board of trustees for the corporation of Aurora. Conwell owned many lots and early buildings in town. The Hurlberts bought two lots from George Lane and constructed their double pile house in 1844.

Mr. Hurlbert began his lumber business in 1848 with offices located at Third and Mechanic Streets. This was the first lumber company in Aurora. His large variety of rough and dressed lumber came from Northern Michigan. He also carried a large supply of sawn shingles, sashes, and doors. Hurlbert was very successful in business and reportedly sold 1,000,000 feet of lumber and almost 1,500,000 shingles annually. Due to its early establishment and longevity in the community, it is estimated that the business handled many hundreds of thousands of dollars. The company grew to occupy a half-dozen lots, an old planing mill, and other buildings. Customers came from throughout Dearborn and adjoining counties. Though not as prominent as the Gaff's distillery business and other holdings in Aurora, Hurlbert's lumber yard contributed much to the growth of the community in the nineteenth century. His prosperity is best reflected in his substantial wood

United States Department of the Interior
National Park Service

National Register of Historic Places
Continuation Sheet

Section number 8 Page 7

Lewis Hurlbert, Sr. House
Dearborn County, Indiana

framed house on Fifth Street.

Lewis Hurlbert, Jr. joined his father's business as a partner in 1866. After Hurlbert Sr.'s death in 1873, his son continued to operate the lumber mill as sole proprietor. In 1885, it was called the "Pioneer yard of the country" because of its longevity. The mill changed ownership several times in the 1900s, but the Aurora Lumber Company continues to operate today in its present location in U.S. 50 (outside of the listed Aurora district). It is considered the oldest continuously operated lumber yard in Indiana.

An interesting footnote to the life of Lewis Hurlbert, Sr. is his involvement in "The Friendly Pact", a Civil War agreement between men from Petersburg, Kentucky and Aurora that promised neutrality, mutual good will, and a maintenance of social and economic ties between the two towns. Hurlbert was one of a group of Aurora men who signed the pact in 1861. Relations were quickly restored after the war.

After the war, Hurlbert, Sr. expanded his business interests. Along with Thomas Gaff, James Gaff (Hurlbert's brother-in-law), Henry W. Smith, W. E. Gibson, John J. Backman, and Abram Lozier, Hurlbert, Sr. was among the first board of directors for the First National Bank of Aurora. The bank opened on December 9, 1864 with 100,000 dollars of capital. The bank was an important institution in the Aurora business community and his position as a board member increased his stature in Aurora.

Mr. Hurlbert, Sr. was also involved in many other aspects of the community of Aurora. He was an elder and deacon at the Presbyterian Church. For twenty years, he was treasurer of the Chosen Friends Lodge (Order of Odd Fellows). He was a member of the school board and worked to provide suitable buildings for Aurora's pupils. During his tenure on the public school board, a new public school building was completed.

After Hurlbert, Sr.'s death in 1873, his family continued to

United States Department of the Interior
National Park Service

National Register of Historic Places
Continuation Sheet

Section number 8 & 9 Page 8

Lewis Hurlbert, Sr. House
Dearborn County, Indiana

occupy the home. It remained in the family until 1910.

The Hurlbert House is architecturally important as a good example of a vernacular house type with high style details. The Indiana Historic Sites and Structures Inventory for Dearborn County recorded a number of Upland South house types, mainly I-houses and two-thirds I-houses. Most have simple Greek Revival detailing, one example (305 Fourth St.) has Downingesque Gothic Revival features. Double pile types are more rare. Only two outstanding examples were noted by the survey in Aurora, the Hurlbert House being one these. The mid-1800s addition to the east of the house continues the simple character of the main section. Interior updating seems to have occurred into the late 1800s; the period of significance includes the date of the addition and most significant interior features.

Section 9-Bibliography

Books

Aurora Sesquicentennial. Aurora, IN: Aurora Sesquicentennial Historical Committee, 1969.

History of Dearborn and Ohio Counties, Indiana. Indianapolis: F.E. Weakley & Co., 1885.

Indiana Historic Sites and Structures Inventory, Dearborn County Interim Report. Indianapolis: Historic Landmarks Foundation of Indiana, 1983.

McElvoy's Lawrenceburg, Aurora, and Rising Sun Directory. 1859-1860.

Sanborn Map and Publishing Company. Sanborn Map of Aurora, Indiana, 1887.

Shaw, Archibald. History of Dearborn County, Indiana. Indianapolis: B.F. Bowen & Co., 1915.

United States Department of the Interior
National Park Service

National Register of Historic Places Continuation Sheet

Section number 9 & 10 Page 9

Lewis Hurlbert, Sr. House
Dearborn County, Indiana

Wiggins and Weaver's Ohio River Directory for 1871-72. Cleveland,
Ohio: Wiggins and Weaver, 1871.

Newspapers

Farmer and Mechanic (Aurora, Indiana), January 7, 1874.

Other

Deed Record Books, Dearborn County Records Office, Dearborn
County Courthouse, Lawrenceburg, Indiana

Section 10-Geographical Data-Verbal Boundary Description

In-lot numbers 181 and 182, in the City of Aurora, Dearborn
County, Indiana.

Boundary Justification

This is the historic property boundary.

United States Department of the Interior
National Park Service

National Register of Historic Places
Continuation Sheet

Section number Photos Page 1

Hurlbert, Lewis, House
Aurora, IN

Cheri A. Ascherman, photographer
February 19, 1994

Negatives: Cheri A. Ascherman, 412 Fifth Street, Aurora, Indiana 47001

photo #1

Exterior facing south

photo #2

Exterior facing south

photo #3

Exterior facing southwest

photo #4

Exterior facing northwest

photo #5

Exterior facing north

photo #6

Exterior facing east

photo #7

Interior facing south (entrance hall)

photo #8

Interior facing south

photo #9

Interior facing south

photo #10

Interior facing east

photo #11

Interior facing east

United States Department of the Interior
National Park Service

National Register of Historic Places Continuation Sheet

Section number Photos Page 2

Hurlbert, Lewis, House
Aurora, IN

photo #12

Interior facing north (second floor sitting room)

photo #13

Interior facing south (second floor)

photo #14

Interior facing west (second floor)

photo #15

Interior facing east

photo #16

Exterior facing south (Stable)

photo #17

Exterior facing north (Stable & outhouse)

photo #18

Exterior facing north (Stable & outhouse)

United States Department of the Interior
National Park Service

National Register of Historic Places Continuation Sheet

Section number _____ Page 1 SKETCH MAP Hurlbert House, Dearborn, Indiana

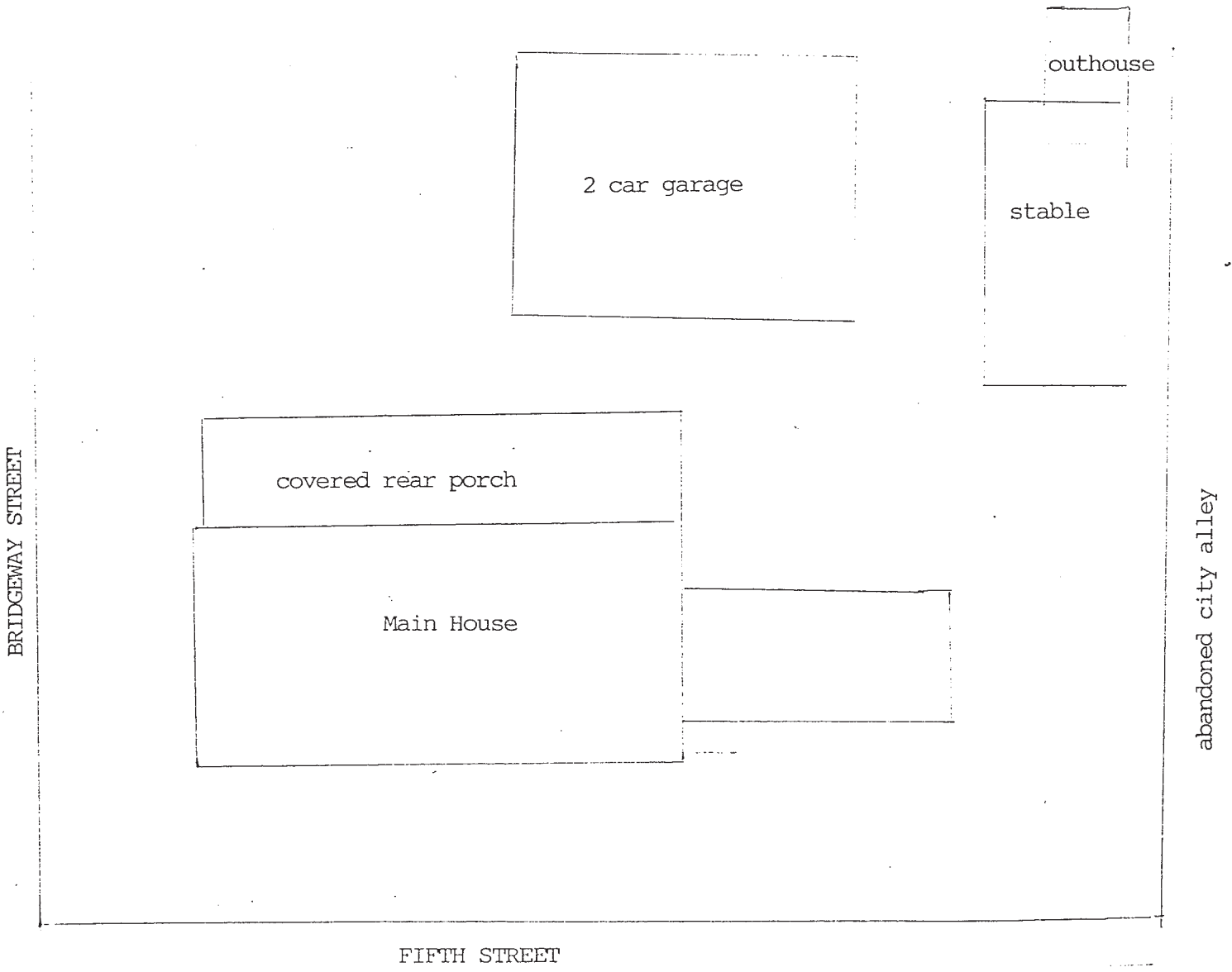

Not to scale